

A decorative graphic featuring three overlapping circles in red and white. Three horizontal orange text boxes are superimposed on the circles, containing the words 'CHANGE', 'COMPARISON', and 'CONTROVERSY' in a stylized, blackletter font. The entire graphic is set against a red background within a white-bordered frame.

CHANGE

COMPARISON

CONTROVERSY

1977

SEATTLE

MEDICAL LIBRARY ASSOCIATION



# Official Program

77th Annual Meeting  
Medical Library Association

***Change, Comparison, Controversy***

June 11-16, 1977  
Olympic Hotel  
Seattle, Washington

---

**NEW**

---

SIMULTANEOUS MICROFICHE SUBSCRIPTION

## **NEW ENGLAND JOURNAL OF MEDICINE**

*Weekly issues dispatched at the same time as the paper edition.*

Enter your subscription either with Pergamon Press, Inc.  
or your regular subscription agency.

Price: **\$26.00** domestic

**\$40.00** foreign (airmail)

---

**NOW IN ITS THIRD YEAR**

---

## **MICROFORM EDITION OF INDEX MEDICUS**

*Published with the permission of the National Library of Medicine*

### **1977 RATES**

	<i>Domestic &amp; Canadian</i>	<i>Foreign</i>
<b>Index Medicus</b>		
microfiche or microfilm	\$90.00	\$130.00
<b>Cumulated Index Medicus</b>		
<i>for 1976 and 1975</i>		
microfiche or microfilm	\$120.00 p.a.	\$130.00 p.a.

Previous years available—inquire for rates.

Orders from Canada and U.S. shipped first class;  
all others airmail.

•

*PERGAMON now produces simultaneous microfiche for 250 of  
its own journals as well as 70 U.S. Government publications.*

---

**Visit Us at Booth No. 41**

**See Our Books and Journals**

---



**PERGAMON PRESS, INC.**

MAXWELL HOUSE, FAIRVIEW PARK, ELMSFORD, N.Y. 10523  
HEADINGTON HILL HALL, OXFORD OX3 0BW, ENGLAND

# TABLE OF CONTENTS

	Page
OFFICERS	1
LOCAL ARRANGEMENTS COMMITTEE	3
GENERAL INFORMATION	4
CONTINUING EDUCATION COURSES	6
OFFICIAL PROGRAM	10
Monday, June 13	11
Keynote Address	12
Business Meeting I	13
Honors and Awards Luncheon	13
General Session I	14
Blake Island Salmon Bake	14
Tuesday, June 14	14
Concurrent Panel Sessions	18
Janet Doe Lecture	18
Special Interest Group Dinners/Meetings	22
Copyright Panel	23
Wednesday, June 15	23
Special Interest Group Breakfasts/Meetings	23
Business Meeting II	23
Special Interest Group Luncheons/Meetings	23
General Session II	26
Business Meeting III	28
Thursday, June 16	28
Sharing Sessions	28
General Session III	29
Inaugural Address	32
Annual Banquet	32
SPECIAL EVENTS	34
SPEAKERS' INDEX	43
EXHIBITORS' LIST	44

# DOCUMENTARY Aids

## INDEX CARDS

We've translated bibliographic information for all Karger serials, proceedings publications, and limited volume series into standard international index card format. With Karger's Index Cards on file, you'll have information concerning title, editor, ISSN, language of publication, last volume, and volumes in preparation for all these publications – right at your fingertips. Ninety index cards in a deck of a good idea. Available on request.

## BACK VOLUMES CATALOGUE

Nostalgic when you remember the past? Sorry you missed out on a Karger classic or a particular volume that could complete your information stock? Don't worry. The past – recent or remote – is never lost. Karger has compiled a catalogue of back volumes, providing you with full information for proceedings, series, and periodicals still available. If you'd like a copy of this new Karger Back Volumes Catalogue, we'd be glad to send you one. Just write to us.

We've translated bibliographic information for all Karger serials, proceedings publications, and limited volume series into standard international index card format.

Nostalgic when you remember the past? Sorry you missed out on a Karger classic or a particular volume that could complete your information stock?



## S. KARGER AG

Medical and Scientific Publishers  
Arnold-Böcklin-Strasse 25  
CH - 4011 Basel (Switzerland)

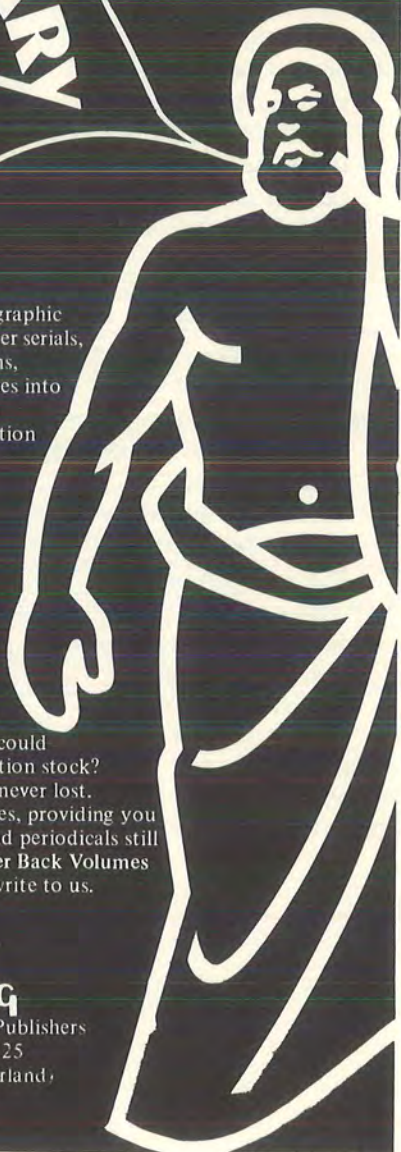

*GENERAL INFORMATION*

*CONTINUING EDUCATION COURSES*

*OFFICIAL PROGRAM*

*PROGRAM SUMMARY*

*SPECIAL EVENTS*

# SWETS

# MEANS

# COMPLETE LIBRARY SERVICES

SWETS NORTH AMERICA, INC. introduces a **FULL DOMESTIC SUBSCRIPTION SERVICE** for periodicals published in the U.S. and Canada — and pledges the same reliable service in the European manner that has distinguished SWETS & ZEITLINGER for 75 years.

SWETS SERVICE  
FOR BACK-DATED  
JOURNALS AND  
PERIODICALS

SWETS SERVICE  
FOR MONOGRAPHS  
AND  
CONTINUATIONS

SWETS SERVICE  
FOR PUBLISHING  
SCIENTIFIC JOURNALS  
AND BOOKS

SWETS SERVICE FOR  
FOREIGN JOURNALS  
WITH COMPUTERIZED  
KARDEX

**Doesn't Your Library  
Deserve SWETS Service?**

CALL LEO BURKELS OR PETER BENCE COLLECT  
(215) 644-4944

**SWETS NORTH AMERICA, INC.**

(A SWETS & ZEITLINGER COMPANY)  
BOX 517 BERWYN, PA 19312  
TELEX 084-5392



# WE KNOW YOU'RE SPECIAL

A medical library isn't like any other library. It's a specialized research center with doctors who often demand *immediate* access to up-to-date information. To provide this information, a medical library relies on its periodical collection,

and, in turn, on its magazine subscription agency to insure that its holdings are current and complete.

F. W. Faxon Company provides domestic and foreign periodicals to medical libraries throughout the world. Sophisticated computers insure accurate records and fast service; regional representatives give personal attention to all our customers.

Faxon understands the needs of medical libraries. After all, we've been doing business together for almost 100 years!

*Library business is our only business — since 1881.*

Visit our Booth #21 at the Conference.



## **F.W. FAXON COMPANY, INC.**

**Library Magazine Subscription Agency**

15 Southwest Park, Westwood, Massachusetts 02090

Tel: 800-225-7894 (toll-free) ■ 617-329-3350 (collect in Mass. and Canada only)



## OFFICERS 1976/77

### PRESIDENT

Miss Ann E. Kerker  
School of Veterinary Medicine  
Lynn Hall  
Purdue University  
West Lafayette, Indiana

### PRESIDENT-ELECT

Mr. Gilbert J. Clausman  
New York University Medical Center  
New York, New York

### IMMEDIATE PAST-PRESIDENT

Mrs. Barbara Coe Johnson  
Department of Libraries  
Harper Hospital  
Detroit, Michigan

### DIRECTORS

Mrs. Lois Ann Colaianni  
Cedars-Sinai Medical Center  
Los Angeles, California

Mrs. Erika Love  
Health Sciences Library  
University of New Mexico  
Albuquerque, New Mexico

Mr. Gerald Oppenheimer  
University of Washington  
Health Sciences Library  
Seattle, Washington

Mr. William H. Caldwell  
National Library of Medicine  
Bethesda, Maryland

Mrs. Priscilla M. Mayden  
University of Utah  
Library of Medical Sciences  
Salt Lake City, Utah

Mr. Irwin H. Pizer  
Library of the Health Sciences  
University of Illinois at the  
Medical Center  
Chicago, Illinois

Miss Virginia H. Holtz  
University of Wisconsin  
Middleton Health Sciences Library  
Madison, Wisconsin

**EXECUTIVE DIRECTOR**

Mr. John S. LoSasso  
Medical Library Association, Inc.  
Chicago, Illinois

**EDITOR OF THE *BULLETIN***

Mr. Robert F. Lewis  
University of California, San Diego  
Biomedical Library  
LaJolla, California

**EDITOR OF THE *MLA NEWS***

Miss Cecile E. Kramer  
Archibald Church Medical Library  
Northwestern University  
Chicago, Illinois

**TRUSTEE FOR FINANCE**

Miss Minnie Orfanos  
Northwestern University  
Dental School Library  
Chicago, Illinois

**PARLIAMENTARIAN**

Miss Joan M. B. Smith  
William Beaumont Hospital Library  
Royal Oak, Michigan

**SERGEANT-AT-ARMS**

Mrs. Harriette M. Cluxton  
Illinois Masonic Medical Center  
Chicago, Illinois

**ANNUAL MEETING  
LOCAL ARRANGEMENTS COMMITTEE**

Gerald J. Oppenheimer  
Chairman  
Health Sciences Library  
University of Washington  
Seattle, Washington

James E. Ekendahl  
Assistant to the Chairman

**Program Committee**

C. William Fraser  
Chairman  
Thomas G. Basler  
Robert A. Berk, Ph.D.  
Charles C. Colby III  
Jean C. Jones  
Miwa Ohta  
Eleanor E. Pasmik  
Janet Schnall  
Bessie A. Stein  
Michael Sullivan  
Clyde J. Winters

**Hospitality**

Joan Ash  
Jean Ashford  
Jody Dubois  
Ruth Harlamert  
Ethel Hill  
Margaret E. Hughes  
Leonoor Swets Ingraham  
Florence E. Johnson  
Dye Kuni  
Robert E. Lawrence  
Anna R. Leith  
Pamela W. Miles  
James E. Morgan  
Natalie J. Novick  
William Parker  
Debbie Pittson  
Mary Jane Richards

Heather G. Rosenwinkel  
Melvina Stell  
Mary Ann Stewert  
Marion von Bruck  
Marie Wagner  
Colleen Weum  
Mary Williams  
Cora R. Wilson  
Joan W. Wilson  
Muriel B. Wood

**Continuing Education**

James E. Ekendahl

**Tours and Entertainment**

Sharon Collins  
Juntina L. Costales  
Dale R. Middleton  
Lorraine Raymond  
Katherine A. Turner  
Glenn Wallace

**Exhibits**

Ellen Howard  
Carol Schneider

**Banquet**

Katherine K. Barber  
Kay F. Denfeld  
Dennis L. Levi  
Mary A. Olson  
Barbara Yocom

**Publicity**

Nancy Blase  
Marcia Henry  
Carol G. Jenkins  
Isabel McDonald  
Carole J. Stock  
Edith Throckmorton

**Graphics**

Connie J. Bennet  
Janet Yee

# GENERAL INFORMATION

## REGISTRATION

Registration will be in the Palm Court of the Olympic Hotel and open during the following hours:

Friday, June 10	6:00 p.m. - 10:00 p.m.
Saturday, June 11	7:30 a.m. - 10:00 a.m. 3:00 p.m. - 8:00 p.m.
Sunday, June 12	7:30 a.m. - 10:00 a.m. 3:00 p.m. - 8:00 p.m.
Monday, June 13	7:30 a.m. - 6:00 p.m.
Tuesday, June 14	8:00 a.m. - 4:00 p.m.
Wednesday, June 15	8:00 a.m. - 4:00 p.m.
Thursday, June 16	8:00 a.m. - 2:00 p.m.

## TICKET SALES

Tickets to special events will be sold in the Registration Area up to twenty-four hours before the function, subject to availability.

## EXHIBITS

Exhibits will be open during the following hours:

Exhibit Opening	
Sunday, June 12	7:00 p.m. - 9:00 p.m.
Monday, June 13	9:30 a.m. - 4:00 p.m.
Tuesday, June 14	10:00 a.m. - 4:00 p.m.
Wednesday, June 15	10:00 a.m. - 2:30 p.m.

## HOSPITALITY

Welcome to Seattle and the Pacific Northwest! Hospitality Subcommittee members are scheduled for 71 hours of service from a convenient location on the Mezzanine of the Olympic Hotel directly up the stairs from the Registration Area.

The Hospitality Center has two components: 1) the Foyer where members are eager to greet you and give assistance with respect to finding your way around the Olympic Hotel, locating program activities of the Annual Meeting and referring you, as necessary, to the 2) Information Center (the "Board Room" adjoining the Foyer) where informational materials are available and knowledgeable people are ready to help you in numerous ways to realize a successful, comfortable meeting and an enjoyable visit.

Hospitality Center hours are:

Friday, June 10	4:00 p.m. - 10:00 p.m.
Saturday, June 11	8:00 a.m. - 10:00 p.m.
Sunday, June 12	8:00 a.m. - 6:00 p.m.
Monday, June 13	8:00 a.m. - 5:00 p.m.
Tuesday, June 14	8:00 a.m. - 6:00 p.m.
Wednesday, June 15	8:00 a.m. - 7:00 p.m.
Thursday, June 16	8:00 a.m. - 7:00 p.m.

So . . . come to the Hospitality Center; relax for awhile; meet your friends and have your questions answered.

## MLA SCHOLARSHIP BOOTH

The Scholarship Booth will be open during the following hours:

Sunday, June 12	7:00 p.m.	-	9:00 p.m.
Monday, June 13	9:30 a.m.	-	4:00 p.m.
Tuesday, June 14	10:00 a.m.	-	4:00 p.m.
Wednesday, June 15	10:00 a.m.	-	2:30 p.m.

## MLA BOOTH

Information on membership, careers, education, certification, publications and the health sciences librarianship film is available. The booth is open during the same hours as Exhibits.

## PLACEMENT SERVICE

The Placement Service this year will include listings of both available positions and personnel. Provisions will be made for scheduling interviews during the period of the meeting.

The Placement Service located in the Williamsburg Room will be open during the following hours:

Friday, June 10	7:00 p.m.	-	10:00 p.m.
Saturday, June 11	7:30 a.m.	-	9:00 a.m.
	4:30 p.m.	-	8:00 p.m.
Sunday, June 12	7:30 a.m.	-	9:00 a.m.
	4:30 p.m.	-	9:00 p.m.
Monday, June 13	9:00 a.m.	-	5:00 p.m.
Tuesday, June 14	9:00 a.m.	-	5:00 p.m.
Wednesday, June 15	9:00 a.m.	-	5:00 p.m.
Thursday, June 16	9:00 a.m.	-	5:00 p.m.

## DAILY NEWSPAPER

The Daily Newspaper is available at the Registration Desk, the Hospitality Area, and in the Exhibit Hall.

## CONVENTION RIBBONS

Ribbons are used to identify registrants and other participants as follows:

WHITE	Officers and Board Members
RED	Hospitality
GOLD	Members from outside the U.S. and Canada
GREEN BUTTONS	New Members have been provided with green buttons. Let's give them a special welcome!

## CONTINUING EDUCATION COURSES

*(Courses are from 9:00 a.m. - 5:00 p.m. unless otherwise noted.)*

Course list is subject to change. Please check your registration material for room locations.

- CE 5 HUMAN FACTORS IN LIBRARY ADMINISTRATION  
Saturday Phyllis S. Mirsky  
Sunday Neil Barnhard
- CE 9 MATERIALS FOR THE HISTORY OF THE HEALTH SCIENCES  
Sunday William Beatty
- CE 10 RECENT ADVANCES IN THE LITERATURE OF PHARMACY  
Saturday Judy Labovitz  
Sunday Judy Labovitz
- CE 12 INDEXING AND ABSTRACTING SERVICES IN THE BIOMEDICAL SCIENCES  
Saturday Lorraine Schulte  
Sunday Lorraine Schulte
- CE 13 GRANT APPLICATIONS AND MANAGEMENT  
Sunday John Timour
- CE 14 PLANNING HEALTH SCIENCES LIBRARIES  
Sunday Samuel Hitt
- CE 15 LITERATURE OF NURSING  
Sunday Jacqueline Picciano
- CE 16 MANAGEMENT OF MEDIA IN LIBRARIES  
Saturday Cherryi Povey  
Sunday Cherryi Povey
- CE 17 PRESERVATION OF LIBRARY MATERIALS  
Sunday Judith Overmier
- CE 18 SYSTEMS ANALYSIS  
Saturday Claire Schultz  
Sunday Claire Schultz
- CE 19 APPLICATION OF OPERATIONS RESEARCH TO LIBRARY DECISION MAKING  
(2-Day) Ching-chih Chen
- CE 20 MEDLINE AND THE HEALTH SCIENCE LIBRARIAN  
Saturday Laura Eisenberg, Peri Schuyler  
Sunday Laura Eisenberg, Peri Schuyler
- CE 22 PLANNING HOSPITAL LIBRARY FACILITIES  
Saturday Jacqueline Bastille  
Sunday Anne Cramer
- CE 23 PROBLEMS IN MEDICAL CATALOGING AND CLASSIFICATION  
Saturday Emilie Wiggins  
Sunday Emilie Wiggins

## CONTINUING EDUCATION COURSES (Cont'd)

*(Courses are from 9:00 a.m. - 5:00 p.m. unless otherwise noted.)*

Course list is subject to change. Please check your registration material for room locations.

- CE 24 MeSH AND NLM CLASSIFICATION  
Saturday Sally Sinn  
Sunday Sally Sinn
- CE 26 TEACHING SKILLS FOR LIBRARY EDUCATORS  
(2-Day) Martha Jane Zachert
- CE 27 LITERATURE OF MENTAL HEALTH  
Saturday Cheryl E. Jacobson  
Sunday Lee Mackler
- CE 28 MANAGEMENT OF REFERENCE SERVICES  
Saturday Lucretia McClure  
Sunday Lucretia McClure
- CE 29 HOSPITAL LIBRARY MANAGEMENT  
Saturday Betsy Schreder, Gertrude Lamb  
Sunday Lois Ann Colaianne, Frances Ishii
- CE 30 BASIC MEDIA MANAGEMENT—HARDWARE AND PHYSICAL FACILITIES  
Saturday Betty Bogen  
Sunday Betty Bogen
- CE 31 BASIC MEDIA MANAGEMENT—SOFTWARE  
Saturday Michael Homan  
Sunday Malcolm Brantz
- CE 34 BIOLOGICAL ABSTRACTS—BIORESEARCH INDEX  
Saturday Ann L. Farren  
Sunday Ann L. Farren
- CE 35 OCLC UTILIZATION IN HEALTH SCIENCES LIBRARIES  
Saturday Patti Armes  
Sunday Patti Armes
- CE 36 WORKING WITH GROUPS/LEADERSHIP AND GROUP SKILLS  
(2-Day) Lillian Hohmann
- CE 37 DEVELOPMENT AND OPERATION OF A HEALTHSCIENCES LIBRARY  
CONSORTIUM  
Saturday Diana Slater  
Sunday Diana Slater
- CE 38 ACQUISITION OF BIOMEDICAL MATERIALS  
Saturday Nancy W. Woelfl  
Sunday Nancy W. Woelfl
- CE 40 ADVANCED COURSE ON GRANTSMANSHIP AND PROPOSAL DEVELOPMENT  
(2-Day) Naomi Broering
- CE 41 INTRODUCTORY DATA COLLECTION AND ANALYSIS  
Saturday Diane Cole  
Sunday Diane Cole

# The Electronic Maildrop\* System!



**SDC's**  
new system  
for ordering  
full-text  
documents in  
hardcopy or  
microform.

Right now, at the terminal, in seconds, you can order full-text copies of documents, in hardcopy or microform, from such data bases as Government R & D Reports (NTIS), Comprehensive Dissertation Index, Congressional Information Service Index, and American Statistics Index. You can also order articles from ANY journals, in ANY of our ORBIT data bases, that are among the 5000 sources covered by the Original Article Tear Sheet service (OATS®) of the Institute for Scientific Information. They even give 24-hour service!

That's basically all there is to it. The ELECTRONIC MAILDROP is one of the many innovative features that are fully operational and ready to serve all users of SDC Search Service. It's the best way we know of for on-line searchers and their clients to acquire important printed or microform documents—fast!

SDC Search Service is one of the most comprehensive on-line, interactive retrieval services in the world. We offer users access to a wide array of data bases, including 16 data bases available only through SDC Search Service. Together these data bases cover:

Agriculture  
Automotive engineering  
Business  
Chemical industry  
Chemistry  
Dissertations  
Education  
Energy  
Engineering  
Geosciences  
Grants  
Library & information science  
Management  
Monographs catalogued by LC

Oil and gas  
Paper chemistry  
Patents  
Petroleum/energy business  
Petroleum literature & patents  
Pharmaceutical industry  
Pharmaceutical literature  
Pollution  
Research in progress  
Textiles  
U.S. Congressional reports  
U.S. Congressional Record  
U.S. Government R & D  
U.S. Government statistical reports

\*Trademark of System Development Corporation

For more information or a demonstration, just write or call any of our offices.

*The Innovative Service—  
where Quality Comes First.*

## SDC Search Service

SDC Search Service, a division of System Development Corporation, with offices at 2500 Colorado Ave., Santa Monica, CA 90406; 7929 West Park Drive, McLean, VA 22101; 401 Hackensack Ave., Hackensack, NJ 07601; 900 Commerce Drive, Oakbrook, IL 60521; and 128 Theobalds Road, London WC1X 8RP, England. In Canada, contact INFOMART One Yonge Street, Toronto.



## RULES FOR MLA BUSINESS MEETINGS\*

### ARTICLE II. Meetings

#### Section 5. *Quorum*

A quorum of five per cent of the voting members shall be required for the transaction of business. For purposes of determining a quorum, a person eligible to cast two votes shall be counted as two voting members.

#### Section 6. *Voting*

To facilitate the counting of votes, the Executive Director shall provide easily seen voter identification to all eligible voters attending the meeting.

#### Section 7. *Order of business*

The order of business at the business meetings of the Annual Meeting shall be at the discretion of the presiding officer, but the business shall include:

Approval of the minutes of the Annual Meeting and of any special meetings of the membership held in the preceding year, but not necessarily of earlier meetings of the current session.

Reception of the reports of the Board of Directors, the Executive Director, the several other appointed officers, and the several committees and representatives.

Action on amendments to the Bylaws (if notice thereof has been given).

Announcement of the election of Officers and the Nominating Committee.

New business.

#### Section 8. *Resolutions*

A voting member may offer at the Annual Meeting a complex motion introducing a new item of business only if written copies have been distributed at or before the meeting to each voting member present or by the unanimous consent of voting members present.

### ARTICLE XI. Parliamentary Authority

#### Section 1. *Rules*

The rules contained in the current edition of *Roberts Rules of Order Newly Revised* shall govern the Association in all cases to which they are applicable and in which they are not inconsistent with these Bylaws and any special rules of order the Association may adopt.

\*Excerpted from the Bylaws, June 1976.

## OFFICIAL PROGRAM

*Medical Library Association policy states that all meetings are open to all Association members, or members of the Press, with closed meetings, or portions of meetings, held only for discussion of matters affecting the privacy of individuals or institutions.*

*Room designations refer to the Olympic Hotel, unless otherwise noted.*

### Wednesday, June 8

1:30 p.m. - 5:30 p.m. Room 351  
EXECUTIVE COMMITTEE  
Ann E. Kerker, Chairman

### Thursday, June 9

8:30 a.m. - 5:00 p.m. Room 351  
BOARD OF DIRECTORS  
Presiding: Ann E. Kerker, President

7:00 p.m. - 9:00 p.m. Room 351  
BOARD OF DIRECTORS ORIENTATION SESSION

### Friday, June 10

8:30 a.m. - 5:00 p.m. Room 351  
BOARD OF DIRECTORS  
Presiding: Ann E. Kerker, President

9:00 p.m. - 10:00 p.m. Room 218  
CONTINUING EDUCATION COURSE INSTRUCTORS

### Saturday, June 11

8:30 a.m. - 12:30 p.m. Room 351  
MLA/NLM LIAISON COMMITTEE  
Gerald J. Oppenheimer, Chairman

9:00 a.m. - 5:00 p.m. See Page 6  
CONTINUING EDUCATION COURSES

1:30 p.m. - 5:30 p.m. Queens Room  
BOARD OF DIRECTORS  
Presiding: Ann E. Kerker, President

4:00 p.m. - 6:00 p.m. Room 235  
AD HOC STEERING COMMITTEE FOR THE DEVELOPMENT  
OF CERTIFICATION EXAMINATIONS  
Beatrice Robinow, Chairman

5:15 p.m. - 6:15 p.m. Room 201  
CONTINUING EDUCATION COURSE INSTRUCTORS

7:00 p.m. - 10:30 p.m. Georgian Room  
AD HOC TASK ANALYSIS COMMITTEES  
Beatrice Robinow, Chairman

## Sunday, June 12

- 7:00 a.m. - 9:00 a.m. Room 235  
INTERNATIONAL COOPERATION COMMITTEE  
Ursula Poland, Chairman
- 8:30 a.m. - 5:00 p.m. Room 351  
RML DIRECTORS
- 9:00 a.m. - 5:00 p.m. See Page 6  
CONTINUING EDUCATION COURSES
- 9:00 a.m. - 5:00 p.m. Georgian Room  
AD HOC TASK ANALYSIS COMMITTEES  
Beatrix Robinow, Chairman
- 9:00 a.m. - 5:00 p.m. Room 264  
PROGRAM AND CONVENTION COMMITTEE  
Ronald M. Watterson, Chairman
- 1:00 p.m. - 3:00 p.m. Room 246  
EDITORIAL COMMITTEE FOR THE *BULLETIN*  
Alison Bunting, Chairman
- 5:00 p.m. - 6:00 p.m. Room 242  
HONORS AND AWARDS COMMITTEE  
Louise Darling, Chairman
- 5:00 p.m. - 6:00 p.m. Room 235  
LEGISLATION COMMITTEE  
Nina W. Matheson, Chairman
- 6:00 p.m. - 7:00 p.m. Olympic Bowl  
NEW MEMBER/INTERNATIONAL VISITOR RECEPTION  
(See Special Events)
- 7:00 p.m. - 9:00 p.m. Grand Ballroom/Spanish Ballroom/Lounge  
WELCOME RECEPTION/EXHIBIT OPENING  
(See Special Events)
- 10:00 p.m. - 11:00 p.m. Queens Room  
SUBCOMMITTEE ON THE JANET DOE LECTURESHIP  
Louise Darling, Chairman

## Monday, June 13

- 7:00 a.m. - 8:30 a.m. Rex Room  
VETERINARY MEDICAL LIBRARIES GROUP BREAKFAST  
(See Special Events)
- 8:45 a.m. - 9:30 a.m. Grand Ballroom  
OPENING SESSION  
Presiding: Ann E. Kerker, President  
Welcome:  
John R. Hogness, M.D., President,  
University of Washington  
Gerald J. Oppenheimer, Chairman  
Annual Meeting Local Arrangements Committee  
Keynote Address:  
David Suzuki, Ph.D., Professor, Zoology,  
University of British Columbia, Vancouver

**Monday, June 13**

9:30 a.m. - 10:00 a.m.

EXHIBIT RECESS – VISIT EXHIBIT AREAS

Complimentary Coffee

10:00 a.m. - 12:00 noon

Grand Ballroom

BUSINESS MEETING I

Presiding: Ann E. Kerker, President

APPROVAL OF MINUTES OF 75TH ANNUAL MEETING

REPORTS OF BOARD AND OFFICERS

REGISTRATION REPORT AND QUORUM

John S. LoSasso, Executive Director

PRESIDENT AND BOARD OF DIRECTORS

Ann E. Kerker

COMMITTEE ON COMMITTEES

Gilbert J. Clausman

FINANCE COMMITTEE

Gerald Oppenheimer

EXECUTIVE DIRECTOR

John S. LoSasso

EDITOR OF THE *BULLETIN OF THE MEDICAL LIBRARY ASSOCIATION*

Robert F. Lewis

EDITOR OF THE *MLA NEWS*

Cecile Kramer

REPORTS OF COMMITTEES

*At the discretion of the Chair Committee Reports may be deferred to Business Meeting II or if scheduled for that meeting taken up at this time.*

ANNUAL MEETING LOCAL ARRANGEMENTS COMMITTEE

Gerald Oppenheimer, Chairman

BIBLIOGRAPHIC AND INFORMATION SERVICES

ASSESSMENT COMMITTEE

Ruth Smith, Chairman

BYLAWS COMMITTEE

Stanley D. Truelson, Jr., Chairman

CERTIFICATION COMMITTEE

Dean Schmidt, Chairman

CONTINUING EDUCATION COMMITTEE

Phyllis S. Mirsky, Chairman

CURRICULUM COMMITTEE

E. Ann Gilmer, Chairman

EDITORIAL COMMITTEE FOR THE *BULLETIN*

Alison Bunting, Chairman

EDITORIAL COMMITTEE FOR THE *MLA NEWS*

Michele S. Klein, Chairman

Monday, June 13

ELECTIONS COMMITTEE  
Gilbert J. Clausman, Chairman

EXCHANGE COMMITTEE  
Nancy W. Garn, Chairman

12:00 noon - 2:00 p.m. Georgian Room

HONORS AND AWARDS LUNCHEON  
(See Special Events)

2:00 p.m. - 3:00 p.m.  
FREE TIME

3:00 p.m. - 4:30 p.m. Grand Ballroom

GENERAL SESSION I:  
*Management Challenges in Health Sciences Libraries*

Moderator: Samuel Hitt,  
Director, Health Sciences Library,  
University of North Carolina,  
Chapel Hill

*Sources of Support*

Robert G. Cheshier,  
Director, Cleveland Health Sciences Library,  
Cleveland, Ohio

This paper explores the responsibilities of central network libraries and those involved in networks with them, including financial and service responsibilities. The issues of resource sharing are related both to the style of management required and the services necessary to effect and maintain viable networks and to ensure reasonable and ordered growth, both qualitatively and quantitatively. The fee-for-service is explored as it affects management and examples of how fees modify managerial concerns are included. There are serious constraints on the implementation of fees during times of fiscal stress, and these are described. The issues of generation of funds to fulfill the library's purpose and the sources from which these funds can be sought are explored. Differences between the United States and Canada are described.

*Budgeting*

William Axford, Ph.D.,  
Director of Libraries,  
University of Oregon,  
Eugene

Attitudes and internal structures adversely affecting library performance and consequently budgets. Performance measurement viewed as the key to changes in both areas leading to greater productivity and therefore, and enhanced social utility for libraries. This, in turn, creating an increased willingness for top-level administrators to invest larger amounts of increasingly scarce resources for library services.

*Cooperative Programs*

Roderick Swartz, Ph.D.,  
State Librarian, Washington State Library,  
Olympia

The presentation will concentrate on the programs of a multi-type library network, and how the medical library can participate in such a network. The talk will focus on the various services of a network including resources sharing, cooperative storage, joint acquisition planning,

## Monday, June 13

and computer and telecommunication services. Emphasis will be on the benefits from network participation for a medical library, and what the potential barriers are for a medical library joining such a cooperative program.

4:30 p.m. - - 5:30 p.m.  
FREE TIME

5:30 p.m. Buses Depart  
BLAKE ISLAND SALMON BAKE  
(See Special Events)

## Tuesday, June 14

7:00 a.m. - 8:30 a.m. Rex Room  
REGIONAL GROUP CHAIRMEN BREAKFAST  
(See Special Events)

7:00 a.m. - 8:30 a.m. Pacific-Evergreen Room  
NURSING LIBRARIES GROUP BREAKFAST  
(See Special Events)

7:00 a.m. - 9:00 a.m. Colonial Room  
INTERNATIONAL COOPERATION COMMITTEE  
Ursula Poland, Chairman

9:00 a.m. - 10:30 a.m. Georgian Room  
CONCURRENT PANEL SESSIONS I -  
*ACADEMIC EMPHASIS*

Moderator:  
Eileen Bradley,  
University of Toronto,  
Toronto

*Oh! Canada! Canadian Health Libraries in 1977*  
Richard Fredericksen,  
Memorial University of Newfoundland

Focusing on the sixteen medical school libraries in Canada, the current status of health libraries in Canada will be reviewed. Slides illustrate the features of Canada's major medical libraries, from the Province of British Columbia to Newfoundland. The relationship of Canadian health librarians to professional associations such as the Medical Library Association and the newly formed Canadian Health Libraries Association will also be discussed. Emphasizing the composite picture, the paper should give the average MLA member a better understanding and awareness of the vitality of the Canadian medical library scene.

*Big Dividends from Wise Investments: Potential Returns for a Large Health Sciences Library from Communication, Cooperation and Stimulation of Departmental Libraries*

Carol D. Kasses  
Sue Taylor  
C. Lee Jones,  
Augustus Long Health Sciences Library,  
Columbia University,  
New York

Tuesday, June 14

Communication patterns and working relationships between large health sciences libraries and departmental libraries are described. Experiences of Columbia's Augustus Long Health Sciences Library in working with personnel of departmental libraries are discussed. These libraries serve to reduce the demand for common materials on the Health Sciences Library. The results of a telephone survey in which information on the experiences of other large health sciences libraries with their departmental units are also reported.

*Library Staff Utilization: The Dillon Model*

L. Yvonne Wulf,  
University of Minnesota,  
Minneapolis

In a 1975 paper titled "Organizing the Academic Library for Instruction", Howard Dillon presented a model of staff organization which is appropriate to academic health science libraries. The model provides for librarians who are active members of the teaching faculty. They are responsible for collections development, reference, resource guide preparation, and workshop presentations. Administration of operational departments is the responsibility of non-librarian staff members.

9:00 a.m. - 10:30 a.m.

Grand Ballroom

CONCURRENT PANEL SESSIONS II -

*CLINICAL EMPHASIS*

Moderator:

Janette Closurdo,  
St. Joseph Mercy Hospital,  
Pontiac Michigan

*Establishing an Interface between a Medical School Library and Area Health Education Center Libraries*

Charles R. Bandy,  
Director, Harley E. French Medical Library,  
University of North Dakota,  
Grand Forks

Establishing an interface between Area Health Education Center libraries and medical school libraries requires careful planning. Major elements of planning are: the overall plan, needs assessment, resource evaluation, developmental plan, institutional agreements, monitoring and evaluation and publicity. Health sciences librarians need to be well-informed of the changes in health-care delivery and health science education. The effectiveness of the interface depends on the quality of the working relationship of the library personnel.

*Meeting the Needs of the Nurse Practitioner—The Librarian's Responsibility*

Evelyn Bedard,  
Texas Medical Center,  
Houston

The nurse practitioner's role in the health care system is reviewed in a variety of settings. Influences which have resulted in the practitioner's awareness of the library as a necessary adjunct to professional life are discussed. The health sciences librarian's sensitivity to the library needs of the practitioner is perceived as a mutually rewarding partnership in the delivery of health care services.

Tuesday, June 14

*The CHIPS Program: A Health Information Network Geared to the Consumer*

Eleanor Goodchild,  
Los Angeles County Harbor General Hospital,  
Torrance, California  
Judith Furman,  
Carson Regional Public Library

The major goal of the CHIPS Project, "Consumer Health Information Program and Services/Salud y Bienestar", is a "Health Information Network" geared to the consumer, a public library client or a hospital patient. Funded by Title I LSCA, the Project coordinates the efforts of the Harbor General Hospital Medical Library and the Carson Regional Public Library. The objectives and operational activities are described with the envisioned role for libraries projected in the health education movement.

10:30 a.m. - 11:00 a.m.

EXHIBIT RECESS — VISIT EXHIBIT AREA  
Complimentary Coffee

11:00 a.m. - 12:30 p.m.

Georgian Room

CONCURRENT PANEL SESSIONS I —  
*ACADEMIC EMPHASIS (continued)*

Moderator:  
Eileen Bradley,  
University of Toronto,  
Toronto

*Health Sciences University Library Directorship 1955-1975*

Thomas G. Basler,  
Director of Libraries and Associate Professor,  
Medical College of Georgia,  
Augusta

This discussion presents the results of a study of health sciences library directorship from 1955 to 1975. Changes are noted concerning institutional definition, administrative framework, and library staff. Directors' positions are expressed in the areas of education, rank and status, age, sex, title, experience, and pressure felt. Fifty job functions performed are discussed as to rate of performance, importance, and time consumption for the years 1955, 1965, and 1975.

*A Survey of Computer Search Service Costs in the Academic Library*

Sherrilynne Shirley,  
Head, Reference Section, USC Health Sciences Campus,  
Los Angeles

The Norris Medical Library, University of Southern California, has recently completed an extensive survey of costs involved in the provision of search services beyond vendor charges for connect time and printing. In this survey, costs for such items as terminal depreciation, repair contract, personnel time, and supplies are analyzed. Implications of this cost survey are discussed in relation to planning and price setting for computer search services.



Tuesday, June 14

11:00 a.m. - 12:30 a.m.

Grand Ballroom

CONCURRENT PANEL SESSIONS II —  
*CLINICAL EMPHASIS (continued)*

Moderator:

Janette Closurdo,  
St. Joseph Mercy Hospital,  
Pontiac, Michigan

*Toward Hospital Library Standards in Canada*

M. A. Flower,  
Atelier à votre santé,  
Westmount, Quebec

A report on Canadian Hospital Library Standards as recently developed and incorporated in a new *Guide to Hospital Accreditation, 1977*; comparisons with MLA recommendations to the Joint Commission on Accreditation of Hospitals; discussion of differential minimal library standards worked out in Canada for hospitals classified according to function rather than size alone, as a practical means of furthering the development of hospital libraries.

*Developing a Competency-Based Examination*

Lorraine G. Hirschfeld,  
Health Sciences Library,  
University of New Mexico,  
Albuquerque  
Julie A. Virgo, Ph.D.,  
Executive Secretary, Association of College and  
Research Libraries, Chicago

In keeping with the provisions of the new Certification Code for more thoroughly evaluating the professional abilities of those entering health science librarianship, the Medical Library Association chose and is moving toward the development of a competency-based certification examination. This paper describes the steps taken in that development, the rationale behind some of those steps, some of the difficulties involved and the objectives set for it.

12:30 p.m. - 2:00 p.m.

EXHIBIT RECESS — VISIT EXHIBIT AREAS  
Complimentary Coffee

12:30 p.m. - 2:00 p.m.

Olympic Bowl

AD HOC COMMITTEE TO EXAMINE THE STATUS  
AND ECONOMIC INTERESTS OF HEALTH SCIENCE  
LIBRARY PERSONNEL  
Jean K. Miller, Chairman

12:30 p.m. - 2:00 p.m.

Georgian Room

AD HOC COMMITTEE TO STUDY  
MLA GROUP STRUCTURE  
James F. Williams II, Chairman

12:30 p.m. - 2:00 p.m.

Queens Room

BYI AWS COMMITTEE  
Stanley D. Truelson, Jr., Chairman

12:30 p.m. - 2:00 p.m.

Evergreen Room

EXCHANGE COMMITTEE  
Nancy W. Garn, Chairman

Tuesday, June 14

12:30 p.m. - 2:00 p.m.	Pacific Room
1978 PROGRAM COMMITTEE Irwin H. Pizer, Chairman	
12:30 p.m. - 2:00 p.m.	Room 351
PUBLICATIONS PANEL Alice Dunlap, Chairman	
2:00 p.m. - 3:00 p.m.	Grand Ballroom
JANET DOE LECTURE (See Special Events)	
3:00 p.m. - 4:30 p.m.	
FREE TIME	
4:30 p.m. - 5:30 p.m.	Room 203
CURRICULUM COMMITTEE E. Ann Gilmer, Chairman	
4:30 p.m. - 6:30 p.m.	Rex Room
AD HOC COMMITTEE TO STUDY THE FEASIBILITY OF AN ACCREDITATION PROGRAM FOR HOSPITAL LIBRARIES OR SUITABLE ALTERNATIVES Ruth W. Wender, Chairman	
4:30 p.m. - 6:30 p.m.	Queens Room
AD HOC COMMITTEE TO STUDY INTERLIBRARY LOAN PRACTICES AND PROBLEMS Robert M. Braude, Chairman	
4:30 p.m. - 6:30 p.m.	Room 247
CONTINUING EDUCATION COMMITTEE Phyllis S. Mirsky, Chairman	
4:30 p.m. - 6:30 p.m.	Room 201
EDITORIAL COMMITTEE FOR THE <i>MLA NEWS</i> Michele S. Klein, Chairman	
4:30 p.m. - 6:30 p.m.	Room 351
<i>HANDBOOK</i> CONSULTANTS PANEL, AD HOC Louise Darling, Chairman	
4:30 p.m. - 6:30 p.m.	Colonial Room
INTERNATIONAL COOPERATION COMMITTEE Ursula Poland, Chairman	
4:30 p.m. - 6:30 p.m.	Room 205
MEMBERSHIP COMMITTEE Lucretia McClure, Chairman	
4:30 p.m. - 6:30 p.m.	Pacific Room
1978 PROGRAM COMMITTEE Irwin H. Pizer, Chairman	
4:30 p.m. - 6:30 p.m.	Evergreen Room
1979 PROGRAM COMMITTEE Rita Kane, Chairman	

# New Medical Books

**THE YEAR IN ENDOCRINOLOGY: 1975-1976**, edited by Sidney H. Ingbar, M.D., Director, Thorndike Laboratory of Harvard Medical School at the Beth Israel Hospital. *327 pages, 1977, \$22.50\**

**THE YEAR IN METABOLISM: 1975-1976**, edited by Norbert Freinkel, M.D., Director, Center for Endocrinology, Metabolism, and Nutrition, Northwestern University Medical School. *353 pages, 1977, \$22.50*

**VIRAL INFECTIONS OF HUMANS: Epidemiology and Control**, edited by Alfred S. Evans, Yale University. *584 pages, 1977, \$39.50*

**THE PRACTITIONER'S GUIDE TO PSYCHOACTIVE DRUGS**, by Ellen L. Bassuk, M.D. and Stephen D. Schoonover, M.D., Beth Israel Hospital, Boston. A volume in Topics in General Psychiatry, edited by John C. Nemiah. *333 pages, 1977, \$19.95*

**THE FRONTIER OF BRIEF PSYCHOTHERAPY: An Example of the Convergence of Research and Clinical Practice**, by David H. Malan, The Tavistock Centre, London. A volume in Topics in General Psychiatry, edited by John C. Nemiah. *374 pages, 1976, \$19.95*

---

**COMPREHENSIVE IMMUNOLOGY**, edited by Robert A. Good and Stacey B. Day, Sloan-Kettering Institute for Cancer Research.

**Volume 1: Immunology and Aging**, edited by Takashi Makinodan, Baltimore City Hospitals, Veterans Administration Wadsworth Hospital Center, and University of California at Los Angeles, and Edmond Yunis, Sidney Farber Cancer Institute, Harvard Medical School. *208 pages, illus., 1977, \$22.50*

**Volume 2: Biological Amplification Systems in Immunology**, edited by Noorbibi K. Day and Robert A. Good, Sloan-Kettering Institute for Cancer Research. *325 pages, illus., 1977, \$29.50*

**Volume 3: Immunopharmacology**, edited by John W. Hadden and Ronald G. Coffey, Sloan-Kettering Institute for Cancer Research, and Federico Spreafico, "Mario Negri" Istituto di Ricerche Farmacologiche, Milano. *approx. 435 pages, illus., 1977, \$35.00*

---

Visit Our Booth #29 at the MLA Conference

**plenum**  
the language of science

PLNEUM PUBLISHING CORPORATION, 227 West  
17th Street, New York, N.Y. 10011  
In United Kingdom: Black Arrow House, 2 Chandos  
Road, London NW10 6NR, England

	7 a.m.	8	9	10	11	12 noon	1	2	
<b>MONDAY</b> REGISTRATION 7:30 a.m. - 6:00 p.m. EXHIBITS 9:30 a.m. - 4:00 p.m. PLACEMENT 9:00 a.m. - 5:00 p.m.	VETERINARY BREAKFAST REX ROOM		OPENING SESSION KEYNOTE ADDRESS BUSINESS MEETING I GRAND BALLROOM			HONORS AND AWARDS LUNCHEON GEORGIAN ROOM			
	SPECIAL INTEREST GROUP BREAKFASTS SEE PAGE 23		CONCURRENT PANEL I ACADEMIC GEORGIAN ROOM		CONCURRENT PANEL I ACADEMIC GEORGIAN ROOM				
<b>TUESDAY</b> REGISTRATION 8:00 a.m. - 4:00 p.m. EXHIBITS 10:00 a.m. - 4:00 p.m. PLACEMENT 9:00 a.m. - 5:00 p.m.	COMMITTEE MEETINGS SEE PAGE 38					COMMITTEE MEETINGS SEE PAGE 38			
			CONCURRENT PANEL II CLINICAL GRAND BALLROOM		CONCURRENT PANEL II CLINICAL GRAND BALLROOM				
<b>WEDNESDAY</b> REGISTRATION 8:00 a.m. - 4:00 p.m. EXHIBITS 10:00 a.m. - 2:30 p.m. PLACEMENT 9:00 a.m. - 5:00 p.m.	SPECIAL INTEREST GROUP MEETINGS SEE PAGE 40		BUSINESS MEETING II GRAND BALLROOM					SPECIAL INTEREST GROUP LUNCHEONS SEE PAGE 23	
			SHARING SESSIONS SPANISH BALLROOM/ LOUNGE OLYMPIC BOWL						
<b>THURSDAY</b> REGISTRATION 8:00 a.m. - 2:00 p.m. PLACEMENT 9:00 a.m. - 5:00 p.m.						BOARD/COMMITTEE CHAIRMEN LUNCHEON COLONIAL ROOM			

# PROGRAM SUMMARY

## Annual Meeting

3	4	5	6	7	8	9	10 p.m.
GENERAL SESSION I GRAND BALLROOM		BLAKE ISLAND SALMON BAKE					
JANET DOE LECTURE GRAND BALLROOM	COMMITTEE MEETINGS SEE PAGE 38				SPECIAL INTEREST GROUP MEETINGS/ DINNERS—SEE PAGE 22		COPYRIGHT PANEL GRAND BALLROOM
GENERAL SESSION II GRAND BALLROOM		COMMITTEE MEETINGS SEE PAGE 38				BUSINESS MEETING III GROUP STRUCTURE GRAND BALLROOM	
GENERAL SESSION III GRAND BALLROOM		INAUGURAL ADDRESS GRAND BALLROOM		ANNUAL BANQUET			
MLA/NLM LIAISON COMMITTEE GRAND BALLROOM							

Tuesday, June 14

- 4:30 p.m. - 6:30 p.m. Room 202  
SUBCOMMITTEE ON THE RITTENHOUSE AWARD  
Frances Groen, Chairman
- 7:00 p.m. - 9:00 p.m. Washington Plaza/Concord Room  
HEALTH SCIENCES AUDIOVISUAL GROUP MEETING  
(See Special Events)
- 7:00 p.m. - 9:00 p.m. Georgian Room  
HOSPITAL LIBRARIES GROUP MEETING  
(See Special Events)
- 7:00 p.m. - 9:00 p.m. Pacific Evergreen Room  
MEDICAL LIBRARY EDUCATION GROUP MEETING  
(See Special Events)
- 7:00 p.m. - 9:00 p.m. Colonial Room  
MEDICAL SOCIETY LIBRARIES GROUP DINNER  
(See Special Events)
- 7:00 p.m. - 9:00 p.m. Rex Room  
MENTAL HEALTH LIBRARIES GROUP MEETING  
(See Special Events)
- 7:00 p.m. - 9:00 p.m. Queens Room  
PUBLIC HEALTH/HEALTH ADMINISTRATION  
LIBRARIES GROUP MEETING  
(See Special Events)
- 7:00 p.m. - 9:00 p.m. Olympic Bowl  
RESEARCH LIBRARIES GROUP DINNER  
(See Special Events)
- 9:00 p.m. - 11:00 p.m. Grand Ballroom  
COPYRIGHT PANEL  
Moderator:  
Dale Middleton,  
Assistant Director, Operations,  
Pacific Northwest Regional Health Services Library,  
University of Washington,  
Seattle  
Panelists:  
Melvin S. Day,  
Deputy Director, National Library of Medicine,  
Bethesda;  
Lewis Flacks,  
Special Legal Assistant, Copyright Office,  
Library of Congress,  
Washington;  
Arthur J. Levine,  
Executive Director, CONTU,  
Washington;  
Alice Wilcox,  
Director, MINITEX, Wilson Library,  
University of Minnesota,  
Minneapolis

**Wednesday, June 15**

- 7:00 a.m. - 8:30 a.m. Colonial Room  
CANADIAN LIBRARIANS MEETING  
(See Special Events)
- 7:00 a.m. - 8:30 a.m. Pacific Evergreen Room  
MEDICAL LIBRARY RELEVANCE GROUP BREAKFAST  
(See Special Events)
- 7:00 a.m. - 8:30 a.m. Rex Room  
MENTAL HEALTH LIBRARIES GROUP MEETING  
(See Special Events)
- 9:00 a.m. - 11:00 a.m. Grand Ballroom  
BUSINESS MEETING II  
Presiding: Ann E. Kerker, President  
REPORTS OF COMMITTEES  
HEALTH SCIENCES LIBRARIES SURVEY COMMITTEE  
Henry L. Lemkau, Jr., Chairman  
HEALTH SCIENCES LIBRARY TECHNICIANS COMMITTEE  
Jackie Rustigian, Chairman  
HONORS AND AWARDS COMMITTEE  
Louise Darling, Chairman  
INTERNATIONAL COOPERATION COMMITTEE  
Ursula Poland, Chairman  
LEGISLATION COMMITTEE  
Nina W. Matheson, Chairman  
MLA/NLM LIAISON COMMITTEE  
Gerald Oppenheimer, Chairman  
MEMBERSHIP COMMITTEE  
Lucretia McClure, Chariman  
NOMINATING COMMITTEE  
Gilbert J. Clausman, Chairman  
PROGRAM AND CONVENTION COMMITTEE  
Ronald M. Watterson, Chairman  
SCHOLARSHIP COMMITTEE  
Richard A. Lyders, Chairman  
SURVEYS AND STATISTICS COMMITTEE  
Doris Bolef, Chairman  
AD HOC COMMITTEE TO EXAMINE THE STATUS  
AND ECONOMIC INTERESTS OF HEALTH SCIENCES  
LIBRARY PERSONNEL  
Jean K. Miller, Chairman  
AD HOC COMMITTEE TO STUDY THE FEASIBILITY OF  
AN ACCREDITATION PROGRAM FOR HOSPITAL  
LIBRARIES OR SUITABLE ALTERNATIVES  
Ruth W. Wender, Chairman

Wednesday, June 15

AD HOC COMMITTEE TO STUDY INTERLIBRARY  
LOAN PRACTICES AND PROBLEMS

Robert M. Braude, Chairman

AD HOC COMMITTEE TO STUDY MLA GROUP  
STRUCTURE

James F. Williams, II, Chairman

AD HOC STEERING COMMITTEE FOR THE  
DEVELOPMENT OF CERTIFICATION EXAMINATIONS

Beatrix Robinow, Chairman

*BULLETIN* CONSULTING EDITORS PANEL

Robert F. Lewis, Chairman

*HANDBOOK* CONSULTANTS PANEL, AD HOC

Louise Darling, Chairman

PUBLICATIONS PANEL

Alice Dunlap, Chairman

*VITAL NOTES* PARTICIPATORY PANEL

Spencer S. Marsh, Chairman

REPORTS OF REPRESENTATIVES AND DELEGATES

ADVISORY BOARD OF NATIONAL TRANSLATIONS  
CENTER

Willhelm Moll, J.D.

AMERICAN ASSOCIATION FOR THE ADVANCEMENT  
OF SCIENCE, SECTION T: INFORMATION, COMPUTING  
AND COMMUNICATION

Naomi Broering

AMERICAN ASSOCIATION OF COLLEGES OF  
PHARMACY, INC. – LIBRARIANS' SECTION

Marjorie Wannarka

AMERICAN LIBRARY ASSOCIATION, REFERENCE AND  
ADULT SERVICES DIVISION, BIBLIOGRAPHY  
COMMITTEE

T. Mark Hodges

AMERICAN LIBRARY ASSOCIATION, REFERENCE AND  
ADULT SERVICES DIVISION, COOPERATIVE  
REFERENCE SERVICES COMMITTEE

Bessie A. Stein

AMERICAN LIBRARY ASSOCIATION, REFERENCE AND  
ADULT SERVICES DIVISION, INTERLIBRARY LOAN  
COMMITTEE

Donald Hendricks, Ph.D.

AMERICAN LIBRARY ASSOCIATION, RESOURCES AND  
TECHNICAL SERVICES DIVISION, CATALOG CODE  
REVISION COMMITTEE

Emilie Wiggins



Wednesday, June 15

AMERICAN NATIONAL STANDARDS INSTITUTE,  
COMMITTEE Z39 ON LIBRARY WORK AND  
DOCUMENTATION

Nancy N. Woelfl

AMERICAN NATIONAL STANDARDS INSTITUTE,  
COMMITTEE Z85 ON STANDARDIZATION OF  
LIBRARY SUPPLIES AND EQUIPMENT

Joyce Loepprich

AMERICAN SOCIETY FOR INFORMATION SCIENCE

Nancy N. Woelfl

AMERICAN SOCIETY FOR INFORMATION SCIENCE  
COMMITTEE ON INTER-SOCIETY COOPERATION

Julie A. Virgo, Ph.D.

CONTINUING LIBRARY EDUCATION NETWORK AND  
EXCHANGE (CLENE)

Julie A. Virgo, Ph.D.

COUNCIL OF NATIONAL LIBRARY ASSOCIATIONS

Erich Meyerhoff

John S. LoSasso (ex-officio)

COUNCIL OF NATIONAL LIBRARY ASSOCIATIONS,  
JOINT COMMITTEE ON LIBRARY EDUCATION

Julie A. Virgo, Ph.D.

COUNCIL ON LIBRARY TECHNICAL-ASSISTANTS

Julie A. Virgo, Ph.D.

FEDERAL LIBRARY COMMITTEE, OBSERVER

Salvador B. Waller

HEALTH SCIENCES COMMUNICATION ASSOCIATION

Reba Benschoter

INTERAGENCY COUNCIL ON LIBRARY RESOURCES  
FOR NURSING

Samuel J. Waddell

JOINT COMMITTEE ON THE UNION LIST OF SERIALS

Samuel Lazerow

MLA SPECIAL CONSULTANT ON HOSPITAL LIBRARY  
STANDARDS

Eloise C. Foster

PLANNING COMMITTEE FOR THE INTERNATIONAL  
CONGRESS ON MEDICAL LIBRARIANSHIP

Scott Adams

SPECIAL LIBRARIES ASSOCIATION

Miriam Libbey

UNIVERSAL SERIALS AND BOOK EXCHANGE

Cecile C. Quintal

Wednesday, June 15

- 11:00 a.m. - 11:30 a.m.  
EXHIBIT RECESS - VISIT EXHIBIT AREA  
Complimentary Coffee
- 11:30 a.m. - 1:30 p.m. Colonial Room  
DENTAL LIBRARIES GROUP LUNCHEON  
(See Special Events)
- 11:30 a.m. - 1:30 p.m. Washington Plaza Charleston Room  
HISTORY OF MEDICINE GROUP LUNCHEON  
(See Special Events)
- 11:30 a.m. - 1:30 p.m. Georgian Room  
HOSPITAL LIBRARIES INTEREST GROUP LUNCHEON  
(See Special Events)
- 11:30 a.m. - 1:30 p.m. Olympic Bowl  
MEDICAL SCHOOL LIBRARIES GROUP LUNCHEON  
(See Special Events)
- 11:30 a.m. - 1:30 p.m. Washington Plaza Yorktown Room  
MILITARY MEDICAL LIBRARIES GROUP LUNCHEON  
(See Special Events)
- 11:30 a.m. - 1:30 p.m. Rex Room  
PHARMACY LIBRARIANS GROUP LUNCHEON  
(See Special Events)
- 11:30 a.m. - 1:30 p.m. Queens Room  
VETERINARY MEDICAL LIBRARIES GROUP LUNCHEON  
(See Special Events)
- 1:30 p.m. - 2:30 p.m.  
FREE TIME
- 2:30 p.m. - 4:30 p.m. Grand Ballroom  
GENERAL SESSION II  
*SOCIAL AND HUMANISTIC ISSUES IN MEDICINE*  
Moderator:  
C. William Fraser,  
British Columbia Medical Library Service,  
Vancouver

*Bioethical Choices: Genetic Screening and Counseling as a Case in Point*

Gilbert S. Omenn, Ph.D., M.D.,  
Assistant Professor of Medicine, Center for Inherited Diseases,  
Director, Robert Wood Johnson Clinical Scholars Program,  
University of Washington,  
Seattle

Genetic counseling has been revolutionized by the introduction of amniocentesis for early prenatal diagnosis of genetic disorders. Now it is possible to determine whether a particular fetus has a particular disease, rather than relying upon statistical risks. A precise diagnosis is essential, often requiring extensive search of the medical literature and considerable clinical experience. This presentation will also review population

Wednesday, June 15

aspects of genetic counseling based upon the screening programs for sickle cell anemia, Tay-Sachs disease, and phenylketonuria, to highlight certain ethical and public policy dilemmas that can arise.

*Dilemmas in Synthetic Biology*

Virginia A. Zakian, Ph.D.,  
Senior Fellow, Department of Genetics,  
University of Washington,  
Seattle

Recent breakthroughs in molecular biology have been commonplace experiments which allow the manipulation of genetic material (DNA) in new ways. The experiments which I will discuss involve the production of multiple copies of specific pieces of DNA and their recombination with DNAs from other sources. The scientific and social implications of this type of research will be examined.

*Allocation of Scarce/High Cost Resources and Social Policy*

Belding Scribner, M.D.,  
Professor of Medicine and Head, Division of Nephrology,  
University of Washington,  
Seattle

The allocation of dialysis by a lay committee in the mid-sixties serves as a warning that as medical technology continues to produce new, expensive life-sustaining techniques, these problems may recur in the future. The difficulties surrounding allocation of such resources will be discussed.

*Health Care Trends: Clinical and Governmental Problems*

William O. Robertson, M.D.,  
Immediate Past President, Washington State Medical Association,  
Professor of Pediatrics and Director of Medical Education,  
Children's Orthopedic Hospital and Medical Center,  
Seattle

Viewed over the span of history, the concept of health insurance is a remarkably recent innovation; so, too, is the rapidly evolving role of "government" in underwriting such insurance—or in providing health care services directly. Groups can do what individuals cannot—yet each of us cries out to be seen as an individual. Moreover, technologic innovation magnifies the dilemma for all involved—i.e., everyone on the globe. How to survive in the 'Brave New World' of 1984 will be briefly described.

*Information About Your Body: To Whom Does It Belong?*

Jane A. Raible,  
Executive Director, Northwest Institute of Ethics and the Life  
Sciences, Human Rights Review Committee, Department of  
Social and Health Services, State of Washington,  
Seattle

The right of informed consent is an area of health care in which Congress, governmental agencies, state legislatures and the judiciary have most actively shaped health policy in recent years. Who owns the information about our bodies? How much information must we be given to make decisions about our health care? Who determines our competency to give informed consent? Complex issues arise at every point of health care for: those genetically at risk, the minor, the mentally ill, the dying, the hospitalized patient, society as a whole. An overview of the issues and trends will be the focus of this presentation on informed consent.

### Wednesday, June 15

- 4:30 p.m. - 5:30 p.m. Room 202  
BIBLIOGRAPHIC AND INFORMATION SERVICES  
ASSESSMENT COMMITTEE  
Ruth C. Smith, Chairman
- 4:30 p.m. - 6:30 p.m. Room 238  
AD HOC COMMITTEE TO STUDY THE FEASIBILITY  
OF AN ACCREDITATION PROGRAM FOR HOSPITAL  
LIBRARIES OR SUITABLE ALTERNATIVES  
Ruth W. Wender, Chairman
- 4:30 p.m. - 6:30 p.m. Room 247  
AD HOC COMMITTEE TO STUDY INTERLIBRARY  
LOAN PRACTICES AND PROBLEMS  
Robert M. Braude, Chairman
- 4:30 p.m. - 6:30 p.m. Room 226  
CERTIFICATION COMMITTEE  
Dean Schmidt, Chairman
- 4:30 p.m. - 6:30 p.m. Room 232  
HEALTH SCIENCES LIBRARY TECHNICIANS  
COMMITTEE  
Eloise C. Foster, Chairman
- 4:30 p.m. - 6:30 p.m. Room 351  
PUBLICATIONS PANEL  
Alice Dunlap, Chairman
- 4:30 p.m. - 6:30 p.m. Room 203  
SCHOLARSHIP COMMITTEE  
Richard A. Lyders, Chairman
- 4:30 p.m. - 6:30 p.m. Room 205  
JOINT MEETING OF THE SURVEYS AND  
STATISTICS AND HEALTH SCIENCES LIBRARIES  
SURVEY COMMITTEES  
Doris Bolef and Henry L. Lemkau, Jr., Chairmen
- 4:30 p.m. - 6:30 p.m. Room 204  
*VITAL NOTES* PARTICIPATORY PANEL  
Spencer S. Marsh, Chairman
- 8:30 p.m. - 10:30 p.m. Grand Ballroom  
BUSINESS MEETING III  
Presiding: Ann E. Kerker, President  
*MLA GROUP STRUCTURE*

### Thursday, June 16

- 8:30 a.m. - 10:00 a.m. Spanish Lounge/Ballroom/Olympic Bowl  
SHARING SESSIONS  
Informal group discussions.  
See registration materials for details.
- \* *A. V. Monies - Getting and Spending*
  - \* *Biomedical Communications Network - I*

Thursday, June 16

- \* *Biomedical Communications Network – II*
- \* *Book Trade*
- \* *Canadian Comparisons*
- \* *Certification of Health Science Librarians*
- \* *Circulation Department Problems*
- \* *Clinical Medical Librarians*
- \* *Community Health Centers – Library Service*
- \* *Computer-Based Information Retrieval Services – I*
- \* *Computer-Based Information Retrieval Services – II*
- \* *Consortia – New Ideas – I*
- \* *Consortia – New Ideas – II*
- \* *Cooperative Collecting*
- \* *Departmental Library in the Hospital*
- \* *The Exchange*
- \* *Faculty Status for Health Sciences Librarians*
- \* *Family Physicians – Improving Library Services*
- \* *Free-Lance Bibliographic Services*
- \* *Future Shock in Health and Its Information Services*
- \* *Hospital Librarians – Professional Status*
- \* *How To Put Together a User Orientation A.V. Program*
- \* *Library School Curricula Changes*
- \* *MLA Publications*
- \* *NCLIS and MLA*
- \* *New Libraries – Old and New Problems*
- \* *Patient and/or Consumer Education – I*
- \* *Patient and/or Consumer Education – II*
- \* *Performance Measures for Health Sciences Libraries –  
What to Measure and How to Measure It*
- \* *Preparation for Administration*
- \* *Problems of the Very Small Library*
- \* *Public Relations*
- \* *Rare Books*
- \* *Reference Statistics – What, Why, and How?*
- \* *Shared Cataloging Services*
- \* *Unions and the Library*

10:30 a.m. - 12:00 noon Spanish Lounge/Ballroom/Olympic Bowl  
SHARING SESSIONS (continued)

12:00 noon - 1:30 p.m. Colonial Room  
BOARD AND COMMITTEE CHAIRMEN LUNCHEON

1:30 p.m. - 3:30 p.m. Grand Ballroom

GENERAL SESSION III  
*CHANGES IN COMMUNICATION MEDIA*

Moderator:

Nelson J. Gilman,

Director of Libraries, USC Health Sciences Campus and  
Los Angeles County/USC Medical Center,  
Los Angeles

Thursday, June 16

*Sharing Audiovisual Resources: The Need for Needs and User Assessment, or, To Share or Not To Share*

Tony Kwak,  
Media Specialist, Media Resources Center,  
Norris Medical Library, USC Health Sciences Campus,  
Los Angeles

The AV resource sharing movement is primarily an outgrowth of recent economic conditions and the ever growing demand for such materials in the health professions. But developing a successful program presents many difficulties. Much will depend upon an adequate need and user assessment. For in the end, the needs will justify the program and its users will ensure its success.

*The Uses and Potential of Microforms*

Jo Ann Bell  
Health Affairs Library, East Carolina University,  
Greenville, North Carolina

A general overview of microform usage in libraries is provided emphasizing the impact of conversion of print materials to microforms on library patrons and library staff members. Diagnostic techniques are analyzed to determine the adaptability of both collections and clientele. Problems concerning the standardization of hardware, selection of the proper microform formats and the use of silver halide, diazo or vesicular films are discussed in-depth.

*Accelerating Toward Online Retrieval — Can the Consequences be Anticipated? Evaluated? Avoided?*

Janet Egeland,  
Vice President, Marketing and Educational Services,  
Bibliographic Retrieval Services,  
Schenectady, New York

Health science libraries have been in the forefront of the acceleration toward online retrieval since the mid 1960's. Indeed, by 1977 online bibliographic retrieval services have become a routine part of the reference services provided by the majority of the health science libraries in the United States. As is often the case in the rush to utilize a new technology, many of the basic questions regarding the cost effective management and integration of these services in the library environment remain unanswered. Some of the most important of these questions will be discussed, along with a review of the procedures that are required to perform a comprehensive evaluation of these services in a given library.

*The User Viewpoint on Computerized Literature Searching*

Burton Reifler, M.D.,  
Instructor, Department of Psychiatry and Robert Wood  
Johnson Clinical Scholar, University of Washington,  
Seattle

The computerized literature search will be discussed primarily from the point of view of the clinical and research user. The author's personal use ranges from a brief "student special" search to a several year retrieval with monthly SDI LINE updates including abstracts. The optimal type of search for a given project varies considerably with one's objectives, and the advice and experience of the operator become increasingly important as the subject becomes more complex. Particular attention is

Thursday, June 16

drawn to the "evolving" type of search, where shifts in the user's objectives require reformulation of the search strategy. There will also be a brief discussion of an informal poll taken among the author's colleagues concerning computerized searches.

*The Controversy Over Change*

Alfred N. Brandon,  
Librarian, New York Academy of Medicine,  
New York

From the pages of present-day library literature, new methodologies and technologies abound! A superficial scanning of the literature may cause naive novices and overanxious progressives in our profession to decide that automation is the panacea for all library ills, and microforms the cure-all for every library space problem. At the other extreme, our stereotyped image views electronic advancements as satanic inspired heresies and fervently hopes they will mysteriously disappear! The discerning librarian harbors neither excessive viewpoint. Instead, his own initiative causes him to study, inquire, observe, and of necessity understand the costs, capabilities, potentialities, and limitations of the technological advances being presented. He evaluates new systems and methods, machine or manual, realistically in terms of increased service output by his library to its clientele. Regardless of scientific sophistication, any system and any machine which do not contribute in a significant way to that one aim have no place in a library. The librarian need not computerize his operation in order to be proficient in his capacity as an information technologist. By streamlining and updating slow, cumbersome, outmoded procedures and policies in acquisitions, cataloging, and serials processing, he can contribute markedly to the speed with which information flows from his library to the patron. To be considered professionally competent, the librarian must be adaptable and receptive to constructive new ideas that digress from the traditional dogma.

3:45 p.m. - 4:45 p.m.

Grand Ballroom

MLA/NLM LIAISON COMMITTEE SESSION

*MEDLINE QUALITY ASSURANCE*

Moderator:

William O. Robertson, M.D.,  
Immediate Past President, Washington State Medical Association,  
Professor of Pediatrics and Director of Medical Education,  
Children's Orthopedic Hospital and Medical Center,  
Seattle

Panelists:

Carole Stock,  
Regional Reference Librarian/MEDLINE Coordinator,  
Pacific Northwest Regional Health Sciences Library,  
Seattle;

Robert Berk, Ph.D.,  
University of Oregon Library School,  
Eugene;

Joseph Leiter, Ph.D.,  
Associate Director, Library Operations,  
National Library of Medicine,  
Bethesda

**Thursday, June 16**

- 5:00 p.m. - 5:30 p.m. Grand Ballroom  
INAUGURAL ADDRESS  
Gilbert J. Clausman,  
New York University Medical Center  
New York
- 8:00 p.m. Buses Depart  
ANNUAL BANQUET  
(See Special Events)

**Friday, June 17**

- 8:00 a.m. - 1:00 p.m. Evergreen Room  
1979 PROGRAM COMMITTEE  
Rita Kane, Chairman
- 9:00 a.m. - 5:00 p.m. Pacific Room  
PROGRAM AND CONVENTION COMMITTEE  
Ronald M. Watterson, Chairman
- 9:00 a.m. - 5:00 p.m. Rex Room  
BOARD OF DIRECTORS  
Presiding: Gilbert J. Clausman, President
- 9:00 a.m. - 5:00 p.m. Colonial Room  
CONTINUING EDUCATION COURSE INSTRUCTORS

**Saturday, June 18**

- 8:00 a.m. - 12:00 noon Rex Room  
BOARD OF DIRECTORS  
Presiding: Gilbert J. Clausman, President
- 9:00 a.m. - 5:00 p.m. Colonial Room  
CONTINUING EDUCATION COURSE INSTRUCTORS



**How can a medical library supplement its written resources to become even more comprehensive and up-to-date?**

By using audio and audiovisual presentations detailing pertinent sessions of medical conferences and symposiums, a library can give its users the opportunity to be vastly more well-informed.

For a complete listing of available medical recordings and visuals, visit Booth 43A



**Audio Archives, Ltd.**

Talk to our representatives about upcoming conferences to be recorded in 1977 and 1978.

# ***EDEN PRESS***

PUBLISHERS OF:

**ANNUAL RESEARCH REVIEWS**

**&**

**MEDICAL HYPOTHESES**

VISIT OUR BOOTH (25) FOR SPECIAL OFFERS NOW AVAILABLE.

## SPECIAL EVENTS

### Sunday, June 12

- 6:00 p.m. - 7:00 p.m. Olympic Bowl  
NEW MEMBER/INTERNATIONAL VISITOR RECEPTION
- 7:00 p.m. - 9:00 p.m. Grand Ballroom/Spanish Ballroom/Lounge  
WELCOME RECEPTION/EXHIBIT OPENING  
The conference welcome cocktail reception will include the opening ceremony for the MLA Exhibit program and an introduction to Seattle "Blue Grass". A complimentary ticket is included with your registration materials.

### Monday, June 13

- 7:00 a.m. - 8:30 a.m. Rex Room  
VETERINARY MEDICAL LIBRARIES GROUP BREAKFAST  
Isabel McDonald, Chairman
- 12:00 noon - 2:00 p.m. Georgian Room  
HONORS AND AWARDS LUNCHEON  
Presiding: Ann E. Kerker, President  
Welcome to New Members  
Gilbert J. Clausman, President-Elect  
New Member Response  
Dennis Lampkowski  
Memorial Sloan-Kettering Cancer Center  
New York, New York  
Presentation of Honorary Member Certificate  
Lucretia McClure, Chairman  
Membership Committee  
Presentation of Scholarships  
Richard A. Lyders, Chairman  
Scholarship Committee  
Cunningham Fellowship  
Ursula Poland, Chairman  
International Cooperation Committee  
Presentation of Prizes and Awards  
Louise Darling, Chairman  
Honors and Awards Committee  
Ida and George Eliot Prize  
Irene Graham, Chairman  
Subcommittee on the Ida and George Eliot Prize  
Murray Gottlieb Prize  
Judith Overmier, Chairman  
Subcommittee on the Murray Gottlieb Prize  
Rittenhouse Award  
Frances Groen, Chairman  
Subcommittee on the Rittenhouse Award  
Marcia C. Noyes Award  
Louise Darling, Chairman  
Honors and Awards Committee

**Monday, June 13**

5:30 p.m.

**BLAKE ISLAND SALMON BAKE**

An authentic Makah Indian salmon bake featuring fresh Pacific Ocean King salmon prepared in the ancient way on cedar stakes over open alder-wood fires in the lobby, where everyone can watch.

Buses depart Main Lobby Olympic Hotel

**Tuesday, June 14**

7:00 a.m. - 8:30 a.m.

Rex Room

**REGIONAL GROUP CHAIRMEN BREAKFAST**

Moderators: Ann E. Kerker, President

John S. LoSasso, Executive Director

7:00 a.m. - 8:30 a.m.

Pacific-Evergreen Room

**NURSING LIBRARIES GROUP BREAKFAST**

Barbara Knight, Chairman

2:00 p.m. - 3:00 p.m.

Grand Ballroom

**JANET DOE LECTURE**

*"Foundations in Medical Librarianship:*

*An Essay in History"*

Erich Meyerhoff,

Librarian, Cornell University Medical College,  
New York

7:00 p.m. - 9:00 p.m.

Washington Plaza/Concord Room

**HEALTH SCIENCES AUDIOVISUAL GROUP MEETING**

Janette Closurdo, Chairman

*"Audiovisuals and the Hospital Library"*

Helen Dimanin,

Director, Community Health Instructional Resources Program;

Kay Wimmer,

Librarian, St. Joseph Hospital,  
Chicago

7:00 p.m. - 9:00 p.m.

Georgian Room

**HOSPITAL LIBRARY INTEREST GROUP**

Business Meeting

Lois Ann Colaiani, Chairman

7:00 p.m. - 9:00 p.m.

Pacific-Evergreen Room

**MEDICAL LIBRARY EDUCATION GROUP MEETING**

Ann L. Farren, Chairman

*"On-Line Data Base Education for the Health Sciences.*

*Who Has Responsibility for It?"*

Pauline V. Angione,

Rosary College, Graduate School of Library Science,

River Forest, Illinois;

William Maina,

Biomedical Library, University of

California at San Diego,

La Jolla, California

**Tuesday, June 14**

- 7:00 p.m. - 9:00 p.m. Colonial Room  
MEDICAL SOCIETY LIBRARIES GROUP DINNER  
Kay Denfeld, Chairman  
*"Do You Want to Die Heroically,  
Medically, or Naturally?"*  
Norman K. Brown, M.D.
- 7:00 p.m. - 9:00 p.m. Rex Room  
MENTAL HEALTH LIBRARIES GROUP MEETING  
Alice Brand, Chairman
- 7:00 p.m. - 9:00 p.m. Queens Room  
PUBLIC HEALTH/HEALTH ADMINISTRATION  
LIBRARIES GROUP MEETING  
Jeannine M. Hinkel, Chairman  
*"The Role of a Librarian in an HSA"*  
Betsy Morton,  
Librarian, Puget Sound Health Planning Council
- 7:00 p.m. - 9:00 p.m. Olympic Bowl  
RESEARCH LIBRARIES GROUP DINNER  
Guy Coffee, Chairman

**Wednesday, June 15**

- 7:00 a.m. - 8:30 a.m. Colonial Room  
CANADIAN LIBRARIANS MEETING  
Richard Fredericksen, Chairman
- 7:00 a.m. - 8:30 a.m. Pacific-Evergreen Room  
MEDICAL LIBRARY RELEVANCE GROUP BREAKFAST  
Carole Stock, Chairman
- 7:00 a.m. - 8:30 a.m. Rex Room  
MENTAL HEALTH LIBRARIES GROUP  
Business Meeting  
Alice Brand, Chairman
- 11:30 a.m. - 1:30 p.m. Colonial Room  
DENTAL LIBRARIES GROUP LUNCHEON  
Carol G. Jenkins, Chairman  
*"A Broader Look at the Impact of Media Intensive Self-  
Instruction in Dentistry" - An Interactive Session*  
Robert J. Whitacre, D.D.S.,  
Assistant Director, Office of Instructional Development,  
University of Washington,  
Seattle
- 11:30 a.m. - 1:30 p.m. Washington Plaza Charleston Room  
HISTORY OF MEDICINE GROUP LUNCHEON  
Judith Overmier, Chairman  
*"The Role of Medical Librarians in the History of Medicine"*  
Estelle Brodman, Ph.D.,  
School of Medicine, Washington University  
St. Louis, Missouri

**Wednesday, June 15**

- 11:30 a.m. - 1:30 p.m. Georgian Room  
HOSPITAL LIBRARY INTEREST GROUP LUNCHEON  
Lois Ann Colaianni, Chairman  
*"Serving the Lay Person in the Hospital Library:  
Medical and Legal Aspects"*
- 11:30 a.m. - 1:30 p.m. Olympic Bowl  
MEDICAL SCHOOL LIBRARIES GROUP LUNCHEON  
Robert F. Lewis, Chairman  
*"The WAMI Program"*  
John N. Lein, M.D.,  
Associate Dean, Director, Division of Continuing Medical  
Education, University of Washington School of Medicine,  
Seattle
- 11:30 a.m. - 1:30 p.m. Washington Plaza Yorktown Room  
MILITARY MEDICAL LIBRARIES GROUP LUNCHEON  
Judith Arnn, Chairman  
*"Audiovisual Media in the Hospital Library"*
- 11:30 a.m. - 1:30 p.m. Rex Room  
PHARMACY LIBRARIANS GROUP LUNCHEON  
Barbara Katz, Chairman
- 11:30 a.m. - 1:30 p.m. Queens Room  
VETERINARY MEDICAL LIBRARIES GROUP LUNCHEON  
Isabel McDonald, Chairman  
*"The Primate Information Center"*  
Maryeva W. Terry

**Thursday, June 16**

- 12:00 noon - 1:30 p.m. Colonial Room  
BOARD AND COMMITTEE CHAIRMEN LUNCHEON
- 8:00 p.m.  
ANNUAL BANQUET  
Seattle will long be remembered as a city of rare experiences and  
the 1977 Banquet will be at the top of everyone's list. You can  
dine, dance and socialize with your colleagues aboard a spacious  
vessel (382 feet).  
Buses depart main lobby Olympic Hotel

## SPECIAL AND STANDING COMMITTEES\*\*

COMMITTEE	DATE	TIME	LOCATION
AD HOC COMMITTEE TO EXAMINE THE STATUS AND ECONOMIC INTERESTS OF HEALTH SCIENCES LIBRARY PERSONNEL	June 14	12:30 p.m.-2:00 p.m.	Olympic Bowl
AD HOC COMMITTEE TO STUDY THE FEASIBILITY OF AN ACCREDITATION PROGRAM FOR HOSPITAL LIBRARIES OR SUITABLE ALTERNATIVES	June 14 June 15	4:30 p.m.-6:30 p.m. 4:30 p.m.-6:30 p.m.	Rex Room Room 238
AD HOC COMMITTEE TO STUDY INTERLIBRARY LOAN PRACTICES AND PROBLEMS	June 14 June 15	4:30 p.m.-6:30 p.m. 4:30 p.m.-6:30 p.m.	Queens Room Room 206
AD HOC COMMITTEE TO STUDY MLA GROUP STRUCTURE	June 14	12:30 p.m.-2:00 p.m.	Georgian Room
AD HOC STEERING COMMITTEE FOR THE DEVELOPMENT OF CERTIFICATION EXAMINATIONS	June 11	4:00 p.m.-6:00 p.m.	Room 235
AD HOC TASK ANALYSIS COMMITTEES	June 11 June 12	7:00 p.m.-10:30 p.m. 9:00 a.m.-5:00 p.m.	Georgian Room Georgian Room
BIBLIOGRAPHIC AND INFORMATION SERVICES ASSESSMENT COMMITTEE	June 15	4:30 p.m.-5:30 p.m.	Room 202
BYLAWS COMMITTEE	June 14	12:30 p.m.-2:00 p.m.	Queens Room
CERTIFICATION COMMITTEE	June 15	4:30 p.m.-6:30 p.m.	Room 226
CONTINUING EDUCATION COMMITTEE	June 14	4:30 p.m.-6:30 p.m.	Room 206
CURRICULUM COMMITTEE	June 14	4:30 p.m.-5:30 p.m.	Room 203
EDITORIAL COMMITTEE FOR THE <i>BULLETIN</i>	June 12	1:00 p.m.-3:00 p.m.	Room 246
EDITORIAL COMMITTEE FOR THE <i>MLA NEWS</i>	June 14	4:30 p.m.-6:30 p.m.	Room 201
EXECUTIVE COMMITTEE	June 8	1:30 p.m.-5:30 p.m.	Queens Room
EXCHANGE COMMITTEE	June 14	12:30 p.m.-2:00 p.m.	Evergreen Room
<i>HANDBOOK</i> ADVISORY PANEL	June 14	4:30 p.m.-6:30 p.m.	Fourth Avenue Room
HEALTH SCIENCES LIBRARY SURVEY COMMITTEE	June 15	4:30 p.m.-6:30 p.m.	Room 205
HEALTH SCIENCES LIBRARY TECHNICIANS COMMITTEE	June 15	4:30 p.m.-6:30 p.m.	Room 232
HONORS AND AWARDS COMMITTEE	June 12	5:00 p.m.-6:00 p.m.	Room 242
INTERNATIONAL COOPERATION COMMITTEE	June 12 June 14 June 14	7:00 a.m.-9:00 a.m. 7:00 a.m.-9:00 a.m. 4:30 p.m.-6:30 p.m.	Room 235 Colonial Room Colonial Room
LEGISLATION COMMITTEE	June 12	5:00 p.m.-6:00 p.m.	Room 235
MLA/NLM LIAISON COMMITTEE	June 11	8:30 a.m.-12:30 p.m.	Queens Room
MEMBERSHIP COMMITTEE	June 14	4:30 p.m.-6:30 p.m.	Room 205
PROGRAM AND CONVENTION COMMITTEE	June 12 June 17	9:00 a.m.-5:00 p.m. 9:00 a.m.-5:00 p.m.	Room 264 Pacific Room
1978 PROGRAM COMMITTEE	June 14 June 14	12:30 p.m.-2:00 p.m. 4:30 p.m.-6:30 p.m.	Pacific Room Pacific Room
1979 PROGRAM COMMITTEE	June 14 June 17	4:30 p.m.-6:30 p.m. 8:00 a.m.-1:00 p.m.	Evergreen Room Evergreen Room
PUBLICATIONS PANEL	June 14 June 15	12:30 p.m.-2:00 p.m. 4:30 p.m.-6:30 p.m.	Fourth Avenue Room Room 201
SCHOLARSHIP COMMITTEE	June 15	4:30 p.m.-6:30 p.m.	Room 203
SUBCOMMITTEE ON THE JANET DOE LECTURESHIP	June 12	10:00 p.m.-11:00 p.m.	Queens Room
SUBCOMMITTEE ON THE RITTENHOUSE AWARD	June 14	4:30 p.m.-6:30 p.m.	Room 202

SURVEYS AND STATISTICS  
COMMITTEE  
VITAL NOTES  
PARTICIPATORY PANEL

June 15 4:30 p.m.-6:30 p.m. Room 205

June 15 4:30 p.m.-6:30 p.m. Room 204

\*\*Those committees not listed have not requested an open meeting during the Annual Meeting.



## HOSPITAL LIBRARIES · Booth 26A

*Have coffee or tea with us.  
And pick up a free copy of  
the magazine for hospital administrators  
and librarians, HOSPITAL LIBRARIES.*

BOX 624 · OAK PARK, ILLINOIS · 60303

## SPECIAL INTEREST GROUPS\*

GROUP	DATE	TIME	LOCATION
CANADIAN LIBRARIANS	June 15	7:00 a.m.-8:30 a.m.	Colonial Room
DENTAL LIBRARIES	June 15	11:30 a.m.-1:30 p.m.	Colonial Room
HEALTH SCIENCES AUDIOVISUAL	June 14	7:00 p.m.-9:00 p.m.	Washington Plaza Concord Room
HISTORY OF MEDICINE	June 15	11:30 a.m.-1:30 p.m.	
HOSPITAL LIBRARY INTEREST	June 14	7:00 p.m.-9:00 p.m.	Georgian Room
	June 15	11:30 a.m.-1:30 p.m.	Georgian Room
MEDICAL LIBRARY EDUCATION	June 14	7:00 p.m.-9:00 p.m.	Pacific-Evergreen Room
MEDICAL LIBRARY RELEVANCE	June 15	7:00 a.m.-8:30 a.m.	Pacific-Evergreen Room
MEDICAL SCHOOL LIBRARIES	June 15	11:30 a.m.-1:30 p.m.	Olympic Bowl
MEDICAL SOCIETY LIBRARIES	June 14	7:00 p.m.-9:00 p.m.	Colonial Room
MENTAL HEALTH LIBRARIES	June 14	7:00 p.m.-9:00 p.m.	Rex Room
	June 15	7:00 a.m.-8:30 a.m.	Rex Room
MILITARY MEDICAL LIBRARIANS	June 15	11:30 a.m.-1:30 p.m.	
PHARMACY LIBRARIANS	June 15	11:30 a.m.-1:30 p.m.	Rex Room
PUBLIC HEALTH/HEALTH ADMINISTRATION	June 14	7:00 p.m.-9:00 p.m.	Queens Room
RESEARCH LIBRARIES	June 14	7:00 p.m.-9:00 p.m.	Olympic Bowl
VETERINARY MEDICAL	June 13	7:30 a.m.-8:30 a.m.	Rex Room
	June 15	11:30 a.m.-1:30 p.m.	Queens Room

\*Room designations refer to the Olympic Hotel, unless otherwise noted.

# *MEDICAL ETHICS*

Feinstein, A. R. <b>CLINICAL JUDGMENT</b>	414 pp.	\$12.50
Hill, A. V. <b>TRAILS AND TRIALS IN PHYSIOLOGY</b>	388 pp.	\$15.50
Keith, A. <b>MENDERS OF THE MAIMED</b>	347 pp.	\$13.95
King, L. S. <b>THE MEDICAL WORLD OF THE 18th CENTURY</b>	363 pp.	\$12.50
Leake, C. D. <b>PERCIVAL'S MEDICAL ETHICS</b>	291 pp.	\$12.50
Pearl, R. <b>TO BEGIN WITH - Being Prophylaxis Against Pedantry</b>	141 pp.	\$4.95



ROBERT E. KRIEGER PUBLISHING CO., INC.  
645 NEW YORK AVENUE or P. O. Box 542  
HUNTINGTON, N. Y. 11743

*Titles to be shown at Combined Book Exhibit Booth Number 1*



## MLA PAST PRESIDENTS

- ‡Dr. George M. Gould (1898-1901)  
‡Dr. William Osler (1901-1904)  
‡Dr. J. R. Chadwick (1904-1905)  
‡Dr. A. Jacobi (1905-1906)  
‡Dr. George Dock (1906-1908)  
‡Dr. J. H. Musser (1908-1912)  
‡C. Perry Fisher (1912)  
‡Dr. J. C. Wilson (1912-1913)  
‡Dr. Francis R. Packard (1913-1914)  
‡Lt. Col. C. C. McCulloch, Jr. (1914-1916)  
‡Dr. Lewis H. Taylor (1916-1917)  
‡Dr. William Browning (1917-1919)  
‡Lt. Col. F. H. Garrison (1919-1920)  
‡Dr. John W. Farlow (1920-1921)  
‡Dr. L. F. Barker (1921-1922)  
‡Dr. C. F. Wylde (1922-1925)  
‡Dr. F. M. Tice (1925-1926)  
‡Dr. John Ruhrah (1926-1927)  
‡Dr. Archibald Malloch (1927-1930)  
‡Dr. Walter Steiner (1930-1933)  
‡Marcia C. Noyes (1933-1934)  
‡Charles Frankenberger (1934-1935)  
‡Dr. W. W. Francis (1935-1937)  
‡James F. Ballard (1937-1939)  
‡Col. Harold W. Jones (1939-1941)  
Mary Louise Marshall (1941-1946)  
‡W. B. McDaniel II, Ph.D. (1946-1947)  
‡Eileen R. Cunningham (1947-1948)  
Janet Doe (1948-1949)  
‡Dr. Sanford V. Larkey (1949-1950)  
‡Marjorie J. Darrach (1950-1951)  
L. Margueriete Prime (1951-1952)  
William D. Postell (1952-1953)  
‡Marion Dondale (1953-1954)  
Wilma Troxel (1954-1955)  
Wesley Draper (1955-1956)  
Bertha B. Hallam (1956-1957)  
Thomas E. Keys (1957-1958)  
‡Isabelle T. Anderson (1958-1959)  
‡Mildred Jordan (1959-1960)  
Robert T. Lentz (1960-1961)  
Gertrude L. Annan (1961-1962)  
Dr. Frank B. Rogers (1962-1963)  
Louise Darling (1963-1964)  
Estelle Brodman, Ph.D. (1964-1965)  
Alfred N. Brandon (1965-1966)  
Mildred C. Langner (1966-1967)  
Scott Adams (1967-1968)  
‡Jacqueline W. Felter (1968-1969)  
Elliott H. Morse (1969-1970)  
Donald Washburn, D.D.S. (1970-1971)  
Bernice M. Hetzner (1971-1972)  
Helen Crawford (1972-1973)  
Sarah C. Brown (1973-1974)  
Sam W. Hitt (1974-1975)  
Barbara Coe Johnson (1975-1976)  
‡Deceased



## SPEAKERS' INDEX



William Axford, Ph.D.	June 13	3:00 p.m. - 4:30 p.m.
Charles R. Bandy	June 14	9:00 a.m. - 10:30 a.m.
Thomas G. Basler	June 14	11:00 a.m. - 12:30 p.m.
Evelyn Bedard	June 14	9:00 a.m. - 10:30 a.m.
Jo Ann Bell	June 16	1:30 p.m. - 3:30 p.m.



Alfred N. Brandon	June 16	1:30 p.m. - 3:30 p.m.
Robert G. Cheshier	June 13	3:00 p.m. - 4:30 p.m.
Janet Egeland	June 16	1:30 p.m. - 3:30 p.m.
M. A. Flower	June 14	11:00 a.m. - 12:30 p.m.
Richard Fredericksen	June 14	9:00 a.m. - 10:30 a.m.



Eleanor Goodchild	June 14	9:00 a.m. - 11:00 a.m.
Lorraine Hirschfeld	June 14	11:00 a.m. - 12:30 p.m.
Carol D. Kasses	June 14	9:00 a.m. - 10:30 a.m.
Tony Kwak	June 16	1:30 p.m. - 3:30 p.m.
Gilbert S. Omenn, Ph.D., M.D.	June 15	2:30 p.m. - 4:30 p.m.



Jane A. Raible	June 15	2:30 p.m. - 4:30 p.m.
Burton Reifler	June 16	1:30 p.m. - 3:30 p.m.
William O. Robertson, M.D.	June 15	2:30 p.m. - 4:30 p.m.
Belding Scribner, M.D.	June 15	2:30 p.m. - 4:30 p.m.
Sherrilynne Shirley	June 14	11:30 a.m. - 12:30 p.m.



David Suzuki, Ph.D.	June 13	8:45 a.m. - 9:30 a.m.
Roderick Swartz, Ph.D.	June 13	3:00 p.m. - 4:30 p.m.
Julie A. Virgo, Ph.D.	June 14	11:00 a.m. - 12:30 p.m.
L. Yvonne Wulff	June 14	9:00 a.m. - 10:30 a.m.
Virginia A. Zakian, Ph.D.	June 15	2:30 p.m. - 4:30 p.m.

## EXHIBITORS' LIST

The firms and organizations listed below cordially invite you to visit their convention exhibits. The products and services represented merit the careful attention of all members.

The exhibits are located in the Spanish Ballroom/Lounge of the Olympic Hotel.

Abrahams Magazine Service (10)  
Audio Archives, Ltd. (43-A)  
Ballen Booksellers International (2)  
Bibliographic Retrieval Services, Inc. (53)  
BioSciences Information Service (16)  
Butterworth Publishers, Inc. (20)  
Checkpoint Systems, Inc. (18)  
Ciba Medical Education Division (3)  
The Combined Book Exhibit (1)  
William Dawson and Sons, Ltd. (19)  
Ebsco Subscription Services (43)  
Eden Press (25)  
Eliot Health Sciences Books (48)  
Elsevier North-Holland (46)  
Encyclopaedia Britannica (15)  
Excerpta Medica (45)  
F. W. Faxon Company, Inc. (21)  
Gustav Fischer New York, Inc. (40)  
Health Insurance Institute (52)  
Hospital Libraries Magazine (26-A)  
Institute for Scientific Information (35-36)  
S. Karger AG (28)  
Laco Bookstores, Inc. (33)  
Lockheed Missiles and Space Company, Inc. (27)  
Login Brothers Book Company, Inc. (24)  
Majors Scientific Books, Inc. (17)  
Matthews Medical and Scientific Books, Inc. (31)  
Med Select c/o de Gruyter, Inc. (32)  
Medcom Products (4)  
Medfact, Inc. (11)  
Moore-Cottrell Subscription Agencies (7)  
National Cancer Institute (6-A)  
National Center for Health Statistics/DHEW (37)  
National Institute of Mental Health/DHEW (5)  
National Library of Medicine (8-9)  
National Technical Information Services (51)  
Pergamon Press, Inc. (41)  
Plenum Publishing Corporation (29)  
Princeton Microfilm Corporation (26)  
Professional Research, Inc. (6-B)  
Raven Press (39)

Read-More Publications, Inc. (23)  
Rittenhouse Book Distributors (30)  
SDC Search Service (34)  
Scientific and Medical Publications of France (12)  
Springer-Verlag New York, Inc. (49)  
Stechert-Macmillan, Inc. (47)  
Swets North America, Inc. (14)  
Universal Serials and Book Exchange, Inc. (38)  
University Microfilms International (42)  
University of Washington/Primate Information Center (50)  
Wistar Institute Press (22)

## NOTES

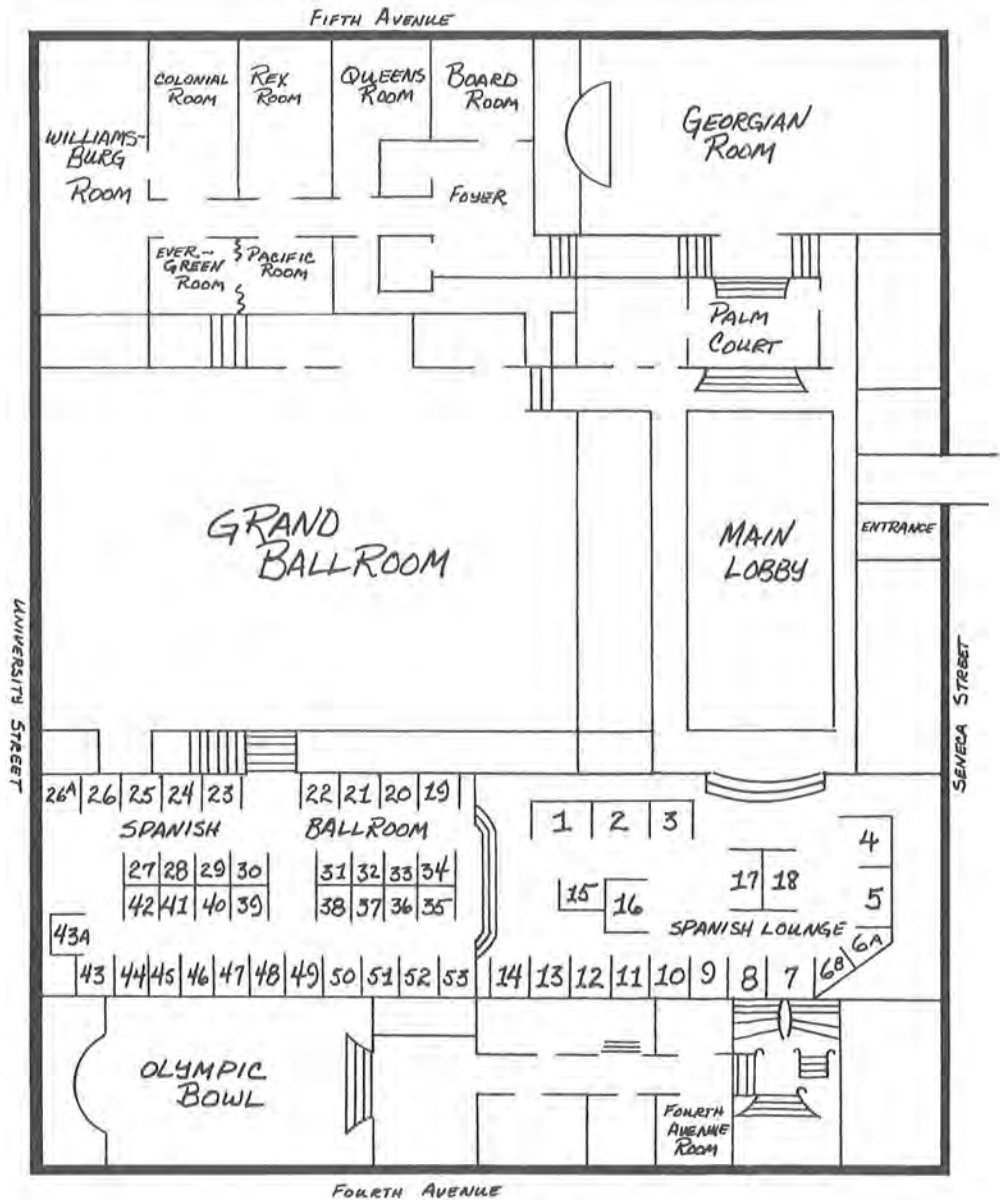

**MEETING ROOM LOCATION**

**OLYMPIC HOTEL**

- Lower Level*
  - Olympic Bowl
  - Fourth Avenue Room
- Mezzanine Level*
  - Board Room
  - Colonial Room
  - Georgian Room
  - Grand Ballroom
  - Evergreen Room
  - Pacific Room
  - Queens Room
  - Spanish Lounge
  - Spanish Ballroom
  - Williamsburg Room

Room number indicates floor for Rooms 201-351

**WASHINGTON PLAZA HOTEL**

- Convention Mezzanine*
  - Arlington Room
  - Bainbridge Room
  - Vashon Room
  - Charlestown Room
  - Concord Room
  - Dupar Room
  - Himmelman Room
  - Jamestown Room
  - Thurston Room
  - West Room
  - Yorktown Room

*For meeting room location fold out page.*

