

Pat Carolan

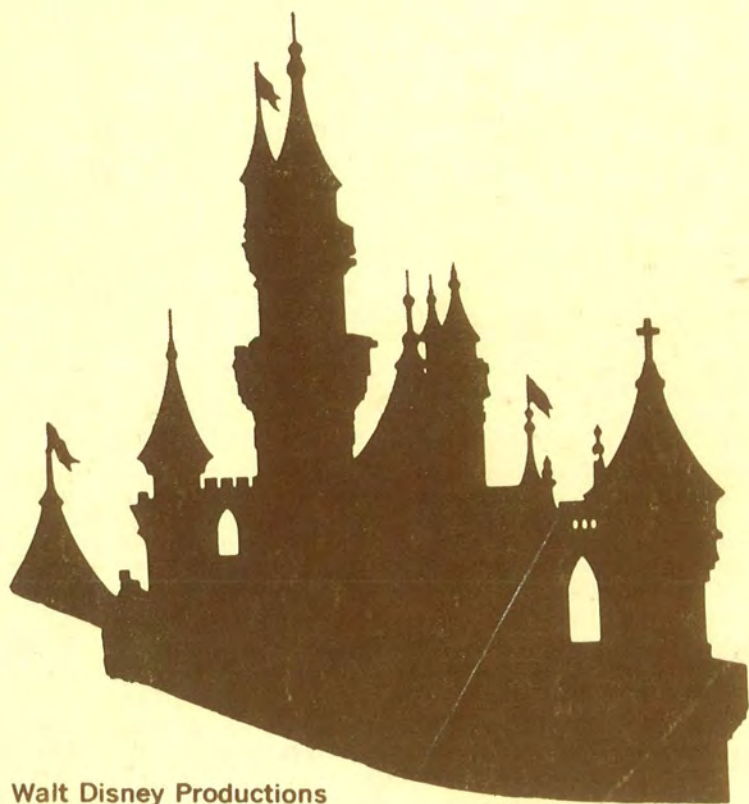

© Walt Disney Productions

OFFICIAL PROGRAM

MEDICAL LIBRARY ASSOCIATION
June 11-17, 1982 — Anaheim, California

If You're Serious About Genetic Engineering only One Data System has the Coverage You Can Rely On!

Telegen



Worldwide genetic engineering and biotechnology intelligence network

is the First
System for
Targeted Data
You Need—Now!

Information is the key to assured growth in the multi-billion dollar, many-sided field of Genetic Engineering and Biotechnology. ENVIRONMENT INFORMATION CENTER, INC. (EIC) has just introduced the first all-inclusive Information System covering all aspects of Genetic Technology. It is called TELEGEN®.

Incorporating hard, primary source data concisely digested into abstract form and derived from universities, independent laboratories, private corporations, government agencies and professional and technological meetings—as well as important information from journal literature. Gathered from around the world by EIC. The System consists of...

- **TELEGEN REPORTER**—a monthly, keeping you up-to-date with current events. Including just announced research, government studies, significant appointments, etc. Then over 300 carefully focused abstracts of new findings, government regulations, industrial applications, conference proceedings—even hard-to-get data such as rarely published monographs. Along with material having an economic, political or social impact. In all, some 3,600 pin-pointed abstracts throughout the year.
- **TELEGEN QUICKTEXT**—a system giving you the option of fast, full text retrieval of reports, papers or articles abstracted for the TELEGEN REPORTER—or from the TELEGEN 1973-1980 backfile.
- **TELEGEN REPORTER REVIEW**—a year end, two-volume hard cover annual. One volume is a unique, five-part index; the other volume contains the cumulated year's abstracts, and providing a complete listing of the year's most important data.

Backed by over a decade of experience in developing similar critical information systems, EIC has the proven know-how in finding and delivering the enormous professional and technological output from this vast, multi-disciplinary field. All in a coherent, quickly accessible system you can rely on.

Better yet, you can get TELEGEN now at \$1,200.

Send for your subscription today.

Visit EIC at the 82nd Annual Medical Library Association Meeting, June 14th- 17th, Anaheim, California at the Disneyland Hotel, Booth #42.

For further information, call or write:

TELEGEN

48 West 38th Street
New York, N.Y. 10018
(212) 944-8500

The Accessible System for Critical Information from EIC, Inc.

OFFICIAL PROGRAM
82ND ANNUAL MEETING
MEDICAL LIBRARY ASSOCIATION

JUNE 11-17, 1982

DISNEYLAND HOTEL
ANAHEIM, CALIFORNIA

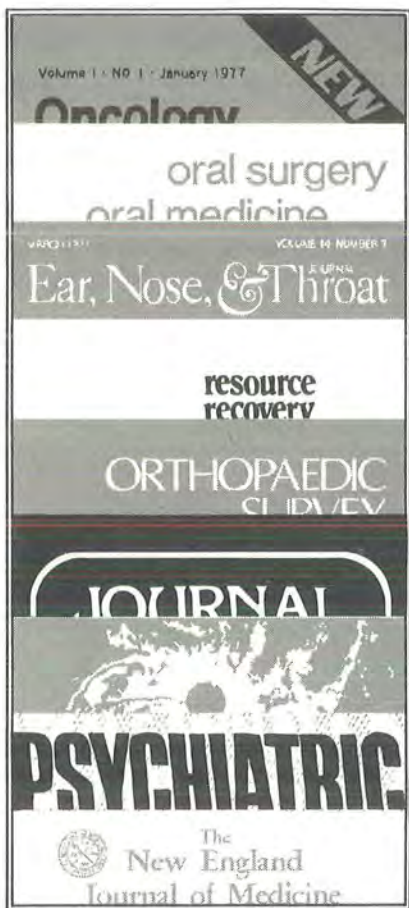

**Come by our booth
and learn about
something new—
Majors Comprehensive
Subscription Service.**

We've expanded our subscription service. And now it's new, improved, and better than ever, thanks to a computer program developed especially for Majors.

Looking for a subscription service with a secure future? Majors has the answer.

Don't forget Majors also has the largest inventory of medical books in the US, conveniently shipped from four branches. And we're fully automated for faster, more reliable service.

Booths 84-85



MAJORS SCIENTIFIC BOOKS, INC.

HOUSTON ATLANTA NEW ORLEANS DALLAS

THANK YOU

On behalf of the MLA Board of Directors, the National Program Committee and the membership, we want to take this opportunity to thank the individuals and organizations who generously donated funds for the special amenities that add so much to our enjoyment of the MLA Annual Meeting.

Raymond Palmer
Executive Director

Alison Bunting
National Program Chairman

Phyllis Mirsky
National Program Associate Chairman

Sponsors

Ballen Booksellers International, Inc. (Flowers)
Commack, New York

Eliot Health Science Books (Newsletter)
Jersey City, New Jersey

Excerpta Medica (Coffee Service)
Princeton, New Jersey

Login Brothers Book Company, Inc. (Coffee Service)
Chicago, Illinois

Majors Scientific Books, Inc. (Banquet Wine)
Dallas, Texas

Online Computer Systems, Inc. (Coffee)
Germantown, Maryland

Swets North America, Inc. (Restaurant Guides)
Berwyn, Pennsylvania

OCLC/MLA: In Touch with Today's Challenges



For over a decade you've been touching us, and we've been responding. Today libraries from specialized fields like the medical profession comprise an important segment of the over 3,000 OCLC participants. The range of OCLC's automated systems and services offers a practical and efficient solution to the host of challenges confronting medical libraries.

While at the conference, visit our booth #62-63. Our complete line of centralized and localized library services includes:

- Integrated automated systems supporting Cataloging, Serials Control/Union Lists, ILL, and Acquisitions
- Independent total processing capabilities of OCLC's local library systems
- Multiple information resources of BRS and DIALOG, brokered through OCLC's Affiliated Online Services



OCLC Online Computer Library Center, Inc.
6565 Frantz Road Dublin, Ohio 43017
(614) 764-6000

TABLE OF CONTENTS

	Page
1981/82 Board of Directors	1
Appointed Officials	3
MLA Headquarters Staff	4
MLA Past Presidents	7
1982 National Program Committee	11
Annual Meeting Highlights	15
General Information	19
Continuing Education Courses	23
Continuing Education Course Pretests	29
Job Market '82	31
Unofficial Meetings and Events	35
Official Program	37
Pre-Conference	37
Wednesday, June 9	37
Board of Directors Committee Meetings	37
Thursday, June 10	37
Board of Directors Committee Meetings	37
Continuing Education Courses Instructors Orientation	37
Friday, June 11	37
Board of Directors Meeting	37
Continuing Education Courses	37
Continuing Education Courses Instructors Orientation	37
Saturday, June 12	37
Board of Directors Meeting	37
Continuing Education Courses	38
Continuing Education Courses Instructors Orientation	38
Sunday, June 13	38
Committee Meetings	38
Tours	38
International Visitors, New Members, and First-time Attendees Welcome Tea and Reception	39
Conference	39
Monday, June 14	39
Committee Meetings	39
Opening Session	41
Invited Papers I-III	42
Section Meetings	50
Contributed Papers Sessions	53
Program Synopsis	56

Tuesday, June 15	47
Section Meeting	64
Business Meeting I	64
Presidential Address	68
General Session I	68
Janet Doe Lecture	70
Poster Sessions	70
Section Meetings	75
Council Meeting	75
Committee Meetings	75
Wednesday, June 16	77
Committee Meetings	77
Contributed Papers Sessions	78
Section Meetings	84
General Session II	87
Dialog MLA/NLM Leadership	88
Committee Meetings	88
Honors and Awards and Banquet	89
Thursday, June 17	89
Committee Meetings	89
Business Meeting II	90
Inaugural Address	90
MLA/NLM Liaison Committee Meeting	91
Section Meeting	91
Invited Papers Sessions	93
Chapter and Section Council	99
Post-Conference	100
Friday, June 18	100
Continuing Education Courses	100
Saturday, June 19	100
Continuing Education Courses	100
Committee Meetings Schedule	103
Invited Speakers Index	107
Contributed Papers: Author/Speakers Index	111
Exhibitors	114
Hotel Map	117

1981/82 BOARD OF DIRECTORS

President

Charles W. Sargent, Ph.D.
Library of the Health Sciences
Texas Tech University Health Sciences Center
Lubbock, Texas

President-Elect

Nancy M. Lorenzi, Ph.D.
University of Cincinnati
Medical Center Libraries
Cincinnati, Ohio

Immediate Past-President

Gertrude Lamb, Ph.D.
Hartford Hospital
Health Sciences Libraries
Hartford, Connecticut

Directors

Naomi C. Broering
Dahlgren Memorial Library
Georgetown University
Medical Center
Washington, D.C.

Arlee May
New England Regional
Medical Library Service
Francis A. Countway Library
of Medicine
Boston, Massachusetts

Eloise C. Foster
Library of the American
Hospital Association
Chicago, Illinois

Lucretia McClure
University of Rochester
School of Medicine/Dentistry
Edward G. Miner Library
Rochester, New York

Jana Bradley
Professional Library
Wishard Memorial Hospital
Indianapolis, Indiana

Judith Messerle
St. Joseph Hospital
Information Services
Alton, Illinois

Ruth W. Wender
University of Oklahoma
Health Science Center Library
Oklahoma City, Oklahoma

x (copy) [unclear]

Ex Officio

Voting Members

Joan Ash
Oregon Health Science
University Library
Portland, Oregon

Holly Shipp Buchanan
NKC Inc., Medical Library
Louisville, Kentucky

Non-Voting Member

Raymond A. Palmer
Executive Director
Medical Library Association
Chicago, Illinois



*Please stop in
at Booth 83*

Eliot Health Science Books, Inc.

34 EXCHANGE PLACE

JERSEY CITY, N.J. 07302

Call us toll free: (800) 526-3025

or (201) 333-3400

or (NYC) 937-2070

APPOINTED OFFICIALS

200
P. 200

Trustee for Finance

Minnie Orfanos
Northwestern University
Dental School Library
Chicago, Illinois

Editor of the "Bulletin"

Susan Crawford
Washington University School of
Medicine
St. Louis, Missouri

Editor of the "MLA News"

Connie Poole
American Hospital Association
Library
Chicago, Illinois

Parliamentarian

T. Mark Hodges
Medical Center Library
Vanderbilt University
Nashville, Tennessee

Sergeant-at-Arms

James H. Parrish
University of Illinois
Library of the Health Sciences
Chicago, Illinois

Archivists

William K. Beatty
Virginia L. Beatty
Evanston, Illinois

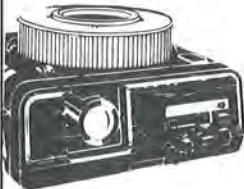

MEDCOM[®]

Famous Teachings in Modern Medicine

Over 375 audiovisual programs
prepared by and for physicians
and covering almost every
medical/surgical specialty.

Write or call for our
1982 Catalog

MEDCOM PRODUCTS
1633 Broadway New York, NY 10019
(212) 765-6162

TOLL-FREE 800-223-2505

MLA HEADQUARTERS STAFF

Administration

Raymond A. Palmer, Executive Director
 Carole Cole, Administrative Assistant
 Rick Podgorny, Accounting Manager
 Bertha Puehringer
 William Wallace

Continuing Education and Certification

Barbara Baxter, Assistant to the
 Director of Education for Continuing
 Education
 Claire Yoshida, Assistant to the
 Director of Education for Certification
 Frances L. Rickey

Meetings and Exhibits

Rosemary A. Buckley, Manager
 Patricia Carolan

Membership and Subscriptions

Dale Harms, Membership and Systems
 Specialist

Publications

Judith L. Biss, Manager
 Bertha Ruckman

We've Graduated!

You've known us as a leading review book publisher. We've helped thousands of students through medical school. And we're still helping, long after graduation day. Take a look at our growing list of *hardcover* books for clinical practice. Books covering all the specialties and subspecialties of medicine. Books with today's diagnostic and therapeutic modalities.

Medical Examination Publishing... much more than review books!

Introduction to Medical Hypnosis (300)	\$25.00
Guide to Patient Evaluation, 4/e (957) SPRING	about 28.00
Essential Neurology, 2/e (740)	32.50
Concise Textbook of Gynecology (585) SPRING	about 30.00
<i>Contemporary Surgical Management Series</i>	
Gastroesophageal Carcinoma (289)	25.00
Benign Diseases of the Esophagus (544)	30.00
Surgical Infections (693) SPRING	about 30.00
<i>Contemporary Patient Management Series</i>	
Anxiety — A Guide to Biobehavioral Diagnosis and Therapy (696)	22.50
Chronic Renal Failure (912)	30.00
Inflammatory Bowel Disease (558)	21.00
<i>New Directions in Therapy</i>	
Adult Psychiatry (848) SPRING	about 40.00
Diabetes and Metabolic Diseases (679) SPRING	about 30.00
Pediatric Otolaryngology (695) SPRING	about 35.00
Pediatric Nephrology (846) SPRING	about 60.00
<i>Focus on Clinical Diagnosis</i>	
Pediatric Allergic Diseases, 2/e (286) SPRING	about 37.50

For more information, get on our monthly *Book Notes* mailing list. Write:
 Medical Examination Publishing Co., Inc. 969 Stewart Ave. Garden City, NY 11530

A MAJOR PROGRAM

ONCOLOGIC Multidisciplinary Decisions in Oncology

A series of self-testing texts for physicians and specialists on the management of cancer. Offers 15 hours of CME credit.

New volumes include: Malignant Tumors of the Uterine Corpus and Trophoblastic Disease
Tumors of the Eye and Ocular Adnexae
Soft Tissues Sarcomas

PERGAMON MEETS YOUR MEDICAL LIBRARY NEEDS

IMPORTANT JOURNALS

Magnetic Resonance Imaging
Metabolic Bone Disease & Related Research
Computerized Radiology
Clinical Hemorheology
International Journal of Radiation Oncology-Biology-Physics
Ultrasound in Medicine & Biology
Leukemia Research
European Journal of Cancer and Clinical Oncology
Clinical and Investigative Medicine
Experimental Gerontology
Journal of Chronic Diseases
Thrombosis Research
Biorheology

MICROFORMS

INDEX MEDICUS In Microform

Since 1975 Pergamon Press has been producing simultaneously microfiche and microfilm of the world-renowned **INDEX MEDICUS** and **CUMULATED INDEX MEDICUS**. Micropublished with the permission of the National Library of Medicine, these editions convert medical literature into a compact, easy-to-handle form.

BACK ISSUES

Through our Maxwell Scientific International Division, Pergamon maintains large selections of medical back issues, competitively priced.



**PERGAMON
PRESS INC.**

VISIT US AT BOOTH #104

Maxwell House, Fairview Park, Elmsford, NY 10523

5/82/1F/200

EXPERTO CREDE*

As Latin forms a strong foundation for many languages, Worden forms a strong basis for effective medical libraries.

The Nordika, Marlborough, and Harford Library Furniture Systems offer a wide choice of support furniture for the library professional in many disciplines. Complementing the three lines is a complete line of desks, seating, shelving, and cabinets to create a successful library design, providing furniture needed for information storage, retrieval, and processing.

Using The Worden Company to establish a strong foundation for your medical library needs, makes sense in any language.

The Worden Company 199 east 17th street, p.o. box 915c,
holland, michigan 49423 (616) 392-1848

Medical
Libraries

Worden



***EXPERTO CREDE [L]**
Trust one who has had experience.

MLA PAST PRESIDENTS

- Gertrude Lamb, Ph.D. (1980-1981)
Lois Ann Colaianni (1979-1980)
Erika Love (1978-1979)
Gilbert J. Clausman (1977-1978)
Ann E. Kerker (1976-1977)
Barbara Coe Johnson (1975-1976)
Samuel W. Hitt (1974-1975)
Sarah C. Brown (1973-1974)
Helen Crawford (1972-1973)
Bernice M. Hetzner (1971-1972)
Donald Washburn, D.D.S. (1970-1971)
Elliott H. Morse (1969-1970)
† Jacqueline W. Felter (1968-1969)
Scott Adams (1967-1968)
Mildred C. Langner (1966-1967)
Alfred N. Brandon (1965-1966)
Estelle Brodman, Ph.D. (1964-1965)
Louise Darling (1963-1964)
Dr. Frank B. Rogers (1962-1963)
Gertrude L. Annan (1961-1962)
Robert T. Lentz (1960-1961)
† Mildred Jordan (1959-1960)
† Isabelle T. Anderson (1958-1959)
Thomas E. Keys (1957-1958)
Bertha B. Hallam (1956-1957)
Wesley Draper (1955-1956)
Wilma Troxel (1954-1955)
† Marion Dondale (1953-1954)
William D. Postell (1952-1953)
L. Margeurite Prime (1951-1952)
† Marjorie J. Darrach (1950-1951)
† Dr. Sanford V. Larkey (1949-1950)
Janet Doe (1948-1949)
† Eileen R. Cunningham (1947-1948)
† W. B. McDaniel II, Ph.D. (1946-1949)
Mary Louise Marshall (1941-1946)
† Col. Harold W. Jones (1939-1941)
† James F. Ballard (1937-1939)
† Dr. W. W. Francis (1935-1937)
† Charles Frankenberger (1934-1935)
† Marcia C. Noyes (1933-1934)

DOES YOUR SUBSCRIPTION AGENCY OFFER YOU...*more?*

more... than 160,000 foreign and domestic serials, including continuations and annuals?

more... personalized service and flexibility from regional offices?

more... easily handled claiming, with the least time-consuming claim system:

- A. A simple list
- B. A monthly Claim Checker
- C. A Missing Copy Bank?

more... management reports—over 24 standard?

more... innovation, with the world's first international online data communications system for serials?

more... professionals with the knowledge and concern to make your serials program work better?

We provide the most... *more* often.

For more information on the services that EBSCO offers or a free demonstration on EBSCONET, stop by and see us at our booth, Nos. 81, 82, 91 and 92.

EBSCO SUBSCRIPTION SERVICES

The serials professionals.

Sandra Gresham/P.O. Box 1943/Birmingham, AL 35201/(205) 252-1212 Telex 5-9717



- †Dr. Walter Steiner (1930-1933)
- †Dr. Archibald Malloch (1927-1930)
- †Dr. John Ruhrah (1926-1927)
- †Dr. F. M. Tice (1925-1926)
- †Dr. C. F. Wylde (1922-1925)
- †Dr. L. F. Barker (1921-1922)
- †Dr. John W. Farlow (1920-1921)
- †Lt. Col. F. H. Garrison (1919-1920)
- †Dr. William Browning (1917-1919)
- †Dr. Lewis H. Taylor (1916-1917)
- †Lt. Col. C. C. McCulloch, Jr. (1914-1916)
- †Dr. Francis R. Packard (1913-1914)
- †Dr. J. C. Wilson (1912-1913)
- †C. Perry Fisher (1912)
- †Dr. J. H. Musser (1908-1912)
- †Dr. George Dock (1906-1908)
- †Dr. A. Jacobi (1905-1906)
- †Dr. J. R. Chadwick (1904-1905)
- †Dr. William Osler (1901-1904)
- †Dr. George M. Gould (1898-1901)

†*Deceased*



Computerized access to the worldwide literature on
population and family planning

See our online demonstration at Booth 86

PRODUCERS:

Population Information Program
Center for Population and Family Health Library/Information Program
Population Index

AVAILABLE FROM:

National Library of Medicine

FEATURED AT:

Public Health and Health Care Administration SIG
Wednesday, June 16 11:00

Your search for highly focused bibliographies online is over!



**Stop by Booths 99A
and B for daily
demonstrations
of the new ISI®
Search Network
data bases.**

If you need precise, focused bibliographies of current journal articles, be sure to stop by Booths 99A and B for a demonstration of the ISI Search Network. This new online information retrieval system helps users perform comprehensive, high-precision searches *quickly, easily, and economically.*

The ISI Search Network includes a number of comprehensive data bases that can be accessed through a variety of search techniques including the all-new capability—research-front specialty searching. Daily demonstrations will feature how to search by research-front specialties and will highlight two specific data bases...

- **ISI/BIOMED™** — covering over 800,000 articles from over 1,400 journals worldwide, in all biomedical disci-

plines, from 1979 to the present.

- **ISI/ISTP&B™** (*Index to Scientific & Technical Proceedings & Books*)—including over 400,000 items from 1978 to date; annually indexing articles from over 3,300 scientific proceedings and over 1,650 multi-authored books (including review series).

Information will also be available on *ISI/CompuMath™* and other new data bases coming soon to the ISI Search Network.

So look no further for high-precision, highly focused bibliographies!

Just stop by Booths 99A and B—and see for yourself how the ISI Search Network will let you perform quick, easy, and low-cost searches with the precision you need. We'll see you there!

isi® Institute for Scientific Information®

3501 Market Street, University City Science Center, Philadelphia, PA 19104 U.S.A.
Telephone: (215) 386-0100, Cable: SCINFO, Telex: 84-5305

©1987 ISI 2811

1982 NATIONAL PROGRAM COMMITTEE

Alison Bunting, Chair
UCLA Biomedical Library
Center for the Health Sciences
Los Angeles

Diane Eckels
Nelson J. Gilman
Rachael K. Goldstein
Linda A. Grix
Lynn Kasner
Gerald J. Oppenheimer

Phyllis S. Mirsky, Co-Chair
Central University Library
University of California, San Diego
La Jolla

Raymond A. Palmer
Taylor Putney
Gertrude Lamb, Ph.D., Board of
Directors Liaison
Rosemary A. Buckley, MLA Staff

Local Arrangements Subcommittees

Child Care Arrangements

Hilary Brover, Chair

Continuing Education Liaison

F. Raymond Long, Chair *Kath Hoffman*
Judy Bube

Hospitality

~~Marilyn Schwartz, Chair~~ *Terry Ryan*
Chris Anderson
Gloria Arrendondo
Deborah Batey
Mary Ann Berliner
Ysabel Bertolucci
Carlene Bogle
Hilary Brover
Janice Brown
Judy Bube
Christa Buswell
Pat Carlson
Shirley Chervin
Steve Clancy
Harriet Cohen
Judith A. Dowd
Jacqueline Doyle
Dorothy Dragorette
Lisa Marie Dunkel
Jackie Erwin

Sherlyn Friday
Sherrilynne Shirley Fuller
Narciso M. Garganta
Elaine K. Graham
Anna Habetler
Susan Harker
Carole Hoff
M. Moss Humphrey
Carol Imah
Nancy Jacobus
Diane Johnson
Janet Judson
Betty Kjellberg
Sheila Latus
Irene Lovas
Terri Malmgren
Gaith Meakin
Stephanie Nelson
Alice Reinhardt
Linda Requena
Justine Roberts
Sherrill Sorrentino
Jeanne Spala
Paul Wakeford
Elaine L. Wells
Sharon Wheeler
Peri Worthington
Gail Yokote

2/15/83

Same year will give to me

The Building Blocks For A Great Library— Medical/Nursing Titles From Addison-Wesley

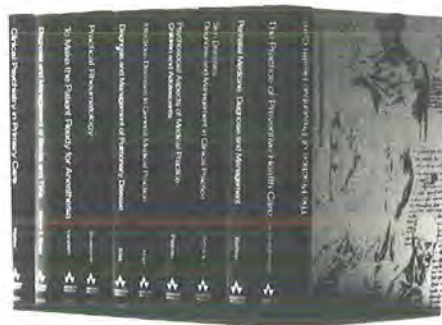

The Clinical Practice Series

Kiss—*Diagnosis and Management of Pulmonary Disease*

Binnick—*Skin Diseases: Diagnosis and Management in Clinical Practice*

Bishop—*Perinatal Medicine: Practical Diagnosis and Management*

Schnatz—*Diabetes Mellitus: Problems in Management*

Fadel—*Obstetric Emergencies: Prevention, Diagnosis, and Treatment*

Nixon—*Medical Management of Cancer*

Meyer & Shaw—*Diagnosis and Management of Stroke and TIAs*



Nursing Titles New In 1982

Ramsey—*Basic Pathophysiology: Modern Stress and the Disease Process*

Kozier & Erb—*Techniques in Clinical Nursing: A Comprehensive Approach*

Saxton—*Addison-Wesley's Comprehensive Manual of Nursing*

Bronzino—*Computer Applications in Patient Care*

 **Addison-Wesley Medical/Nursing Division** • 2727 Sand Hill Road • Menlo Park, CA 94025
 **Addison-Wesley (Canada) Ltd.** • 36 Prince Andrew Place • Don Mills, Ontario, Canada M3c2TB

Poster Sessions

Linda A. Grix, Coordinator

Publicity

Cynthia Butler, Chair

Rochelle Bock

Julie Smith

Eliz White

Section Liaison

Sherrilynn Shirley Fuller, Chair

Gillian Olechno

Justine Roberts

Rose Hogan

Social Events

Lois Clark, Chair

Pat Carlson

Betty Connolly

Wendy Culotta

Estelle Davis

Collette Ford

Emily Giustino

Erika Hansen

Lois Harris

Pauline Kelvin

Betty Kjellberg

Emi Kosaka

Judith Levy

Irene Lovas

Frances Lyon

Carole Myrick

Sharon Pruhs

Ann Ryan

1983 National Program Committee

Richard Lyders, Chairman
Houston Academy of Medicine
Texas Medical Center Library
Jesse H. Jones Library Bldg.
Houston

501-661-5980

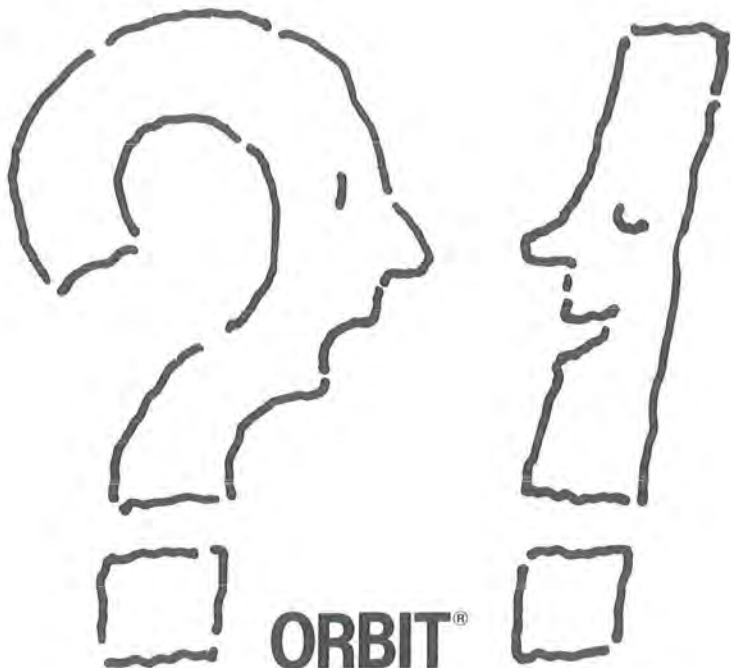

ORBIT[®]
answers questions
you didn't even know could
be asked.

Is there anyone, anywhere, who's invented just what you need? A consultant who's been working on your exact project? Someone who has developed an alternate energy source you can use?

Ask ORBIT—The Information Retrieval System of SDC Search Service. You'll quickly get information you thought was either so broad, or so very specialized, you didn't know where to start looking.

Start with ORBIT. For comprehensive databases—many of them exclusive. And our unique CROSSFILE feature that makes searching easy—no matter how broad or narrow the field. Japanese mini-computers? Storing Loire Valley wine, vintage '78?

No question about it: the answers are in ORBIT.

For ORBIT System Information, call:

SDC Search Service, (800) 421-7229.

SDC

System Development Corporation

2500 Colorado Avenue, Santa Monica, California 90406

ANNUAL MEETING HIGHLIGHTS

Sunday, June 13

10:00 a.m. – 4:00 p.m.

Tours

Several special tours have been arranged to provide MLA '82 participants with an opportunity to see some of the unique sights of Southern California. Choose either the Pasadena/Huntington Library Art Museum and Botanical Gardens Tour or the Early California Tour. For lovers of fine art, beautiful gardens, and rare books the Huntington Library and Art Museum is not to be missed; those interested in early California history or who have never seen the lovely Southern California coastline should take advantage of the Early California tour. Either tour warrants your early arrival in Anaheim and allows you to return in time for the welcoming festivities on Sunday evening.

12:00 p.m. – 10:00 p.m.

Disneyland Park: MLA '82 Private Party

At Disneyland Hotel's Travelport, step aboard the monorail to the Magic Kingdom. For the single fixed price of \$6.50, MLA '82 participants will have unlimited use of all rides in Disneyland Park as part of a private party with another organization. The Park will be open to us from 12 noon to 12 p.m. with in-and-out access permitted as often as desired. This will make it possible for you to take time out for the Welcome Party at the hotel, then return again to the Park. The many restaurants in the Park make it an ideal place for dinner after the Welcome Party.

5:15 p.m. – 6:30 p.m.

New Members/International Visitors/First Time Attendees Welcome Tea and Orientation

Members attending their first Annual Meeting and new members or visitors from outside the United States and Canada are invited to attend this orientation session sponsored by the Membership Committee. The Committee will present information to help you get the most out of your first MLA meeting.

Sunday, June 13 (continued)

- 5:15 p.m. — 6:30 p.m. **New Members . . . (continued)**
Immediately preceding the orientation session, new members, first-time attendees and visitors from abroad are invited to meet Association's officers, Board of Directors, Committee Chairmen, members of the Membership, International Cooperation, and the National Program Committees. This is an excellent opportunity to make new acquaintances and to meet some of the leaders of MLA.
- 6:30 p.m. — 7:30 p.m. **Welcome Party/Wine and Cheese Tasting**
A lovely outdoor garden area will be the setting for the Welcome Party featuring California wines accompanied by a variety of cheeses. Join your MLA colleagues at this informal event which is the perfect send-off to an evening at Disneyland. Musical entertainment will be provided by Phil Birdsell.

Monday, June 14

- 10:00 a.m. — 7:30 p.m. **Exhibit Opening and Exhibitor's Cocktail Party**
The Exhibits will open Monday, June 14, at 10:00 a.m. to allow registrants maximum opportunity to visit the over 100 exhibits. On Monday evening at 7:30 p.m., join us in the exhibit area for a complimentary drink and an additional opportunity to visit the exhibits.

Tuesday, June 15

- 4:00 p.m. — 11:00 p.m. **Library Tours**
Take one of the tours to the Medical School Libraries in Los Angeles and Orange counties. Following your library visit, you will have time for dinner in a restaurant of your choice in either Westwood Village, Chinatown, or Newport Beach. The return trip to Anaheim will include visits to various points-of-interest in the Los Angeles/ Orange county area.

Tuesday, June 15 (continued)

6:00 p.m. — 8:00 p.m. Newport Beach Dine-Around

If you are unable to participate in one of the tours, the Newport Beach Dine-Around provides an excellent and inexpensive opportunity for dinner in one of Southern California's loveliest beach communities.

Wednesday, June 16

7:00 a.m. — 11:00 p.m. Banquet

The annual banquet has been scheduled for Wednesday evening and promises to provide an enjoyable evening of musical entertainment and conviviality. The "no host" cocktail reception prior to the banquet will feature Latin American music. Bob's California Big Band will entertain us after a south-of-the-border dinner with selections from band music popular in the 30's and 40's.

A special feature of this year's banquet will be the presentation of the Association's top awards, including the Marcia Noyes award, the honorary members, and fellows.

Only Faxon could have created



See us at booths 5 & 6

The superior serials
management system

that evolves with your changing needs.

- DATALINX for direct access to computerized Faxon data bases and files.
- LINX SC-10 for on-line check-in and claiming.
- LINX for instantaneous electronic messages and comprehensive, on-line training.

Get the complete story on LINX. There's no competition!

Mail coupon to: **Faxon**,
15 Southwest Park
Westwood, Massachusetts
02090 USA

Tel: 800-225-6055 (toll-free)
617-329-3350 (collect in
Mass. and Canada)

faxon

100 years helping the world communicate

Name _____

Title _____

Library/Information Center _____

Address _____

City _____ State _____ Zip _____

Telephone () _____

please send me more information on LINX and how it would work for my library.

please contact me to schedule a free no-obligation LINX demonstration.

MLA-3

GENERAL INFORMATION

Registration

Registration will be in the ~~La Strada~~ Registration Area of the Convention Center of the Disneyland Hotel during the following hours:

Thursday, June 11 <i>May 26</i>	3:00 p.m. - 8:00 p.m.
Friday, June 12 <i>May 27</i>	3:00 p.m. - 8:00 p.m.
Saturday, June 13 <i>May 28</i>	7:00 a.m. - 7:00 p.m.
Sunday, June 14 <i>May 29</i>	7:00 a.m. - 7:00 p.m.
Monday, June 15 <i>May 30</i>	8:00 a.m. - 4:00 p.m.
Tuesday, June 16 <i>May 31</i>	9:00 a.m. - 4:00 p.m.
Wednesday, June 17 <i>June 1</i>	9:00 a.m. - 4:00 p.m.
Thursday, June 18 <i>June 2</i>	9:00 a.m. - 12:00 p.m.

① Meeting material including badges, tickets and program-related materials will be distributed in the registration area. Continuing Education course participants will receive information at that time. Information about special events, room locations for all events and further changes and additions to the program will be found in Special Announcements in the daily newspaper.

② Ticket Sales

Tickets to special events will be sold in the registration area up to twenty-four hours before the function, subject to availability.

Meeting Rooms

Meeting rooms are in three separate conference centers located on the Disneyland Hotel grounds:

Embassy/Magnolia Center	Sierra Conference Center	Bonita Conference Center
Embassy Room	Alamitos Room	Santa Barbara Room
Embassy West	Balboa Room	Santa Catalina Room
Embassy East	Cerritos Room	San Clemente Room
Magnolia Room	Olympic Room	Santa Cruz Room
Magnolia A	Orange Room	Santa Rosa Room
Magnolia B	Pacific Room	
Magnolia C	Palm Room	
	Regency Room	
	Serrano Room	
	Sierra Room	
	Yorba Room	

For the location of the meeting rooms in each Conference Center, please refer to the map on pages 117-118.

Exhibits

Exhibits will be open during the following hours:

Monday, June 14	10:30 a.m. — 5:00 p.m. 7:30 p.m. — 9:30 p.m.
Tuesday, June 15	10:00 a.m. — 5:00 p.m.
Wednesday, June 16	10:00 a.m. — 5:00 p.m.
Thursday, June 17	10:00 a.m. — 12:00 p.m.

Placement Service

The Placement Service will be located in the Disneyland Hotel Convention Center North Lounge, near the exhibit hall. It will maintain a set of notebooks for resumes of job candidates and a set of notebooks and a bulletin board listing job openings. The notebooks will be available for general browsing and interviews may be arranged. The Placement Service will be open during the following hours:

Friday, June 11 <i>May 27</i>	4:00 p.m. — 8:00 p.m.
Saturday, June 12 <i>May 28</i>	4:00 p.m. — 8:00 p.m. 4:30 p.m. — 6:00 p.m.
Sunday, June 13 <i>May 29</i>	8:00 a.m. — 9:00 a.m. 4:30 p.m. — 6:00 p.m.
Monday, June 14 <i>May 30</i>	8:30 a.m. — 4:30 p.m.
Tuesday, June 15 <i>May 31</i>	8:30 a.m. — 4:30 p.m.
Wednesday, June 16 <i>1</i>	8:30 a.m. — 4:30 p.m.
Thursday, June 17 <i>2</i>	8:30 a.m. — 4:30 p.m.

Hospitality

Welcome to Disneyland! The Hospitality Center has information available on the conference events and the surrounding areas of Anaheim. So drop in and relax for awhile, meet your friends and have your questions answered. The Hospitality Center will be located in the Mandarin Lounge, June 11 through 13, and the Exhibit Hall, June 14 through June 17, during the following hours:

Friday, June 11	3:00 p.m. — 6:00 p.m.	Mandarin Lounge
Saturday, June 12	8:00 a.m. — 10:00 a.m.	Mandarin Lounge
	2:00 p.m. — 7:00 p.m.	Mandarin Lounge
Sunday, June 13	9:00 a.m. — 5:00 p.m.	Mandarin Lounge
Monday, June 14	8:00 a.m. — 5:00 p.m.	Exhibit Hall
Tuesday, June 15	8:30 a.m. — 4:30 p.m.	Exhibit Hall
Wednesday, June 16	8:30 a.m. — 4:30 p.m.	Exhibit Hall
Thursday, June 17	8:30 a.m. — 12:00 p.m.	Exhibit Hall

MLA Scholarship Booth

The MLA Scholarship Booth is located adjacent to the Registration Area and is open during the following hours:

Saturday, June 12	8:00 a.m. — 3:00 p.m.
Sunday, June 13	8:00 a.m. — 3:00 p.m.
Monday, June 14	8:00 a.m. — 3:00 p.m.
Tuesday, June 15	8:00 a.m. — 4:00 p.m.
Wednesday, June 16	9:00 a.m. — 3:00 p.m.
Thursday, June 17	9:00 a.m. — 1:00 p.m.

Daily Newspaper

The *Dateline Disneyland* will report changes, cancellations or additions to the printed program including unofficial groups and informal meetings. Tidbits on local events and attractions will also be included. Copy for the next day's issue must be submitted by 3 p.m. to the press office. Pick up a copy at the Hospitality Center, Registration Area, or the entrance to General Sessions.

Convention Ribbons

White	Officers and Board Members
Blue (Dark)	Chapter Council Representatives and Alternates
Blue (Light)	Committee Chairmen and Members of ICC and Membership Committee
Green (Dark)	Section Council Representatives and Alternates
Green (Light)	First-Time Attendees, New Members and Registrants from outside U.S. and Canada. Please give them a special welcome.
Orange	MLA Staff
Pink	Hospitality and Program Committee
Purple	Exhibitors
Red	Sponsors
Tan	Instructors
Yellow	Speakers
Yellow (Light)	Moderator

Maroon

Brown

Black

R/Wh/Bl.

*Registrants outside
U.S. & Canada*

ONLINE Computer Systems, Inc. sets the standard in library automation with the National Library of Medicine's

INTEGRATED LIBRARY SYSTEM

Compare ILS Features

Subsystems

Circulation • Bibliographic • Administration • Online Public Catalog with keyword & Boolean searching • Limited Serials Control (enhancements underway) • Online Documentation and Help

Choice of Hardware and Support Options

IBM • Data General • Digital Equipment Corporation (DEC) • Full or limited support from Online Computer Systems • Complete Source Code and Documentation included if local support desired

Functionality

Full MARC format • Full Authority File management • Outstanding Catalog Search Capability • Integration by design, not by afterthought • Other modules in development

ONLINE COMPUTER SYSTEMS specializes in

Library Automation
Information Retrieval
Computer Assisted Instruction
Computer Graphics

Videodisc-based information systems
Custom system analysis, engineering,
and programming
Full customer support

'80/'81 Achievements

First company in the world to design and produce a videodisc-based product—VIDEO PATSEARCH™

Designed and produced the first multilingual Career Guidance System capable of running on micro and minicomputer systems with optional videodisc images of universities and occupations

First company to support a Computer Assisted Instruction Language transportable across most major microcomputers—PILOT plus™

Recognized as a leader in information systems design and application of technology by more journals and conferences than any other library systems company

For further information contact:
Online Computer Systems, Inc.
ILS Product Manager
20010 Century Blvd., Suite 101
Germantown, Maryland 20874
Telephone: (301) 428-3700

Online has more ILS sites and more ILS experience than any other company.

CONTINUING EDUCATION COURSES

Continuing education courses will be offered on Friday, June 11, Saturday, June 12, and Sunday, June 13, at the Disneyland Hotel.

Friday, June 11, 8:30 a.m.-5:00 p.m.

CE 129—Hospital Library Management

Lois Ann Colaianni
Palm Room, Sierra Center

CE 466—Toxicology for Online Search Analysts (Two-day Course)

Bonnie Snow and Janet Everitt
San Clemente Room, Bonita Center

CE 524—MeSH and NLM Classification

Susan Hill
Yorba Room, Sierra Center

CE 636—Patient Education

Lionelle Elsesser
Pacific Room, Sierra Center

CE 669—Assertiveness and Human Relations Skills

Janette Caputo, Ph.D.
Balboa Room, Sierra Center

Saturday, June 12, 8:30 a.m.-5:00 p.m.

CE 117—Preservation of Library Materials

Judith Overmier
Alamitos Room, Sierra Center

CE 246—Basic Budgeting for Health Sciences Libraries

Cami Loucks
Yorba Room, Sierra Center

CE 332—Statistical Sources for Health Sciences Librarians

Sydney Owens
Sierra Room, Sierra Center

CE 420—MEDLINE and the Health Sciences Librarian

Lynne Morris

Cerritos Room, Sierra Center

CE 464—Online Searching in Psychiatry (Section One)

Barbara Epstein

Balboa Room, Sierra Center

CE 464—Online Searching in Psychiatry (Section Two)

Jennifer Angier

Pacific Room, Sierra Center

CE 466—Toxicology for Online Search Analysts (Two-day Course)

Bonnie Snow and Janet Everitt

San Clemente Room, Bonita Center

CE 535—OCLC Utilization in Health Sciences Libraries

Patti Armes

Santa Cruz Room, Bonita Center

CE 562—Serials Selection and Management

Cheryl Rueby

Serrano Room, Sierra Center

CE 563—Monograph Selection, Acquisition, and Management

Nancy Woelfl

Palm Room, Sierra Center

CE 605—Human Factors in Library Administration

Neil Kelley

Regency Room, Sierra Center

CE 653—Writing for Publication

Gloria Werner

Santa Barbara Room, Bonita Center

CE 668—Clinical Librarianship (Section One)

Gretchen Naisawald

Santa Catalina Room, Bonita Center

CE 668—Clinical Librarianship (Section Two)

Julie Quain

Santa Rosa Room, Bonita Center

BACK BY POPULAR DEMAND

at Booth 64 ❀



Come visit us and learn how to gain immediate access to over 3,500 international biomedical journals. Also, ask about our training programs and user aids.

Members of our staff will be on hand to discuss new developments at Excerpta and customer service matters of concern to you.

❀ **Enter the Excerpta Medica beach towel drawing to be held 3 times daily.**



EXCERPTA MEDICA
P.O. Box 3085
Princeton, New Jersey 08540
(609) 896-9450

You've made us # 1



...and you've told us why

CUMULATIVE INDEX TO NURSING & ALLIED HEALTH LITERATURE

Comprehensive, up-to-date coverage of nursing, allied health, health care, and popular journals. Indexes most nursing journals, primary journals for 11 allied health disciplines, pertinent material from 2,600 biomedical journals indexed in *Index Medicus*, relevant articles from popular journals. Lists book reviews, pamphlets, audiovisuals. Current service—5 bimonthlies plus annual cumulation.

"CINAHL is invaluable, accurate, comprehensive."

—Librarian

easiest to use. Highly readable, provides clues to speed research, explains unclear titles, informative "how-to" section.

"The index is easy to read. . . the scope notes and numerous cross references. . . greatly facilitate its use." —Librarian

Helps you help patrons. Offers informative "how-to" audiovisual for only \$20; Desk copy of List of Subject Headings and Cross References for only \$5; Back volumes —now at 30% off; Copying service for obtaining copies of articles not readily available.

For information about our services, or to obtain a FREE sample bimonthly, write to CINAHL at the address below—or give us a call.

REGISTER FOR DRAWING AT BOOTH #7

Win a current CINAHL Subscription, "How-to" Audiovisual, List of Subject Headings and Cross References.



Cumulative Index to Nursing & Allied Health Literature (CINAHL)

Department J

P. O. Box 871

Glendale, CA 91209

Phone: (213) 240-2819

ad BB
JOB MARKET '82

**Workshops on Job-Hunting Strategies
Employment Opportunities for Health Sciences Librarians
Sponsored by the MLA Placement Service
William E. Maina, Coordinator
University of Texas Health Science Center Library, Dallas**

Saturday, June 12

5:15 p.m. — 5:55 p.m. Preparation of the Resume and Cover Letter
Magnolia Room B

Speakers: **Jo Anne Boorkman** and **Janis Apted**

6:00 p.m. — 6:40 p.m. Preparation for the Employment Interview
Magnolia Room B

Speakers: **Eleanor Goodchild**, **Carol Jenkins**,
Carolyn Lipscomb

Monday, June 14

8:00 a.m. — 8:40 a.m. Preparation of the Resume and Cover Letter (Repeat)
Magnolia Room A

Speakers: **Jo Anne Boorkman** and **Janis Apted**

12:45 p.m. — 1:30 p.m. Preparation for the Employment Interview (Repeat)
Magnolia Room A

Speakers: **Eleanor Goodchild**, **Carol Jenkins**,
Lorraine Schulte

Tuesday, June 15

7:30 a.m. — 8:00 a.m. Medical School and Special Library Employment
Opportunities
Magnolia Room A

Speakers: **Patti Armes** and **Michael Homan**

CANCERLINE

LET A COMPUTER
FIND CANCER INFORMATION
FOR YOU



You Can Quickly Search:

300,000 Abstracts from the
published cancer literature (CANCERLIT)

20,000 Descriptions of ongoing
cancer research projects (CANCERPROJ)

3,000 Summaries of experimental
cancer therapy protocols (CLINPROT)

ASK YOUR LIBRARIAN FOR DETAILS

A Service of the International Cancer
Research Data Bank — a program of the
National Cancer Institute



Visit us at booth no. 110

Tuesday, June 15 (continued)

10:00 a.m. – 10:30 a.m. Hospital, Clinical, and Circuit Librarian Employment Opportunities
Magnolia Room A

Speakers: **Jane Lambremont, Gale Hannigan, Leon Smigiel**

Wednesday, June 16

8:15 a.m. – 8:45 a.m. Federal Library Employment Opportunities and Practices
Magnolia Room A

Speakers: **Maxine Hanke and Donna Griffitts**

1:15 p.m. – 2:00 p.m. Opportunities for Professional Advancement and Professional Growth
Magnolia Room A

Options for Enriching Your Career as a Health Sciences Librarian: A Personal View

Speaker: **Nancy Lorenzi, Ph.D.**

How to Move into Library Management: A Personal View

Speaker: **Gloria Werner**

THE B/NA APPROVAL PLAN: TAILORED TO LIBRARY NEEDS, NOT BOOKSELLER LIMITATIONS.

You've probably heard about other new "controlled" or "efficient" approval plans. Actually they're similar to what our staff began with in 1965—approval plans with a limited selection of publishers. The theory? That they can cover roughly 90% of the publications of academic interest.

But 90% coverage isn't good enough for us. That additional 10% means at least 2,000 scholarly books per year which you miss.

In contrast, B/NA provides comprehensive services to academic and research libraries.

You receive all the approval books or announcements appropriate to your collection. Our subject thesaurus, with over 5,000 descriptors, systematically spans the universe of knowledge. Apply non-subject parameters as well, and tailor B/NA's Approval Plan precisely to your needs—not to ours.

Moreover, no other approval plan gives you B/NA's New Books Status Report. Updated and circulated monthly, it minimizes your uncertainties. The NBSR lists on microfiche all action taken on new books during the current and preceding year—on order, not published, treated, not appropriate and so on.

With the NBSR you get all the information we have on new books as soon as we have it.

Call your Regional Sales Manager or nearest distribution center toll free for details on how B/NA's Approval Plan gives you more.



BLACKWELL
Blackwell North America, Inc.

6024 S.W. Jean Road, Building G
Lake Oswego, Oregon 97034
Telephone (800) 547-6426

1001 Fries Mill Road
Blackwood, New Jersey 08012
Telephone (800)257-7341

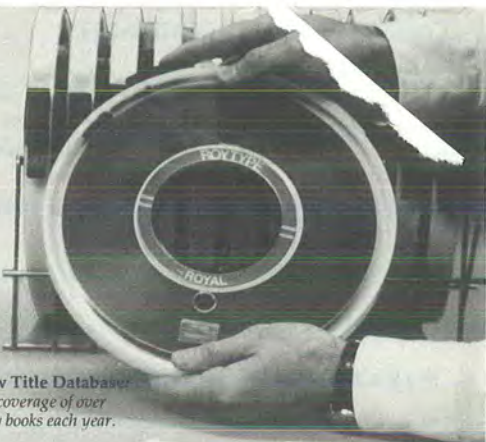

The B/NA New Title Database:
Comprehensive coverage of over 20,000 scholarly books each year.

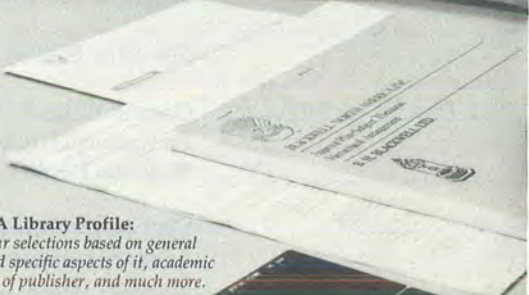

The B/NA Library Profile:
Makes your selections based on general subject and specific aspects of it, academic level, type of publisher, and much more.



The monthly B/NA New Books Status Report: Gives you instant access on fiche to our actions on all new titles for the current and preceding year.

OFFICES IN: OXFORD, ENGLAND; LAKE OSWEGO, OREGON; BLACKWOOD, NEW JERSEY; NOVATO, CALIFORNIA; LONDON, ONTARIO, CANADA; HOUSTON, TEXAS; BOSTON, MASSACHUSETTS; ATLANTA, GEORGIA; MINNEAPOLIS, MINNESOTA; CANBERRA, AUSTRALIA AND FREIBURG, WEST GERMANY.

UNOFFICIAL MEETINGS AND EVENTS

The following is a list of meetings and events which are being held in conjunction with, but are not part of the Official 1982 MLA Annual Meeting Program:

Sunday, June 13

9:00 a.m. – 5:00 p.m.

BRS Introductory Training Magnolia Room A, Magnolia Center

9:00 a.m. – 5:00 p.m.

BRS: MeSH Training Magnolia Room B, Magnolia Center

Monday, June 14

12:30 p.m. – 2:00 p.m.

MARCIVE Users Meeting Santa Catalina Room, Bonita Center

Friday, June 18

9:00 a.m. – 4:00 p.m.

Commonwealth Agricultural Bureaux:

CAB Abstracts Online Workshop Inn at the Park Hotel Garden Room

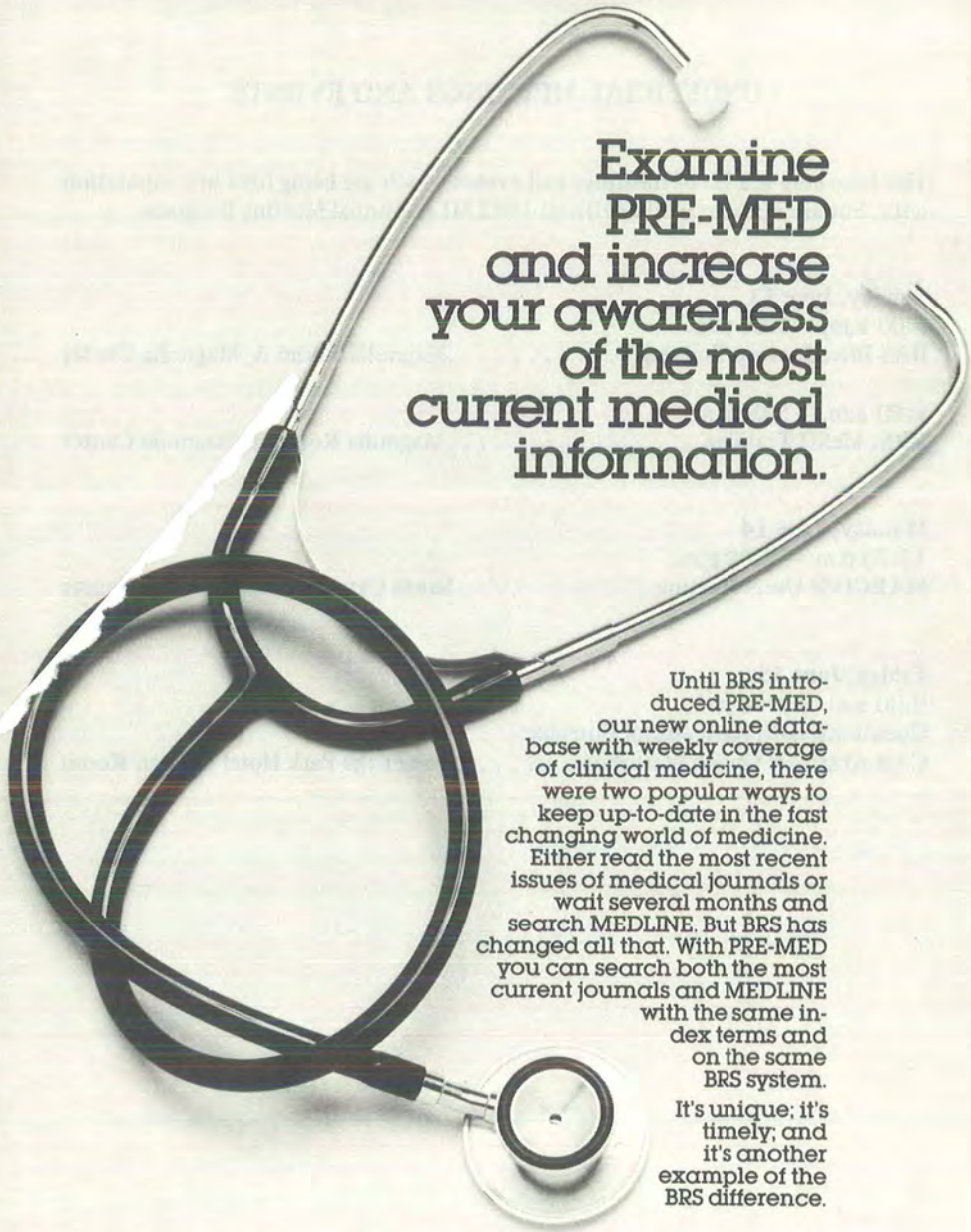

**Examine
PRE-MED
and increase
your awareness
of the most
current medical
information.**

Until BRS introduced PRE-MED, our new online database with weekly coverage of clinical medicine, there were two popular ways to keep up-to-date in the fast changing world of medicine. Either read the most recent issues of medical journals or wait several months and search MEDLINE. But BRS has changed all that. With PRE-MED you can search both the most current journals and MEDLINE with the same index terms and on the same BRS system.

It's unique; it's timely; and it's another example of the BRS difference.

BRS

BIBLIOGRAPHIC RETRIEVAL SERVICES, INC.

Corporate Headquarters: 1200 Route 7, Latham, New York 12110 • (800) 833-4707

Telephone: (518) 783-1161

Denver, Colorado • Philadelphia, Pennsylvania

• Raleigh/Durham, North Carolina • Washington, D.C.

82ND ANNUAL MEETING
OFFICIAL PROGRAM

Pre-Conference

Wednesday, June 9

8:30 a.m. — 5:00 p.m. Board of Directors Committee Meetings
Cerritos Room, Sierra Center

Thursday, June 10

8:30 a.m. — 5:00 p.m. Board of Directors Meeting
Presiding: **Charles W. Sargent, Ph.D.**
Cerritos Room, Sierra Center

7:00 p.m. — 7:30 p.m. Continuing Education Courses
Instructors Orientation
Yorba Room, Sierra Center

Friday, June 11

8:30 a.m. — 5:00 p.m. Board of Directors Meeting
Presiding: **Charles W. Sargent, Ph.D.**
Cerritos Room, Sierra Center

8:30 a.m. — 5:00 p.m. Continuing Education Courses
See page 23.

7:00 p.m. — 7:30 p.m. Continuing Education Courses Instructors
Orientation
Orange Room, Sierra Center

Saturday, June 12

8:30 a.m. — 5:00 p.m. Board of Directors Meeting
Presiding: **Charles W. Sargent, Ph.D.**
Cerritos Room, Sierra Center

Saturday, June 12 (continued)

- 8:30 a.m. — 5:00 p.m. Continuing Education Courses
See page 23.
- 5:15 p.m. — 6:40 p.m. Job Market '82
See page 31.
- 5:30 p.m. — 7:00 p.m. 1983 National Program Committee
"How To" Sessions: Informative session on
chairing meetings and editing library newsletters.
Magnolia A, Magnolia Center
- 5:30 p.m. — 7:00 p.m. Informal Meeting
Hospital Libraries Section
Executive Board Meeting
Regency Room, Sierra Center
- 7:00 p.m. — 7:30 p.m. Continuing Education Courses Instructors
Orientation
Orange Room, Sierra Center

Sunday, June 13

- 8:30 a.m. — 5:00 p.m. Continuing Education Courses
See page 23.
- 9:00 a.m. — 5:00 p.m. **COMMITTEE MEETINGS**
- Certification Examination Review (I)
Chair: **Susan L. Gullion**
Olympic Room, Sierra Center
- Publication Panel
Chair: **Virginia H. Holtz**
Villa 15, Garden Buildings
- RML Directors
Chair: **Lois Ann Colaiani**
Embassy East, Embassy Center
- 10:00 a.m. — 4:00 p.m. Pasadena/Huntington Library Art Museum and
Botanical Gardens Tour

Sunday, June 13 (continued)

- 10:00 a.m. — 4:00 p.m. Early California Tour
- 12:00 p.m. — 10:00 p.m. Disneyland Park: MLA '82
Private Party
- 5:15 p.m. — 5:45 p.m. Welcome Tea for New Members, International
Visitors, and First-time Attendees
Magnolia C, Magnolia Center
- Chair: **E. Louisa Worthington**, Subcommittee on
New Member/International Visitor Reception,
International Cooperation Committee
- 5:30 p.m. — 7:00 p.m. Informal Meeting
Hospital Libraries Section
Villa 15, Garden Buildings
- 5:45 p.m. — 6:30 p.m. Orientation for New Members, International Visitors,
and First-time Attendees
Magnolia C, Magnolia Center
- Chair: **Nidia T. Scharlock**, Subcommittee on New
Members, International Visitors, and First-time
Attendees Orientation, Membership Committee
- 6:30 p.m. — 7:30 p.m. Welcome Reception
Villa Lawn
- 7:30 p.m. — 10:00 p.m. Disneyland Park: MLA '82 Private Party

Conference

Monday, June 14

- 7:00 a.m. — 9:00 a.m. **COMMITTEE MEETINGS**
- Bylaws
Chair: **Jacqueline L. Picciano**
San Clemente Room, Bonita Center

Monday, June 14 (continued)

7:00 a.m. – 9:00 a.m. Committee Meetings (continued)

Certification Eligibility

Chair: **Virginia Lantz Algermissen**

Palm Room, Sierra Center

Continuing Education (I)

Chair: **Martha Jane K. Zachert, D.L.S.**

Yorba Room, Sierra Center

Copyright

Chair: **Albert M. Berkowitz**

Alamitos Room, Sierra Center

Exchange (I)

Chair: **Joan S. Zenan**

Regency Room, Sierra Center

Handbook of Medical Library Practice: Volume
III Chapter Authors

Chair: **Louise Darling**

Santa Cruz Room, Bonita Center

International Cooperation

Chair: **Sally Peterson**

Cerritos Room, Sierra Center

MLA/HeSCA Joint Committee to Develop
Guidelines for Audiovisual Facilities in Health
Sciences Libraries (I)

Chair: **Gloria Holland**

Sierra Room, Sierra Center

1983 National Program (I)

Chair: **Richard A. Lyders**

Orange Room, Sierra Center

1984 National Program

Chair: **Charles R. Bandy**

Olympic Room, Sierra Center

Monday, June 14 (continued)

7:00 a.m. – 9:00 a.m. Committee Meetings (continued)

Program and Convention (I)

Chair: **Jeanne G. Mueller**

Serrano Room, Sierra Center

Research and Evaluation (I)

Chair: **Erika Love**

Balboa Room, Sierra Center

Rittenhouse Award Subcommittee

Chair: **Carolyn E. Lipscomb**

Santa Barbara, Bonita Center

8:00 a.m. – 8:40 a.m. Job Market '82

See page 31.

9:00 a.m. – 9:30 a.m. **OPENING SESSION**

Grand Ballroom, Convention Center

Presiding: **Charles W. Sargent, Ph.D.**, President,
Medical Library Association

Welcome: **Alison Bunting**, Chair, 1982 National
Program Committee

Phyllis S. Mirsky, Associate Chair, 1982 National
Program Committee

Greetings from Disneyland

9:30 a.m. – 10:30 a.m. **KEYNOTE ADDRESS**

Introduction:

Nelson J. Gilman, Director, Norris Medical
Library, University of Southern California,
Los Angeles

Monday, June 14 (continued)

9:30 a.m. – 10:30 a.m. Keynote Address (continued)

Speaker:

Lawrence Weed, M.D., Professor of Medicine,
PROMIS Laboratory, University of Vermont,
Burlington

*Coupling the Best Thinking in an Area to Everyday
Action: What is the Library's Role?*

10:30 a.m. – 11:00 a.m. BREAK AND EXHIBIT OPENING

11:00 a.m. – 12:30 p.m. **INVITED PAPERS SESSIONS I-III**

**SESSION I: ONLINE TECHNICAL SERVICES
FILES: IMPLEMENTATION AND APPLICATIONS**
Center Ballroom, Convention Center

Moderator:

Phyllis S. Mirsky, Assistant University Librarian,
Sciences, University of California, San Diego,
La Jolla

Speakers:

Neal K. Kaske, Ph.D., Director, Office of Research,
OCLC, Dublin

*Online Public Catalogs: Research Findings and
Implications*

An overview of current research projects studying the use of online public access catalogs is reported. These research efforts are funded in part by the National Science Foundation, The Council on Library Resources, and OCLC Online Computer Library Center. Data for these projects have been collected at more than 25 library systems throughout the United States. The methodologies used in these studies and preliminary findings are presented. The impact of the findings on online public access catalogs and technical services is offered.

Monday, June 14 (continued)

11:00 a.m. — 12:30 p.m. Invited Papers Session I (continued)

Nancy Gwinn, Associate Director of Program
Coordination, Research Libraries Group, Stanford

Online Support for the RLG Collection Management and Development Program

The Research Libraries Group, Inc. (RLG) has established a Collection Management and Development Program, several components of which are supported online through RLIN (Research Libraries Information Network), RLG's computerized bibliographic system. The RLIN Acquisitions Subsystem allows members to share information on both positive and negative selection decisions, particularly with regard to expensive items and serials. The subsystem also provides a mechanism for "petitioning" members to secure information about items under consideration for purchase and about serials cancellations. Management reports of use to collection development officers will soon be available.

Data for the RLG Conspectus, a tool for surveying and analyzing collection strengths and weaknesses in member libraries, is currently produced by central staff through a SPIRES program. Development work is under way to convert the Conspectus data into an online, interactive file that can be searched by institution, subject, and collection level. The Association of Research Libraries is considering adoption of the Conspectus for use by the entire ARL membership.

T. Daniel Tonkery, Associate University Librarian,
Technical Services and Bibliographic Products,
University of California, Los Angeles

Online Serials Processing Control Systems: Status, Problems, and Future Options

Since the early 1930's the library community has been experimenting with mechanized support of

Monday, June 14 (continued)

11:00 a.m. – 12:30 p.m. Invited Papers Session I (continued)

library processing functions. After nearly 50 years of automation projects, the library community has accepted automation in support of circulation, acquisitions, cataloging, and database services. Today's library has the potential to utilize online systems to support much of the traditional house-keeping functions in technical services. The bibliographic utilities provide each library with access to enormous bibliographic resources, the circulation vendors provide minicomputer-based systems which support multiple applications.

With all the technological achievements, all the software development, and practical experience with library automation, most libraries still lack a fully automated serials control system that performs check-in, claiming, binding, and invoice control. Current developments at a number of organizations may offer some support for automated serials control. A selected number of these options will be discussed along with an identification of implementation problems.

Brian Nielsen, Head, Reference Department,
Northwestern University Library, Evanston

An Unfolding, Not an Unveiling: The Ongoing Process of Creating an Online Public Catalog

A theoretical framework developed out of public policy research is used to shed light on the problem of preparing library staff and users for the introduction of an online catalog. The framework, a process model of innovation, suggests that to think of an online catalog as simply a new format for a catalog previously on cards is a serious mistake. For a library to respond creatively to the impending introduction of an online catalog, it is important for management to seek wide participation in the innovation process, including the drawing in of public services staff and even users into the creative

Monday, June 14 (continued)

11:00 a.m. – 12:30 p.m. Invited Papers Session I (continued)

effort. Some experiences of libraries which are now working with online catalogs are described to illustrate the breadth of change which may occur with this technological innovation.

SESSION II: EXPANDED ROLES FOR HOSPITAL LIBRARIANS

North Ballroom, Convention Center

Moderator:

Marilyn Schwartz, Chief Librarian, Thompson Medical Library, Naval Regional Medical Center, San Diego

Speakers:

Jane Belt, Medical Librarian and Coordinator of Continuing Education, Central Washington Hospital, Wenatchee

With the growth of hospital libraries to serve all hospital employees in their departmental, clinical, and educational training as well as continuing education needs, the hospital librarian has found an expanded role beyond clinical research for the physician. This role permits one to be an integral part of the organization supporting all those who care for the patient. At Central Washington Hospital in Wenatchee, Washington, the need for coordination of hospital-wide education meshed well with the education, experience and skill of the medical librarian. Therefore, with the combining of these two departments, the hospital has made a cost savings in office space, personnel, and resources. The librarian has gained input into the real needs of the departments and physicians and provides an on-target collection as well as a perception of future resource needs.

Monday, June 14 (continued)

11:00 a.m. — 12:30 p.m. Invited Papers Session II (continued)

Patricia L. Thibodeau, Director of Health Sciences Information Center and Research Administrator, Women and Infants Hospital of Rhode Island, Providence

Research duties were added to the job of the Health Sciences Information Center Director as a result of the former Director's interest in the federal regulations governing research. Administration recognized that the ability to locate and organize information is inherent to the development of research administration policy and procedures. Furthermore, it was a logical extension of the librarian's current job of providing the researchers with the data necessary to develop their projects.

The Director's position involves the basic duties of organizing Research Committee meetings, maintaining files and records, and answering correspondence. The Director must also ensure the researcher's and institution's compliance with state and federal regulations governing human and animal research. This means that ponderous regulations must be interpreted, summarized and translated; and then must be transformed into institutional policies and procedures. In order to ensure compliance, the Director must often work closely with researchers from the inception to the conclusion of the project. Funding, approval and acceptability of results may be dependent upon compliance.

The dual role permits one to see the direction of the research programs and therefore, to anticipate future information needs. It emphasizes the importance of the library in research and enhances the librarian's role as a resource in research.

Monday, June 14 (continued)

11:00 a.m. – 12:30 p.m. Invited Papers Session II (continued)

Rosemarie Taylor, Director of Library Services,
Wilkes-Barre General Hospital, Wilkes-Barre

This presentation focuses on one librarian's experience in administrative functions outside the traditional library role in the hospital. Included will be a description of the librarian's duties in helping revise personnel policies, investigating sick time use in the hospital and creating an incentive policy, helping reorganize the employee health service, and participating in the establishment of the hospital's day care center. The impact participation in these functions has had on library service in the hospital will also be discussed.

Nardina L. Nameth, Director, Department of
Library and Audiovisual Services, Henry Ford
Hospital, Detroit

The desire of hospital administrators to consolidate educational support services has led in many cases to the librarian accepting responsibility for the audiovisual production unit in hospitals. At Henry Ford Hospital in Detroit, Michigan, this arrangement has been in effect since April, 1979. The challenges of a dual responsibility, managing a creative enterprise and the realities and issues of photographic, film and video production management will be discussed.

SESSION III: SELECTED ISSUES IN DRUG INFORMATION

Sponsored by the Pharmacy and Drug Information
Section

South Ballroom, Convention Center

Moderator:

David Morse, Technical Services Librarian,
Norris Medical Library, University of Southern
California, Los Angeles

Monday, June 14 (continued)

11:00 a.m. – 12:30 p.m. Invited Papers Session III (continued)

Speakers:

Bonnie Snow, Information Specialist, Lockheed Information Systems, Arlington

Online Database Coverage of Pharmacy Periodicals

Published journal lists for individual computerized files often do not indicate degree of coverage (i.e., cover-to-cover, selective, rush-priority, etc.); nor are such lists readily available for many databases or categorized by subject area. *Ulrich's* and other reference tools, as well as many journal editors, provide indications of indexing coverage, but such listings are incomplete and generally focus on well-known hardcopy services, neglecting newer online resources or those which have no print equivalent. This paper will describe an attempt to identify core journals in the pharmaceutical and drug information subject area, and a subsequent statistical analysis of online database coverage of these core journals in the past three years. Discussion will include comparisons regarding lag time, depth of indexing, English language coverage, and overlap.

Terry Ann Jankowski, Reference Librarian, Health Sciences Library, University of Washington Libraries, Seattle

Drug Information for the Layman

Medical librarians are frequently asked for information about drugs by the general public. These library users create problems in conducting the reference interview because of their reluctance to specify their needs and their lack of medical knowledge. Finding sources of information written at their level of sophistication is difficult. This paper explores some of the commonly asked questions and appropriate sources for answering them.

Monday, June 14 (continued)

11:00 a.m. – 12:30 p.m. Invited Papers Session III (continued)

Gregory A. Thompson, Pharm. D., Drug Information Center, Los Angeles County/USC Medical Center

Review of Drug Information Services in a Drug Information Center

Drug information centers have been developed to meet the need for quick and accurate drug information in the hospital setting. The Drug Information Center (DIC) of the Los Angeles County/USC Medical Center is co-directed by a pharmacist and a physician and is operated daily by two staff pharmacists and a secretary. The DIC is available for health professionals from the Medical Center and also takes calls from throughout Southern California. The DIC's primary job is to act as a quick reference to answer patient care questions related to drugs and drug therapy. It is also involved in the Medical Center's Drug Utilization Review Program. This presentation will provide an introduction to the information services provided by DIC's and discuss the complementary roles of DIC's and libraries in the provision of drug information.

Eileen Eandi, Public Services Librarian, Norris Medical Library, Health Sciences Campus, University of Southern California, Los Angeles

Online Retrieval of Drug Abuse Information

This paper will discuss the selection of appropriate databases and the formulation of optimum search strategies for retrieving references on five areas of drug abuse: 1) health effects, 2) treatment, 3) education and prevention, 4) sociocultural aspects, and 5) epidemiology. The abuse of both legal and illegal drugs will be covered. Alcoholism and smoking, as aspects of the broader field of substance abuse, will also be considered. Terminology inconsistencies which often make it difficult to distinguish between drug and substance abuse, and physical and

Monday, June 14 (continued)

11:30 a.m. — 12:30 p.m. Invited Papers Session III (continued)

psychological dependency will be identified. Databases to be discussed and compared include Medline, Drug Info, Excerpta Medica, Psychological Abstracts, ERIC, Social Science Citation Index and BIOSIS.

12:30 p.m. — 2:00 p.m. LUNCH

MLA Board/Incoming Committee Chairs' Luncheon
Pacific Room, Sierra Center

12:30 p.m. — 2:00 p.m. Informal Meeting
National Library of Medicine: NLM
Online Users Meeting
North Ballroom, Convention Center

12:45 p.m. — 1:30 p.m. Job Market '82. See page 31.

2:00 p.m. — 3:30 p.m. SECTION MEETINGS

CANCER LIBRARIANS SECTION

Panel Presentation

Cancer Information: The State of the Art
Cerritos Room, Sierra Center

Moderator:

Ann P. Hutchinson, Library Director, Roswell
Park Memorial Institute, Buffalo

Speakers:

Marie Harvin, Research Medical Librarian, M.D.
Anderson Hospital and Tumor Institute, University
of Texas System Cancer Center, Houston
*The Growth of Cancer Literature Since the Passage
of the National Cancer Act of 1971*

Janet L. Erickson, Cancer Information Specialist,
Biomedical Library, University of California, Los
Angeles
*The UCLA Biomedical Library Cancer Information
Service*

Monday, June 14 (continued)

2:00 p.m. — 3:30 p.m. Cancer Librarians Section Meetings (continued)

Sherril O. Sorrentino, Director for Public Education,
Division of Cancer Control, UCLA Jonsson
Comprehensive Cancer Center
Consumer Health Information Resources on Cancer

Sourya Henderson, Ph.D., Medical Librarian,
American Cancer Society Library, New York
The American Cancer Society Library

Gayle J. Ablove, Senior Librarian for Acquisitions
and Cataloging, Roswell Park Memorial Institute,
Buffalo
*Holdings of Monographic Cancer Literature for
Health Professionals in New York State*

HEALTH SCIENCES AUDIOVISUAL SECTION
Panel Presentation

Health Education: New Technologies, Databases,
and Materials
Balboa Room, Sierra Center

HISTORY OF THE HEALTH SCIENCES SECTION

Speaker and Business Meeting
Palm Room, Sierra Center

Carolyn Tilley, Head, MEDLARS Management
Section, National Library of Medicine, Bethesda
NLM HISTLINE Overview

MEDICAL LIBRARY EDUCATION SECTION

Program and Business Meeting
Research and the Medical Librarian
South Lounge, Convention Center

Moderator:

Gale Dutcher, Systems Librarian, Circulation
and Control, National Library of Medicine,
Bethesda

Monday, June 14 (continued)

2:00 p.m. — 3:30 p.m. Medical Library Education Section
(continued)

Speakers:

Sherrilynne Shirley Fuller, Associate Director,
Norris Medical Library, University of Southern
California, Los Angeles

Kenneth H. Plate, Associate Professor, School of
Library and Information Management, University
of Southern California, Los Angeles

Judy Wanger, Vice President, Cuadra Associates,
Santa Monica

Deborah Graham, Librarian, Sacred Heart General
Hospital, Eugene

MILITARY MEDICAL LIBRARIANS SECTION
Business Meeting
Serrano Room, Sierra Center

RELEVANT ISSUES SECTION
Program and Business Meeting
Holistic Health and Beyond
Yorba Room, Sierra Center

Moderator:

Joyce Loepprich, Serials Librarian, Biomedical
Library, University of California, Irvine

Speakers:

Edward Taub, M.D., F.A.A.P.
Barbara Taub, R.N., B.S.N., P.H.N., H.F.
Institute for Health Facilitation, Irvine

VETERINARY MEDICAL LIBRARIES SECTION
Program and Business Meeting
Sierra Room, Sierra Center

Monday, June 14 (continued)

2:00 p.m. – 3:30 p.m. Veterinary Medical Libraries Section
(continued)

Speaker:

J.F. Smithcors, D.V.M., Ph.D., Editor, American
Veterinary Publications, Santa Barbara
Collecting and Writing in Veterinary Medical History

3:30 p.m. – 4:00 p.m. Visit the Exhibits

4:00 p.m. – 5:30 p.m. **CONTRIBUTED PAPERS SESSION**

SESSION I:

Center Ballroom, Convention Center

Moderator:

Justine Roberts, The Library, University of
California, San Francisco

4:00 p.m.

*Beyond Bibliophiles to Electronic Information
Managers with the Aid of Minicomputers: The
Changing Role of Librarians*

Naomi C. Broering, MLS, MA, Medical Center
Librarian

Bonnie G. Cannard, MLS, Assistant Librarian/
Resource and Technical Services

Alan E. Zuckerman, MD, Director, Library
Computer Services

Walter Bechtold, DDS, Computer Consultant

Georgetown University Medical Center, Washington

4:18 p.m.

*Development of an Online Acquisitions System
through Use of a Database Management System*

Monday, June 14 (continued)

4:00 p.m. — 5:30 p.m. Contributed Papers Session I (continued)

Bonnie G. Cannard, MLS, Assistant Librarian/
Resource and Technical Services

Naomi C. Broering, MLS, MA, Medical Center
Librarian

Pamela M. Lee, MLS, MA, Acquisitions/Serials
Librarian

Alan E. Zuckerman, MD, Director, Library
Computer Services

Georgetown University Medical Center, Washington

4:36

*Online Integrated Library System: Bibliographic
Access and Control System of Washington University
School of Medicine Library*

Susan Crawford, Ph.D., Director

Elizabeth A. Kelly, Head, Access Services

Deborah K. Yedlin, Head, Technical Services

Washington University, School of Medicine Library,
St. Louis

4:54 p.m.

*Computer Automation in the Information Center of
a Pharmaceutical Company*

Kathleen Syverson, Information Analyst

Marlene Galante Kozak, Manager, Information
Services

Ronald Schwartz, Ph.D., Director, Scientific Affairs

American Critical Care, McGraw Park

5:12 p.m.

*Use of a Local Online System (NOTIS) in a Health
Sciences Library*

Anton J. Olson, Head Catalog Librarian, Northwestern
University, Medical School Library, Chicago

Monday, June 14 (continued)

4:00 p.m. — 5:30 p.m. Contributed Papers Sessions (continued)

SESSION II:

South Ballroom, Convention Center

Moderator:

Ellen Nagle, Health Sciences Library, Columbia University, New York

4:00 p.m.

PR Methods for Introducing MEDLINE

Linda Plunket, Project Coordinator

Rayna Bowlby Genetti, Project Director

Maryanne Greven, Project Librarian

Central Maine Medical Center, Lewiston

4:18 p.m.

MEDLINE at BRS, DIALOG, and NLM: Is There a Choice?

Susan Feinglos, Online Coordinator, Duke Medical Center Library, Durham

4:36 p.m.

Using a Minicomputer to Manage Bibliographies Obtained from MEDLINE Searches

Alan E. Zuckerman, MD, Director, Library Computer Services

Helen E. Bagdoyan, MLS, Assistant Librarian for Public Information Services

Bonnie G. Cannard, MLS, Assistant Librarian for Resource and Technical Services

Naomi C. Broering, MLS, MA, Medical Center Librarian

Georgetown University Medical Center, Washington

PROGRAM

Monday, June 14

Registration 8:00 am - 4:00 pm
Hospitality 8:00 am - 5:00 pm
Placement 8:30 am - 4:30 pm
Exhibits 10:30 am - 5:00 pm
7:30 pm - 9:30 pm

7:00 am - 9:00 am
Committee Meetings

9:00 am - 9:30 am
Opening Session

9:30 am - 10:30 am
Keynote Address
N.J. Gilman, L. Weed, M.D.

11:00 am - 12:30 pm
Invited Papers Session I-III

2:00 pm - 3:30 pm
Section Meetings

4:00 pm - 5:30 pm
Contributed Papers Session

5:30 pm - 7:00 pm
Chapter Council Meeting
Section Council Meeting

7:30 pm - 9:30 pm
Exhibitors' Cocktail Party

Tuesday, June 15

Registration 9:00 am - 4:00 pm
Hospitality 8:30 am - 4:30 pm
Placement 8:30 am - 5:00 pm
Exhibits 10:00 am - 5:00 pm

8:00 am - 9:30 am
Business Meeting I

9:30 am - 10:00 am
Presidential Address
C.W. Sargent, Ph.D.

10:30 am - 12:30 pm
General Session I:
Implications for Libraries in
Changing Medical Information
Systems
**R.K. Goldstein, H.S. Buchanan,
W.G. Cooper, Ph.D., V. Holtz,
N.W. Matheson, W.D. Mayer, Ph.D.**

2:00 pm - 3:00 pm
Janet Doe Lecture
U.H. Poland

3:00 pm - 5:00 pm
Poster Session

4:00 pm - 6:00 pm
Chapter Council Meeting
Section Council Meeting
Committee Meetings

4:00 pm - 11:00 pm
Tours and Dinners

7:30 pm - 9:00 pm
Section Meeting

SYNOPSIS

Wednesday, June 16

Registration 9:00 am - 4:00 pm
Hospitality 8:30 am - 3:00 pm
Placement 8:30 am - 4:30 pm
Exhibits. 10:00 am - 5:00 pm

7:00 am - 9:00 am
Committee Meetings

9:00 am - 10:30 am
Contributed Papers Session

10:30 am - 2:00 pm
Section Meetings

2:00 pm - 3:30 pm
General Session II
Preparing for Technological Change
in Information Transfer
A. Bunting, J. Shannon,
F. Williams, R.M. Hayes

4:00 pm - 5:00 pm
Dialog with MLA/NLM Leadership
C.W. Sargent, Ph.D.,
M.M. Cummings, M.D.

5:00 pm - 6:30 pm
Committee Meetings

7:00 pm - 11:00 pm
Honors and Awards and Banquet

Thursday, June 17

Registration 9:00 am - 12:00 pm
Hospitality 8:30 am - 12:00 pm
Placement 8:30 am - 4:30 pm
Exhibits. 10:00 am - 12:00 pm

7:00 am - 9:00 am
Committee Meetings

9:00 am - 10:30 am
Business Meeting II

10:30 am - 11:00 am
Inaugural Address
N.M. Lorenzi, Ph.D.

11:30 am - 1:00 pm
Section Meetings

2:00 pm - 3:30 pm
Invited Papers Sessions IV-V

4:00 pm - 5:00 pm
Joint Chapter and Section Council

Monday, June 14 (continued)

4:00 p.m. — 5:30 p.m. Contributed Papers Session II (continued)

4:54 p.m.

Online Search Quality: A Process of Peer Evaluation

Diane L. Glunz, Search Analyst

Eileen Wakiji, Search Analyst

Norris Medical Library, University of Southern
California, Los Angeles

5:12 p.m.

*Cerebral Vascular Accident or Stroke? Indexing
Consumer Health Information*

Judi Dover DeCarme, Database Manager

Joanne Angle, Project Director

National Health Information Clearinghouse,
Washington

SESSION III:

North Ballroom, Convention Center

Moderator:

Joan S. Zenan, Savitt Medical Library, University
of Nevada, Reno

4:00 p.m.

Consumer Library Services for Those with Handicaps

Dorothy Gilroy, M. Ed., MSLS, Chief Research
Librarian, University Affiliated, Cincinnati Center
for Developmental Disorders, Cincinnati

4:18 p.m.

*The Hospital Library as a Focus of Patient Education
Activities and Resources*

Joan Fierberg, MLS, Formerly Patient Library
Information Service Librarian, Los Angeles County
Harbor-UCLA Medical Center Library

Monday, June 14 (continued)

4:00 p.m. — 5:30 p.m. Contributed Papers Session III (continued)

Mary Ann Berliner, MLS, Acting Director, Library Services, Los Angeles County Harbor-UCLA Medical Center Library

Eleanor Goodchild, MS, MLS, Director, Medical and Biological Sciences Library, University of Pennsylvania, Philadelphia

Marilouise Gil-Gomez, MLS, Assistant Director, Library Services, Los Angeles County Harbor-UCLA Medical Center Library

4:36 p.m.

Needs Assessment and Evaluation Studies in a Library Network: Resource Information Network for Cancer

Sherrill Sorrentino, Program Coordinator
Ann Mahony
Alfred Marcus
Eleanor Goodchild
Mary Ann Berliner

Jonsson Comprehensive Cancer Center, Division of Cancer Control, University of California, Los Angeles

4:54 p.m.

Health Questions Consumers Ask

Jory H. Barone, Manager, Information Services
Joanne G. Angle, Project Director

National Health Information Clearinghouse,
Washington

5:12 p.m.

Development of a Consumer Health Information Pamphlet Library on Microfiche

Monday, June 14, (continued)

4:00 p.m. — 5:30 p.m. Contributed Papers Session III (continued)

Alan M. Rees, Case Western Reserve University,
Cleveland

Howard McGinn, Microfilming Corporation of
America (A New York Times Company)

Jodith Janes, Case Western Reserve University,
Cleveland

Pat Cook, Microfilming Corporation of America
(A New York Times Company)

SESSION IV:
Pacific Room, Sierra Center

Moderator:
Robin M. Rand, Health Science Library, Maine
Medical Center, Portland

4:00 p.m.
*Usage Study of Excerpta Medica Abstracting
Journals: To Drop or Not to Drop?*

Elaine C. Alligood, MLS, Head, Public Services
Elaine M. Russo, MSLS, Reference Librarian
Richard A. Peterson, MSLS, Head Reference
Librarian

The Claude Moore Health Sciences Library,
University of Virginia Medical Center, Charlottesville

4:18 p.m.
User Involvement in Journal De-selection

Suzanne Grefsheim, Associate Director and Chief of
Technical Services
Shelley Bader, Director
Pamela Meredith, Serials Librarian

Monday, June 14 (continued)

4:00 p.m. — 5:30 p.m. Contributed Papers Session IV (continued)

Paul Himmelfarb Library, George Washington
University Medical Center, Washington

4:36 p.m.

A Comparison of Recall Methods

Jo Ann Bell, Ph.D., Director

Donna B. Flake, Head of Reference

Health Sciences Library, East Carolina University,
Greenville

4:54 p.m.

*Bibliographic Instruction—A Public Relations
Perspective*

Diane G. Schwartz, Head, Reference/Information
Services Department Coordinator, User Education,
The Alfred Taubman Medical Library, The University
of Michigan, Ann Arbor

5:12 p.m.

*Bibliographic Instruction: Beginning a Program With
Limited Resources*

Rosanne Labree, Reference Librarian/Search Analyst,
Countway Library of Medicine, Harvard Medical
School, Boston

SESSION V:

Balboa Room, Sierra Center

Moderator:

Martha Fishel, National Library of Medicine,
Bethesda

4:00 p.m.

*Technical Services and Collection Development in
the Health Sciences Library*

Monday, June 14 (continued)

4:00 p.m. — 5:30 p.m. Contributed Papers Session V (continued)

David H. Morse, Technical Services Librarian,
Norris Medical Library, University of Southern
California, Los Angeles

4:18 p.m.

*A Comparison of CIP Versus Full Cataloging as
Obtained from NLM Proof Sheets*

Dianne Olson, Catalog/Acquisitions Librarian,
Library, Loyola University Medical Center, Maywood

4:36 p.m.

*Centralized Cataloging in a Hospital Library
Consortium*

Sandra Clevesy, Director of Library Services,
Framingham Union Hospital, Framingham

4:54 p.m.

*A SERLINE-Based Union List of Serials for Basic
Unit Libraries: A Detailed Protocol*

Christine L. Bell, Director of Library Services,
Newton-Wellesley Hospital, Consortium for
Information Resources, Newton Lower Falls

5:12 p.m.

*Tennessee Health Sciences Serials—1981; A State-
Wide Union List of Periodical Holdings*

Jan Hawkins, Librarian, Le Bonheur Children's
Medical Center, Health Sciences Library, Memphis

Mary King Givens, Head of Reference and
Interlibrary Loan, University of Tennessee, Center
for the Health Sciences Library, Memphis

Susan Selig, Librarian, Stollerman Branch of
University of Tennessee, Center for the Health
Sciences Library, Memphis

Monday, June 14 (continued)

- 5:30 p.m. — 7:00 p.m. Chapter Council Meeting
Chair: **Joan Ash**
Santa Cruz Room, Bonita Center
- Section Council Meeting
Chair: **Holly Shipp Buchanan**
Santa Barbara Room, Bonita Center
- 5:30 p.m. — 7:00 p.m. 1983 National Program Committee "How To"
Sessions: Informative Session on chairing meetings
and editing newsletters
- 5:30 p.m. — 7:00 p.m. Informal Meetings
- Consumer Health Information
Santa Catalina Room, Bonita Center
- Pediatric Libraries
Santa Rosa Room, Bonita Center
- PHILSOM Advisory Committee
Villa 15, Garden Buildings
- Reference Department Managers
Palm Room, Sierra Center
- Resources and Hospital Library Directors
Magnolia A, Magnolia Center
- Technical Services Section
San Clemente Room, Bonita Center
- 7:00 p.m. — 7:30 p.m. FREE TIME
- 7:30 p.m. — 9:30 p.m. Exhibitors' Cocktail Party
Exhibit Hall, Convention Center

Tuesday, June 15

- 7:00 a.m. — 8:00 a.m. **SECTION MEETING**
Hospital Library Section: Welcome Coffee Hour
Embassy East, Embassy Center
- 7:30 a.m. — 8:00 a.m. Job Market '82
See page 31.
- 8:00 a.m. — 9:30 a.m. **BUSINESS MEETING I**
Grand Ballroom, Convention Center
- Presiding: **Charles W. Sargent, Ph.D.**, President
- Introduction of MLA Parliamentarian
T. Mark Hodges
- Introduction of Tellers
- Introduction of Executive Director
Raymond A. Palmer
- Quorum and Registration Report
Raymond A. Palmer
- In Memoriam—A moment of silence for MLA
members who have died during the past year as
reported to Headquarters prior to April 15, 1982
Pamela S. Fry
Samuel Lazerow
Grayson B. Tabler
- New Member Recognition
Nancy M. Lorenzi, Ph.D., President-elect
- Greetings from Abroad
- Approval of minutes of 81st Annual Meeting,
Montreal, Canada
- REPORTS OF BOARD AND OFFICERS**
- President, Board of Directors and Executive
Committee: **Charles W. Sargent, Ph.D.**

Tuesday, June 15 (continued)

8:00 a.m.— 9:30 a.m. Business Meeting I—Reports of Board and Officers (continued)

Committee on Committees, Elections Committee:
Nancy M. Lorenzi, Ph.D.

Finance Committee: **Lucretia McClure**

Proposal for a dues increase: **Lucretia McClure**

Headquarters: **Raymond A. Palmer**

Editor of the *Bulletin of the Medical Library Association*: **Gloria Werner**

Editor of the *MLA News*: **Nancy Garn, Connie Poole**

Archivists: **William K. and Virginia L. Beatty**

Trustee: **Minnie Orfanos**

REPORTS OF COMMITTEES

Standing and Ad Hoc Committees are grouped according to their respective Board Liaisons. MLA Representatives' Reports now appear as part of their respective Standing Committee's Annual Report.

Jana Bradley, Board Liaison

Certification Eligibility: **Virginia Lantz Algermissen**, Chair

Certification Examination Review: **Susan L. Gullion**, Chair

Recertification: **Julie Blume Nye**, Chair

Status and Economic Interests of Health Sciences Library Personnel: **Toby G. Port**, Chair

Ad Hoc Committee to Examine the Certification and Recertification Process: **Beatrix H. Robinow**, Chair

Tuesday, June 15 (continued)

8:00 a.m. — 9:30 a.m. Business Meeting I—Reports of Committees
(continued)

Naomi C. Broering, Board Liaison

Bulletin Consulting Editors Panel: **Gloria Werner**,
Chair

Exchange: **Joan S. Zenan**, Chair

Publication Panel: **Virginia H. Holtz**, Chair

Publishing and Information Industries Relations:

Joseph E. Jensen, Chair

Ad Hoc Committee for the International Exchange
and Redistribution of Library Materials: **Janis Sharp**,
Chair

Eloise C. Foster, Board Liaison

Audiovisual Standards and Practices: **Carmel C.**
Bush, Chair

Hospital Library Standards and Practices: **Rosalind**
F. Dudden, Chair

Interlibrary Loan and Resource Sharing Standards
and Practices: **Glenn Brudvig**, Chair

Research and Evaluation: **Erika Love**, Chair

MLA/HeSCA Joint Committee to Develop
Guidelines for Audiovisual Facilities in Health
Sciences Libraries: **Gloria Holland**, Chair

Gertrude Lamb, Ph.D., Board Liaison

National Program, 1982: **Alison Bunting**, Chair
Study Group on MLA's Role in the Educational
Process for Health Sciences Librarians: **Phyllis**
Mirsky, Chair

Nancy M. Lorenzi, Ph.D., Board Liaison

National Program Committee, 1984

Tuesday, June 15 (continued)

8:00 a.m. — 9:30 a.m. Business Meeting I—Reports of Committees
(continued)

Lucretia McClure, Board Liaison

Certification and Recertification Appeals Panel:

Lucretia McClure, Chair

Copyright: **Albert M. Berkowitz**, Chair

Legislation: **Lucile S. Stark**, Chair

Surveys and Statistics: **Ching-chih Chen**, Chair

Arlee May, Board Liaison

International Cooperation: **Sally Peterson**, Chair

Membership: **Rosanne Labree**, Chair

MLA/NLM Liaison: **Arlee May**, Chair

Scholarship and Grants: **Sally Pollak**, Chair

Judith Messerle, Board Liaison

Continuing Education: **Martha Jane K. Zachert**,
D.L.S., Chair

Honors and Awards: **Julia G. Pfau**, Chair

Janet Doe Lectureship Subcommittee: **Martha
Jane K. Zachert, D.L.S.**

Ida and George Eliot Prize Subcommittee: **Elizabeth
B. Davis**, Chair

Murray Gottlieb Prize Subcommittee: **Julie G. Pfau**,
Chair

Rittenhouse Award Subcommittee: **Carolyn E.
Lipscomb**, Chair

ISI Award Subcommittee: **Cecile Quintal**, Chair

Vital Notes Participatory Panel: **Don Potts**, Chair

Charles W. Sargent, Ph.D., Board Liaison

MLA/SLA Joint Committee

National Issues Advisory Council: **Charles W. Sargent**,
Ph.D., Chair

National Program, 1983: **Richard A. Lyders**, Chair

Tuesday, June 15 (continued)

8:00 a.m. — 9:30 a.m. Business Meeting I—Reports of Committees
(continued)

Ruth W. Wender, Board Liaison

Bylaws: **Jacqueline L. Picciano**, Chair
Editorial Committee for the *Bulletin*: **James
Shedlock**, Chair
Editorial Committee for the *MLA News*: **Lynda
Sanford**, Chair
Health Sciences Library Technicians: **Karen J.
Graves**, Chair
Oral History: **Nancy Whitten Zinn**, Chair
Ad Hoc Committee on Consumer Health
Information: **Ellen Gartenfeld**, Chair

REPORTS OF COUNCILS

Chapter Council: **Joan Ash**, Chair
Section Council: **Holly Shipp Buchanan**, Chair

9:30 a.m. — 10:00 a.m. Presidential Address

Charles W. Sargent Ph.D., Library of the Health
Sciences, Texas Tech University Health Sciences
Center, Lubbock

10:00 a.m. — 10:30 a.m. Visit the Exhibits

10:30 a.m. — 12:30 p.m. **GENERAL SESSION I:**
Grand Ballroom, Convention Center

Implications for Libraries in Changing Medical Information Systems

The role of the library in the context of changing information systems and technologies that are affecting academic health centers will be discussed. This interactive panel will review issues raised in the NLM-sponsored AAMC study from the perspectives of hospital and medical school libraries, senior administrators of health centers, and the NLM.

Tuesday, June 15 (continued)

10:30 a.m. — 12:30 p.m. General Session I (continued)

Moderator:

Rachael K. Goldstein, Health Sciences Librarian,
Health Sciences Library, Columbia University

Speakers:

Holly Shipp Buchanan, Director, Medical Library,
NKC Inc., Louisville

William G. Cooper, Ph.D., Acting Deputy Director
for Research and Education, National Library of
Medicine, Bethesda

Virginia H. Holtz, Director, University of Wisconsin,
Center for Health Sciences Libraries, Madison

Nina W. Matheson, M.L., Assistant Director, Health
Information Management Studies, Association of
American Medical Colleges, Washington

William D. Mayer, M.D., President, Eastern Virginia
Medical Authority, Norfolk

12:30 p.m. — 2:00 p.m. Lunch

MLA Board/Chapter and Section Chair's Luncheon
Pacific Room, Sierra Center

12:30 p.m. — 2:00 p.m. Informal Meetings

AHEC Group
Cerritos Room, Sierra Center

Bibliographic Instruction Group
Yorba Room, Sierra Center

Vision Librarians
Santa Rosa Room, Bonita Center

Tuesday, June 15 (continued)

1:00 p.m. — 2:00 p.m. Informal Meeting

PHILSOM Group
San Clemente Room, Bonita Center

2:00 p.m. — 3:00 p.m. JANET DOE LECTURE
Grand Ballroom, Convention Center

Introduction: **Robert G. Cheshire**, Director,
Cleveland Health Sciences Library, Janet Doe
Lecturer, 1981

Speaker:
Ursula H. Poland, Librarian and Professor of
Medical Library Science, Albany Medical College,
Janet Doe Lecturer, 1982
*Reflections on the Medical Library Association's
Activities*

3:00 p.m. — 5:00 p.m. POSTER SESSIONS
North Ballroom, Convention Center

Elaine C. Alligood, Head, Public Services, The Claude
Moore Health Sciences Library, University of
Virginia Medical Center, Charlottesville

Karen B. Higgins, Assistant Director, Program
Planning and Development, Welch Medical Library,
Johns Hopkins Medical Institutions, Baltimore

*A Novel Arrangement of Basic Reference Collections:
Out of Call Numbers and Into Logical Subject
Sections*

Mary Ann Berliner, MLS, Acting Director, Library
Services, Los Angeles County/Harbor-UCLA
Medical Center, Torrance

Marilouise Gil-Gomez, MLS, Assistant Director,
Library Services, Los Angeles County/Harbor-
UCLA Medical Center, Torrance

Tuesday, June 15 (continued)

3:00 p.m. — 5:00 p.m. Poster Sessions (continued)

The Patient Education Committee, an Effective Vehicle for Hospital Library Involvement

Jocelyn A. Bernholdt, Medical Librarian, Alexian Brothers Medical Center, Elk Grove Village

Moveable Shelf System Saves Space in a Medical Library

Regan De Franza, Librarian, Jeghers Medical Index Library, St. Elizabeth Hospital Medical Center, Youngstown

The Jeghers Medical Index Library; A Review

Eileen Emberson, Director, Library Services, Luther Hospital, Eau Claire

Hospital Based Health Information Center

Dorothy Gilroy, M.Ed., MSLS, Cincinnati Center for Developmental Disorders, Cincinnati

Toy Library for Special Children

Maryanne Lamont Greven, Project Librarian, Central Maine Medical Center, Lewiston

Circuit Riding—Yankee Style

Karen T. Hackleman, Regional Developmental Coordinator, Midcontinental Regional Medical Library Program, Omaha

A. James Bothmer, Health Sciences Information Network Coordinator, University of Wyoming Science Library, Laramie

Riding the High Plains: Networking in Wyoming

Tuesday, June 15 (continued)

3:00 p.m. — 5:00 p.m. Poster Sessions (continued)

Patricia M. Hanley, Medical Librarian, Bess Kaiser Medical Center, Portland

Library Newsletters

Gale G. Hannigan, Coordinator for Physician Services, Houston Academy of Medicine-Texas Medical Center Library, Houston

Organizing Personal Reprint Files

Carol Jenkins, Associate Director, The Claude Moore Health Sciences Library, University of Virginia Medical Center, Charlottesville

Leonoor Ingraham, Director, Aubrey R. Watzek Library, Lewis and Clark College, Portland

Regional Legislative Action Networks Coast to Coast

Marilyn Anne Jensen, Coordinator, Library/Learning Resources Program, California Area Health Education Center System, Fresno

The California AHEC: Library/Learning Resources Program California Area Health Education Center System

Sue Ann Johnson, Medical Center Librarian
Jill Rowe, Branch Manager

UCSD Medical Center Library, San Diego

Robert Lewis, Biomedical Librarian, UCSD Biomedical Library, La Jolla

San Diego's Newest Hospital Library: An Architectural Poster

Tuesday, June 15 (continued)

3:00 p.m. — 5:00 p.m. Poster Sessions (continued)

Carol D. Kasses, Head, Access/Support Services,
Health Sciences Library, Columbia University

Joan S. Zenan, Director, Savitt Medical Library,
University of Nevada, Reno

*Columbia Health Sciences Library's Photocopy
Services: A Multifaceted Operation*

Joyce Loepprich, Co-Project Director, Serials
Librarian, Biomedical Library, University of
California, Irvine

Evelyn Simpson, Co-Project Director, Medical
Librarian, Western Medical Center, Santa Ana

*Librarians and Nurses as Partners: The Nursing
Information Consortium of Orange County*

Kenneth C. Lynn, DDS, MLS, Dental Research
Data Officer, National Institute of Dental Research,
Bethesda

Dental Research in Progress—A Source

William E. Maina, Assistant Director for Public
Services, University of Texas, Health Science Center
at Dallas Library, Dallas

Audiovisual Orientation to the UTHSCD Library

Nancy P. Merrick, Head, Reference Department,
McGoogan Library of Medicine, University of
Nebraska Medical Center, Omaha

*Marketing Audiovisual Services in a Health Sciences
Library*

Tuesday, June 15 (continued)

3:00 p.m. — 5:00 p.m. Poster Sessions (continued)

James H. Parrish, Editor, Illinois Health and Science Libraries Serial Holdings List, University of Illinois at the Medical Center, Library of the Health Sciences, Chicago

The Illinois Health and Science Libraries Serial Holdings List

Patty Powell, Director, Fayetteville AHEC Library, Fayetteville

Diane Foxman, North Carolina AHEC Audiovisual Liaison Librarian, Chapel Hill

The North Carolina Library/Learning Resource Center Network

Sherrill Sorrentino, Project Coordinator, Resource Information Network for Cancer, Division of Cancer Control, UCLA Jonsson Comprehensive Cancer Center, Los Angeles

Resource Information Network for Cancer (RINC)

Marcia Stephens, Director of Library Services, St. Luke's Hospitals, Fargo

Guidelines for A Regional Locator/Union List of Serials

Joan M. Stoddart, Reference Librarian, Spencer S. Eccles Health Sciences Library, The University of Utah, Salt Lake City

Medline Searching: A Comparison of Three Vendors

Karen Taylor, Program Coordinator, TALON RMLP
John Budrew, Head, Collection Development, Acquisitions, Serials

Tuesday, June 15 (continued)

3:00 p.m. — 5:00 p.m. Poster Sessions (continued)

University of Texas, Health Science Center at Dallas
Library, Dallas

A New-Employee Orientation Packet

4:00 p.m. — 6:00 p.m. CHAPTER COUNCIL MEETING

Chair: **Joan Ash**
Santa Cruz Room, Bonita Center

SECTION COUNCIL MEETING

Chair: **Holly Shipp Buchanan**
Santa Barbara Room, Bonita Center

COMMITTEE MEETINGS

Ad Hoc Committee for the International Exchange
and Redistribution of Library Materials (I)

Chair: **Janis Sharp**
Regency Room, Sierra Center

Ad Hoc Committee on Consumer Health
Information (I)

Chair: **Ellen Gartenfeld**
Santa Rosa Room, Bonita Center

Certification Examination Review (II)

Chair: **Susan L. Gullion**
Palm Room, Sierra Center

Editorial Committee for the *Bulletin*

Chair: **James Shedlock**
Santa Catalina Room, Bonita Center

Honors and Awards

Chair: **Julia G. Pfau**
Yorba Room, Sierra Center

Hospital Library Standards and Practices (I)

Chair: **Rosalind F. Dudden**
Pacific Room, Sierra Center

Tuesday, June 15 (continued)

4:00 p.m. — 6:00 p.m. **Committee Meetings (continued)**

Membership (I)

Chair: Rosanne Labree

Cerritos Room, Sierra Center

National Issues Advisory

Chair: Charles W. Sargent, Ph.D.

Serrano Room, Sierra Center

Program and Convention (II)

Chair: Jeanne G. Mueller

Sierra Room, Sierra Center

Surveys and Statistics

Chair: Ching-chih Chen

Alamitos Room, Sierra Center

4:00 p.m. — 11:00 p.m. **TOURS AND DINNER**

Tours of the Norris Medical Library, University of Southern California and dinner in Chinatown

Tour of the University of California, Irvine, Biomedical Libraries and dinner in Newport Beach

Tour of the University of California, Los Angeles, Biomedical Library and dinner in Westwood Village

6:00 p.m. — 8:00 p.m. **NEWPORT BEACH DINE-AROUND**

7:30 p.m. — 9:00 p.m. **SECTION MEETING**

**Veterinary Medical Libraries Section:
Informal Evening Meeting**

Wednesday, June 16

7:00 a.m. — 9:00 a.m.

COMMITTEE MEETINGS

Audiovisual Standards and Practices

Chair: **Carmel C. Bush**

Sierra Room, Sierra Center

Editorial Committee for the *MLA News*

Chair: **Lynda Sanford**

Santa Catalina Room, Bonita Center

Hospital Library Standards and Practices (II)

Chair: **Rosalind F. Dudden**

Santa Rosa Room, Bonita Center

Interlibrary Loan and Resource Sharing
Standards and Practices

Chair: **Patricia A. Jones**

Olympic Room, Sierra Center

Janet Doe Lectureship Subcommittee

Chair: **Martha Jane K. Zachert, D.L.S.**

Orange Room, Sierra Center

Legislation

Chair: **Lucile S. Stark**

Alamitos Room, Sierra Center

1983 National Program (II)

Chair: **Richard A. Lyders**

Serrano Room, Sierra Center

Scholarship and Grants

Chair: **Sally Pollak**

Cerritos Room, Sierra Center

Status and Economic Interests of Health Sciences
Library Personnel

Chair: **Toby G. Port**

Palm Room, Sierra Center

8:15 a.m. — 8:45 a.m.

Job Market '82

See page 31.

Wednesday, June 16 (continued)

9:00 a.m. – 10:30 a.m. **CONTRIBUTED PAPERS SESSION**

SESSION VI

Center Ballroom, Convention Center

Moderator:

Faith Meakin, Biomedical Library, University of California, San Diego

9:00 a.m.

Denver's Electronic Messaging System Utilizing A Microcomputer for the Purpose of Interlibrary Loan

Rosalind F. Dudden, Director of Library Services, Mercy Medical Center, Denver

Fred I. Dudden, President, Mile High Media, Denver

9:18 a.m.

OCTANET and the Electronic Medical Library Network

Millard F. Johnson, Jr., Head, Research and Technology, Washington University School of Medicine Library, St. Louis

9:36 a.m.

Current Update Exchange (CUE): An Electronic Communication System for the Medical Library Association

Naomi C. Broering, MLS, MA, Georgetown University Medical Center, Washington

Nina Matheson, MLS, Association of American Medical Colleges, Washington

Alan E. Zuckerman, MD, Georgetown University Medical Center, Washington

Wednesday, June 16 (continued)

9:00 a.m. — 10:30 a.m. **Contributed Papers Session VI (continued)**

9:54 a.m.

Use of a Microcomputer in an Academic Health Sciences Library

Jo Ann Bell, Ph.D., Health Sciences Library, East Carolina University, Greenville

10:12 a.m.

Word Processors in the Library Environment

Margaret Norman, Head Librarian, Boehringer Ingelheim Pharmaceuticals, Ridgefield

SESSION VII

Pacific Room, Sierra Center

Moderator:

Gerald Oppenheimer, Health Sciences Library, University of Washington, Seattle

9:00 a.m.

Conservation—Who Needs It?

Albert M. Berkowitz, Chief, Reference Services Division, National Library of Medicine, Bethesda

9:18 a.m.

Exhibits in Health Science Libraries

Nancy Whitten Zinn, Head, Special Collections, The Library, University of California, San Francisco

9:36 a.m.

Eighteenth-Century Short-Title Catalogue: Participation of Medical School Library Rare Book Collections

Judith A. Overmier, Curator, Wangensteen Historical Library of Biology and Medicine, University of Minnesota, Minneapolis

Wednesday, June 16 (continued)

9:00 a.m. – 10:30 a.m. Contributed Papers Session VII (continued)

Elizabeth Ihrig, Acting Librarian, Bakken Library
of Electricity in Life, Minneapolis

9:54 a.m.

*Robert Mills and the Architectural Genesis of the
First Humane State Institution for the Treatment
of the Insane*

Julie M. Johnson, Associate Medical Librarian,
School of Medicine Library, University of South
Carolina, VA Medical Center, Columbia

10:12 a.m.

A Storage and Retrieval System for 35mm Slides

Jeanne Law Spala, B.Ed., MLS, Medical Librarian,
Centinela Hospital Medical Center, Inglewood

SESSION VIII

South Ballroom, Convention Center

Moderator:

Lynn Kasner, New York Academy of Medicine
Library, New York

9:00 a.m.

*The Role of Basic Health Science Librarians in RML
Politics—A Typical Evolutionary Process*

Faith Van Toll, Associate Director, Kentucky-
Ohio-Michigan Regional Medical Library Network,
Detroit

9:18 a.m.

*The Role of the State Library in Providing Health
Sciences Information: The Iowa State Medical
Library*

Pamela C. Rees, Director, State Medical Library of
Iowa, Des Moines

Wednesday, June 16 (continued)

9:00 a.m. — 10:30 a.m. Contributed Papers Session VIII (continued)

9:36 a.m.

Managing a Multi-Hospital Library Program

Rayna Bowlby Genetti, Project Director
Linda Plunket, Project Coordinator
Maryanne Lamont Greven, Project Librarian
Barbara Estabrook, Evaluation Consultant

Central Maine Medical Center, Lewiston

9:54 a.m.

Development of a Hospital Library Survey: A KOMRML Committee Approach

Holly Shipp Buchanan, Chair

KOM Hospital Library Survey Committee:
Gail Bank, Ph.D., **Richard Cheski**, **Pamela Elwell**,
Margaret Hardy, **Nancy Lorenzi, Ph.D.**, **Patricia**
Wolfgram and **Faith Van Toll**, Ex Officio

10:12 a.m.

Marketing Attitudes for Outreach Librarians

Joseph O. Smith, MA, ML, Coordinator for
Educational Resources, Medical University of South
Carolina, Charleston

SESSION IX

North Ballroom, Convention Center

Moderator:

Linda Angold Grix, Mesa, Arizona

9:00 a.m.

Facility Planning for Hospital Libraries

Bernie Todd Smith, Werner Health Sciences Library,
Rochester General Hospital, Rochester

Wednesday, June 16 (continued)

9:00 a.m. – 10:30 a.m. Contributed Papers Session IX (continued)

9:18 a.m.

Management Collection in a Hospital Library: A Strategy for Survival

Eugenie Prime, Director of Library

Carolyn Fishel, Assistant Director of Library

Ann Gupta, Reference Librarian

Donna Greer, Reference Librarian

Glendale Adventist Medical Center, Glendale

9:36 a.m.

Individualized Library Services for Physicians in Office Practice

William A. Clintworth, Project Director, Norris Medical Library, University of Southern California, Los Angeles

9:54 a.m.

Development of a Statewide Health-Science Audiovisual Catalog

David W. Boilard, Associate Director, Lommen Health Sciences Library, University of South Dakota School of Medicine, Vermillion

10:12 a.m.

The Use of Prefabricated Rooms in a Learning Resources Center

Cliff Solomon, Coordinator, Learning Resources Center, The Norris Medical Library, University of Southern California, Los Angeles

Wednesday, June 16 (continued)

9:00 a.m. – 10:30 a.m. Contributed Papers Sessions (continued)

SESSION X
Balboa Room, Sierra Center

Moderator:
R. Taylor Putney, Jr., Health Science Library,
Wright State University, Dayton

9:00 a.m.
*Development of an International Index in Family
Medicine*

Dorothy Fitzgerald, Librarian, The College of
Family Physicians of Canada, Editor, *Family
Medicine Literature Index (FAMLI)*

9:18 a.m.
*The Coverage of Clinical Medicine in Three Major
Nursing Journals*

Laurie A. Conway, Health Sciences Library,
University of Maryland, Baltimore

9:36 a.m.
*A Basic Bibliography for Pharmaceutical and Drug
Information*

Bonnie Snow, DIALOG Information Services, Inc.,
Arlington

9:54 a.m.
*Referral as an Integral Part of a Health Sciences
Reference Service*

Carol Hansen Fenichel, Ph.D., Director of Library
Services

Margaret Giles Fallis, Head, Public Services

Joseph W. England Library, Philadelphia College of
Pharmacy and Science, Philadelphia

Wednesday, June 16 (continued)

9:00 a.m. – 10:30 a.m. Contributed Papers Session X (continued)

10:12 a.m.

Pharmacy Continuing Education: A New Arena for Librarians

Janis Fukasawa Brown, Research Librarian, Norris Medical Library and School of Pharmacy, University of Southern California, Los Angeles

10:30 a.m. – 11:00 a.m. Visit the Exhibits

10:30 a.m. – 2:00 p.m. **SECTION MEETING**

MEDICAL SOCIETY LIBRARIES SECTION:
Tour of the Los Angeles County Medical Society Library and Luncheon

11:00 a.m. – 1:00 p.m. **SECTION MEETINGS**

HOSPITAL LIBRARY SECTION
Program and Business Meeting
Embassy Room, Embassy Center

Future Directions for the 1980's

The hospital librarian's role will be discussed from the perspective of unlimited, challenging horizons with a practical identification of skills necessary to more than survive in today's austere climes; the effect of new directions by MLA on the hospital library membership will be explored; and the rationale for greater cooperation and communication between different kinds of libraries will be addressed.

Moderator:

Eleanor Goodchild, Librarian, Medical and Biological Sciences Library, University of Pennsylvania, Philadelphia

Wednesday, June 16 (continued)

11:00 a.m. — 1:00 p.m. Hospital Library Section Meeting (continued)

Speakers:

Lois Ann Colaianni, Deputy Associate Director for Library Operations, National Library of Medicine, Bethesda

Raymond A. Palmer, Executive Director, Medical Library Association, Chicago

Gary E. Strong, California State Librarian, Sacramento

MEDICAL SCHOOL LIBRARIES SECTION
Program and Business Meeting
Magnolia C, Magnolia Center

Public and Technical Services Librarians in Wonderland: A Panel Discussion Designed to Explore the Wonder of the World of Medical School Libraries

Moderator:

Jeanne Mueller, Indiana University School of Medicine Library, Indianapolis

Speakers:

Kate Hammell, University of Illinois at the Medical Center, Library of the Health Sciences, Chicago

Lucretia McClure, University of Rochester, School of Medicine/Dentistry, Edward G. Miner Library, Rochester

W. Wallace McLendon, Health Sciences Library, University of North Carolina, Chapel Hill

Cheryl Rueby, Wright State University, Health Sciences Library, Dayton

Wednesday, June 16 (continued)

11:00 a.m. — 1:00 p.m. Section Meetings (continued)

PUBLIC HEALTH/HEALTH ADMINISTRATION SECTION

Program and Business Meeting
Information—Feast or Famine?
Magnolia B, Magnolia Center

Speakers:

Jo Ann Angle, National Health Information Clearinghouse, Washington
Impact of Federal Budget Cuts on Information Clearinghouses

Anne Compton, Coordinator, Population Information Programs, Johns Hopkins University, Baltimore

POPLINE and POPULATION REPORTS: Development, Services, and Future Plans

Michelle Chatfield, Technical Information Specialist, Food and Drug Administration, Bureau of Foods, Washington

Literature Searching Services for the Priority Assessment of Food Additives

Sandy Smith, Scientific and Technical Information Branch, National Center for Health Statistics, Hyattsville

Publications and Developments at NCHS

12:00 p.m. — 1:00 p.m. SECTION BUSINESS MEETINGS

Cancer Librarians Section
Santa Catalina Room, Bonita Center

Pharmacy and Drug Information Section
Cerritos Room, Sierra Center

1:00 p.m. — 2:00 p.m. LUNCH

Wednesday, June 16 (continued)

1:00 p.m. — 2:00 p.m. Informal Meetings

Bibliographic Instruction Group
Yorba Room, Sierra Center

Health Sciences Library Computer Network
Palm Room, Sierra Center

Research Interest Group: Library Related Research
(organizational meeting)
Santa Rosa Room, Bonita Center

1:15 p.m. — 2:00 p.m. Job Market '82
See page 31,

2:00 p.m.— 3:30 p.m. **GENERAL SESSION II**
Embassy Room, Embassy Center

Panelists will discuss the expected future developments in information transfer, the human and psychological aspects of adopting new technology, and the implications technological change present for the formation of public policy.

Moderator:

Alison Bunting, Associate Biomedical Librarian
for Public Services, University of California, Los
Angeles, Biomedical Library

Speakers:

Jerry Shannon, Telecommunications Consultant,
University of California, San Diego, La Jolla

Frederick Williams, Ph.D., Professor, Annenberg
School of Communications, University of Southern
California, Los Angeles

Robert M. Hayes, Ph.D., Dean, Graduate School
of Library and Information Science, University of
California, Los Angeles

3:30 p.m. — 4:00 p.m. Visit the Exhibits

Wednesday, June 16 (continued)

4:00 p.m. — 5:00 p.m. **DIALOG WITH MLA/NLM LEADERSHIP**
Embassy Room, Embassy Center

Introduction:

Charles W. Sargent, Ph.D., President, Medical
Library Association

Speaker:

Martin M. Cummings, M.D., Director, National
Library of Medicine, Bethesda
NLM Relationships with the Private Sector

Respondent:

Charles W. Sargent, Ph.D., President, Medical
Library Association

5:00 p.m. — 6:30 p.m. **COMMITTEE MEETINGS**

Ad Hoc Committee for the International Exchange
and Redistribution of Library Materials (II)

Chair: **Janis Sharp**

Regency Room, Sierra Center

Exchange (II)

Chair: **Joan S. Zenan**

Orange Room, Sierra Center

Health Sciences Library Technicians

Chair: **Karen J. Graves**

Serrano Room, Sierra Center

Inter-Association Representatives Panel

Chair: **Gertrude Lamb, Ph.D.**

Sierra Room, Sierra Center

Membership (II)

Chair: **Rosanne Labree**

Alamitos Room, Sierra Center

Publishing and Information Industries Relations

Chair: **Joseph E. Jensen**

Yorba Room, Sierra Center

Wednesday, June 16 (continued)

5:00 p.m. — 6:30 p.m. Committee Meetings (continued)

Recertification (I)
Chair: **Julie Blume Nye**
Palm Room, Sierra Center

Research and Evaluation (II)
Chair: **Erika Love**
Olympic Room, Sierra Center

Vital Notes Panel
Chair: **Don Potts**
Cerritos Room, Sierra Center

5:00 p.m. — 6:30 p.m. Informal Meetings

VA Librarians
Pacific Room, Sierra Center

6:30 p.m. — 7:00 p.m. VA and Military Librarians: FHRSC Activities
Pacific Room, Sierra Center

6:30 p.m. — 7:30 p.m. Free Time

7:00 p.m. — 11:00 p.m. Honors and Awards and Banquet
Grand Ballroom, Convention Center

Thursday, June 17

7:00 a.m. — 9:00 a.m. **COMMITTEE MEETINGS**

Ad Hoc Committee on Consumer Health Information
Chair: **Ellen Gartenfeld**
Regency Room, Sierra Center

Continuing Education (II)
Chair: **Martha Jane K. Zachert, D.L.S.**
Alamitos Room, Sierra Center

Thursday, June 17 (continued)

7:00 a.m. – 9:00 a.m. Committee Meetings (continued)

Library Standards and Practices
Chair: **Glenn Brudvig**
Cerritos Room, Sierra Center

MLA/HeSCA Joint Committee to Develop
Guidelines for Audiovisual Facilities in Health
Sciences Libraries (II)
Chair: **Gloria Holland**
Sierra Room, Sierra Center

Membership (III)
Chair: **Rosanne Labree**
Olympic Room, Sierra Center

Murray Gottlieb Prize Subcommittee
Chair: **Julia G. Pfau**
Serrano Room, Sierra Center

Oral History
Chair: **Nancy Whitten Zinn**
Orange Room, Sierra Center

Recertification (II)
Chair: **Julie Blume Nye**
Palm Room, Sierra Center

9:00 a.m. – 10:30 a.m. BUSINESS MEETING II
Grand Ballroom, Convention Center

10:30 a.m. – 11:00 a.m. INAUGURAL ADDRESS
Grand Ballroom, Convention Center

Speaker:
Nancy M. Lorenzi, Ph.D.
The Future is Ours Today

11:00 a.m. – 11:30 a.m. Visit the Exhibits

Thursday, June 17 (continued)

11:30 a.m. — 1:00 p.m. **MLA/NLM Liaison Committee Meeting**
Chair: **Arlee May**
Santa Cruz Room, Bonita Center

11:30 a.m. — 1:00 p.m. **SECTION MEETINGS**

DENTAL LIBRARY SECTION

Speaker and Business Meeting
Cerritos Room, Sierra Center

Speaker:

Dr. Gerald Vale, Dental Director, Los Angeles
County/USC Medical Center, Los Angeles
Personal Identification and Bite Mark

HEALTH SCIENCES AUDIOVISUAL SECTION

Speaker and Business Meeting
Audiovisual Loan Practices: A Network Approach
Pacific Room, Sierra Center

Speakers:

Linda Kudrick, Chief, Materials Utilization Branch,
National Medical Audiovisual Center, Bethesda

James E. Morgan, Director of Libraries, Oregon
Health Sciences University, Portland

Monica Yunag, Senior Reference Librarian, Wright
State University, Dayton

MENTAL HEALTH LIBRARIES SECTION

Speaker and Business Meeting
Santa Catalina Room, Bonita Center

Speaker:

Robert S. Pynoos, MD, Assistant Professor,
Psychiatry, Neuropsychiatric Institute, University
of California, Los Angeles
Psychiatry and DSM-III

Thursday, June 17 (continued)

11:30 a.m. — 1:00 p.m. Section Meetings (continued)

**NURSING AND ALLIED HEALTH RESOURCES
SECTION**

Panel Presentation and Business Meeting
Nursing Information Consortium of Orange County
Balboa Room, Sierra Center

Speakers:

Nancy E. Donaldson, R.N., M.S.N., Clinical Nurse
Specialist, Newport Beach

Diana Lane, Librarian, UC Irvine Medical Center
Library, Orange

Joyce Loepprich, R.N., Serials Librarian, UC
Irvine Biomedical Library, Irvine

Carole Myrick, Harbor UCLA Medical Center,
Torrance

Julie Smith, Librarian, St. Joseph Hospital, Orange

RESEARCH LIBRARIES SECTION

Program and Business Meeting
Santa Rosa Room, Bonita Center

Speaker:

Ralph H. Rousel, M.D., Medical Director, Cutter
Laboratories, Berkeley

*Immune Globulin Intravenous: A New Plasma
Product?*

Panel Discussion:

Librarians from research institutions will discuss
how the services and collections of their libraries
support research activities.

1:00 p.m. — 2:00 p.m. Lunch

Thursday, June 17 (continued)

2:00 p.m. — 3:30 p.m. **INVITED PAPERS SESSION IV-V**

IV: ISSUES IN CONSUMER HEALTH EDUCATION
Embassy Room, Embassy Center

Moderator:

Jacqueline Doyle, Reference Librarian, Biomedical Library, University of California, San Diego

Speakers:

E. Richard Brown, Ph.D., Assistant Professor, School of Public Health, University of California, Los Angeles

The Potential of Voluntary Health Agencies for Community Education and Organization to Resolve Environmental Health Problems

The effective resolution of community health and safety problems, such as those resulting from toxic substance exposures, requires the informed and active participation of community members. Major voluntary health agencies have traditionally played little or no role in efforts to reduce or eradicate environmental health problems. Recently, efforts have been undertaken to involve these agencies in educational and legislative efforts to resolve these problems.

This presentation reports on the experience of the Santa Monica, California, branch of the American Cancer Society in developing a "Community Forum on Toxic Substances and Health" as a vehicle for community education and organization. The ACS branch formed a coalition of environmental, health, labor, and community groups which planned the forum around problems of occupational exposures, toxic waste disposal, pesticides, air and water pollution, food additives, and household and community exposures.

The presentation will assess the extent to which program objectives were fulfilled, analyzes the

Thursday, June 17 (continued)

2:00 p.m. — 3:30 p.m. Invited Papers Session IV (continued)

factors influencing the outcomes of this educational and organizational project, evaluates its impact on ACS, and makes recommendations for future use of such vehicles.

Sheldon Greenfield, M.D., Associate Professor of Medicine and Public Health, School of Medicine, University of California, Los Angeles

Changing Patient Behavior through Information Sharing

In order to increase patient participation in medical care, we developed an individualized education program for chronic disease patients. In a one-hour training session, patients are presented with their own medical records and structured materials for reading and understanding them. Through the review of their medical records, patients are given the relevant details regarding their health care. This review is then coupled with a second short session designed to improve effective information-seeking skills. In a randomized controlled trial, comparing this intervention to a typical chronic disease education program, we measured the following outcomes: patient participation as reflected in question-asking and mutual decision making during the doctor-patient encounter; patient adherence to medical regimens; patient satisfaction, and control of the chronic disease. Factors such as demographic characteristics, locus of control, health beliefs and perceived degree of responsibility in the doctor-patient relationship that influenced the outcomes, were measured. The overall aim of this research was to produce a valid, feasible and generalizable program which will involve patients in their medical care and thereby improve health outcomes.

Thursday, June 17 (continued)

2:00 p.m. — 3:30 p.m. Invited Papers Session IV (continued)

Thomas J. Kean, MPH, Special Assistant, Office of Cancer Communications, National Cancer Institute, Bethesda

Issues in Disseminating Cancer Information Through Libraries

Throughout the last decade there has been growing public interest in the subject of cancer. All types of public media are providing increasing coverage of this subject area. In response to this growing demand, the National Cancer Institute and other member groups of the National Cancer Program have been engaged in developing and/or expanding their public information/education resources and programs. A major problem facing those responsible for the dissemination of such information is that the body of knowledge related to cancer is very dynamic, and is changing rapidly as research results come available. It is believed that libraries, medical and public, afford an excellent opportunity for disseminating such information. The issues involved in utilizing and working with libraries in the context of a rapidly expanding knowledge base will be discussed. An overview of existing and planned information resources available to libraries will also be given.

Gordon L. Scott, Consumer Affairs Officer, Los Angeles District, Food and Drug Administration, Los Angeles

FDA's Role in Providing the Public With Consumer Health Education

The Food and Drug Administration's principal responsibility is to assure the public that products regulated by the FDA are safe, sanitary and properly labeled. Inspections are held, standards are set and in certain cases products are approved before marketing. In addition to enforcement activities, the FDA sponsors a variety of educational programs aimed at informing the public about important

Thursday, June 17 (continued)

2:00 p.m. — 3:30 p.m. Invited Papers Session IV (continued)

health issues. Such programs are organized by Consumer Affairs Officer (CAO's) of whom there are more than 50. CAO's are often the first-line contact with state officials, the public and the media on "hot" and current issues. CAO's conduct workshops for teachers, nurses and other professionals. They give speeches, staff exhibits and regularly interact with the news media. Other informational activities carried out by local FDA offices include: responding to telephone and written inquiries, receiving consumer complaints, and providing copies of FDA publications (English and Spanish).

V: EVALUATION OF SERVICES

Magnolia Room, Magnolia Center

Moderator:

Gail Yokote, Head, Information Services, Texas Medical Center Library, Houston

Speakers:

Teri A. Denson, Ph.D., Senior Evaluator, Development and Demonstration Center in Continuing Education for Health Professionals, University of Southern California, School of Medicine, Los Angeles

Program Evaluation: Adventureland, Tomorrowland, or Fantasyland?

Research has traditionally been associated with classical concepts of experimental design. While appropriate to laboratory research, these principles are not always the best guides for development or demonstration studies or for most program evaluation tasks. Some newer concepts from action research, naturalistic evaluation and qualitative analysis are both useful and sound guides for planning evaluation studies in the library setting.

Thursday, June 17 (continued)

2:00 p.m. — 3:30 p.m. Invited Papers Session V (continued)

These newer approaches acknowledge the inherent "messiness" of most real-life research situations, including the inability to exercise such hallowed procedures as randomization, interval metrics, and experimental controls. Instead of offering apologies, these methods present alternatives that actually enhance the usefulness of evaluation results.

The wise participant in evaluation studies does not, however, embrace these so-called "new" methods indiscriminately or use them as an excuse for sloppy research. A useful framework for "evaluating" evaluations is found in *Standards for Evaluation of Educational Programs, Projects, and Materials* (McGraw Hill Book Co. 1981).

Michael Homan, Head, Information Services,
Corporate Technical Library, The Upjohn Company,
Kalamazoo

Evaluation of a Computerized In-House SDI System
Since 1967, the Upjohn Company's Corporate Technical Library has provided an in-house computerized selective dissemination of information (SDI) program based on the Ringdoc database generated by Derwent Publications Ltd., London, England. Ringdoc is a literature alerting and retrieval service specifically designed to meet the information and documentation requirements of the pharmaceutical industry. Monthly computer tapes of the Ringdoc database are processed in-house on an IBM mainframe using software developed for this purpose in 1967. Vendor announced tape format changes necessitating new retrieval software together with decreased use statistics and the availability of other SDI systems prompted an evaluation of the in-house SDI program to determine how well it was still meeting user requirements for SDI. Results of the evaluation are reported.

Thursday, June 17 (continued)

2:00 p.m. – 3:30 p.m. Invited Papers Session V (continued)

Ruth Traister Morris, Reference/AV Librarian,
Health Sciences Library, University of Iowa, Ames

Being There: Effect of the Patron's Presence on MEDLINE Search Results

An evaluation was conducted at the University of Iowa Health Sciences Library to determine what effect the patron's presence had on MEDLINE search results. One hundred patrons participated over a four-month period. Three main criteria were used: search precision, search recall, and patron satisfaction. Each MEDLINE search was run twice, once prior to the patron's arrival and a second time during the scheduled appointment with the patron. The two searches for each patron were run by different searchers, and the four searchers alternated running the patron-absent or the patron-present search. The patron was asked to compare the citations on the two searches by checking each printout for relevant citations. A short questionnaire was administered to determine general patron information and satisfaction measures for each search. The extensiveness of the interview for the patron-absent search was varied in order to determine if the depth of the initial interview would affect the search results. Evaluation of the findings indicated an increase in precision, recall, and patron satisfaction for the patron-present search. Some difficulties in designing the experiment are discussed and implications of the evaluation results are considered.

Susan Shelly Anthony, Assistant Director, Health
Sciences Library, University of Cincinnati Medical
Center Libraries, Cincinnati

Improving the Quality of Your Work Life through Evaluations

Evaluation within a library's information services
department can produce significant outcomes

Thursday, June 17 (continued)

2:00 p.m. — 3:30 p.m. Invited Papers Session V (continued)

resulting in improved quality of work life. Improved services, increased accountability, effective rationale for budgeting and increased "political points" are all potential results of well planned and executed evaluations in the library setting.

Evaluation of information services must be planned and purposeful to provide useful information. They may be performed at the end of a project, as needed, such as at reaccreditation time, or systematically, as with daily reference statistics.

Four types of data collection methods are useful in evaluating information services: written surveys, interviews, unobtrusive/observation methods and a combination of the three types.

For the novice performing evaluations, it is beneficial to seek assistance from persons trained in evaluation methods. Through evaluation, the librarian can develop new skills and become a better manager or administrator while improving the quality of library services, its image and the work environment.

3:30 p.m. — 4:00 p.m. BREAK

4:00 p.m. — 5:00 p.m. JOINT CHAPTER AND SECTION COUNCIL
Pacific Room, Sierra Center

4:00 p.m. — 6:00 p.m. Informal Meeting
Association of Academic Health Sciences Library
Directors
Balboa Room, Sierra Center

Postconference

Friday, June 18

8:30 a.m. — 5:00 p.m. Board of Directors Meeting
Presiding: Nancy M. Lorenzi, Ph.D.
Cerritos Room, Sierra Center

Continuing Education Course
See page 23.

Saturday, June 19

8:30 a.m. — 5:00 p.m. Continuing Education Course
See page 23.



Martinus Nijhoff
Booksellers and Subscription Agents

**Supplying libraries with journals
and books**

for more than a century

Visit us at Booth 101

P.O. Box 269 - 2501 AX The Hague, The Netherlands
Liaison office: 190 Old Derby Street, Hingham, MA 02043

Springer publishing co

PRESENTING 2 OF SPRINGER'S
5 AJN BOOK OF THE YEAR WINNERS

Nursing Information Systems

Harriet H. Werley, R.N. Ph.D
Margaret Grier, R.N., Ph.D., eds.

Discusses the systematizing and computerizing of information for enhancing nursing care, education and research.

448pp / 1981 / 0-8261-2520-4 / \$27.50

Inferences of Patients' Pain and Psychological Distress

Lois L. Davitz, Ph.D and *Joel R. Davitz, Ph.D.*

The full report of the authors' six-year international study focusing on the factors that influence nurses' varied reactions to the pain of patients.

220 pp / 1981 / 0-8261-3360-6 / hard \$25.00

NEW

Dictionary of Rehabilitation Medicine

Herman L. Kamenetz, M.D.

This superb resource book offers in a single volume a look into the multidisciplinary world of medical rehabilitation in its broadest aspect.

384 pp / 1982 / 0-8261-3320-7 / hard \$21.95

Advances in Disease Prevention

Volume 1

Charles B. Arnold, M.D., et al., eds.

Integrates new preventive care research findings in this interdisciplinary field. The theme of the first volume is chronic illness.

320pp / 1981 / 0-8261-2830-0 / hard \$35.00

Elderly Patients and Their Doctors

Marie R. Haug, Ph.D., ed.

Exploration of doctor-elderly patient relationship.

240 pp / 1981 / 0-8261-3570-6 / hard \$20.95 (text price 10 or more: \$14.95)

NEW

Stress and Human Health

Glen R. Elliot, Ph.D., M.D. and *Carl Eisendorfer, Ph.D., M.D., eds.*

Seminal report sponsored by the National Academy of Science's Institute of Medicine summarizes current knowledge on stress.

400pp / 1982 / 0-8261-4110-2 / hard \$34.95

The Evaluation of Teaching in Medical Schools

Robert M. Rippey, Ph.D.

Synthesizes and interprets the research on the evaluation of teaching in order to provide guidelines for the implementation of effective programs.

173pp / 1981 / 0-8261-3440-8 / hard \$23.95

Order from your bookstore or directly from Publisher. Enclose \$1.10 postage and handling.

Springer Publishing Company 200 Park Ave. South, N.Y. N.Y. 10003

An Invitation
to own the magnificent facsimile of

**The Anatomical Studies of
Leonardo da Vinci**
lodged in
The Royal Library at Windsor Castle

CREATED in facsimile by English craftsmanship and by brilliant international scholarship, the folio-size volumes bound in Nigerian goatskin are available in an English-language edition of 998 numbered sets. The work consists of three volumes, two comprising Leonardo's text in Italian and English in addition to artistic and medical commentary, and one a portfolio box of 201 drawings printed in up to six colors per plate. The plates were produced in a studio especially constructed by Harcourt Brace Jovanovich, with permission and under regulation of the Crown, on the grounds of Windsor Castle. Price: \$6,600 a set.

For further information, write or telephone.



JOHNSON REPRINT CORPORATION

Harcourt Brace Jovanovich, Publishers
757 Third Avenue, New York, N.Y. 10017
(212) 888-2925 Telex: 12-7891 Cable: HARBRACE, New York

A special 30% convention discount will be offered to all members attending the meeting. This offer will expire July 31, 1982.

Ad Hoc

COMMITTEE MEETINGS SCHEDULE*

Committee	Date	Time	Meeting Room
Ad Hoc Committee for the International Exchange and Redistribution of Library Materials (I)	June 15	4:00 p.m.	Regency
Ad Hoc Committee for the International Exchange and Redistribution of Library Materials (II)	June 16	5:00 p.m.	Regency
Ad Hoc Committee on Consumer Health Information (I)	June 15	4:00 p.m.	Santa Rosa
Ad Hoc Committee on Consumer Health Information (II)	June 17	7:00 a.m.	Regency
Audiovisual Standards and Practices	June 16	7:00 p.m.	Sierra
Board of Directors (I)	June 9	8:30 a.m.	Cerritos
Board of Directors (II)	June 10	8:30 a.m.	Cerritos
Board of Directors (III)	June 11	8:30 a.m.	Cerritos
Board of Directors (IV)	June 12	8:30 a.m.	Cerritos
Bylaws	June 14	7:00 a.m.	San Clemente
Certification Eligibility	June 14	7:00 a.m.	Palm
Certification Examination Review (I)	June 13	9:00 a.m.	Olympic
Certification Examination Review (II)	June 15	4:00 p.m.	Palm
Continuing Education (I)	June 14	7:00 a.m.	Yorba
Continuing Education (II)	June 17	7:00 a.m.	Alamitos
Copyright	June 14	7:00 a.m.	Alamitos

Editorial Committee for the <i>Bulletin</i>	June 15	4:00 p.m.	Santa Catalina
Editorial Committee for the <i>MLA News</i>	June 16	7:00 a.m.	Santa Catalina
Exchange (I)	June 14	7:00 a.m.	Regency
Exchange (II)	June 16	5:00 p.m.	Orange
Handbook of Medical Library Practice: Chapter III Authors	June 14	7:00 a.m.	Santa Cruz
Health Sciences Library Technicians	June 16	5:00 p.m.	Serrano
Honors and Awards	June 15	4:00 p.m.	Yorba
Hospital Library Standards and Practices (I)	June 15	4:00 p.m.	Pacific
Hospital Library Standards and Practices (II)	June 16	7:00 a.m.	Santa Rosa
Inter-Association Representatives Panel	June 16	5:00 p.m.	Sierra
Interlibrary Loan and Resource Sharing Standards and Practices	June 16	7:00 a.m.	Olympic
International Cooperation	June 14	7:00 a.m.	Cerritos
Janet Doe Lectureship Subcommittee	June 16	7:00 a.m.	Orange
Legislation	June 16	7:00 a.m.	Alamitos
Library Standards and Practices	June 17	7:00 a.m.	Cerritos
MLA/HeSCA Joint Committee to Develop Guidelines for Audiovisual Facilities in Health Sciences Libraries (I)	June 14	7:00 a.m.	Sierra
MLA/HeSCA Joint Committee to Develop Guidelines for Audiovisual Facilities in Health Sciences Libraries (II)	June 17	7:00 a.m.	Sierra
MLA/NLM Liaison	June 17	11:30 a.m.	Santa Cruz

Membership (I)	June 15	4:00 p.m.	Cerritos
Membership (II)	June 16	5:00 p.m.	Alamitos
Membership (III)	June 17	7:00 a.m.	Olympic
Murray Gottlieb Prize Subcommittee	June 17	7:00 a.m.	Serrano
National Issues Advisory Council	June 15	4:00 p.m.	Serrano
National Program, 1983 (I)	June 14	7:00 a.m.	Orange
National Program, 1983 (II)	June 16	7:00 a.m.	Serrano
National Program, 1984	June 14	7:00 a.m.	Olympic
Oral History	June 17	7:00 a.m.	Orange
Program and Convention (I)	June 14	7:00 a.m.	Serrano
Program and Convention (II)	June 15	4:00 p.m.	Sierra
Publication Panel	June 13	9:00 a.m.	Villa 15
Publishing and Information Industries Relations Committee	June 16	5:00 p.m.	Yorba
Recertification (I)	June 16	5:00 p.m.	Palm
Recertification (II)	June 17	7:00 a.m.	Palm
Research and Evaluation (I)	June 14	7:00 a.m.	Balboa
Research and Evaluation (II)	June 16	5:00 p.m.	Olympic
Rittenhouse Award Subcommittee	June 14	7:00 a.m.	Santa Barbara
RML Directors	June 13	9:00 a.m.	Embassy East
Scholarship and Grants	June 16	7:00 a.m.	Cerritos
Status and Economic Interests of Health Sciences Library Personnel	June 16	7:00 a.m.	Palm

Surveys and Statistics

June 15 4:00 p.m. Alamitos

Vital Notes Participatory Panel

June 16 5:00 p.m. Cerritos

*Those committees not listed are not meeting during the 1982 Annual Meeting.



Zero to Three

a publication for professionals
working with infants and their families;
reports on new research, clinical studies,
publications, conferences, and more;
edited by Sally Provence, M.D.

(Child Development Center, Yale University)

\$10 per year (4-6 issues)

FOR AN INTRODUCTORY COPY, WRITE TO:
National Center for Clinical Infant Programs
733 15th Street, N.W., Suite 912
Washington, D.C. 20005

INVITED SPEAKERS INDEX

Name	Date	Meeting Room	Time
Gayle J. Ablove	June 14	Cerritos Room	2:00 p.m.
Jo Ann Angle	June 16	Embassy Room	11:00 a.m.
Susan Shelly Anthony	June 17	Magnolia Room	2:00 p.m.
Jane Belt	June 14	Center Ballroom	11:00 a.m.
E. Richard Brown, Ph.D.	June 17	Embassy Room	2:00 p.m.
Holly Shipp Buchanan	June 15	Grand Ballroom	10:30 a.m.
Alison Bunting	June 14	Grand Ballroom	9:00 a.m.
Robert G. Cheshire	June 15	Grand Ballroom	2:00 p.m.
Michele Chatfield	June 16	Embassy Room	11:00 a.m.
Lois Ann Colaianni	June 16	Embassy Room	11:00 a.m.
Ann Compton	June 16	Embassy Room	11:00 a.m.
William G. Cooper, Ph.D.	June 15	Grand Ballroom	10:30 a.m.
Martin M. Cummings, M.D.	June 16	Embassy Room	4:00 p.m.
Teri A. Denson, Ph.D.	June 17	Magnolia Room	2:00 p.m.
Nancy E. Donaldson	June 17	Balboa Room	11:30 a.m.
Gale Dutcher	June 14	Center Ballroom	2:00 p.m.
Eileen Eandi	June 14	Center Ballroom	11:00 a.m.
Janet L. Erickson	June 14	Cerritos Room	2:00 p.m.
Sherrilynne Shirley Fuller	June 14	Cerritos Room	2:00 p.m.
Nelson J. Gilman	June 14	Grand Ballroom	9:30 a.m.
Deborah Graham	June 14	South Lounge	2:00 p.m.
Sheldon Greenfield, M.D.	June 17	Embassy Room	2:00 p.m.
Nancy Gwinn	June 14	Center Ballroom	11:00 a.m.
Kate Hammell	June 16	Embassy Room	11:00 a.m.
Marie Harvin	June 14	Cerritos Room	2:00 p.m.
Robert M. Hayes, Ph.D.	June 16	Embassy Room	2:00 p.m.
Sourya Henderson, Ph.D.	June 14	Cerritos Room	2:00 p.m.
Virginia H. Holtz	June 15	Grand Ballroom	10:30 a.m.
Michael Homan	June 17	Magnolia Room	2:00 p.m.
Terry Ann Jankowski	June 14	Center Ballroom	11:00 a.m.

Neal K. Kaske, Ph.D.	June 14	Center Ballroom	11:00 a.m.
Thomas J. Kean, MPH	June 17	Embassy Room	2:00 p.m.
Linda Kudrick	June 17	Pacific Room	11:30 a.m.
Diana Lane	June 17	Balboa Room	11:30 a.m.
Joyce Loepprich	June 17	Balboa Room	11:30 a.m.
Nancy M. Lorenzi, Ph.D.	June 17	Grand Ballroom	10:30 a.m.
Nina W. Matheson	June 15	Grand Ballroom	10:30 a.m.
William D. Mayer, Ph.D.	June 15	Grand Ballroom	10:30 a.m.
Phyllis S. Mirsky	June 14	Grand Ballroom	9:00 a.m.
James E. Morgan	June 17	Pacific Room	11:30 a.m.
Ruth Traister Morris	June 17	Magnolia Room	2:00 p.m.
Carole Myrick	June 17	Balboa Room	11:30 a.m.
Lucretia McClure	June 16	Embassy Room	11:00 a.m.
W. Wallace McLendon	June 16	Embassy Room	11:00 a.m.
Nardina L. Nameth	June 14	Center Ballroom	11:00 a.m.
Brian Nielsen	June 14	Center Ballroom	11:00 a.m.
Raymond A. Palmer	June 16	Embassy Room	11:00 a.m.
Kenneth H. Plate	June 14	South Lounge	4:00 p.m.
Ursula H. Poland	June 15	Grand Ballroom	2:00 p.m.
Robert S. Pynoos	June 17	Santa Catalina Room	11:30 a.m.
Ralph Rousel, M.D.	June 17	Balboa Room	11:30 a.m.
Cheryl Rueby	June 16	Embassy Room	11:00 a.m.
Charles W. Sargent, Ph.D.	June 14	Grand Ballroom	9:00 a.m.
	June 15	Grand Ballroom	9:30 a.m.
	June 16	Embassy Room	4:00 p.m.
Gordon L. Scott	June 17	Embassy Room	2:00 p.m.
Jerry Shannon	June 16	Embassy Room	2:00 p.m.
Julie Smith	June 17	Balboa Room	11:30 a.m.
Sandy Smith	June 16	Embassy Room	11:00 a.m.
J. F. Smithcors, D.V.M.	June 14	Sierra Room	2:00 p.m.
Bonnie Snow	June 14	Center Ballroom	11:00 a.m.
Sherrill O. Sorrentino	June 14	Cerritos Room	4:00 p.m.
Gary E. Strong	June 16	Embassy Room	11:00 a.m.
Barbara Taub, R.N.	June 14	Yorba Ballroom	2:00 p.m.
Edward Taub, M.D.	June 14	Yorba Ballroom	2:00 p.m.
Rosemarie Taylor	June 14	Center Ballroom	11:00 a.m.

Patricia L. Thibodeau	June 14	Center Ballroom	11:00 a.m.
Gregory A. Thompson	June 14	Center Ballroom	11:00 a.m.
Carolyn Tilley	June 14	Palm Room	2:00 p.m.
T. Daniel Tonkery	June 14	Center Ballroom	11:00 a.m.
Gerald Vale	June 17	Cerritos Room	11:30 a.m.
Judy Wanger	June 14	South Lounge	2:00 p.m.
Lawrence Weed, M.D.	June 14	Grand Ballroom	9:30 a.m.
Frederick Williams, Ph.D.	June 16	Embassy Room	2:00 p.m.
Monica Yunag	June 17	Pacific Room	11:30 a.m.

FOREIGN BOOKS and PERIODICALS

CURRENT OR OUT-OF-PRINT

SPECIALTIES:

Search Service

Irregular Serials

International Congresses

Building Special Collections

ALBERT J. PHIEBIG INC.

Box 352, White Plains, N. Y. 10602+0352
(914) 948-0138

ENTER THE
COMPUTER AGE
WITH SAZTEC

Computer services offered for the publishing, library and database industries. Saztec's expertise in upfront and historical file conversions offer the prospective firms a proven and economical means to enter the computer age.

The rapid expansion into electronic publishing, automated circulation systems and on-line database retrieval requires an experienced and professional computer services firm. Saztec is the expert. Saztec can conform to your present inhouse system or provide data in the formats of most software packages.

Data conversion includes system analysis, programming, clerical markup for typesetting, key entry and verification and computer formatting and editing.

Saztec's worldwide facilities with offices in seven countries and nine U.S. locations offer a capacity of over 500 million characters per month.

SAZTEC

27520 Hawthorne Blvd., Suite 265, Rolling Hills Estates, CA 90274

Telephone 213-544-0337

■■■■■■ Please inquire at booth 29 for more detailed information

CONTRIBUTED PAPERS: AUTHOR/SPEAKER INDEX

Name	Date	Session	Meeting Room	Time
Joanne G. Angle	June 14	II	South Ballroom	5:12 p.m.
	June 14	III	North Ballroom	4:54 p.m.
Elaine Alligood	June 14	IV	Pacific Room	4:00 p.m.
Shelley Bader	June 14	IV	Pacific Room	4:18 p.m.
Helen E. Bagdoyan	June 14	II	South Ballroom	4:36 p.m.
Gail Bank, Ph.D.	June 16	VIII	South Ballroom	9:54 p.m.
Jory H. Barone	June 14	III	North Ballroom	4:54 p.m.
Walter Bechtold, DDS	June 14	I	Center Ballroom	4:00 p.m.
Christine L. Bell	June 14	V	Balboa Room	4:54 p.m.
Jo Ann Bell, Ph.D.	June 14	IV	Pacific Room	4:36 p.m.
	June 16	VI	Center Ballroom	9:54 a.m.
Albert M. Berkowitz	June 16	VII	Pacific Room	9:00 a.m.
Mary Ann Berliner	June 14	III	North Ballroom	4:18 p.m.
	June 14	III	North Ballroom	4:36 p.m.
David W. Boilard	June 16	IX	North Ballroom	9:54 a.m.
Naomi C. Broering	June 14	I	Center Ballroom	4:00 p.m.
	June 14	I	Center Ballroom	4:18 p.m.
	June 14	II	South Ballroom	4:36 p.m.
	June 16	VI	Center Ballroom	9:36 a.m.
	June 16	X	Balboa Room	10:12 a.m.
Janis Fukasawa Brown	June 16	X	Balboa Room	10:12 a.m.
Holly Shipp Buchanan	June 16	VIII	South Ballroom	9:54 a.m.
Bonnie G. Cannard	June 14	I	Center Ballroom	4:00 p.m.
	June 14	I	Center Ballroom	4:18 p.m.
	June 14	II	South Ballroom	4:36 p.m.
Richard Cheski	June 16	VIII	South Ballroom	9:54 a.m.
Sandra Clevesy	June 14	V	Balboa Room	4:36 p.m.
William A. Clintworth	June 16	IX	North Ballroom	9:36 a.m.
Laurie A. Conway	June 16	X	Balboa Room	9:18 a.m.
Pat Cook	June 14	III	North Ballroom	5:12 p.m.
Susan Crawford, Ph.D.	June 14	I	Center Ballroom	4:36 p.m.
Judi Dover De Carme	June 14	II	South Ballroom	5:12 p.m.
Fred I. Dudden	June 16	VI	Center Ballroom	9:00 a.m.
Rosalind F. Dudden	June 16	VI	Center Ballroom	9:00 a.m.

Pamela Elwell	June 16	VIII	South Ballroom	9:54 a.m.
Barbara Estabrook	June 16	VIII	South Ballroom	9:36 a.m.
Margaret Giles Fallis	June 16	X	Balboa Room	9:54 a.m.
Susan J. Feinglos	June 14	II	South Ballroom	4:18 p.m.
Carol Hansen Fenichel	June 16	X	Balboa Room	9:54 a.m.
Joan Fierberg	June 14	III	North Ballroom	4:18 p.m.
Carolyn Fishel	June 16	IX	North Ballroom	9:18 a.m.
Dorothy Fitzgerald	June 16	X	Balboa Room	9:00 a.m.
Donna B. Flake	June 14	IV	Pacific Room	4:36 p.m.
Raynna Bowlby Gennetti	June 14	II	South Ballroom	4:00 p.m.
	June 16	VIII	South Ballroom	9:36 a.m.
Dorothy Gilroy, M.Ed.	June 14	III	North Ballroom	4:00 p.m.
Mary King Givens	June 14	V	Balboa Room	5:12 p.m.
Diane L. Glunz	June 14	II	South Ballroom	4:54 p.m.
Marilouise Gil-Gomez	June 14	III	North Ballroom	4:18 p.m.
Eleanor Goodchild	June 14	III	North Ballroom	4:18 p.m.
	June 14	III	North Ballroom	4:36 p.m.
Donna Greer	June 16	IX	South Ballroom	9:18 a.m.
Suzanne Grefsheim	June 14	IV	Pacific Room	4:18 p.m.
Maryanne Lamont Greven	June 14	II	South Ballroom	4:00 p.m.
	June 16	VIII	South Ballroom	9:36 a.m.
Ann Gupta	June 16	IX	North Ballroom	9:18 a.m.
Margaret Hardy	June 16	VIII	South Ballroom	9:54 a.m.
Jan Hawkins	June 14	V	Balboa Room	5:12 p.m.
Elizabeth Ihrig	June 16	VII	Pacific Room	9:36 a.m.
Jodith Janes	June 14	III	North Ballroom	5:12 p.m.
Julie M. Johnson	June 16	VII	Pacific Room	9:54 a.m.
Millard F. Johnson, Jr.	June 16	VI	Center Ballroom	9:18 a.m.
Elizabeth A. Kelly	June 14	I	Center Ballroom	4:36 p.m.
Marlene Galante Kozak	June 14	I	Center Ballroom	4:54 p.m.
Rosanne Labree	June 14	IV	Pacific Room	5:12 p.m.
Pamela M. Lee	June 14	I	Center Ballroom	4:18 p.m.
Nancy Lorenzi, Ph.D.	June 16	VIII	South Ballroom	9:54 a.m.
Ann Mahony	June 14	III	North Ballroom	4:36 p.m.
Alfred Marcus	June 14	III	North Ballroom	4:36 p.m.
Nina Matheson	June 16	VI	Center Ballroom	9:36 a.m.

Howard McGinn	June 14	III	North Ballroom	5:12 p.m.
Pamela Merideth	June 14	IV	Pacific Room	4:18 p.m.
David H. Morse	June 14	V	Balboa Room	4:00 p.m.
Margaret Norman	June 16	VI	Center Ballroom	10:12 a.m.
Anton J. Olson	June 14	I	Center Ballroom	5:12 p.m.
Dianne Olson	June 14	V	Balboa Room	4:18 p.m.
Judith A. Overmier	June 16	VII	Pacific Room	9:36 a.m.
Richard A. Peterson	June 14	IV	Pacific Room	4:00 p.m.
Linda Plunket	June 14	II	South Ballroom	4:00 p.m.
	June 16	VIII	South Ballroom	9:36 a.m.
Eugenie Prime	June 16	IX	North Ballroom	9:18 a.m.
Alan M. Rees	June 14	III	North Ballroom	5:12 p.m.
Pamela C. Reese	June 16	VIII	South Ballroom	9:18 a.m.
Elaine M. Russo	June 14	IV	Pacific Room	4:00 p.m.
Diane G. Schwartz	June 14	IV	Pacific Room	4:54 p.m.
Ronald Schwartz, Ph.D.	June 14	I	Center Ballroom	4:54 p.m.
Susan Selig	June 14	V	Balboa Room	5:12 p.m.
Cliff Solomon	June 16	IX	North Ballroom	10:12 a.m.
Sherrill Sorrentino	June 14	III	North Ballroom	4:36 p.m.
Bernie Todd Smith	June 16	IX	North Ballroom	9:00 a.m.
Joseph O. Smith	June 16	VIII	South Ballroom	10:12 a.m.
Bonnie Snow	June 16	X	Balboa Room	9:36 a.m.
Jeanne Law Spala	June 16	VII	Pacific Room	10:12 a.m.
Kathleen Syverson	June 14	I	Center Ballroom	4:54 p.m.
Faith Van Toll	June 16	VIII	South Ballroom	9:00 a.m.
	June 16	VIII	South Ballroom	9:54 a.m.
Eileen Wakiji	June 14	II	South Ballroom	4:54 p.m.
Patricia Wolfgram	June 16	VIII	South Ballroom	9:54 p.m.
Deborah K. Yedlin	June 14	I	Center Ballroom	4:36 p.m.
Nancy Whitten Zinn	June 16	VII	Pacific Room	9:18 a.m.
Alan E. Zuckerman, M.D.	June 14	I	Center Ballroom	4:00 p.m.
	June 14	I	Center Ballroom	4:18 p.m.
	June 14	II	South Ballroom	4:36 p.m.
	June 16	VI	Center Ballroom	9:36 a.m.

EXHIBITORS

Name	Booth Number
Addison-Wesley Publishing Co., Inc.	77
Adis Press, Inc.	78
Alfred Jaeger, Inc.	94
ARCO Publishing, Inc.	112D
Area, Inc.	43
Audio Visual Medical Marketing, Inc.	97
Avatar Systems, Inc.	38
Aves Audio Visual	115
Ballen Booksellers International, Inc.	95
Bibliographic Retrieval Services, Inc.	89
Birkhauser Boston, Inc.	102
Blackwell North America, Inc.	100
Boley Subscription Agency, Inc.	45
Book Examination Center (THE)	72
British Medical Journal.	98
Brodart, Inc.	109
Brown & Connolly, Inc.	88
Checkpoint Systems Inc.	110
CIBA Medical Education Division	60
CLASS	9
Combined Book Exhibit (THE)	1, 2, 3
Commonwealth Agricultural Bureaux	50
Computer Translation, Inc.	58
Coronet Health Care Education	52
Cumulative Index to Nursing and Allied Health Literature.	7
CPEC, Inc.	96
Data Phase Systems, Inc.	93
Demco, Inc.	47
Dialog Information Services, Inc.	69, 70
DTI Data Trek	66
EBSCO Subscription Services.	81, 82, 91, 92
Eliot Health Science Books	83
Elsevier North Holland	54
Encyclopaedia Britannica, Inc.	44
Environment Information Center, Inc. (EIC)	42
Excerpta Medica	64
F. W. Faxon Company, Inc.	5, 6
Gaylord Bros., Inc.	108

Name	Booth Number
Health Education Aids	87
Highly Specialized Promotions, Inc.	112A
Human Science Press	31
Institute for Scientific Information	99A, 99B
International Pharmaceutical Abstracts	10
Johnson Reprint Corp.	46
John Wiley & Sons, Inc.	57
Libin & Associates.	32
Login Brothers Book Company, Inc.	56
McGregor Magazine Agency.	55
Majors Scientific Books, Inc.	84, 85
Marcel Dekker, Inc.	87B
Marcive, Inc.	41
Matthews Medical & Scientific Books, Inc.	51
Martinus Nijhoff Booksellers and Subscription Agents	101
Medcom Products	106
Medical Economics Books.	87A
Medical Library Association, Inc.	86A, 86B
Microfilming Corporation of America	49
Mino-Micrographic Inc.	39
National Cancer Institute-ICRDB	98B
National Center for Health Statistics	99
NCME.	59
National Library of Medicine.	112, 113
OCLC	62, 63
OnLine Computer Systems, Inc.	111
Otto Harrassowitz	98A
Pergamon Press Inc.	104
Population Information Program (Johns Hopkins University).	86
Princeton Microfilm Corp.	48
Read-More Publications, Inc.	103
Rittenhouse Book Distributors.	67
Sable Corporation	112B
Science Image Communications	65
Systems Development Corp.—SDC Search Service	105
Scientific and Medical Publishers of France, Corp. (SMPF)	53
Social Issues Resources Series, Inc.	71
Springer Publishing Company	30
Springer-Verlag New York Inc.	90
Swets North America, Inc.	80
Saztec California, Inc.	29

Name	Booth Number
Turner Subscription Agency	73
TV Center for Continuing Medical Education	68
University Microfilms International.	74, 75
University of Michigan Media Library	107
University Park Press	76
Universal Serials & Book Exchange, Inc.	79
University Products Inc.	4
Van Nostrand Reinhold Company	87A
Wadsworth.	87A
Worden Company (THE)	61

SCIENTIFIC AND MEDICAL PUBLICATIONS FROM FRANCE INC.

485 FIFTH AVENUE
NEW YORK, N.Y. 10017

Telephone: 212 986-7752

CALL ON US FOR
INFORMATION AND REQUESTS
REGARDING FRENCH MEDICAL BOOKS.

C.N.R.S.
I.N.S.E.R.M.
MALOINE
SYMPOSIUM. DICTIONNAIRE

VIDAL AND ALL BI-LINGUAL
MEDICAL DICTIONARIES.
MASSON
EXPANSION SCIENTIFIQUE ETC. . . .

**PLEASE COME AND BROWSE
AT OUR BOOTH NO. 53**

check with hotel + ~~one~~ for maps

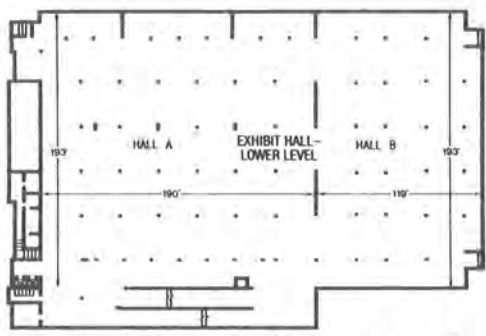
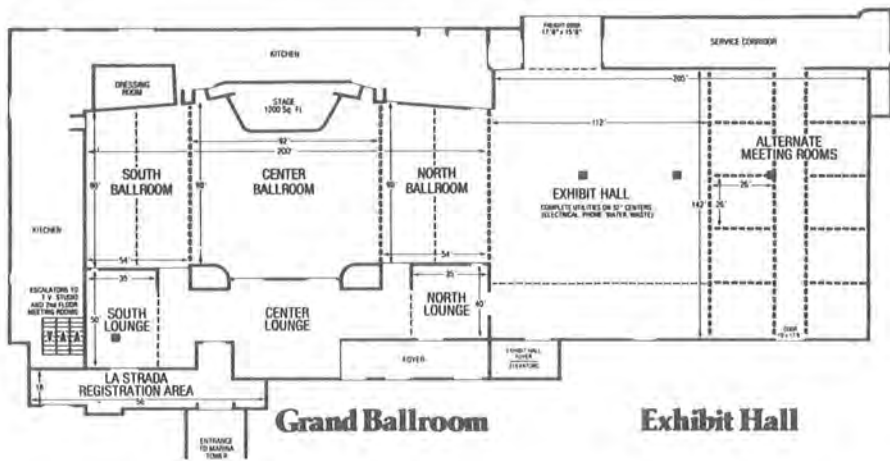

Convention Center



Sierra Conference Center

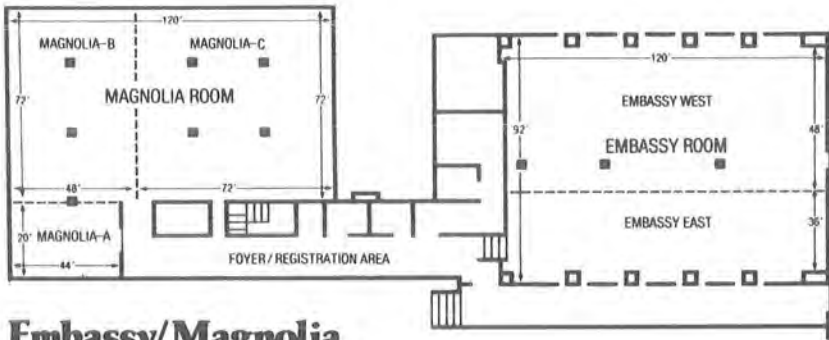

Embassy/Magnolia Center

Bonita Conference Center

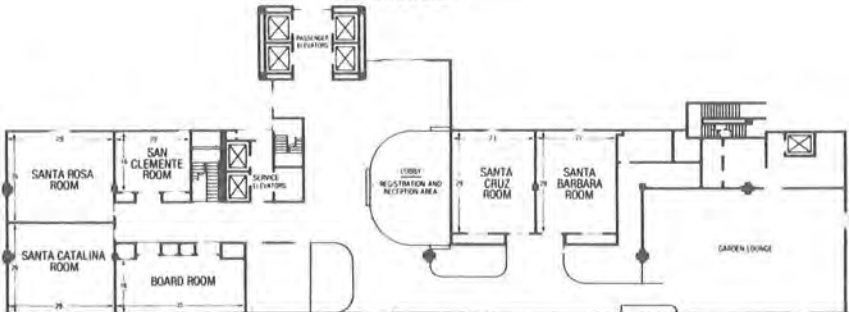



Intensive care for biomedical information. Dialog.

Dialog has now added the MEDLINE database (available worldwide), and that makes us the world's most comprehensive single source of medical, life science and biomedical reference information.

In that vital database group, MEDLINE joins Excerpta Medica, Biosis, International Pharmaceutical Abstracts, IRL Life Sciences, and Sci-Search. That's a total of more than 10 million medical, pharmaceutical, and biochemical references.

As the world's largest online information retrieval system, Dialog currently has more than 130 databases and 50 million references and abstracts. But the benefits of

biomedical searching in Dialog don't end there. For example, our *online* coverage of MEDLINE goes all the way back through 1966. And we offer a variety of contract options to suit any budget.

With our unbeatable collection of databases, excellent training programs and superb documentation, Dialog is clearly the best choice for modern reference searching, particularly in the biomedical field.

Get complete information from Dialog Information Services, Dept. 70, 3460 Hillview Ave., Palo Alto, CA 94304. Call toll-free (800) 227-1927. In California, call (800) 982-5838.

 **Lockheed Dialog**

Booth #69-70

WE CAN CARVE THIS MOUNTAIN DOWN TO A MOLEHILL!



Busy health care professionals are faced with a mounting dilemma: how to distill cumbersome medical journals into the "hands-on" knowledge needed to meet today's challenges.

The UPDATE SERIES periodicals feature the nation's leading authorities presenting the latest developments and state-of-the-art techniques in medicine's most demanding specialties.

"Hands-on" tools for today. . .
Valuable references for tomorrow.



Continuing
Professional
Education
Center, Inc.

1101 State Road, Bldg. Q / Princeton, NJ 08540 / (609) 924-4500

