

"Partnerships"

MLA '86



Medical Library Association
86th Annual Meeting
Minneapolis, Minnesota
May 16-22, 1986

PaperChase

the user-friendly search program that provides instant, easy access to the MEDLINE file.

- No search training needed
- View abstracts online
- Request reprints of any article in the database
- No registration fee or monthly minimum

Volume discounts are automatically applied.

Ask us about arranging a PaperChase Workstation for your library or institution.



**...a little help
from a friend**

Meet us at MLA - booth #23

PaperChase

Beth Israel Hospital
330 Brookline Avenue
Boston, MA 02215
(617) 735-2253

Official Program

**86th Annual Meeting
Medical Library Association
May 16 - 22, 1986
Minneapolis, Minnesota**



*"It says Majors Booth Numbers are 39 & 44,
and they are sure looking forward to seeing us."*



MAJORS SCIENTIFIC BOOKS, INC.

Dallas 1851 Diplomat 75234 214-247-2929 (collect)
1-800-527-3492 (outside TX) 1-800-442-5086 (TX only)
New Orleans 3909 Bienville 70119 504-486-5956 (collect)
Houston 6632 South Main 77030 713-526-5757 (collect)
Atlanta 3770-A Zip Industrial Blvd. 30354
404-768-4956 (collect) 1-800-241-6551 (outside GA)

Welcome to the 86th Annual Meeting of the Medical Library Association!

Minneapolis and St. Paul highlight this year's theme of Partnerships. Even in this age of competition, the Twin Cities complement each other. They combine the neighborly charm of the old and the energetic technology of the new. Together these cities offer a unique mix of comfort and convenience in a community known for scholarly and scientific innovation.

The cry of the loon is said to have a magical hold on those who hear it the first time. Perhaps it is true for MLA. We were here ten years ago. Now we return, joining friends and colleagues from across the country and around the world.

This meeting has come to be only through the efforts of many individuals and groups. My thanks go to the members of the 1986 National Program Committee and the Local Assistance Subcommittees, as well as Sections, Exhibitors, Donors, Staff . . . and the many MLA members who share their knowledge and skill throughout the meeting.

A wide range of structured educational opportunities are linked to meet the needs and interests of both the first-time attendee and the MLA "veteran." Nationally known speakers, a colloquium for hospital librarians, poster sessions, seminars and courses, topical roundtables, contributed papers, and local library tours: all are combined in a diverse and challenging program.

Here in this city of unsurpassed hospitality, we will refresh our memories, strengthen the partnerships and networks of expertise which enrich our profession, and gain new insights on the opportunities for innovation which surround us.

Welcome to MLA '86 — Partnerships!

Holly Shipp Buchanan
Chairman
1986 National Program Committee

You can't judge a book by its title . . .

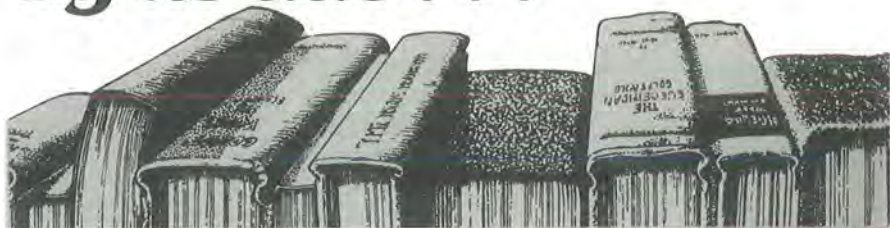

. . . that's why you need the **NEW** **Index to Scientific Book Contents™!**

Searching multi-authored scientific books can be difficult and time-consuming . . . because their titles don't generally reflect individual chapter contents. Beginning in 1986 the *Index to Scientific Book Contents* will give you chapter-level access, simplifying the search process and saving you valuable time! *ISBC™* is the *only* multi-disciplinary index to science books that gives your patrons the coverage of chapter contents they need.

With *ISBC*, you can retrieve information through a variety of access points—author name, editor name, chapter subject, book subject, and author affiliation. So it's easy to pinpoint exactly those book chapters relevant to a specific research area.

ISBC indexes nearly 36,300 chapters from over 2,200 newly published, significant scientific books. And *ISBC* provides multi-disciplinary coverage of books in all scientific subject areas. There's no need to search individual, discipline-oriented indexes for the information you need.

You'll find *ISBC* important for:

- current awareness—*ISBC*'s quarter-

ly issues offer timely coverage

- bibliographic verification—*ISBC*'s complete bibliographic information on books and chapters enables you to verify citations
- retrospective searching—*ISBC* is cumulated annually
- acquisitions—*ISBC*'s currency will help you identify and select important new multi-authored books

No other *single index* helps you locate multi-authored scientific books and book chapters as quickly and easily as the *Index to Scientific Book Contents*.

The new *Index to Scientific Book Contents* is from the publishers of *Current Contents®* and the *Science Citation Index®*. Beginning in 1986, *ISBC* is published in three quarterly issues and an annual cumulation. A 1985 annual is also available.

For more information—and a free sample issue—call toll-free (800) 523-1850, extension 1405.

Stop by Booths 31 and 32 to Enter Drawing for FREE *ISBC* Annual Sample issues available

isi®

Institute for Scientific Information®

Customer Services Department, 3501 Market Street, Philadelphia, PA 19104 U.S.A.
Telephone: (215)386-0100, ext. 1405, Cable: SCINFO, Telex: 84-5305
European Office: 132 High Street, Uxbridge, Middlesex UB8 1DP, United Kingdom
Telephone: 44-895-70016, Telex: 933693 UKISI

© 1986 ISI
259-4202

TABLE OF CONTENTS

	Page
Appointed Officials	3
Committee Meeting Schedule	61
Continuing Education Courses	19
Contributions	72
Daily Program	27
Exhibitors	65
General Information	13
Hotel Layout (Hyatt Regency)	74
Informal Meetings	63
Local Arrangements Committees	5
Minneapolis Map	76
MLA Headquarters Staff	8
MLA Board of Directors, 1985-86	1
National Program Committee, 1986	5
Placement Service	16
Registration	13
Speaker and Author Index	69

The Daily Program

Wednesday, May 14

Board of Directors Meeting	27
----------------------------------	----

Thursday, May 15

Board of Directors Meeting	27
----------------------------------	----

Friday, May 16

Board of Directors Strategic Planning	27
Continuing Education Courses	27

Saturday, May 17

Board of Directors Meeting	27
Continuing Education Courses	28
Hospital Library Colloquium	28

Sunday, May 18

Continuing Education Courses	28
Chapter Council Meeting	28
Section Council Meeting	28
Hospital Library Colloquium	28
Reception and Orientation for New Members, International Visitors, and First-time Attendees	28
Opening Session	28
Keynote Address	29
Welcome Reception	29

Monday, May 19

Committee Meetings	29
Plenary Session I	30
Exhibit Opening	30
Section Meetings	31, 35
Contributed Papers Sessions I	32
Exhibitor's Reception	37

Tuesday, May 20

Section Meetings	37
Business Meeting I/Presidential Address	38
Plenary Session II	42
Poster Session I	43
Professional Development Roundtables	44
Exhibitor Demonstrations	46
Informal Meetings	47

Wednesday, May 21

Committee Meetings	47
Honors and Awards	48
Janet Doe Lecture	48
Luncheon for MLA Board of Directors, Incoming Committee, Chapter, and Section Chairmen, and MLA Professional Staff	48
Exhibitor Demonstrations	48
Informal Meetings	49
Business Meeting II	49
Section Meetings	49

Thursday, May 22

Committee Meetings	51
MLA/NLM Liaison Committee Program II	51
Business Meeting III	52
Inaugural Address	52
Plenary Session III/McGovern Award Lecture	52
Poster Session II	52
Chapter Council Meeting	54
Section Council Meeting	54
Contributed Papers II	55

Friday, May 23

Board of Directors Meeting	58
Workshop on Item Development	58

Saturday, May 24

Board of Directors Meeting	58
----------------------------------	----

Light years ahead.

A dramatic advance in serials check-in has arrived. MicroLinX is here.

Until now, you've only dreamed of such speed and accuracy. A bar code scanner attached to your personal computer enables MicroLinX to read SISAC and UPC codes, and automatically check in the specific issue you've received. With a growing number of publishers committed to printing these codes, libraries of all sizes can save time with this reliable feature.

MicroLinX also offers easy downloading, predictive check-in and electronic claims transmission through Faxon's global network of libraries and publishers. Additional software modules will soon be available, making this a comprehensive serials management system.

Let MicroLinX check in your journals with the speed of light. Call 800 225-6055 toll free, or 617 329-3350 collect.

faxon

A Future You Can Look Forward To



If it's about behavior, you'll find it in PsycINFO

And you'll find
PsycINFO at
Booth 72

Demonstrations of:

- PsycLIT on
CD-ROM
- PsycINFO
Database Online
- PsycALERT
Database Online

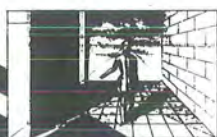

Write for your free
Guide to PsycINFO today.

Psychological Abstracts
Information Services
1200 Seventeenth Street, NW
Washington, DC 20036

800-336-4980—Toll Free
(In Virginia, Call 703-247-7829)



1985-86 MLA BOARD OF DIRECTORS

Jean K. Miller, *President*
Library
Health Sciences Center at Dallas
University of Texas
Dallas, Texas

Judith Messerle, *President-Elect*
Medical Center Library
St. Louis University
St. Louis, Missouri

Phyllis S. Mirsky,
Immediate Past President
Central University Library
University of California at San Diego
La Jolla, California

Rachael K. Anderson, *Director*
Health Sciences Library
Columbia University
New York, New York

Jacqueline D. Bastille, *Director*
Treadwill Library
Massachusetts General Hospital
Boston, Massachusetts

Gary D. Byrd, *Director*
Health Sciences Library
University of North Carolina
Chapel Hill, North Carolina

- * June Fulton, *Director*
College of Physicians
of Philadelphia
Philadelphia, Pennsylvania

Eleanor Y. Goodchild, *Director*
Biomedical Library
University of Pennsylvania
Philadelphia, Pennsylvania

Frances Groen, *Director*
Medical Library
McGill University
Montreal, Quebec, Canada

Jane Lambremont, *Director*
Region 2 Regional Medical Library
Health Sciences Library
University of Maryland
Baltimore, Maryland

Richard A. Lyders, *Director*
Texas Medical Center Library
Houston Academy of Medicine
Houston, Texas

- Madeline V. Taylor, *Director*
George F. Smith Library
University of Medicine and
Dentistry of New Jersey
Newark, New Jersey

Raymond A. Palmer,
Executive Director
Medical Library Association
Chicago, Illinois

- * Section Council Chairman
- Chapter Council Chairman

Instant relief for back issue problems.

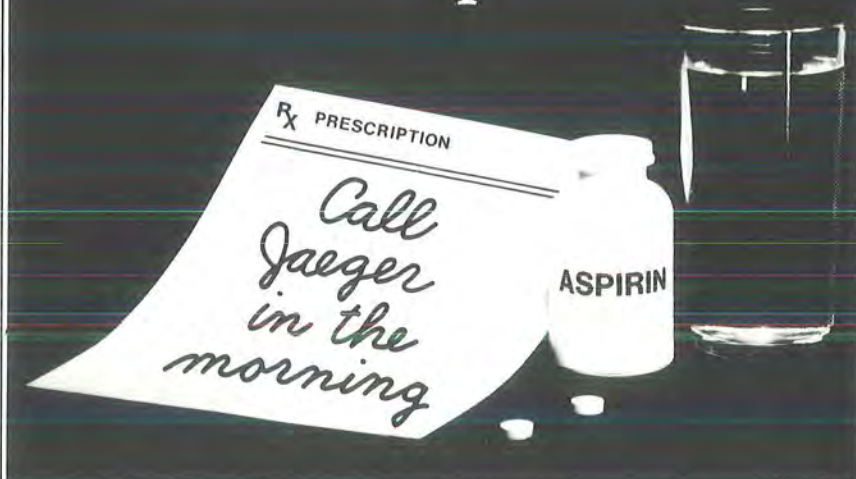

Jaeger. Your one source for out-of-print and specialized Health Science periodicals.

Our comprehensive inventory is sure to include the exact material you need from all over the world. That's why we've been a primary source for health science libraries for more than 25 years. Simply send us your list of requirements and we'll respond promptly with a quote. And now you can even access us through the FAXON-LINX network under "Jaeger". By the way, we'll also be glad to purchase your duplicate copies. So for instant relief for back issue problems (or if your clientele prefer the hard copy over microform) Jaeger is the prescription. Contact us today. Write or call Toll Free 1-800-453-0011. In New York State 516-543-1500.



**ALFRED
JAEGER
INC.**

66 Austin Boulevard, Commack, NY 11725
Phone (Code 516) 543-1500 • TELEX: 968-189
Cable Address: JAEMAGS, COMMACK

**CALL
TOLL
FREE**

**1-800-
453-0011**
(Outside of New York State Only)

ALFRED JAEGER INC.

Dept. M, 66 Austin Blvd., Commack, NY 11725

Gentlemen: Please send your latest catalog and brochure.

Name

Title

Company/Facility

Address

City State Zip

Phone

Visit our exhibit booths #1 and #2

APPOINTED OFFICIALS

Raymond A. Palmer,
Executive Director
Medical Library Association
Chicago, Illinois

M. Kent Mayfield, Ph.D.,
Director of Education
Medical Library Association
Chicago, Illinois

Minnie Orfanos, *Trustee*
The Dental School Library
Northwestern University
Chicago, Illinois

Charles W. Sargent, *Ph.D.,
Parliamentarian*
Library of the Health Sciences
Texas Tech University
Health Sciences Center
Lubbock, Texas

Darel Robb, *Sergeant-at-Arms*
Norman, Oklahoma

Nancy Fabrizio, *Editor, MLA News*
Health Sciences Library
SUNY at Buffalo
Buffalo, New York

Susan Crawford, *Ph.D., Editor,
Bulletin of the Medical Library
Association*
Washington University
School of Medicine Library
St. Louis, Missouri

'REMO' IS THE FUTURE[®]

OF
AUTOMATED
SERIALS
MANAGEMENT

READ-MORE PUBLICATIONS

LIBRARY PERIODICAL SUBSCRIPTION AGENCY

1-212-349-5540

THE FUTURE IS HERE.[®]

SEE A DEMONSTRATION OF THE 'REMO' AUTOMATED SYSTEM AT:

[BOOTH 35]

1986 NATIONAL PROGRAM COMMITTEE

Holly Shipp Buchanan, *Chairman*
NKC Hospitals
Louisville, Kentucky

Richard E. Lucier,
Associate Chairman
Carrboro, North Carolina

Frances A. Bischoff, *Member*

Robert Braude, *Member*

Cyril C. Feng, *Member*

Dorothy Fitzgerald, *Member*

Richard B. Fredericksen, *Member*

Sherrilynne Fuller, *Ph. D., Member*

Stephena E. Harmony, *Member*

Samuel Hitt, *Member*

Carol Jenkins, *Member*

Eugenie Prime, *Member*

Robert J. Sekerak, *Member*

Jeane E. Strub, *Member*

M. Kent Mayfield, Ph.D.,

Program Director

Estella L. Smith,

Conference Coordinator

Jean K. Miller,

Board of Directors Liaison

Local Assistance Committee

Sherrilynne Fuller, *Ph.D. Chairman*

Hospitality Committee

Barbara Brian, *Chairman*

Marianne Kelley

Mary Mueller

Sandra Tarman

Publicity Committee

Gertrude Foreman, *Chairman*

Ruth Makinen

Mary Ellinghuysen

Gale Hannigan

Donna Barbour-Talley

Vicki Glasgow

Janet Arth, Editor, Newsletter

Elaine Trzebiatowski

Diane Ebro

Pam Ahrens

Social Events Committee

Patty Williams, *Co-Chairman*

Diane Jordan, *Co-Chairman*

Vicki Glasgow

Barbara Brian

Jacqueline Wulff

Nancy Battaglia

Sue Ager

Tours Committee

Mary Dolan, *Co-Chairman*

Annelie Sober, *Co-Chairman*

Betty Sande

Sandra Tarman

Facilities Assistance Committee

Mary Dolan, *Chairman*

Continuing Education

Assistance Committee

Vicki Glasgow, *Chairman*

Online, Where Can You Find:

- MEDLINE journals before they're put in MEDLINE?
- Full control of your searches on PDQ?
- The complete text of *The New England Journal of Medicine*?
- Management software for library-based, end-user searching?

On Colleague!

The online medical literature and information service from BRS/Saunders.
Booth 37-38 at the MLA meeting.

- **MEDLINE journals previewed**—Colleague's PREV database provides the most up-to-date index of articles from 211 important journals (83 with abstracts) weeks before they appear in MEDLINE.
- **PDQ enhanced**—Colleague's powerful, user-friendly system gives you precise control of your search strategy and fast, direct retrieval from this comprehensive source of cancer information.
- ***The New England Journal of Medicine* online**—Online each week on the day of publication, exclusively on Colleague.
- **End-user searching**—PROMPT SEARCH, Colleague's microcomputer software for managing library-based, end-user Colleague searching, makes account administration easy; PROMPT SEARCH does the paperwork.

Visit the Colleague Exhibit at MLA

Colleague contains the complete text of 22 journals and periodicals and 28 medical books, as well as standard bibliographic sources including MEDLINE — all of them searchable in the same fast, direct, user-friendly way.



BRS/Saunders
Colleague

Give your patrons the index that covers the *human* side of medicine: **The Social Sciences Citation Index®.**

As every medical librarian knows, the medical sciences, the social sciences, and the behavioral sciences are closely related. That's why every medical library needs the *Social Sciences Citation Index*.



1,445 journals!

Many medical libraries rely on the *SSCI* for this valuable coverage: the University of Arizona Health Sciences Center, the Houston Academy of Medicine, Letterman Army Medical Center, Massachusetts General Hospital, and

the University of North Carolina School of Medicine are just a few of them. And we invite you to join them . . .

The *SSCI*® can add valuable coverage to *your* reference collection in the many areas concerned with the human aspect of medicine . . . topics like drugs and addiction, gerontology, social issues, rehabilitation, psychology, and hygiene and public health. And the *Social Sciences Citation Index* can give your patrons access to every item from more than

For more information, stop by ISI's Booths 31 & 32. And for a free sample issue of *SSCI*, fill out and mail the coupon below.

From the producers of *Current Contents*® and the *Science Citation Index*®.

Please send me a free sample issue of the *Social Sciences Citation Index*®. I understand that there is no cost or obligation.

Name/Title

Organization/Department

Address

City

State/Province

Country

Zip/Postal Code

Telephone

isi®

Institute for Scientific Information®

Customer Services Department, 3501 Market Street, Philadelphia, PA 19104 U.S.A.
Telephone: (215)386-0100, ext. 1371, Cable: SCINFO, Telex: 84-5305

European Office: 132 High Street, Uxbridge, Middlesex UB8 1DP, United Kingdom
Telephone: 44-895-70016, Telex: 933693 UKISI

259-4249
©1986 ISI

MLA HEADQUARTERS STAFF

Administration

Raymond A. Palmer, Executive Director

Vicki Doyle, Administrative Assistant

Lisa McKamy, Staff Assistant

Ray Naegele, Director of Administrative and Financial Services

Bertha Puehringer, Accounting Manager

Patricia Carolan, Secretary for Membership and Public Relations

Janet Rathberger, Membership and Administrative Records Assistant

Michael Logan, Supply and Operations Assistant

Program Development

M. Kent Mayfield, Ph.D., Director of Education

Eileen Fitzsimons, Ph.D., Program and Information Resources Coordinator

Assistant to Director of Education

Estella L. Smith, Conference Coordinator

Frances L. Rickey, Secretary

Marc R. Elledge, Assistant for Program Services

Communications

Rita Shafer, Director of Communications

Bertha Ruckman, Secretary

**People with
CLASS
pay less for:**

VU/TEXT
DP DIALOG
WILSONLINE **BRS**
INFORMATION TECHNOLOGIES

Online Searching Discounts
available through

CLASS

Cooperative Library Agency for Systems and Services

Dept. MLA
1415 Koll Circle, Suite 101
San Jose, CA 95112-4698
(408) 289-1756

Don't be an old timer



be

OnTyme[®]

The Electronic Mail Service

through

CLASS

Cooperative Library Agency for Systems and Services

Dept. MLA
1415 Koll Circle, Suite 101
San Jose, CA 95112-4698
(408) 289-1756

OnTyme is a service mark of McDonnell-Douglas Corp

GEORGETOWN UNIVERSITY MEDICAL CENTER
Library Information System

A fully integrated system with a
master bibliographic file

L I S

Stop by Booth 73
For an online demonstration

Fully operational
components for all library
functions:

- The miniMEDLINE SYSTEM™
- Online catalog
- Circulation
- Serials
- Acquisitions
- Accounting
- Word processing
- ILL/networking

The miniMEDLINE SYSTEM
A self-search bibliographic search
system based on a subset of
MEDLINE

ANS MUMPS language; runs on a full
range of DEC processors; PDP 11
series, 11/23 to 11/84; VAX series
microVAX—8600

* The miniMEDLINE SYSTEM is a trademark of
Georgetown University.

Current LIS subscribers are the health science libraries of:

Catherine McCauley Health Center
Cornell University Medical College
—Memorial Sloan Kettering Hospital
—Payne Whitney Psychiatric Clinic
—Hospital for Special Surgery
Eastern Virginia Medical School
Georgetown University Medical Center
Johns Hopkins University (miniMEDLINE)
Medical College of Georgia
Medical University of South Carolina
Rush-Presbyterian-St. Luke's Medical Center
St. John Medical Center (miniMEDLINE)
Texas College of Osteopathic Medicine

Texas Tech University Health Sciences Center
—Lubbock, El Paso, Amarillo, Odessa
Thomas Jefferson University
University of Alabama, Birmingham
University of Nebraska
University of Puerto Rico
University of South Carolina
University of Texas Health Science
Center at San Antonio
The Upjohn Company
—Corporate Technical Library
—Business Library
—12 branch collections



Since 1853

NORTH AMERICA
190 Old Derby Street
Hingham, MA 02043
(617) 749-5266, Collect

THE NETHERLANDS
P.O. Box 269
2501 AX The Hague
Telex: 34164 NIJBUNL

MARTINUS NIJHOFF INTERNATIONAL
BOOKSELLERS AND SUBSCRIPTION AGENTS

STRONG WEST-EUROPEAN MEDICINE
BOOTH 77

A number of outstanding Medical Libraries have chosen us for our service. We supply West-European academic journals and books in a professional yet personal way. Please visit Booth 77 and ask us about:

- Automated journals department, providing machine-readable invoicing, claim and bibliographical reports
- Special reduced service-charge agreements
- Bibliorecords, a slip notification system
- Monthly new academic titles catalogue
- Customized approval plans
- Airfreight system for monographs and bookseries
- Standing orders and continuations program
- Antiquarian department and out-of-print searching
- North American Liaison office for professional assistance

OCLC UPDATE

OCLC EASI Reference and OCLC Gateway Service

Make the Most of OCLC and BRS

In a medical library you're concerned with efficient, cost-effective online information retrieval. Now you can make the most of both the OCLC Online System and the BRS Information Technologies system with two exciting new OCLC services: *EASI Reference* and the *Gateway Service*.

If you've longed for the day when you'd have subject access to the vast resources of the OCLC Online Union Catalog, the wait is over. OCLC EASI Reference provides extensive, up-to-date coverage of a significant portion of the world's largest bibliographic database. Approximately one million citations representing materials from all eight cataloging formats, including books, serials, sound recordings, and software, are available to BRS subscribers on the EASI Reference database (BRS Database Label: OCLC). You'll also be pleased to know that EASI Reference is as cost effective as it is comprehensive, particularly if your library is an OCLC member.

And now you can make the most of your OCLC dedicated-line terminal with the OCLC Gateway Service. The Gateway Service enables you to access both the OCLC Online System and the BRS system from a single, OCLC dedicated-line terminal, providing one point of access to the entire range of OCLC and BRS online services. Using the Gateway Service and a BRS password, you can move

with ease from the OCLC Online System to any one of more than 100 BRS databases, including EASI Reference. What's more, Gateway Service telecommunications charges are probably less than you're now paying.

Neither OCLC EASI Reference or the OCLC Gateway Service requires extensive training, and both services are supported by OCLC, its affiliated networks, and BRS.



Visit the OCLC booth for information about these and many other OCLC services.



Online Computer Library Center
6565 Frantz Road
Dublin, Ohio 43017-0702
(614) 764-6000

American Medical Periodicals 1797-1900

*From holdings at the
National Library of
Medicine and other major
institutions, a new and
important microfilm
publication from
Research Publications.*



American Medical Periodicals, 1797-1900 offers unique research possibilities — with over 1,200 19th-century medical periodicals documenting the evolution of American medical thought as it was recorded by contemporary literature.

Through these periodicals, researchers will have insights into the important issues and events during the formation of American medicine and medical practices, and their influence on American society,

including:

- the introduction of anesthetics in surgery
- improvement in diagnosis and therapeutics
- the rise of the public health field
- allopathic, homeopathic, and naturopathic medicine
- debates between faddish medical practitioners and rising medical professionals

This collection is being released in units of 50 reels each at the standing order unit price of \$2,950 per unit—a savings of 15% off the individual unit price. Prices are for U.S. and Canada only. Shipping and handling charges will be added.

Research Publications
12 Lunar Drive/Drawer AB
Woodbridge, CT 06525
(203) 397-2600
Toll-free: 1-800-REACH-RP
TWX: 710-465-6345
FAX: (203) 397-3893

Outside North and South America:
P.O. Box 45
Reading, RG1 8HF England
TEL: 0734-583247
TELEX: 848336 NADL G
FAX: 011-44-734-591325

rp

research publications®

GENERAL INFORMATION

Registration

Registration for the 1986 Annual Meeting takes place in the Hyatt Regency Hotel, Second Floor Balcony overlooking the Atrium, as follows:

Thursday, May 15	4:00 p.m. - 8:00 p.m.
Friday, May 16	7:00 a.m. - 8:30 a.m.
	4:00 p.m. - 8:00 p.m.
Saturday, May 17	7:00 a.m. - 6:00 p.m.
Sunday, May 18	7:00 a.m. - 6:00 p.m.
Monday, May 19	8:00 a.m. - 5:00 p.m.
Tuesday, May 20	8:00 a.m. - 5:00 p.m.
Wednesday, May 21	8:00 a.m. - 5:00 p.m.
Thursday, May 22	8:00 a.m. - 12:00 noon

Official conference badges, ribbons, programs, tickets, and other meeting material are available at the Registration Booth.

Tickets

Tickets for special events, if still available, are on sale in the registration area during the official hours of registration (see above).

In most cases, **ticket sales end 48 hours prior to the starting time of the particular event.** Please note the ticket sales cut-off time for each event as announced in the daily program section of the Official Program. If you have any questions about tickets, inquire at the Ticket Booth in the registration area.

Meeting Rooms

Meeting Rooms are located in two hotels, which are within walking distance of each other: The Hyatt Regency and the Minneapolis Plaza. The location of the two hotels is shown on the map on page 76.

Hyatt Regency

Meeting rooms are located on the:

- First Floor
- Second Floor

Study the map that is included in the Official Program, and, if possible, take a walk through the hotel when you first arrive.

Minneapolis Plaza

Meeting rooms are located on the:

- Lobby Level
- Plaza Level

Should you have any questions about the locations of the meeting rooms, inquire at the Hospitality/Information Center in the Hyatt Regency Hotel.

Featuring MLA . . .

The MLA booth, located next to the Registration Area, has a new look this year. In addition to information on the Association and its publications, the exhibit displays samples of several new items available for sale to Annual Meeting attendees. They include:

MLA pin: the first official MLA jewelry, this attractive gold and enamel lapel pin can be proudly worn by all MLA members.

MLA Note Pad: these practical 500-sheet pads with the MLA logo are ideal for short messages and notes. You'll want one for the office and home as well.

ALA Posters: brighten up your library, office, or home with your choice of one of these American Library Association posters.

All items on display at the MLA store, including publications, can be purchased at the Registration Area. Pay by check, cash, traveler's check, MasterCard or Visa. Please note that quantities of most items are limited and may be purchased only during the Annual Meeting.

The Hospitality/Information Center

Welcome to Minneapolis! The Hospitality/Information Center has information about conference program, the city of Minneapolis, and points of interest in the surrounding area. Feel free to drop by and plan your day. The Center is located on the first floor in front of the Nicollet Ballroom at the Hyatt Regency Hotel. Hours of operation are:

Thursday, May 15	4:00 p.m. - 8:00 p.m.
Friday, May 16	7:00 a.m. - 8:30 a.m.
	4:00 p.m. - 8:00 p.m.
Saturday, May 17	3:00 p.m. - 6:00 p.m.
Sunday, May 18	12:00 noon - 6:00 p.m.
Monday, May 19	8:00 a.m. - 5:00 p.m.
Tuesday, May 20	8:00 a.m. - 5:00 p.m.
Wednesday, May 21	8:00 a.m. - 5:00 p.m.
Thursday, May 22	8:00 a.m. - 12:00 noon

MLA Scholarship Booth

Support MLA's scholarship program with tax-free donations by purchasing T-shirts and coffee mugs. Stop by the Scholarship Booth to make your donation and to receive these mementos of MLA Minneapolis '86. Cash, checks, Visa, and MasterCard are accepted. The Scholarship Booth (Promenade South outside Exhibit Hall, Hyatt Regency Hotel) operates during the following hours:

Saturday, May 17	3:00 p.m. - 6:00 p.m.
Sunday, May 18	12:00 noon - 6:00 p.m.
Monday, May 19	8:00 a.m. - 5:00 p.m.
Tuesday, May 20	8:00 a.m. - 5:00 p.m.
Wednesday, May 21	8:00 a.m. - 5:00 p.m.
Thursday, May 22	8:00 a.m. - 12:00 noon

The 1986 Exhibit

Suppliers to the biomedical information community are exhibiting their latest goods and services to MLA members. The Exhibit is located in the Exhibit Hall of the Hyatt Regency Hotel. Hours for the Exhibit are:

Monday, May 19	11:00 a.m. - 6:00 p.m. 7:00 p.m. - 9:00 p.m.
Tuesday, May 20	11:00 a.m. - 6:00 p.m.
Wednesday, May 21	11:00 a.m. - 6:00 p.m.

Special exhibitor demonstrations take place on Tuesday and Wednesday.

Buy a sandwich in the Exhibit Hall restaurant and use the opportunity to browse through the exhibits. And don't forget to attend the grand opening of the Exhibit on Monday, May 19 at 11:00 a.m. or the Exhibitor's Reception on Monday, May 19 from 7:00 p.m. to 9:00 p.m.

Explore the Exhibits Contest

Everyone enjoys the opportunity to visit the Exhibits and the chance to see advances in technology, new publications, and other goods and services of interest to the biomedical information community.

This year, though, there is yet another reason to visit the exhibits — the chance to win one of the several prizes being given away to registrants who complete their "Explore the Exhibits" form included in the registration materials.

The prizes include an airline ticket to the 1987 Annual Meeting in Portland, complimentary conference - only registration for the 1987 Annual Meeting, dinner for two at the Bristol Bar and Grill in Minneapolis, books on Minneapolis and Portland, and reduced fees for 1987 Annual Meeting Continuing Education Courses. A full list of all prizes will be posted outside the Exhibit Hall.

Each Explore the Exhibits form identifies 20 exhibitors spread throughout the exhibit area. To participate in the contest, all you need to do is have a company representative sign your form when you visit each of the 20 specially marked exhibits. When you have all the required signatures, complete the bottom of the form with your name and address and drop it into the contest box at the entrance to the exhibit hall.

The first drawing will be held Monday evening, May 19 at the Exhibitors' Reception. Additional drawings will be held Tuesday, Wednesday, and Thursday, with times and locations posted outside the Exhibit Hall. Please note that winners must claim their prizes by 5:00 p.m., Thursday May 22. No prize can be claimed after the Annual Meeting and none will be mailed to the winners. Only MLA conference

registrants may participate; representatives of exhibiting companies, daily exhibit pass holders, members of the MLA and hotel staffs, and other firms providing services to the Annual Meeting are not eligible.

Placement Service

The MLA Minneapolis '86 Placement Service may be used by any Annual Meeting attendee to list job openings or to register as a job applicant from "entry" through "upper management" levels. The Placement Service is located in the Nicollet Foyer 4, First Floor.

Notebooks of job descriptions and a bulletin board announcing job openings are maintained in the Placement Service. Notebooks of applicant resumes are available for review by employers registered with the Placement Service.

Conference attendees can obtain the necessary forms to list job openings or applicant resume forms from the Placement Service during its hours of operation. Interviews between job applicants and employer representatives can be arranged through the Placement Service.

The Placement Service is open during the following hours:

Thursday, May 15

Administrative Services (Registration Desk) 4:00 p.m. - 8:00 p.m.

Friday, May 16

Administrative Services (Registration Desk) 7:00 a.m. - 8:30 a.m.

4:00 p.m. - 8:00 p.m.

Saturday, May 17 8:00 a.m. - 6:00 p.m.

Sunday, May 18 8:00 a.m. - 4:30 p.m.

Monday, May 19 8:00 a.m. - 4:30 p.m.

Tuesday, May 20 8:00 a.m. - 4:30 p.m.

Wednesday, May 21 8:00 a.m. - 4:30 p.m.

Thursday, May 22 8:00 a.m. - 12:00 noon

Convention Ribbons

White Officers, Board Members, and Appointed Officials

Blue (dark) Chapter Council Representatives and Alternates

Blue (light) Committee Chairs

Gold Membership Committee

Green (dark) Section Council Representatives and Alternates

Green (light) First-Time Attendees, New Members, and Guests

Lavender International Cooperation Committee and International Visitors

Orange MLA Headquarters Staff

Pink (light) Hospitality Committee and Volunteers

Purple Exhibitors

Red Sponsors

Rose National Program Committee

Yellow Instructors, Speakers, and Moderators

Those with questions concerning ribbons should inquire at the Registration Booth in the Second Floor Balcony overlooking the Atrium of the Hyatt Regency Hotel.

Convention Badges

The color of the registration badge indicates certain types of membership in MLA:

BlueRegular, Fellow, Honorary, Life

PinkInstitutional Representative

YellowInstitutional Representative and one of the above categories

WhiteNon-Member, Exhibitor, Sustaining, Associate, Student

The MLA Daily Newsletter

The MLA daily newsletter for the 1986 Annual Meeting includes:

- items of interest
- additions to the Official Program
- room changes
- cancellations
- informal meetings
- local events and attractions

Meeting participants are welcome to submit items for publication. *Copy for the next day's issue* must be submitted to the MLA Office *no later than 12:00 noon of the preceding day*. The location of the MLA Office is the Regency Room at the Hyatt Regency Hotel.

Pick up a copy of the MLA daily newsletter at the Hospitality/Information Center, the Registration Booth, or at the entrance to the general sessions of the conference.

New from Human Sciences Press

Napodano, Rudolph J., M.D.

VALUES IN MEDICAL PRACTICE

A Statement of Philosophy for Physicians and Model for Teaching a Healing Science

This forward-looking work argues eloquently that the teaching of empathy and compassion must go hand in hand with the teaching of science and biotechnology, in the preparation of physicians for effective practice.

1986 148 pp. (approx.)
0-89885-268-4 \$24.95

Brown, J.H.U., Ph.D.

THE HIGH COST OF HEALING

Physicians and the Health Care System

This insightful volume explores the responsibility that physicians must bear for the high cost of medical care today.

"... written in a clear and understandable style.
... Recommended."

—CHOICE

1985 213 pp.
0-89885-222-6 \$26.95

Freedman, Alfred M., M.D.;
Richard Brotman, Ph.D.;
Irving Silverman, Ph.D., M.P.H.; and
David Hutson, M.S.W., editors

ISSUES IN PSYCHIATRIC CLASSIFICATION

Science, Practice and Social Policy
Foreword by Lothar B. Kalinowsky, M.D.

1986 240 pages (approx.)
0-89885-294-3 \$29.95

Wu, Wen-Hsien, M.D., editor

PAIN MANAGEMENT

Assessment and Treatment of Chronic and Acute Syndromes

This multidisciplinary collection provides the primary care physician with information on chronic and acute pain.

1986 380 pp. (approx.)
0-89885-265-X \$39.95

Harris, Jay E., M.D.

CLINICAL NEUROSCIENCE From Neuroanatomy to Psychodynamics

This groundbreaking book, in reconciling psychoanalytic theory with recent findings in neuroscience, is designed to help the clinician become better oriented in the rapidly changing world of post-modern psychiatry.

1986 304 pp.
0-89885-238-2 hard \$39.95

Meier, Levi, Ph.D.

JEWISH VALUES IN BIOETHICS

Foreword by Harold Jeremy C. Swan, M.D., Ph.D.

In this insightful volume, the dilemmas posed by medical ethics are thoroughly explored by the leading physicians, clinicians, ethicists, and clergy of our time.

1986 136 pp.(approx.)
0-89885-299-4 \$24.95

Duhl, Leonard J., M.D.

HEALTH PLANNING AND SOCIAL CHANGE

1986 286 pages (approx.)
0-89885-301-X \$29.95

ESSENTIAL JOURNALS

PRE- AND PERI-NATAL PSYCHOLOGY JOURNAL

Sponsored by the Pre- and Peri-Natal Psychology Association of North America
Editor: Thomas R. Verny, M.D.

Quarterly Volume 1, 1986 ISSN 0883-3095
Order PPNP-D personal \$30.00
Order PPNP-F institutions \$79.00

JOURNAL OF COMMUNITY HEALTH

The Publication of Health Promotion and Disease Prevention

Editor: Pascal J. Imperato, M.D.

Quarterly Vol. 11, 1986 ISSN 0094-5145
Order JCHE-D personal \$36.00
Order JCHE-F institutions \$89.00

HUMAN SCIENCES PRESS
72 FIFTH AVENUE
NEW YORK, N.Y. 10011

TELEPHONE ORDERS ACCEPTED
To order call (212) 243-6000

CONTINUING EDUCATION COURSES

Continuing education courses are offered Friday, May 16, Saturday, May 17, and Sunday, May 18. Courses take place in two hotels: the Hyatt Regency and the Minneapolis Plaza. The locations of these two hotels are shown on the map on page 76. Onsite registration for courses is available subject to course enrollment constraints. Check at the MLA Registration Booth for more information.

On Friday and Saturday courses take place from 8:30 a.m. - 5:00 p.m., and on Sunday from 8:00 a.m. - 4:00 p.m. An asterisk (*) indicates a two day course.

Friday, May 16

NP 861 — Designing Online Education for Medical End-Users

GREENWAY B, HYATT REGENCY HOTEL

Seminar Leaders: Bonnie Snow, Biomedical Information Specialist, DIALOG Information Services, Inc., Philadelphia, Pennsylvania and Joseph G. Wible, Reference Librarian, Lane Medical Library, Stanford University Medical Center, Palo Alto, California.

*NP 868 — Statistics and Quantitative Measures for Librarians

GREENWAY A, HYATT REGENCY HOTEL (DAY 1)

Seminar Leader: George D'Elia, Ph.D., School of Management, formerly Dean, School of Library and Information Science, University of Minnesota, Minneapolis, Minnesota.

CE 114 — Essentials of Online Searching: What You Need to Know to Be An Effective MEDLINE Searcher

GREENWAY E, HYATT REGENCY HOTEL

Instructors: Gail Yokote, Associate Biomedical Librarian for Public Services, Biomedical Library, Center for the Health Sciences, University of California, Los Angeles, Los Angeles, California and Susan Feinglos, Coordinator, Online Services, Duke Medical Center Library, Durham, North Carolina.

CE 245 — Marketing Library Services

GREENWAY C, HYATT REGENCY HOTEL

Instructor: Eugenie Prime, Director, Medical Library, Glendale Adventist Medical Center, Glendale, California.

CE 440 — Intermediate Skills for Online Searchers

GREENWAY D, HYATT REGENCY HOTEL

Instructor: Carolyn Anne Reid, Associate Director, Midcontinental Regional Medical Library Program, McGoogan Library of Medicine, Omaha, Nebraska.

Saturday, May 17

NP 862 — Numeric Database Systems

GREENWAY B, HYATT REGENCY HOTEL

Seminar Leaders: Peter Hernon, Ph.D., Professor, Graduate Library School, University of Arizona, Tucson, Arizona; John V. Richardson, Jr., Ph.D., Associate Professor, Graduate School of Library and Information Science, University of California, Los Angeles, Los Angeles, California; and Julie K. Kwan, Head, Reference Department, Biomedical Library, University of California, Los Angeles, Los Angeles, California.

NP 863 — Cross Cultural Dimensions in Library Service: Serving New Populations

GREENWAY C, HYATT REGENCY HOTEL

Seminar Leaders: Josef A. Mestenhauser, Ph.D., Professor and Director, International Student Advisor's Office; R. Michael Paige, Ph.D., Associate Professor of Education; and Kay A. Thomas, Ph.D., Senior Student Personnel Worker, University of Minnesota, Minneapolis, Minnesota.

NP 864 — Videodiscs: Technology and System Applications

GREENWAY D, HYATT REGENCY HOTEL

Seminar Leader: Martin Perlmutter

*NP 868 — Statistics and Quantitative Measures for Librarians

GREENWAY A, HYATT REGENCY HOTEL (DAY 2)

Seminar Leader: George D'Elia, Ph.D., School of Management, formerly Dean, School of Library and Information Science, University of Minnesota, Minneapolis, Minnesota.

CE 128 — Management of Reference Services

GREENWAY H, HYATT REGENCY HOTEL

Instructor: Gail Yokote, Associate Biomedical Librarian for Public Services, UCLA Biomedical Library, University of California, Los Angeles, Center for the Health Sciences, Los Angeles, California.

CE 310 — Drug and Pharmaceutical Information Resources

GREENWAY F, HYATT REGENCY HOTEL

Instructor: Bonnie Snow, Biomedical Information Specialist, DIALOG Information Services, Inc., Philadelphia, Pennsylvania.

CE 454 — Oncology: Concepts and Resources

GREENWAY J, HYATT REGENCY HOTEL

Instructor: Ada Seltzer, Assistant Director for Public Services, Medical Center Library, University of South Florida, Tampa, Florida.

CE 456 — Advanced Skills for Online Searching

GREENWAY G, HYATT REGENCY HOTEL

Instructor: Susan Feinglos, Coordinator, Online Services, Duke Medical Center Library, Durham, North Carolina.

CE 510 — Media Services Management

NICOLLET A-1, Hyatt Regency Hotel

Instructor: Linda Jacknowitz, Former Chief Audiovisual Librarian, West Virginia University, Morgantown, West Virginia.

CE 524 — MeSH and NLM Classification

GREENWAY E, HYATT REGENCY HOTEL

Instructor: Kathy Hoffman, Associate Director, Houston Academy of Medicine, Texas Medical Center Library, Houston, Texas.

CE 637 — Health Information Services for the Layperson

NICOLLET A-3, HYATT REGENCY HOTEL

Instructor: Alan M. Rees, Professor, School of Library and Information Science, State University of New York at Albany, Albany, New York.

CE 669 — Assertiveness and Human Relations Skills

GREENWAY I, HYATT REGENCY HOTEL

Instructor: Joanne Marshall, Department of Behavioural Science, University of Toronto, Toronto, Ontario, Canada.

Sunday, May 18

NP 865 — Immunology - Concepts and Resources

REGENCY ROOM, MINNEAPOLIS PLAZA HOTEL

Seminar Leaders: George F. McGregor, Information Specialist, Cetus Corporation, Emeryville, California and Vincent J. Merluzzi, Ph.D., Research Associate, Sloan-Kettering Cancer Center, Walker Laboratory, Rye, New York.

NP 866 — Library Telecommunications: Strategies for Cost Effective Management

EAST EMBASSY, MINNEAPOLIS PLAZA HOTEL

Seminar Leader: Richard W. Boss, Senior Consultant with Information Systems Consultants, Inc., Bethesda, Maryland.

NP 867 — Consultant/Broker/Entrepreneur: Managing a New Role

WEST EMBASSY, MINNEAPOLIS PLAZA HOTEL

Seminar Leader: Alice Sizer Warner, The Information Guild, Lexington, Massachusetts.

CE 111 — Introduction to Reference Sources in the Health Sciences

GREENWAY H, HYATT REGENCY HOTEL

Instructor: Mary Ann Brown, Associate Director, Medical Center Library, Duke University, Durham, North Carolina.

CE 112 — Collection Development and Use

GREENWAY I, HYATT REGENCY HOTEL

Instructor: James E. Bobick, Associate Director of University Libraries, Case Western Reserve University, Cleveland, Ohio.

CE 520 — Descriptive Cataloging in Health Sciences Libraries

GREENWAY B, HYATT REGENCY HOTEL

Instructor: Laurie Thompson, Librarian, Cataloging Section, Technical Services Division, National Library of Medicine, Bethesda, Maryland.

CE 258 — Planning: Strategic and Tactical

GREENWAY J, HYATT REGENCY HOTEL

Instructor: Jo Ann Bell, Ph.D., Director, Health Services Library, East Carolina University, Greenville, North Carolina.

CE 327 — Mental Health Information Resources

GREENWAY G, HYATT REGENCY HOTEL

Instructor: Leona Mackler, Director, Library and Information Services,
Post Graduate Center for Mental Health, New York, New
York.

CE 342 — Nursing Information Resources

GREENWAY C, HYATT REGENCY HOTEL

Instructor: Margaret Allen, Learning Resource Center Librarian, St.
Joseph's Hospital, School of Nursing, Marshfield,
Wisconsin.

CE 352 — Government Information Resources

GREENWAY E, HYATT REGENCY HOTEL

Instructor: John Budrew, David D. Palmer Library, Palmer College of
Chiropractic, Davenport, Iowa.

CE 433 — Health Care Planning and Administration: Information Resources
and Online Searching

GREENWAY A, HYATT REGENCY HOTEL

Instructor: Peg Hewitt, Director of Peg Hewitt Information Services,
Brookline, Massachusetts.

CE 459 — Online Biochemical Searching in the Health Sciences

GREENWAY D, HYATT REGENCY HOTEL

Instructor: Bonnie Snow, Biomedical Information Specialist, DIALOG
Information Service, Inc., Philadelphia, Pennsylvania.

American
Psychiatric
Press, Inc.

**Come Visit Us
at Booth #81**

New '86 Releases Now Available

Psychiatry Update

American Psychiatric Association

Annual Review—Volume 5

Edited by Allen J. Frances, MD and

Robert E. Hales, MD

(See other volumes in this prestigious series at our booth)

**Fundamentals of Research in
the Behavioral Sciences**

Principles and Practice

Franklin C. Shontz, PhD

Fundamentals of Psychiatry

Robert J. Waldinger, MD



**Two New Titles in the *Progress in
Psychiatry Series***



**Six New Titles in the *Clinical Insights
Monographs Series***



**Also Debuting this Spring is a New
Series—*Issues in Psychiatry***

**Come by Our Booth to See these New
Releases and Many More along with Best
Selling Backlist Titles**

For a free catalog write to:

Marketing Manager, American Psychiatric Press, Inc.,
1400 K Street, N.W., Washington, DC 20005

Use all the pieces to solve the puzzle!

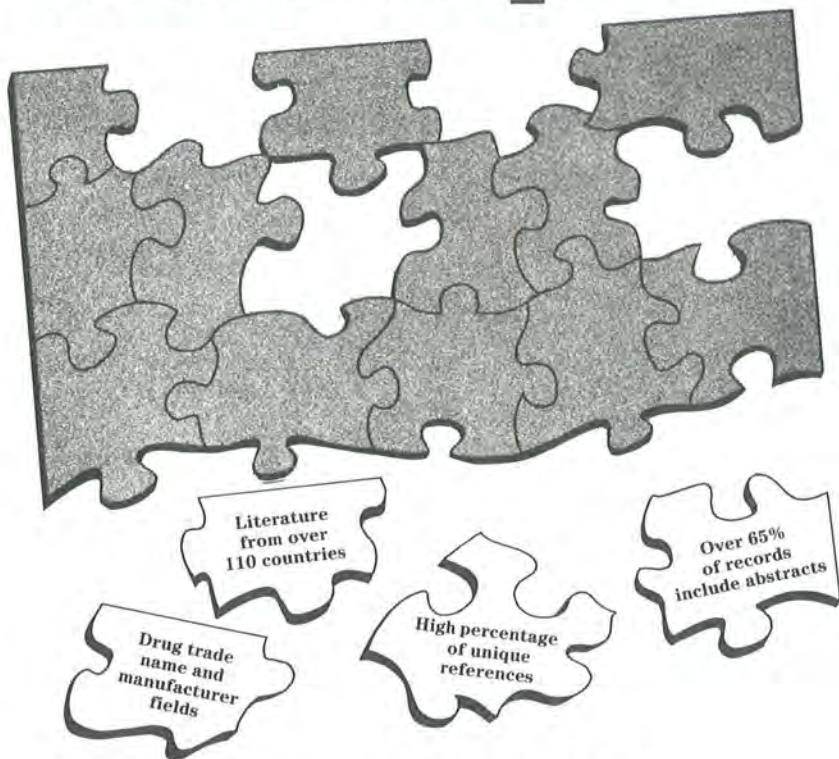

Use **EMBASE** the Excerpta Medica Database

EMBASE offers unique features and capabilities
not available on comparable systems.

Visit us at Booths BB, CC, DD for an EMBASE demonstration.
Journals and books also on display.

For more information, contact:

North American Database Department
Elsevier Science Publishers
52 Vanderbilt Avenue, New York, NY 10017
or phone (800) HLP-EMED

Elsevier Science Publishers
P.O. Box 1527, 1000 BM Amsterdam
The Netherlands
or phone (020) 5803507

EMBASE™ is a trade name of Elsevier Science Publishers BV/Excerpta Medica

Keep your collection up-to-date with Springer-Verlag

Publishing new ideas in medical research and technique

*A new videotape teaching program for the
neurosciences . . .*

Dissection of the Human Brain

Lennart Heimer, MD

Dissection of the Human Brain, a four-hour, eleven-part videotape series, is a strong visual teaching aid that will complement neuroanatomy lectures and laboratory classes. The method of dissection shown in the program is similar to the procedures used in many medical schools throughout the world. Brain specimens and diagrams are used to familiarize the student with functionally relevant and clinically important anatomical features. The films serve not only as an excellent guide for actual dissection in the laboratory, but also relate the gross anatomy of the brain to clinical neurology.

1985/available in VHS, Beta and U-Matic/\$1,800.00 to \$1,995.00/

Please contact Library Sales Mgr. for more information concerning our complete line of audiovisual materials.

*Stop by our booth to see
these acclaimed book series*

- **Advances and Technical Standards in Neurosurgery**
- **Advances in Anatomy, Embryology and Cell Biology**
- **Clinical Perspectives in Obstetrics and Gynecology**

- **Clinical Practice in Urology**
- **Comprehensive Manuals in Pediatrics**
- **Comprehensive Manuals of Surgical Specialties**
- **Current Topics in Microbiology and Immunology**
- **Current Topics in Neuroendocrinology**
- **Current Topics in Pathology**
- **Disorders in Human Communication**
- **Handbook of Experimental Pharmacology**
- **Handbook of Sensory Physiology**
- **Lecture Notes in Medical Informatics**
- **Monographs on Endocrinology**
- **Radiology of Iatrogenic Disorders**
- **Recent Results in Cancer Research**
- **Reviews of Physiology, Biochemistry and Pharmacology**
- **Topics in Environmental Physiology and Medicine**

—and these new series . . .

- **Advances in Immunity and Cancer Therapy**
- **Current Issues in Toxicology**
- **Current Topics in Medical Mycology**
- **Medical Radiology**
- **Medicolegal Library**
- **Monographs on Pathology of Laboratory Animals**
- **Springer Sandoz Advanced Texts**
- **Treatment in Clinical Medicine**

Stop by booth #6 for a closer look at our books, videotapes and journals, or call Mary Fugle, Library Sales Manager at (212) 460-1594.



Springer-Verlag
New York Berlin

Heidelberg

Tokyo

Vienna

MEDICAL LIBRARY ASSOCIATION

86TH ANNUAL MEETING MINNEAPOLIS, MINNESOTA

THE DAILY PROGRAM

The *General Information* section (pages 13-17) contains details of Registration, Placement, Hospitality, Ticket Sales, MLA Store and Display, and Exhibit Hours.

For information concerning Continuing Education Courses, their instructors, and locations see page 19.

All events listed in this program are at the Hyatt Regency Hotel unless noted otherwise, and begin and end promptly at the time indicated.

WEDNESDAY, May 14

8:00 a.m. - 5:00 p.m. BOARD OF DIRECTORS' STRATEGIC PLANNING
GREENWAY A

THURSDAY, May 15

8:00 a.m. - 5:00 p.m. BOARD OF DIRECTORS' STRATEGIC PLANNING
GREENWAY A

4:00 p.m. - 8:00 p.m. REGISTRATION
Administrative Services for Placement and
Continuing Education
BALCONY OVERLOOKING LOBBY ATRIUM

FRIDAY, May 16

7:00 a.m. - 8:30 a.m. REGISTRATION
Administrative Services for Placement and
Continuing Education
BALCONY OVERLOOKING LOBBY ATRIUM

8:00 a.m. - 5:00 p.m. BOARD OF DIRECTORS' Strategic Planning
SKYWAY ROOM AND GREENWAY J

8:30 a.m. - 5:00 p.m. CONTINUING EDUCATION COURSES

4:00 p.m. - 8:00 p.m. REGISTRATION
Administrative Services for Placement and
Continuing Education
BALCONY OVERLOOKING LOBBY ATRIUM

SATURDAY, May 17

7:00 a.m. - 6:00 p.m. REGISTRATION
BALCONY OVERLOOKING LOBBY ATRIUM

8:00 a.m. - 5:00 p.m. BOARD OF DIRECTORS' MEETING
SKYWAY ROOM

- 8:00 a.m. - 6:00 p.m. PLACEMENT SERVICE
NICOLLET FOYER 4
- 8:30 a.m. - 5:00 p.m. CONTINUING EDUCATION COURSES
- 1:00 p.m. - 5:00 p.m. HOSPITAL LIBRARY COLLOQUIUM
(To Be Audio Taped)
MINNEAPOLIS PLAZA HOTEL - ST. ANTHONY

SUNDAY, May 18

- 7:00 a.m. - 6:00 p.m. REGISTRATION
BALCONY OVERLOOKING LOBBY ATRIUM
- 8:00 a.m. - 6:00 p.m. PLACEMENT SERVICE
NICOLLET FOYER 4
- 8:00 a.m. - 4:00 p.m. CONTINUING EDUCATION COURSES
- 9:00 a.m. - 1:00 p.m. CHAPTER COUNCIL MEETING
NICOLLET D-1
- 9:00 a.m. - 1:00 p.m. SECTION COUNCIL MEETING
NICOLLET A-1
- 9:00 a.m. - 4:00 p.m. HOSPITAL LIBRARY COLLOQUIUM
(To Be Audio Taped)
MINNEAPOLIS PLAZA HOTEL - COTILLION ROOM
- 9:00 a.m. - 4:30 p.m. CERTIFICATION COMMITTEE
CERTIFICATION EDITORIAL PANEL
GREENWAY F
- 9:00 a.m. - 4:30 p.m. PUBLICATION PANEL
GRANT ROOM
- 10:00 a.m. - 1:30 p.m. TOURS AND SIGHTSEEING
- 3:30 p.m. - 4:45 p.m. RECEPTION AND ORIENTATION FOR NEW
MEMBERS, INTERNATIONAL VISITORS, AND
FIRST-TIME ATTENDEES
SKYWAY ROOM
- An orientation session for new MLA members,
visitors from outside the United States, and those
attending an MLA Annual Meeting for the first time.
Refreshments will be served.
- 5:00 p.m. - 5:30 p.m. OPENING SESSION (To Be Audio Taped)
NICOLLET GRAND BALLROOM

Welcome

Holly Shipp Buchanan, Chairman, 1986 National Program Committee, Corporate Information Resources, NKC Hospitals, Inc., Louisville, Kentucky
Sherrilynne Fuller, Ph.D., Chairman, Local Assistance Subcommittee, 1986 National Program Committee, Bio-Medical Library, University of Minnesota, Minneapolis, Minnesota

Frances Humphrey Howard, Special Assistant to the Associate Director, Extramural Programs, National Library of Medicine, Bethesda, Maryland

5:30 p.m. - 6:30 p.m.

KEYNOTE ADDRESS
NICOLLET GRAND BALLROOM

The Visionary Factor

Marilyn Ferguson, author of *The Aquarian Conspiracy*, editor and publisher of *Leading Edge Bulletin*, Los Angeles, California

6:30 p.m. - 8:30 p.m.

WELCOME RECEPTION
ORCHESTRA HALL

Renew acquaintances, meet new friends, and begin the 1986 Annual Meeting with refreshments (cash bar) and light snacks in the colorful setting of Orchestra Hall.

Admission tickets are available for purchase at the Ticket Booth on the Balcony overlooking the Atrium of the Hyatt Regency Hotel until 5:30 p.m., Sunday, May 18.

MONDAY, May 19

As information professionals, we need to be alert to new technologies, improved products and services which can help us and our institutions be efficient and effective.

Include the MLA Exhibit as you plan your schedule for MLA '86. We suggest that you allocate four to six hours for viewing the exhibits over the three days of the exhibit. This will assure ample time to visit most of the booths, featuring the most up-to-date products and services available to the library community.

7:30 a.m. - 9:00 a.m.

COMMITTEE MEETINGS

- Audiovisual Standards and Practices
GREENWAY B
- Awards
GREENWAY F
- Bylaws
GRANT ROOM
- Continuing Education
GREENWAY C
- Editorial Committee for the *MLA News*
GREENWAY G
- Exchange Committee
GREENWAY H
- Governmental Relations
GREENWAY I
- Hospital Library Standards and Practices
GREENWAY D
- International Cooperation
NICOLLET FOYER 1

- MLA/NLM Joseph Leiter Lectureship
GREENWAY A
- Membership Committee
GREENWAY J
- Program and Convention
SKYWAY ROOM

7:30 a.m. - 9:00 a.m.	INFORMAL MEETINGS (see page 63 for locations)	
8:00 a.m. - 4:30 p.m.	PLACEMENT SERVICE NICOLLET FOYER 4	
8:00 a.m. - 5:00 p.m.	REGISTRATION BALCONY OVERLOOKING LOBBY ATRIUM	
9:00 a.m. - 11:00 a.m.	PLENARY SESSION I NICOLLET GRAND BALLROOM	(To Be Audio Taped)

Moderator: Frances A. Bischoff, Director of Education and Information Services,
Project HOPE Health Sciences Education Center, Millwood, Virginia

Coalition Building: A National Perspective for the Scientific and Biomedical Communities

Carl N. Edwards, Director, Four Oaks Institute, Dover, Massachusetts

Record acceleration in the growth of the health sciences knowledgebase, and the emergence of new technologies which will revolutionize the storage and communication of information, combine to promise a decade of unprecedented challenge and opportunity. But meeting this challenge, and managing new opportunities, will require increasing resources, broadening vision, and creative partnerships between institutions and sectors which have never before shared common perspectives, goals, or traditions. This part of Session I takes a practical look at the forces which will shape, and be shaped by, those entrusted with the guardianship of the health sciences knowledgebase in the years ahead. Effective coalitions on the national level can and must confront complex political and economic forces, but this process will require a judicious blend of new skills and technologies with the traditions and values which are the foundation of medical librarianship.

Coalition Building: Institutional Perspective

At Johns Hopkins University, the Welch Medical Library is striving to become more active within its institutional environment. A strategy for building institutional partnerships is explored and several examples of partnerships are highlighted: *The Clinical Workstation* project is designed to provide access to multiple, separate files. *The Curricular Information Database* grew out of an evaluation of gaps and overlaps of the School of Medicine's curriculum. Using Inmagic, a specific subject index of topics is being developed. *The Mendelian Inheritance in Man Database*, through work with Victor McKusik, M.D. and NLM, is an online version of bibliographic and text material on Mendelian genetics.

Robert S. Gresehover, Deputy Director, Welch Medical Library; Stephen N. Kahane, M.D., Department of Medicine, School of Medicine; Jayne M. Crofts, Senior Reference Librarian, Welch Medical Library; and Sandra D. Teitelbaum, Project Coordinator, Welch Medical Library, Johns Hopkins University, Baltimore, Maryland

11:00 a.m. - 11:30 a.m. EXHIBIT OPENING
EXHIBIT HALL

Join MLA's President, Jean K. Miller, as she welcomes this year's exhibitors to the 86th Annual Meeting.

11:30 a.m. - 6:00 p.m. EXHIBIT
EXHIBIT HALL

12:30 p.m. - 2:30 p.m. SECTION PROGRAMS AND BUSINESS MEETINGS

- Health Sciences Audiovisual Business Meeting and Program
GREENWAY A

Managing Micros II

At the Denver meeting a forum began which focused on the impact of public access microcomputers in library environments. In Minneapolis, we will continue the discussion of issues related to the growing presence of microcomputers. The format includes coordinated five minute presentations prepared by section members who will address specific topics; e.g., the relationship between the LRC and the university computer center. There will be time for questions and discussion.

- History of Health Sciences Business Meeting
GREENWAY B

Program and Reception: Tuesday, May 20, 5:00 p.m. - 9:00 p.m.

Dr. Arthur Conan Doyle's Patients in Fact and Fiction

Mr. Key will present Arthur Conan Doyle, M.D., and his patients in fact and fiction. The program will be at the Owen H. Wangensteen Historical Library of Biology and Medicine at the University of Minnesota. Exhibits will be part of the program.

Jack Key, Associate Professor of Biomedical Communications, Mayo Medical School and Librarian, Mayo Foundation, Rochester, Minnesota

- Medical School Libraries Program (To Be Audio Taped)
NICOLLET D-2

The Changing Medical School Curriculum: Impact of the GPEP Report (General Professional Education of the Physician)

The impact of "Educating the Physician in the 21st Century" (the GPEP report) on the changing medical school curriculum will be discussed by Ilene Harris, Ph.D. and Robert McCollister, M.D., curriculum administrators from the University of Minnesota Medical School. Ramifications of these curriculum for medical school libraries will be included in the presentations.

Faith Van Toll, Moderator, Shiffman Medical Library, Wayne State University, Detroit, Michigan

Ilene Harris, Ph.D., Associate Professor, Curriculum Affairs, University of Minnesota Medical School, Minneapolis, Minnesota

Robert McCollister, M.D., Associate Dean, Curriculum Affairs, University of Minnesota Medical School, Minneapolis, Minnesota

Cathy E. Harbert, Respondent, Chief of Reader Services, Paul Himmelfarb Health Science Library, George Washington University, Washington, D.C.

- Research Libraries Program and Business Meeting

GREENWAY C

Quality Circles — The Duluth Experience

In 1983 the Duluth Public Library began participation in a city-wide quality circles program involving all service departments in the city government. While the subjective and the objective benefits were clear, unexpected stumbling blocks were discovered. After a short overview of the theory of Quality Circles and the management preconditions necessary for such a program, Ms. Caven will discuss the Library experience.

Mary Caven, Media Specialist, Duluth Public Library, Duluth, Minnesota

- Public Health/Health Administration Libraries

GREENWAY D

(12:30 p.m. - 1:30 p.m.)

Relevant Issues

(1:30 p.m. - 2:30 p.m.)

Business Meetings

3:00 p.m. - 4:45 p.m.

CONTRIBUTED PAPERS I
CONCURRENT SESSIONS

SESSION I

NICOLLET A-1

Moderator: Rick B. Forsman, Charles Denison Memorial Library, University of Colorado Medical Center, Denver, Colorado

3:05 p.m.: Partnering Enables a CD ROM Version of the MiniMEDLINE System

Naomi C. Broering, Medical Center Librarian, Georgetown University Medical Center, Washington, D.C.

3:25 p.m.: Current Contents Online at Washington University School of Medicine Library

Susan Y. Crawford, Ph.D., Elizabeth Kelly, Barbara Halbrook, and Jennifer Nakeff-Plaat, Washington University School of Medicine Library, St. Louis, Missouri

3:45 p.m.: Computer Networking for Enhanced Library Service: An Experience with Multi-Level Computer Systems

William T. McGowan III, Ph.D., *Julie Johnson McGowan, and R. Thomas Lange, School of Medicine Library, University of South Carolina, Columbia, South Carolina

4:05 p.m.: Compatibility of MEDLINE and MARC Records: Implications for Integrated Systems in Health Science Libraries

Dick R. Miller, Lane Medical Library, Stanford University Medical Center, Stanford, California

4:25 p.m.: Forging New Technical Services Partnerships Within a University Library System: Learning to Live with Entangling Alliances

David H. Morse, Norris Medical Library; Margaret Wineburgh-Freed, Norris Medical Library; and Frank Mason, Dentistry Library, University of Southern California, Los Angeles, California

SESSION II

NICOLLET A-2

Moderator: Shelley A. Bader, Paul Himmelfarb Health Science Library, George Washington University Medical Center, Washington, D.C.

3:05 p.m.: Establishing an Instructional Microcomputer Laboratory in the Health Sciences Library: A Cooperative Venture Between University Administration, Faculty, and Librarians

Laura P. Barrett, University of Medicine and Dentistry of New Jersey, Newark, New Jersey

3:25 p.m.: Public Services Librarians and Microcomputer Consultation: A Model for Training and Evaluation

James L. Bingham and Abigail Hubbard, Texas Medical Center Library, Houston Academy of Medicine, Houston, Texas; Gail A. Yokote, Biomedical Library, Center for the Health Sciences, University of California at Los Angeles, Los Angeles, California; Damon Camille, Pamela Agner, and Gita Srivastava, Medical Center Library, Houston Academy of Medicine, Houston, Texas

3:45 p.m.: Cooperative Computing in an Academic Medical Center

Marline R. Gerrity, Susan V. Case, and T. Lee Willoughby, School of Medicine, University of Missouri at Kansas City, Kansas City, Missouri

4:05 p.m.: Microcenter: Medical Library Managed Distributed Processing in a Health Care Institution

Daniel J. Heenan, Boehringer Ingelheim Pharmaceuticals, Inc., Ridgefield, Connecticut

4:25 p.m.: Partnerships in End-User Training: the HOBET Program

Judith G. Robinson and Melanie M. Hillner, Tompkins-McCaw Library, Medical College of Virginia/Virginia Commonwealth University, Richmond, Virginia

SESSION III

NICOLLET A-3

Moderator: Carol G. Jenkins, Southeastern Atlantic Regional Medical Library Services, Health Sciences Library, University of Maryland, Baltimore, Maryland

*First author is the speaker except when noted with an asterisk.

3:05 p.m.: MEDVIEW: Cooperation in West Virginia's Health Care Community
Brenda J. Curry, United Hospital Center, Clarksburg, West Virginia

3:25 p.m.: HEALTHANSWERS: Practical Partnership Between Hospital and Public Libraries

Joyce L. Fedeczko and Rya Ben-Shir, Health Sciences Resource Center, MacNeal Hospital, Berwyn, Illinois

3:45 p.m.: The Massachusetts Medical Information Link

Jenny McGee and Steve Hunter, MEDLINK, Waltham, Massachusetts

4:05 p.m.: HEALTHNET: Connecticut Consumer Health Information Network: Linking Health Information Resources, Public Libraries and the Citizens of Connecticut

Alberta L. Richetelle, Health Center Library, University of Connecticut, Farmington, Connecticut

4:25 p.m.: Multi-Type Libraries: Partners for the Delivery of Consumer Health Information in Nebraska

Carolyn G. Weaver, McGoogan Library of Medicine, University of Nebraska Medical Center, Omaha, Nebraska

SESSION IV

NICOLLET D-1

Moderator: Diane F. Ream, Baptist Hospital of Miami, Miami, Florida

3:05 p.m.: The Microcomputer Resource Center, or "Computers on Call": A Hospital Library's Joint Venture

Jacqueline D. Doyle, Good Samaritan Medical Center, Phoenix, Arizona

3:25 p.m.: The Prospect of IAIMS Applications in a Veterans Administration Medical Center Library

Valerie K. Smith and Shirley C. Ting, Veterans Administration Medical Center, Kansas City, Missouri

3:45 p.m.: Automating Veterans Administration Libraries: Planning and Development

Martha B. Leredu, Jean McVoy, Nancy Clark, and Joy Hunter, Veterans Administration Medical Center, Seattle, Washington

4:05 p.m.: Toward a Common Goal: Sharing Audiovisual Resources

Susan Harker, Veterans Administration Medical Center West Los Angeles, Wadsworth Division, Los Angeles, California and *Irene Lovas, Veterans Administration Medical Center, Long Beach, California

4:25 p.m.: Managing a Satellite Communications Program in a Hospital Library

Lynn Sorensen Sutton, Detroit-Macomb Hospital Corporation, Warren, Michigan; Frances Phillips and Susan Winfield, Grace Hospital, Detroit, Michigan

*First author is the speaker except when noted with an asterisk.

SESSION V*NICOLLET D-2*

Moderator: Ted F. Srygley, Health Center Library, University of Florida, Gainesville, Florida

3:05 p.m.: Creating a High Performance Team: Recruitment, Interview, and Selection Processes for Professional Staff Positions

Lynn M. Fortney, Lister Hill Library, University of Alabama at Birmingham, Birmingham, Alabama

3:25 p.m.: Matrix Management as a Framework for Partnerships

Susan A. Hawk and Jeanne Goshorn, Specialized Information Services, National Library of Medicine, Bethesda, Maryland

3:45 p.m.: A View of the Library from LCME

Charles W. Sargent, Ph.D., and Mary Moore, Library of the Health Sciences, Texas Tech University Health Sciences Center, Lubbock, Texas

4:05 p.m.: Partnerships - Some Dark Sides

Robert G. Cheshier, Cleveland Health Sciences Library, Cleveland, Ohio

4:25 p.m.: People to People Networking

Cheryl Hamberg, Meharry Medical Library, Meharry Medical College, Nashville, Tennessee

5:00 p.m. - 7:00 p.m. SECTION PROGRAMS AND BUSINESS MEETINGS

- Cancer Librarians Business Meeting and Program

NICOLLET D-3

Survival Rates in Cancer Patients

Leslie Robison, Ph.D., Assistant Professor, Division of Pediatric Oncology, University of Minnesota, Minneapolis, Minnesota

Products of Medical Research

Maureen Wellen, Product Manager, Medtronic Inc., Minneapolis, Minnesota

- Consumer and Patient Health Information Business Meeting and Program

GREENWAY A,B,C,D

Munch, Mingle, and Mini-Posters

The mini-poster session will consist of 20 tables with exhibits by librarians involved in consumer and patient health information programs. Photographs, publicity materials, bibliographies, etc., will be on display with numerous handouts available. Librarians from each library will be present to explain their programs and ideas on innovative consumer/patient literature programs. Wine and cheese will be served. Admission will be by free ticket available at the MLA registration booth Sunday and Monday of the convention. The session will be sponsored by UMI Research Collections and by the Media Library of the University of Michigan Medical Center, who will also be displaying their consumer/patient health materials.

*First author is the speaker except where noted with an asterisk.

- Dental Program and Business Meeting

NICOLLET D-1

The Evil Eye

Robert J. Gorlin, Regents' Professor and Chairman, Department of Oral Pathology and Genetics, University of Minnesota School of Dentistry, Minneapolis, Minnesota

- Mental Health Libraries Program and Business Meeting

NICOLLET A-1

Straight Talk on Mental Health

The three panelists tackle the plight of the consumer seeking information about mental health. They will discuss how to meet that challenge in different professional settings.

Do You Have to be a Philadelphia Lawyer to Understand Mental Health and Its Treatment?

Meliza Jackson, Patients' Librarian, Western Psychiatric Institute and Clinic, Pittsburgh, Pennsylvania

The Librarian as Mediator Between the Consumer and Information

Lionelle Elsesser, Executive Director, Health Science Communications Association, St. Louis, Missouri

Getting to Mental Health Literature Through the Library Catalog

Sanford Berman, Head Cataloger, Hennepin County Library, Minnetonka, Minnesota

- Military Medical Libraries Program and Business Meeting

NICOLLET D-2

Partnerships Are Made of People

Jane A. Lambremont, Education Coordinator, Southeastern/Atlantic Regional Medical Library Service, Baltimore, Maryland

- Nursing and Allied Health Resources Program and Business Meeting
(To Be Audio Taped)

NICOLLET A-3

Computers and Nursing

The information explosion, coupled with the dynamic changes taking place in health care, has forged a new and exciting partnership between the nursing educator/practitioner, the computer, and the information specialist. Computer technology is a powerful tool with potential for significant impact on nursing education, patient-care, research, administration, and information management. The new technology will provide a challenge to the changing roles of the nurse and the information specialist.

Cynthia R. Gross, Ph.D., Assistant Professor, College of Pharmacy and School of Nursing, University of Minnesota, Minneapolis, Minnesota

Osteopathic Libraries

GREENWAY I

Pharmacy and Drug Information Program and Business Meeting

NICOLLET A-2

Of Mice and Men: The End User Interface to Medical Information

(Excerpta Medica Lecture)

We may view the responsibilities of clinical research as the transformation of observation into knowledge. The transfer of this knowledge to the end user has been managed by media, teachers, and librarians. The presence of a large and growing number of online knowledge bases, the development of electronic publishing, and the evolution of true user networks are evidence of a real information explosion.

Medical librarians have already expanded their role of enhancing knowledge access from books and journals to include online searching. The quantum leap to electronic publishing will involve some features of author-user interaction, access to dynamic knowledge bases, and user-driven publishing.

No single factor has had more impact on this evolution or offered more potential solutions than the microcomputer. And with those solutions, the role of the librarian at the interface between the end user and the medical information systems will continue to expand.

Daniel A. Spyker, M.D., Associate Professor of Internal Medicine and Director of the Health Information Center, University of Virginia; Co-Director of the Blue Ridge Poison Center, Charlottesville, Virginia

Veterinary Medical Libraries Business Meeting

GREENWAY J

30 p.m. - 9:00 p.m.

EXHIBITORS' RECEPTION

EXHIBIT HALL

Enjoy a complimentary cocktail and stroll through the 1986 MLA Exhibit. Exhibitors are eager to introduce their latest products and services.

TUESDAY, May 20

30 a.m. - 9:30 a.m.

SECTION PROGRAMS AND BUSINESS MEETINGS

Hospital Library Program and Business Meeting

(To Be Audio Taped)

1/2 GREENWAY (F,G,H,I,J)

Breakfast (7:00 a.m.) sponsored by the Network for Continuing Medical Education

Look to the Future: The National Library of Medicine as a Partner with the Hospital Community

Donald Lindberg, M.D., Director of the National Library of Medicine, will describe the ways in which NLM's strategic plan will affect hospital libraries in the management and delivery of information services. His presentation will be preceded by a breakfast and followed by a business meeting.

Donald A.B. Lindberg, M.D., Director, National Library of Medicine, Bethesda, Maryland

• **Library Research Business Meeting and Program**

GREENWAY A AND B

Research in Progress: Panel Discussion

Library Research: A Personal Perspective

Richard A. Lyders, Executive Director, Texas Medical Center Library, Houston Academy of Medicine, Houston, Texas

Anatomy of a Small Research Project

Mark Funk, Head, Collection Development, McGoogan Library of Medicine, University of Nebraska Medical Center, Omaha, Nebraska

Adapting the IAIMS Model to the Science Library

Barbara Montanary, Head, Science Libraries, University of California at Riverside, Riverside, California

Evaluating Research for Publication

Susan Y. Crawford, Ph.D., Professor and Director, Washington University School of Medicine Library, St. Louis, Missouri

• **Technical Services Business Meeting and Program** (To Be Audio Taped)

GREENWAY C AND D

Survival? Evolution? Extinction? Technical Services in the Electronic Library

The impact of the electronic library on traditional library activities, especially those most commonly associated with technical services—acquisition, cataloging, serials control—will be explored. Dr. Gatewood will present the model of an electronic library from the point of view of a health sciences computing expert, non-librarian IAIMS planner and a library user. Mrs. Anderson will speculate on how technical services will change as a result of this concept.

The Future of Health Science Libraries and Health Informatics: The User Perspective

Lael C. Gatewood, Ph.D., Professor of Laboratory Medicine and Pathology, Director of Health Computer Sciences, University of Minnesota, Minneapolis, Minnesota

The Future of Health Science Libraries and Health Informatics: The Librarian Perspective

Rachael K. Anderson, Health Sciences Librarian, Columbia University, New York, New York

8:00 a.m. - 4:30 p.m. **PLACEMENT SERVICE**

NICOLLET FOYER 4

8:00 a.m. - 5:00 p.m. **REGISTRATION**

BALCONY OVERLOOKING LOBBY ATRIUM

10:00 a.m. - 12:00 p.m. **BUSINESS MEETING I** (To Be Audio Taped)

NICOLLET GRAND BALLROOM

Presiding: Jean K. Miller, President, Medical Library Association; Director of Library, The University of Texas Health Science Center at Dallas, Dallas, Texas

Announcements and Introductions by Raymond A. Palmer, Executive Director, Medical Library Association, Chicago, Illinois

Residential Address

... And Serve the Future Hour

Jean K. Miller, President, Medical Library Association

Call to order by Jean K. Miller, President, Medical Library Association

Numbers in parentheses following each report refer to pages in the 1985/86 Annual Report

Report of the State of the Association

Raymond A. Palmer, Executive Director, Medical Library Association

Report of the Finance Committee (1)

Gary Byrd, Chairman

Trustee's Report (17)

Ann Orfanos, Trustee

REPORTS OF APPOINTED OFFICIALS

Report of the Bulletin of the Medical Library Association (18)

Janet Y. Crawford, Ph.D., Editor, *Bulletin of the Medical Library Association*

Report of the MLA News (21)

Janet Y. Crawford, Editor, the *MLA News*

REPORTS OF ADMINISTRATIVE COMMITTEES

Raymond A. Palmer, Executive Director

Committees of the Board

Committee on Committees (22)

Elections Committee (23)

Nominating Committee (24)

Judith Messerle, Chairman

Bylaws Committee (26)

Lucretia McClure, Chairman

June H. Fulton, Board Liaison

Membership and Exchange Coordination

Raymond S. Naegele, Director of Financial and Administrative Services

Ad Hoc Committee on Automating the Exchange (31)

Raymond A. Palmer, Chairman

Gary Byrd, Board Liaison

Exchange Committee (32)

Beth Weil, Chairman

Gary Byrd, Board Liaison

Membership Committee (33)

Joan Stoddart, Chairman

Madeline V. Taylor, Board Liaison

INFORMATION ISSUES AND POLICY

Raymond A. Palmer, Executive Director

- Governmental Relations Committee (35)
Gerald J. Oppenheimer, Chairman
Richard A. Lyders, Board Liaison
- International Cooperation Committee (38)
Marilyn Sullivan, Chairman
Frances Groen, Board Liaison
- MLA/NLM Liaison Committee (45)
Eleanor Y. Goodchild, Chairman and Board Liaison
- Publishing and Information Industries Relations Committee (46)
Patricia R. Bristor, Chairman
Richard A. Lyders, Board Liaison
- Status and Economic Interests of Health Sciences Library Personnel Committ (48)
Sheldon Kotzin, Chairman
June H. Fulton, Board Liaison

PROFESSIONAL DEVELOPMENT

M. Kent Mayfield, Ph.D., Director of Education

- Certification Committee (49)
Julie Kuenzel Kwan, Chairman
Jacqueline D. Bastille, Board Liaison
- Continuing Education Committee (51)
Neil Kelley, Chairman
Jacqueline D. Bastille, Board Liaison
- Editorial Panel for Certification and Registration Examination (54)
Fred W. Roper, Chairman
Jacqueline D. Bastille, Board Liaison

Meeting Coordination

Estella L. Smith, Conference Coordinator

- 1986 National Program Committee (55)
Holly Shipp Buchanan, Chairman
Jean K. Miller, Board Liaison
- 1987 National Program Committee (56)
Carol G. Jenkins, Chairman
Judith Messerle, Board Liaison
- 1988 National Program Committee (58)
Mary Horres, Chairman

- Program and Convention Committee (59)
Thomas Williams, Chairman
Richard A. Lyders, Board Liaison

Honors and Awards Coordination

Eileen Fitzsimons, Ph.D., Assistant to Director of Education

- Awards Committee (60)
Jean Antes, Chairman
Eleanor Y. Goodchild, Board Liaison
- Grants and Scholarship Committee (61)
Linda A. Grix, Chairman
Eleanor Y. Goodchild, Board Liaison
- Joseph Leiter NLM/MLA (63)
Lectureship Committee
Lois Ann Colaianni, Chairman
Rachael K. Anderson, Board Liaison

COMMUNICATIONS

Rita Shafer, Director of Communications

- *Bulletin* Consulting Editors Panel
Susan Y. Crawford, Ph.D., Chairman
Frances Groen, Board Liaison
- Editorial Committee for the *Bulletin* (64)
Daniel Taylor, Chairman
Frances Groen, Board Liaison
- Editorial Committee for the *MLA News* (65)
Ruth E. Fenske, Chairman
Frances Groen, Board Liaison
- Oral History Committee (66)
Suzanne Grefsheim, Chairman
Eleanor Y. Goodchild, Board Liaison
- Publication Panel (68)
Jana Bradley, Chairman
Richard A. Lyders, Board Liaison

STANDARDS AND PRACTICES

Raymond A. Palmer, Executive Director

- Ad Hoc Committee to Develop a Code of Ethics (70)
Alice A. Brand, Chairman
Gary Byrd, Board Liaison
- Audiovisual Standards and Practices Committee (71)
James A. Curtis, Chairman
Jane A. Lambremont, Board Liaison
- Health Sciences Library Technicians Committee (73)
Dorothy Gilroy, Chairman
Jane A. Lambremont, Board Liaison

- Hospital Library Standards and Practices Committee (74)
Richard B. Pride, Chairman
Jane A. Lambremont, Board Liaison
- Interlibrary Loan and Resources Sharing Standards and Practice Committee (75)
James Shedlock, Chairman
Jane A. Lambremont, Board Liaison
- Library Standards and Practices Committee (77)
Marjorie A. Waite, Chairman
Jane A. Lambremont, Board Liaison
- MLA/AAHSLD Joint Task Force to Develop Academic Health Sciences Librarian Guidelines (78)
Erika Love, Chairman
Rachael K. Anderson, Board Liaison

REPORT OF COUNCILS

- Chapter Council (84)
Madeline V. Taylor, Chairman
- Section Council (87)
June H. Fulton, Chairman
- Old Business
- New Business

Note: MLA Representatives' Reports appear as part of their respective Standing Committee's Annual Reports.

Bylaws Introduction and Bylaws
Charles W. Sargent, Parliamentarian
Lucretia McClure, Chairman, Bylaws Committee

- | | | |
|------------------------|--|---------------------|
| 11:00 a.m. - 6:00 p.m. | EXHIBIT
<i>EXHIBIT HALL</i> | |
| 12:00 p.m. - 1:00 p.m. | CHAPTER CHAIRMEN MEETING/LUNCHEON
<i>GREENWAY J</i> | |
| 1:00 p.m. - 2:30 p.m. | PLENARY SESSION II
<i>NICOLLET GRAND BALLROOM</i> | (To Be Audio Taped) |

Moderator: Sherrilyne Fuller, Ph.D., Director, Bio-Medical Library, University of Minnesota, Minneapolis, Minnesota

Forging New Partnerships: University/Hospital/Private Industry

New relationships are currently being forged between private industry, hospitals and academic institutions. Further, the ground rules for existing partnerships are in transition. Speakers representing each of the three sectors will explore the challenges implicit in these new configurations and attempt to predict future direction for these partnerships among the three sectors. The potential effect of these changes on health sciences libraries will be summarized in a joint presentation by hospital and an academic librarian.

Steffore Infante, Ph.D., Dean, The Institute of Technology, University of Minnesota, Minneapolis, Minnesota

George O. Johnson, Ph.D., Director, Division of Hospital and Health Care Administration, School of Public Health, University of Minnesota, Minneapolis, Minnesota

Franklin Pass, M.D., Chairman of the Board and Chief Executive Officer, Molecular Genetics Corporation, Minnetonka, Minnesota

Donna P. Johnson, Director, Department of Library/Media Services, Abbott-Northwestern Hospital, Minneapolis, Minnesota

Sherrilynne Fuller, Ph.D., Director, Bio-Medical Library, University of Minnesota, Minneapolis, Minnesota

3:30 p.m. - 4:30 p.m. POSTER SESSION I

EXHIBIT HALL

Booth A

Medical Software and Library Materials on Electronic Bulletin Board

Marline Gerrity, School of Medicine, University of Missouri at Kansas City, Kansas City, Missouri

Booth B

Selective Videotape Publication Program

Suzetta Burrows, Louis Calder Memorial Library, Miami, Florida

Booth C

AMRMLN Serials Exchange Pilot Study

Ruby S. May, Library of the Health Sciences, University of Illinois at Chicago, Chicago, Illinois

Booth D

Bibliographic Applications of Two File Management Programs for the IBM-PC: Notebook II and PC-File III

Wicki Glasgow, Bio-Medical Library, University of Minnesota, Minneapolis, Minnesota

Booth E

Increasing Use of Area Health Education Center Information Services by Dental Professionals

Sherilynne K. Siemers and Cathryn E. White, Health Sciences Library, University of North Carolina at Chapel Hill, Chapel Hill, North Carolina

Booth F

LIBSTAT-Computer Search Service Recordkeeping and Reports on a Microcomputer

Joan E. Latta, McGoogan Library of Medicine, University of Nebraska Medical Center, Omaha, Nebraska

Booth G

D*A*T*S: A Book Acquisitions Application of D-Base III

David H. Morse, Norris Medical Library, University of Southern California, Los Angeles, California

Booth H

D-Base III Products in Public Service Operations: Kudos, Concerns, and Comments

Marie Reidelbach, McGoogan Library of Medicine, University of Nebraska Medical Center, Omaha, Nebraska

Booth I

Audiovisual "Core" Collection

Gale G. Hannigan, Bio-Medical Library, University of Minnesota, Minneapolis Minnesota

Booth J

General Accounting Software in the ILL Department

Janice E. Kelly, Southeastern/Atlantic Regional Medical Libraries Service, University of Maryland Health Sciences Library, Baltimore, Maryland

Booth K

Georgia Interactive Network-GaIN-for Medical Information: Information Management in an Innovative Curriculum

Jocelyn Rankin, Mercer University School of Medicine Library, Macon, Georgia

Booth L

EARS-Electronic Access to Reference Service

Frieda Weise, Health Sciences Library, University of Maryland at Baltimore, Baltimore, Maryland

Booth M

F.I.L.L.S.: Developing Software Inhouse

Joyce L. Fedeczko, Health Sciences Resource Center, MacNeal Hospital, Berwyn Illinois

Booth N

InfoNet: Partners in Information Access

Carolyn Anne Reid, Mid-Continental Regional Medical Library Program, McGoogan Library of Medicine, University of Nebraska Medical Center, Omaha Nebraska

Booth O

Creating and Implementing a Statistical Resources Database

Dee A. Mater, Health Sciences Library, University of North Carolina at Chapel Hill Chapel Hill, North Carolina

3:00 p.m. - 4:00 p.m.

ROUNDTABLES

GREENWAY BALLROOM

I. Coping With Reductions in Staff and Materials

Facilitator: Angela Wesling, Medical Center Library, Mt. Zion Hospital and Medical Center, San Francisco, California

II. Information Services for Administrators

Facilitator: Kirsten Quam, Professional Library, Wishard Memorial Hospital, Indianapolis, Indiana

II. How to Write an Effective Resume

Facilitator: JoAnne Boorkman, Health Sciences Library, University of California, Davis, California

IV. Alternative Library Careers or How to Wake Up Each Morning and Enjoy Going to Work

Facilitator: Julie R. Quain, BRS/Saunders Colleague, New York, New York

V. CML - How to Get Started

Facilitator: Helen-Ann Brown, Mid-Continental Regional Medical Library Program, McGoogan Library of Medicine, University of Nebraska, Omaha, Nebraska

VI. Locating Supervisory/Management Training Materials (Print and Non-Print)

Facilitator: Gary Gray, Methodist Hospital of Indiana, Indianapolis, Indiana

VII. How to Evaluate Search Services

Facilitator: Ann Van Camp, School of Medicine Library, Indiana University, Indianapolis, Indiana

VIII. Organizing Reprint Files

Facilitator: Sandra Spurlock, Zimmerman Library, University of New Mexico, Albuquerque, New Mexico

X. Pricing Strategies for the Library - Fee for Service, Charge-Back System

Facilitator: Gary Byrd, Health Sciences Library, University of North Carolina at Chapel Hill, Chapel Hill, North Carolina

C. Hospital Library Consulting

Facilitator: Betsey Beamish, Hospital Library Consultant, Pacific Palisades, California

I. Online Public Catalogs

Facilitator: Carolyn Fishel, Medical Library, Glendale Adventist Medical Center, Glendale, California

II. IAIMS Prototype in a Hospital Library

Facilitator: Ellen Wilson Green, Health Sciences Information, Cedars-Sinai Medical Center, Los Angeles, California

III. Microcomputers/PC's in the Health Sciences Library

Facilitator: Edward A. Tawyea, Medical Library, Northwestern University, Chicago, Illinois

IV. Grant Applications

Facilitator: Elaine Graham, Pacific Southwest Regional Medical Library, Biomedical Library, University of California at Los Angeles, Los Angeles, California

V. Effective Performance Measures for the Health Sciences Library

Facilitator: Betty F. Connolly, Library, Veteran's Administration Medical Center, Long Beach, California

VI. Learning Resource Centers in the Health Sciences Library

Facilitator: Gale G. Hannigan, Bio-Medical Library, University of Minnesota, Minneapolis, Minnesota

XVII. Effective Marketing of Library Services (Non-Traditional Users)

Facilitator: Jo Ann Bell, Ph.D., Health Sciences Library, East Carolina University
Greenville, North Carolina

XVIII. End-User Searching

Facilitator: James Shedlock, Medical Library, Northwestern University, Chicago
Illinois

XIX. Marketing Information Services in the Hospital

Facilitator: Jacqueline Bastille, Treadwell Library, Massachusetts General Hospital,
Boston, Massachusetts

XX. Towards Publishing a Newsletter

Facilitator: Joyce Loepprich, Biomedical Library, University of California at Irvine
Irvine, California

3:00 p.m. - 9:30 p.m. TOURS AND SIGHTSEEING

4:00 p.m. - 5:30 p.m. EXHIBITOR DEMONSTRATIONS
(Refer to Guide to Exhibitors for complete listing)

- BRS Saunders/Colleague

NICOLLET A-2

COLLEAGUE, the electronic medical literature and information service from BRS/Saunders, provides end-user access to a comprehensive collection of full-text journals and books, indexes and abstracts, plus special databases. Simple English-language menus and commands are used to search resources such as *Annals of Internal Medicine*, *the New England Journal of Medicine*, Cecil's *Textbook of Medicine*, MEDLINE and PDQ. COLLEAGUE now offers PROMPT SEARCH—a software package which will enable medical librarians to provide an end-user service and easily manage accounting and communications.

- PaperChase

NICOLLET A-3

PaperChase - the user-friendly computer program for searching the biomedical literature-will be demonstrated. A question and answer period will be provided.

- The Faxon Company

NICOLLET D-3

MicroLinx is Faxon's microcomputer based software system for serials management using an IBM Personal Computer. MicroLinx Check-in provides: check-in claiming, information retrieval, and report generation with speed and accuracy. MicroLinx can handle both single and multiple copy subscriptions. The easy-to-learn MicroLinx system includes program disks and complete documentation (reference manual and tutorial).

4:00 p.m. - 6:00 p.m. LIBRARY OPEN HOUSES

The following libraries will offer tours during this period. Individuals wishing to participate will need to arrange their own transportation. Details regarding the libraries and their collections, as well as directions, are available at the Hospitality Booth.

Abbott-Northwestern Hospital Medical Library
 Beckman United Hospital Medical Library
 Bakken Library of Electricity and Magnetism in Medicine
 Bio-Medical Library, University of Minnesota, Twin Cities
 Hennepin County Medical Center Medical Library
 North Memorial Hospital Medical Library
 Northwestern College of Chiropractic Medical Library

4:00 p.m. - 6:00 p.m. 1987 NATIONAL PROGRAM COMMITTEE
 GRANT ROOM

5:00 p.m. - 7:00 p.m. INFORMAL MEETINGS
 (see pages 63-64 for locations)

WEDNESDAY, May 21

7:30 a.m. - 9:30 a.m. COMMITTEE MEETINGS

- Awards Juries
 GREENWAY G
- *Bulletin* Consulting Editors Panel
 GREENWAY H
- Certification
 GREENWAY F
- Continuing Education
 GREENWAY C
- Governmental Relations
 GREENWAY I
- Grants and Scholarships
 GRANT ROOM
- Interlibrary Loan and Resource Sharing Standards and Practices
 SKYWAY ROOM
- Membership
 GREENWAY J
- 1988 National Program
 GREENWAY D
- Publications and Information Industries Relations
 GREENWAY B

7:30 a.m. - 9:00 a.m.	INFORMAL MEETINGS (see pages 63-64 for locations)	
8:00 a.m. - 4:30 p.m.	PLACEMENT SERVICE <i>NICOLLET FOYER 4</i>	
8:00 a.m. - 5:00 p.m.	REGISTRATION <i>BALCONY OVERLOOKING LOBBY ATRIUM</i>	
9:30 a.m. - 10:15 a.m.	HONORS AND AWARDS CEREMONY <i>NICOLLET GRAND BALLROOM</i>	
10:15 a.m. - 11:15 a.m.	JANET DOE LECTURE <i>NICOLLET GRAND BALLROOM</i>	(To Be Audio Taped)

Measures of Excellence: The Search for the Gold Standard

Virginia H. Holtz, Professor and Director of Center for the Health Sciences Libraries, University of Wisconsin, Madison, Wisconsin

11:00 a.m. - 6:00 p.m.	EXHIBIT <i>EXHIBIT HALL</i>	
11:30 a.m. - 12:30 p.m.	1987 NATIONAL PROGRAM COMMITTEE <i>SKYWAY ROOM</i>	
11:30 a.m. - 1:30 p.m.	LUNCHEON (Board of Directors, Incoming Committee, Chapter, Council and Section Chairmen Professional Staff) <i>GREENWAY A AND B</i>	
11:30 a.m. - 1:30 p.m.	EXHIBITOR DEMONSTRATIONS (Refer to Guide to Exhibitors for complete listing)	

- General Meters Corporation
GREENWAY F

Demonstration of the COPIER ACCOUNTANT and how it can reduce copier costs, and give full accountability for chargeback purpose. The use of deb cards to eliminate coin box headaches and provide better service to outside doctors and researchers will be shown.

- OCLC
GREENWAY I AND J

OCLC "What's New" Update Session

- Professional Software
GREENWAY H

A Serial Control System and a Circulation Manager operating on the IBM PC XT, AT, or compatible microcomputer.

11:30 a.m. - 1:30 p.m. **INFORMAL MEETINGS**
(see pages 62-63 for locations)

1:30 p.m. - 3:00 p.m. **BUSINESS MEETING II: TOWN HALL MEETING —
MLA SHAPING THE FUTURE (To Be Audio Taped)**
NICOLLET GRAND BALLROOM

Presiding: Jean K. Miller, President, Medical Library Association; Director of Library, The University of Texas Science Center at Dallas, Dallas, Texas

The meeting will provide an opportunity for members to comment on the internal and external economic, social, and technological factors which may or may not impact on the future of the Association and its members. Robert Braude will serve as facilitator for the MLA's quest to "Shape the Future."

3:00 p.m. - 4:00 p.m. **MLA/NLM LIAISON COMMITTEE PROGRAM I**
(To Be Audio Taped)
NICOLLET GRAND BALLROOM

Donald A.B. Lindberg, M.D., Director, National Library of Medicine, Bethesda, Maryland

4:30 p.m. - 6:30 p.m. **SECTION PROGRAMS AND BUSINESS MEETINGS**

- **Medical Library Education Program and Business Meeting**
(To Be Audio Taped)
GREENWAY D

Accreditation: The Role of the Information Professional, Educator, and Association

The speakers will discuss the process of accreditation and the role of the health science librarian, the library educator, and MLA. The work of the MLA Ad-Hoc Committee on Accreditation will be described -- its recommendations, decisions, etc.

Excellence: Else What's a Heaven For?

M. Kent Mayfield, Ph.D., Director of Education, Medical Library Association, Chicago, Illinois

New Horizons in Education for Medical Librarianship

Alan M. Rees, Professor of Library Science, State University of New York at Albany, Albany, New York

Accreditation: Who Pays?

L. Yvonne Wulff, Head Librarian, Taubman Library, University of Michigan, Ann Arbor, Michigan

- **Medical Society Libraries**
GREENWAY E
- **Public Health/Health Administration**
- **Libraries and Relevant Issues** (To Be Audio Taped)
Joint Program
GREENWAY C

Indigent Health Care - The Emergence of a Two Tiered Health Care System

The issue of how to provide health care to the indigent portion of our population is a vital one impacting all components of the health care system. Do all citizens have an equal right to access health care? Who is responsible for providing this care? Who is responsible for paying for it? How is the current crisis in financing health care impacting this issue? In this session this issue and the many questions it raises will be discussed by a panel of distinguished experts. Discussing the issue from a national perspective will be Dr. Robert L. Kane, the new Dean of the University of Minnesota School of Public Health and a nationally renowned scholar of health policy issues. Over the past five years he has focused on issues relating to long-term care. Presenting the issue from the perspective of the states will be Marianne Miller, who has worked on this issue for her Department for the last several years. Barbara A. Baxter will address the question of information resources for policy related issues.

Indigent Health Care - A National Perspective

Robert L. Kane, M.D., Dean, School of Public Health, University of Minnesota, Minneapolis, Minnesota

Health Care of the Indigent; the Minnesota Experience

Marianne Miller, Director, Health Economics Program, Minnesota Department of Health, Minneapolis, Minnesota

Information Sources for the Issue of Indigent Health Care

Barbara Baxter, Director of Collection Development, Texas Medical Center Library, Houston Academy of Medicine, Houston, Texas; formerly Staff Associate, Information Services, American Hospital Association Resource Center, Chicago, Illinois

Open House

NICOLLET A-2

Immediately following the program (6:30 p.m.), both sections are hosting an open house sponsored by BRS and by University Microfilms' Research Collections. All convention attendees are welcome.

- Reference Services Business Meeting and Program
(To Be Audio Taped)

1/2 GREENWAY BALLROOM (J,I,H,G,F)

New Perspectives on Computer Technology

Moderator: Francesca Allegri, Health Sciences Library,
University of North Carolina at Chapel Hill, Chapel Hill, North Carolina

The program will develop two themes in computer applications in health sciences libraries. The first presentation will describe a new application of technology: an individualized multimedia approach to instructing end user searchers. Optical disk technology is the crux around which sound, visuals, and microcomputer technology are organized for this particular mode of information management education. The second speaker will reflect upon our thoughts about the computer and make suggestions which may provoke changes in our perspective. Issues which will be addressed include self-education, current awareness, and humor.

The Development of Interactive Learning Systems with Computer-Controlled Optical Discs for Training Medline End-Users

John P. Phelps, Ph.D., Associate Chairman, Division of Instructional Development and Associate Director, Health Information Technologies and Education Center, School of Allied Health Science, University of Texas Health Science Center, Dallas, Texas

Exorcising the Box

Dale Archibald, Editor, *Computer User*, MSP Publications, Inc., Minneapolis, Minnesota

THURSDAY, May 22

7:30 a.m. - 9:30 a.m. COMMITTEE MEETINGS

- Ad Hoc Committee on Automating the Exchange
GREENWAY G
- Ad Hoc Committee to Develop a Code of Ethics
GREENWAY J
- Certification
GREENWAY F
- Continuing Education
GREENWAY C
- Editorial Committee for the *Bulletin*
GREENWAY B
- Grants and Scholarship Juries
GRANT ROOM
- Health Sciences Library Technicians
GREENWAY H
- Library Standards and Practices
GREENWAY I
- 1987 National Program
SKYWAY ROOM
- 1988 National Program
GREENWAY D

8:00 a.m. - 9:30 a.m. MLA/NLM LIAISON COMMITTEE PROGRAM II
(To Be Audio Taped)
NICOLLET GRAND BALLROOM

NLM Library Operations Update

Lois Ann Colaanni, Associate Director for Library Operations, National Library of Medicine, Bethesda, Maryland

8:00 a.m. - 12:00 noon REGISTRATION
BALCONY OVERLOOKING LOBBY ATRIUM

8:00 a.m. - 12:00 noon PLACEMENT SERVICE
NICOLLET FOYER 4

9:30 a.m. - 11:30 a.m. **BUSINESS MEETING III** (To Be Audio Taped)
 NICOLLET GRAND BALLROOM

Presiding: Jean K. Miller, President, Medical Library Association; Director of Library, The University of Texas Health Science Center at Dallas, Dallas, Texas

- Old Business (continued from Business Meeting I)
- New Business
- Resolutions
- 1987 Annual Meeting Announcement and Welcome
- Introduction of New Members of the Board of Directors

11:30 a.m. - 12:00 p.m. **INAUGURAL ADDRESS**
 (To Be Audio Taped)
 NICOLLET GRAND BALLROOM

Beyond the Edge: Risk and Promise

Judith Messerle, President-Elect, Medical Library Association; Director, Medical Center Library, St. Louis University, St. Louis, Missouri

1:30 p.m. - 3:00 p.m. **PLENARY SESSION III/McGOVERN AWARD LECTURE**
 NICOLLET GRAND BALLROOM

Moderator: Robert M. Braude, Director, McGoogan Library of Medicine, University of Nebraska, Omaha, Nebraska

Computers and the Human Spirit

Sherry Turkle, Ph.D., Associate Professor, Program in Science, Technology, and Society, Massachusetts Institute of Technology, Boston, Massachusetts

3:00 p.m. - 5:30 p.m. **POSTER SESSION II**
 1/2 GREENWAY BALLROOM (F,G,H,I,J)

Booth 1

HUI: A Hawaiian Partnership Blending the Knowledge of the Writer, the Informational Needs of the User, and the Expertise of the Librarian

Frances P. Smith, Arnold Library, Straub Clinic and Hospital, Inc., Honolulu, Hawaii

Booth 2

PR/Publication Partnership for Library Promotion

Sharon E. Hull and Leslie Goodale, Meharry Medical College Library, Nashville, Tennessee

Booth 3

Collection, Display, and Binding of Faculty Publications: A Way to Enhance the Librarian Faculty Partnership

Robert J. Veenstra, Veterinary Medical Library, Auburn University, Auburn, Alabama

Booth 4

Using the OCLC Union Listing Component for a Statewide Health Sciences Union List of Serials

Patricia Wolfgram, Midland Hospital Center Library, Midland, Michigan

Booth 5

Rare Books Outreach

Nancy Rucker, Mayo Clinic History of Medicine Library, Rochester, Minnesota

Booth 6

The University of Minnesota Bio-Medical Library Learning Resources Center

Gale G. Hannigan, Bio-Medical Library, University of Minnesota, Minneapolis, Minnesota

Booth 7

The Philatelist's View of Partnerships Within Medicine

Thomas J. Kosman, Scituate, Massachusetts

Booth 8

End User Searching by Family Practice Residents in Rural Nebraska

Joan Stark, McGoogan Library of Medicine, University of Nebraska Medical Center, Omaha, Nebraska

Booth 9

Briscoe Library/Drug Information Service Partnership

Nancy F. Bierschenk and Leroy C. Knodel, University of Texas Health Science Center at San Antonio, San Antonio, Texas

Booth 10

Library's Bioethics Exhibit Augments Teaching Effort

Barbarie Hill, Children's Hospital Research Foundation Library, Cincinnati, Ohio

Booth 11

JournalScan: A Current Awareness Service

Barbara J. Frey, Lyman Maynard Stowe Library, University of Connecticut Health Center, Farmington, Connecticut

Booth 12

Staff Exchange Program

Sandra K. Millard, Lyman Maynard Stowe Library, University of Connecticut Health Center, Farmington, Connecticut

Booth 13

Journal Coverage: Psychological Abstracts and the Primary Health Sciences Indexes

Robert J. Sekerak, Dana Medical Library, University of Vermont, Burlington, Vermont

Booth 14

The National Library of Medicine Training Program in Medical Informatics: The Minnesota Experience

Lael Gatewood, Minneapolis, Minnesota

Booth 15

"Steps" to Providing MEDLARS End User Training

Rosemary Mattox, St. Francis Regional Medical Center, Wichita, Kansas

Booth 16

Quality Care Through Informed Decisions: Circuit Library Program

Mary Ellinghuysen, Abbott Northwestern Hospital Library, Minneapolis, Minnesota

Booth 17

A Model for Computer Network Interface in the Academic Health Sciences Environment

Julie Johnson McGowan, University of South Carolina School of Medicine Library, Columbia, South Carolina

Booth 18

Micro-Based Book Processing System

Nancy Ann Austin, Health Sciences Library, University of North Carolina at Chapel Hill, Chapel Hill, North Carolina

Booth 19

Research and Development at Washington University School of Medicine Library

Elizabeth Kelly, Loretta Stucki, Barbara Halbrook, and Linda Salisbury, Washington University School of Medicine Library, St. Louis, Missouri

Booth 20

Online Ordering and Claiming - What Benefit?

Mary Charles Lasater and Judith L. Rieke, Medical Center Library, Vanderbilt University, Nashville, Tennessee

Booth 21

Bibliographic File Management Software Open House Program at the Biomedical Library, University of California, San Diego

Susan Starr, Biomedical Library, University of California, San Diego, La Jolla, California

Booth 22

Clinical Consultant to End Users

Ruth Wender, University of Oklahoma, Health Sciences Center, Oklahoma City Oklahoma

Booth 23

End User MEDLINE Training: A Hands-on Approach

Elaine Keefer, Linda Garr Markwell, and Kathy Torrente, A.W. Calhoun Medical Library, Emory University, Atlanta, Georgia

Booth 24

The Twin Cities Biomedical Consortium Today

Jacqueline Wulff, North Memorial Medical Center, Medical Library, Robbinsdale, Minneapolis, Minnesota

3:00 p.m. - 6:00 p.m.

CHAPTER COUNCIL MEETING

GREENWAY E

3:00 p.m. - 6:00 p.m.

SECTION COUNCIL MEETING

GREENWAY A

3:30 p.m. - 5:15 p.m.

CONTRIBUTED PAPERS II
CONCURRENT SESSIONS**SESSION I:**

GREENWAY B

Moderator: Kathryn J. Hoffman, Texas Medical Center Library, Houston, Texas

3:35 p.m.: A Cost-Sharing Formula for a Regional On-Line Circulation and Union Catalog System

Ralph D. Arcari, Health Center Library, University of Connecticut, Farmington, Connecticut

3:55 p.m.: Sharing an Online Catalog: The First Year in Colorado

Charles R. Bandy, Health Sciences Center Library, University of Colorado, Denver, Colorado; and *Marla M. Graber, Health Sciences Center Library, University of Colorado, Denver, Colorado

4:15 p.m.: The Cornell Health Sciences Computerized Library Network: Synergism of Networking

Josefina P. Lim and Jean Reibman, Cornell University Medical College Library, New York, New York

4:35 p.m.: The South Carolina Health Information Network: An Experiment in State-Wide Cooperation

Julie Johnson McGowan, School of Medicine Library, University of South Carolina, Columbia, South Carolina; Nancy C. McKeenan, Libraries and Learning Resource Centers, Medical University of South Carolina, Charleston, South Carolina; *R. Thomas Lange, School of Medicine Library, University of South Carolina, Columbia, South Carolina; and Warren A. Sawyer, Libraries and Learning Resource Centers, Medical University of South Carolina, Charleston, South Carolina

4:55 p.m.: Georgia Interactive Network—GalN—for Medical Information

Jocelyn A. Rankin, Medical Library, Mercer University School of Medicine, Macon, Georgia

SESSION II

GREENWAY C

Moderator: Lisa Rains Russell, Health Sciences Library, University of Alabama, University, Alabama

3:35 p.m. Practicing Physicians as End Users of Online Databases: Initial Results of the Canadian Medical Association/Telecom Canada iNet 2000 Trial

Joanne Gard Marshall, Department of Behavioural Science, Community Health, University of Toronto, Toronto, Canada

3:55 p.m.: PAM (Public Access Microcomputer) Service in an Academic Medical Center Library

Susan Ellingson Russell, Irvine Medical Center Library, University of California, Irvine, California

*First author is the speaker except when noted with an asterisk

4:15 p.m.: Information Management Education: Campus Partnerships

Frieda O. Weise and Patricia Hinegardner, Health Sciences Library, University of Maryland at Baltimore, Baltimore, Maryland

4:35 p.m.: Introducing Online Skills in a Pediatric Residency Program: A Partnership Between Librarian and Clinical Faculty

Rex G. Bickers, Children's Hospital, Columbus, Ohio; and *Mary Pat Wilhem, Medical Library, Hartford Hospital, Hartford, Connecticut

4:55 p.m.: Teaching Library and Computer Literacy in the Cancer Education Program

Marsha Dallaire Williams and James U. Lowe, Meharry Medical College, Nashville, Tennessee

SESSION III*GREENWAY D*

Moderator: Thomas G. Basler, Medical College of Georgia, Augusta, Georgia

3:35 p.m.: Telefaxing Medical Information Among Libraries Serving the University of Medicine and Dentistry of New Jersey

Victor Basile, Janice Rettino, and *Mary Scanlon, University of Medicine and Dentistry of New Jersey, New Brunswick, New Jersey

3:55 p.m.: DOCLINE Implementation in Region I

Micki McIntyre and Gale A. Dutcher, Greater Northeastern Regional Medical Library Program, New York, New York

4:15 p.m.: The Pro-Active Librarian: Partnerships with Faculty, Students, and a Library in the Third World

Marion Holena Levine, University of Connecticut Health Center Library, Farmington, Connecticut

4:35 p.m.: The Case of the Information Explosion

Joyce C. Loepprich, Biomedical Library; Susan Ellingson Russell, Irvine Medical Center Library; and Carl Dennis, Biomedical Library, University of California, Irvine, California

4:55 p.m.: Clinical Medical Librarianship Reexamined

Lisa M. Boyd and Barbara J. Frey, Health Center Library, University of Connecticut, Farmington, Connecticut

SESSION IV*NICOLLET D-1*

Moderator: L. Yvonne Wulff, Alfred Taubman Medical Library, Ann Arbor, Michigan

3:35 p.m.: A Penn/BRS/Saunders Colleague Partnership

Eleanor Y. Goodchild, *Judie Malamud, Mary Berwick, and Adrienne Loev, Biomedical Library, University of Pennsylvania, Philadelphia, Pennsylvania

*First author is the speaker except when noted with an asterisk.

3:55 p.m.: Responding to the GPEP Report: A Medical Education Partnership
Abigail Hubbard, Ph.D.; Barbara Wilson; and Ruth Ellen Bulger, Ph.D., Texas Medical Center Library, Houston Academy of Medicine, Houston, Texas

4:15 p.m.: Teaching Information-Seeking Skills
Anita DeArmond Johnson and Phyllis Self, Library of the Health Sciences at Urbana, University of Illinois, Urbana, Illinois

4:35 p.m.: Library Instruction in a Didactic/Selective Curriculum for Medical Students
Mary Mueller and Gertrude Foreman, Bio-Medical Library, University of Minnesota, Minneapolis, Minnesota

4:55 p.m.: A Microcomputer Elective for Medical Students: A Partnership in Medical Education
Lila Pedersen, Library of the Health Sciences, University of North Dakota School of Medicine, Grand Forks, North Dakota

SESSION V

NICOLLET D-2

Moderator: Mary Ann Knotts, Medical Library, Veteran's Administration Medical Center, Birmingham, Alabama.

3:35 p.m.: Learning and Communication Styles of Library and Health Sciences Students
Barbara Stein, Ph.D., School of Library and Information Science, North Texas State University, Denton, Texas; and James D. Hand, Ph.D., University of Illinois College of Medicine, Rockford, Illinois

3:55 p.m. Continuing Education for Online Searchers in Partnership with a University Extension Telephone Network
Mary B. Blackwelder and *Jacqueline Glick, Froedtert Library, Medical College of Wisconsin Libraries, Milwaukee, Wisconsin

4:15 p.m.: Libraries and Computer Vendors, "Strange Bedfellows or Partners in Progress"
Sallieann Swanner, University of Texas Health Science Center at San Antonio Library, San Antonio, Texas

4:35 p.m.: Partnerships: The Health Sciences Library and the Corporate Library
Thomas Williams and Chris Ellen Bliven, Louis Calder Memorial Library, University of Miami School of Medicine, Miami, Florida

4:55 p.m.: The Meharry Medical College Library Archives: A Partnership of the Past with the Future
Sam A. Cameron and Leslie Goodale, Meharry Medical College Library, Nashville, Tennessee

*First author is the speaker except when noted with an asterisk.

7:00 p.m. - 9:00 p.m. "PORTS OF CALL"

THE ATRIUM — INTERNATIONAL MARKET SQUARE

Enjoy cocktails (cash bar), a variety of international foods, and colorful entertainment in the beautiful Atrium of the International Market Square.

Admission tickets are available for purchase at the Ticket Booth in the Balcony overlooking the Lobby Atrium of the Hyatt Regency Hotel until 12 noon, Thursday, May 22.

FRIDAY, May 23

8:00 a.m. - 5:00 p.m.

BOARD OF DIRECTORS' COMMITTEE MEETINGS

SKYWAY ROOM

8:00 a.m. - 5:00 p.m.

WORKSHOP ON ITEM DEVELOPMENT

NICOLLET D-1, D-2, D-3

ALL DAY

TOURS AND SIGHTSEEING

SATURDAY, May 24

8:00 a.m. - 5:00 p.m.

BOARD OF DIRECTORS' MEETING

SKYWAY ROOM

8:45 a.m. - 3:45 p.m.

TOURS AND SIGHTSEEING

Coming soon . . .

CETUS



BioScan

The Biotechnology Corporate Directory Service

Compiled by Cetus Corporation Information Service

To keep track of developments in this exciting field, The Oryx Press has joined the Cetus Corporation, a major force in biotechnology, to publish BioScan—the most comprehensive and up-to-date information service covering biotechnology companies.

BioScan provides detailed and current information on more than 800 companies worldwide participating in this fast-paced field. BioScan's detailed company profiles cover everything from names of officers and former officers to agreements, joint ventures, and research and development activities. Four indexes facilitate access.

BioScan is published annually in a sturdy loose-leaf binder. Subscribers also receive five bimonthly supplements each year to keep their directories up-to-date.

The inaugural BioScan directory will be published in October. Charter subscribers who place a standing order can save up to 10% off the regular subscription rates.

Visit booth No. 9 for complete information about BioScan and see a host of other vital publications from The Oryx Press.

**For ordering information,
call Toll-Free 1-800-457-ORYX***



The Oryx Press

2214 North Central at Encanto
Phoenix, Arizona 85004-1483

*In Arizona, Alaska, and Hawaii call (602) 254-6156.

OCLC UPDATE

LS/2000 Committed to medical libraries

OCLC Local Systems is committed to support the needs of medical libraries. Our cooperative development work with IAIMS libraries, our efforts on citation retrieval systems, and the increasing number of libraries choosing LS/2000 are the results of that commitment.

These libraries discovered our commitment and chose LS/2000:

- Bowman Gray School of Medicine, Winston-Salem, NC
- Cedars-Sinai Medical Center, Los Angeles, CA
- East Carolina University Health Science Library, Greenville, NC
- Eccles Health Sciences Library, University of Utah, Salt Lake City, UT
- Glendale Adventist Medical Center, Glendale, CA
- Houston Academy of Medicine-Texas Medical Center Library, Houston, TX
- University of Texas Dental Branch Library, Houston, TX
- University of Texas Research Medical Library of the M. D. Anderson Hospital & Tumor Institute, Houston, TX
- University of Texas School of Public Health Library, Houston, TX
- Mt. Sinai School of Medicine of the City University of New York, New York, NY
- New York Academy of Medicine, New York, NY
- Texas A & M Medical Sciences Library, College Station, TX
- University of Arizona Health Sciences Center Library, Tucson, AZ
- University of Connecticut Health Center Library, Farmington, CT
- University of Kentucky Medical Center, Lexington, KY
- University of Maryland at Baltimore Health Sciences Library, Baltimore, MD



The University of Kentucky Medical Center Library

LS/2000 features a sophisticated online catalog, comprehensive circulation control, MARC-based bibliographic and authority control, administrative reporting, and NOW serials control.

OCLC Local
Systems

6565 Frantz Road, Dublin, Ohio 43017-0702
614-764-6000

COMMITTEE MEETINGS SCHEDULE

All meeting rooms are in the Hyatt Regency Hotel

Committee	Date	Time	Room
Ad Hoc Committee on Automating the Exchange	5/22	7:30 a.m.	Greenway G
Ad Hoc Committee to Develop a Code of Ethics	5/22	7:30 a.m.	Greenway J
Audiovisual Standards and Practices	5/19	7:30 a.m.	Greenway B
Awards	5/19	7:30 a.m.	Greenway F
Awards Juries	5/21	7:30 a.m.	Greenway G
Board of Directors	5/14	8:00 a.m.	Greenway A
	5/15	8:00 a.m.	Greenway A
	5/16	8:00 a.m.	Skyway
	5/17	8:00 a.m.	Skyway
	5/23	8:00 a.m.	Skyway
	5/24	8:00 a.m.	Skyway
<i>Bulletin</i> Consulting Editors Panel	5/21	7:30 a.m.	Greenway H
Bylaws	5/19	7:30 a.m.	Grant
Certification	5/18	9:00 a.m.	Greenway F
	5/21	7:30 a.m.	Greenway F
	5/22	7:30 a.m.	Greenway F
Continuing Education	5/19	7:30 a.m.	Greenway C
	5/21	7:30 a.m.	Greenway C
	5/22	7:30 a.m.	Greenway C
Editorial Committee for the <i>Bulletin</i>	5/22	7:30 a.m.	Greenway B
Editorial Committee for the <i>MLA News</i>	5/19	7:30 a.m.	Greenway G
Editorial Panel for Certification and Registration Examination	5/18	9:00 a.m.	Greenway F
Exchange	5/19	7:30 a.m.	Greenway H
Governmental Relations	5/19	7:30 a.m.	Greenway I
	5/21	7:30 a.m.	Greenway I
Grants and Scholarship	5/21	7:30 a.m.	Grant
	5/22	7:30 a.m.	Grant
Health Sciences Library Technicians	5/22	7:30 a.m.	Greenway H
Hospital Library Standards and Practices	5/19	7:30 a.m.	Greenway D
Interlibrary Loan and Resource Sharing Standards and Practices	5/21	7:30 a.m.	Skyway
International Cooperation	5/19	7:30 a.m.	Nicollet Foyer 1
Library Standards and Practices	5/22	7:30 a.m.	Greenway I
MLA/NLM Joseph Leiter Lectureship	5/19	7:30 a.m.	Greenway A
MLA/NLM Liaison	5/21	3:00 p.m.	Nicollet Grand Ballroom
	5/22	8:00 a.m.	Nicollet Grand Ballroom

Membership Committee	5/19	7:30 a.m.	Greenway J
	5/21	7:30 a.m.	Greenway J
1986 National Program	5/16	6:00 p.m.	Skyway
1987 National Program	5/20	4:00 p.m.	Grant
	5/21	11:30 a.m.	Skyway
	5/22	7:30 a.m.	Skyway
1988 National Program	5/21	7:30 a.m.	Greenway D
	5/22	7:30 a.m.	Greenway D
Nominating	5/17	6:00 p.m.	Skyway
Oral History	5/19	5:00 p.m.	Nicollet Foyer 1
Program and Convention	5/19	7:30 a.m.	Skyway
Publication Panel	5/18	9:00 a.m.	Grant
Publications and Information			
Industries Relations	5/21	7:30 a.m.	Greenway B
Status and Economic Interests of			
Health Sciences Library Personnel	5/20	7:30 a.m.	Grant

Sign up for free sample issues at EBSCO'S booth!

You don't have to buy subscriptions sight unseen. EBSCO'S Sample Issue Program lets you see many periodicals before you make choices for your library.

We have the issues on display at our booth during the conference. Come by our booth (48-49/56-57) and sign up for your own free sample copies.

And check out EBSCO Subscription Services. We know the issues of professional serials management. And we have answers.

EBSCO
SAMPLE
ISSUE
PROGRAM



ISSUES

INFORMAL MEETINGS

All meetings are in the Hyatt Regency unless otherwise indicated.

Group	Date	Time	Room
Association of Visual Science Librarians	5/20	5:00 p.m.-7:00 p.m.	Greenway H
AAHSLD Board Meeting	5/19	5:00 p.m.-6:30 p.m.	Holiday Inn, Board Room
Dues Forum	5/20	5:00 p.m.-6:30 p.m.	Holiday Inn, Satellites 6 & 7
Automation: Information Exchange Automation Committee Hospital Library Section	5/21	7:30 a.m.-9:15 a.m.	Greenway A
Circuit Librarians	5/20	5:00 p.m.-7:00p.m.	Greenway G
Collection Development Round Table (Business Meeting)	5/20	4:30 p.m.-6:00 p.m.	Greenway I
DOCLINE Users Group	5/21	4:00 p.m.-5:00 p.m.	Nicollet Grand Ballroom
Georgetown University Medical Center Library	5/19	7:30 a.m.-9:00 a.m.	Holiday Inn, Avenue 4
	5/21	7:30 a.m.-9:00 a.m.	Holiday Inn, Satellite 6
Greater Northeastern Regional Medical Library Program	5/20	5:00 p.m.-6:30 p.m.	Luxford Hotel Nicollet 1,2,3
Hospital Library Section Strategic Planning	5/19	7:00 a.m.-8:45 a.m.	Holiday Inn, Board Room
	5/22	7:30 a.m.-9:30 a.m.	Holiday Inn, Avenue 3
Executive Committee	5/19	11:30 a.m.-2:30 p.m.	Greenway J
	5/20	4:30 p.m.-6:30 p.m.	Greenway J
Membership Committee	5/19	5:00 p.m.-7:00 p.m.	Greenway F,
Consultant and Publications Bylaws and Government Relations	5/19	5:00 p.m.-7:00 p.m.	Greenway G
	5/19	5:00 p.m.-7:00 p.m.	Holiday Inn, Avenue 4
Automation and Continuing Education	5/19	5:00 p.m.-7:00 p.m.	Greenway H
Exercise Class	5/20	7:00 p.m.-9:00 p.m.	Athletic Club

Medical Informatics Roundtable	5/20	3:00 p.m.-4:30 p.m.	Nicollet Foyer 1
NLM Users Group	5/21	11:30 a.m.-1:30 p.m.	Nicollet Grand Ballroom
On-Line Users - Nursing & Allied Health Database	5/20	5:00 p.m.-7:00 p.m.	Greenway F
Philsom Users	5/20	5:00 p.m.-7:00 p.m.	Greenway D
Reference Services Section	5/20	6:00 p.m.-8:00 p.m.	Greenway C
SCRG	5/20	6:00 p.m.-8:00 p.m.	Greenway A
Veterans Administration	5/21	5:00 p.m.-7:00 p.m.	Holiday Inn, Satellites 6 & 7
Wisconsin Health Science Library Association	5/20	5:30 p.m.-8:30 p.m.	Nicollet A-1

**When service is the issue, you'll
find answers at EBSCO'S booth.**



EBSCO emphasizes professional service. And in serials management, professional service can be the answer to your administrative and paperwork problems.

Our worldwide network of professionals, dedicated to giving you quick responses to your questions, can often help eliminate problems before they occur.

Stop by our booth (48-49/56-57) during the conference and see how we can help you address the issue of more professional subscription services.

EBSCO
SUBSCRIPTION SERVICES

*Your Professional Partner
in Serials Management*

P.O. Box 1943, Birmingham, Alabama 35201 205/991-1182

EXHIBITORS

Company Name	Booth Number
Aball Software Inc.	X
Academic Press	7
American Academy of Pediatrics	8
American Association of Retired Persons Ageline Database	12
American Board of Medical Specialties	10
American Library Association (Alanet)	29
American Psychiatric Press, Inc.	81
Appleton Century Crofts	19
Aquinas Subscription Agency, Inc.	40
Ballen Booksellers International, Inc.	5
Better Health Products	87
Biosciences Information Service	4
Blackwell North America, B.H. Blackwell, Boley International Subscription Agency Blackwell Library Systems	66
Brown and Connolly Inc.	25
BRS Information Technologies	50 & 55
BRS/Saunders-Colleague	37 & 38
The Buckstaff Company	18
Cambridge Scientific Abstracts	52
Cardinal Health Systems, Inc.	86
Checkpoint Systems Inc.	70
CLSI	79
Conference Book Service	78
Cooperative Library Agency for Systems & Services	51
Cumulative Index to Nursing & Allied Health Literature	21
Dahlgren Memorial Library - Georgetown University Medical Center	73
Data Research Associates, Inc.	82
Data Trek, Inc.	P
DIALOG Information Services, Inc.	60
Digital Diagnostics Inc.	90
Diogenes(sm)	16
Drug Information Fulltext/IPA	22
Dual Office Suppliers	28
Dun's Marketing Services	94
EBSCO Subscription Services	48, 49, 56, & 57
Embase-Elsevier Science Publishers	BB, CC, & DD
The Faxon Company	62 & 63
Gaylord Bros., Inc.	96
General Meters Corporation	68
Greater Portland Convention and Visitors Association, Inc.	Center Cafe

Harwal Medical Publications, Inc.	98
Health Affairs	65
Horizon Information Services	84
Hospital Satellite Network	93
Institute for Scientific Information	31 & 32
International Cancer Information Center	91
Alfred Jaeger, Inc.	1 & 2
The Library Corporation	53 & 54
Login Brothers Book Company, Inc.	36
Majors Scientific Books, Inc.	39 & 44
Marcive, Inc.	17
Marquis Who's Who	85
Matthews Medical & Scientific Book Company	58 & 59
McGregor Subscription Service, Inc.	71
Mead Data Central	45
Medcom, Inc.	95
Media Library (University of Michigan Medical Center)	67
Medical Data Exchange	13
Micromedex, Inc.	T
Minolta Corporation	92
The C.V. Mosby Company	61
National Center for Health Statistics	80
National Library of Medicine	14 & 15
The Network for Continuing Medical Education	46
Martinus Nijhoff International	77
OCLC Online Computer Library Center, Inc.	74 & 75
The Oryx Press	9
Otto Harrassowitz-Wiesbaden, West Germany	69
PaperChase	23
Pergamon Press, Inc.	3
Population Information Program	33
Princeton Microfilm Corporation	27
Professional Software	76
PsyclINFO	72
Publishers Book Exhibit	41
Read-More Publications, Inc.	35
Research Information Systems, Inc.	99
Research Publications	88
Rittenhouse Book Distributors, Inc.	64
W. B. Saunders Company	30

Spacesaver Corporation	89
Springer-Verlag New York Publishers, Inc.	6
Swets North America, Inc.	42 & 43
Sydney Dataproducts, Inc.	24
Teaching Films, Inc.	34
3M/Safety & Security Systems	97
USB (Universal Serials and Book Exchange, Inc.)	Y
University Microfilms International	26
John Wiley & Sons, Inc.	20
World Health Organization	83
XCP, Inc.	11
Year Book Medical Publishers	47

RESEARCH ASSISTANTS.

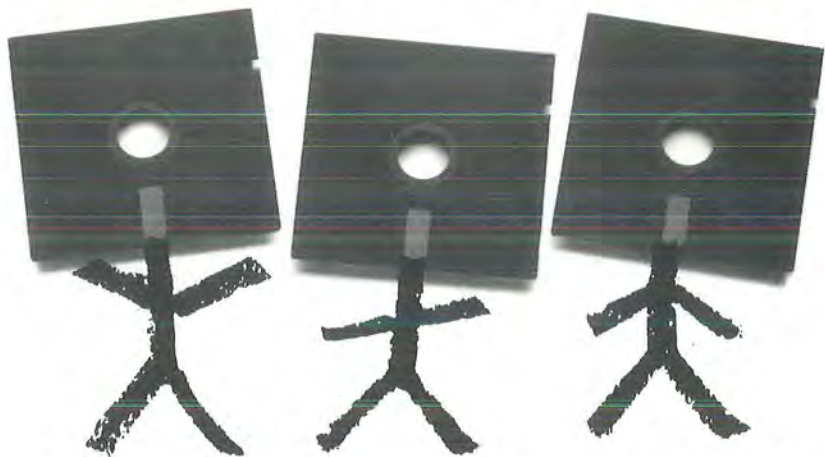

...tireless, accurate, and always on time.

Together, they're called the **Sci-Mate® Software System**, and they produce everything from initial research to correctly referenced manuscripts.

With the **Searcher**, a PC, and a modem, search online databases for the information you want. No need to learn special languages and symbols. The Searcher understands and uses plain English.

With the **Manager**, replace a desk full of index cards. File references from online databases, or enter your own information. The Manager keeps everything—references, lab notes, memos, addresses—up to date and in order.

With the **Editor**—an expert copy chief—format your references in one bibliographic style. Then reformat them in another—instantly. Pop a reference in your manu-

script or bury it in a footnote. The Editor takes the tedium out of responsible scholarship.

Hire the Sci-Mate® assistants. Individually or together, they make research fast, simple, and productive.

Call: **1-800-523-4092**

Pennsylvania residents, call 1-215-386-0100, ext. 1418.

isi®

Institute for Scientific Information®

3501 Market Street
Philadelphia, PA 19104
U.S.A.

In the U.K.: 132 High Street
Uxbridge

Middlesex UB8 1DP
44-895-70016,

Telex: 933693 UKISI

© 1986 ISI 259-4241

Stop by booths 31 and 32 for a demonstration.

SPEAKER AND AUTHOR INDEX

— A —

Agner, Pamela, 33
 Allegri, Francesca, 50
 Anderson, Rachael K., 38
 Arcari, Ralph D., 55
 Archibald, Dale, 51

— B —

Bader, Shelley A., 33
 Bandy, Charles, 55
 Barrett, Laura P., 33
 Basile, Victor, 56
 Basler, Thomas G., 56
 Baxter, Barbara, 50
 Ben-Shir, Rya, 34
 Berman, Sanford, 36
 Berwick, Mary, 56
 Bickers, Rex G., 56
 Bingham, James L., 33
 Bischoff, Frances A., 30
 Blackwelder, Mary B., 57
 Bliven, Chris Ellen, 57
 Boyd, Lisa M., 56
 Braude, Robert M., 52
 Broering, Naomi C., 32
 Buchanan, Holly S., 28
 Bulger, Ruth Ellen, 57

— C —

Cameron, Sam A., 57
 Camille, Damon, 33
 Case, Susan V., 33
 Caven, Mary, 32
 Cheshier, Robert G., 35
 Clark, Nancy, 34
 Colaanni, Lois Ann, 51
 Crawford Susan Y., 32, 38
 Crofts, Jayne M., 30
 Curry, Brenda, 33

— D —

Dennis, Carl, 56
 Doyle, Jacqueline D., 34
 Dutcher, Gale A., 56

— E —

Edwards, Carl N., 30
 Elsesser, Lionelle, 36

— F —

Fedeczko, Joyce L., 34
 Ferguson, Marilyn, 29
 Foreman, Gertrude, 57
 Forsman, Rick B., 32
 Fortney, Lynn M., 35
 Frey, Barbara J., 56
 Fuller, Sherrilynne, 28, 42, 43
 Funk, Mark, 38

— G —

Gatewood, Lael C., 38
 Gerrity, Marline R., 33
 Glick, Jacqueline, 57
 Goodale, Leslie, 57
 Goodchild, Eleanor, 56
 Gorlin, Robert J., 36
 Goshorn, Jeanne, 35
 Graber, Marla M., 55
 Gresehover, Robert S., 30
 Gross, Cynthia R., 36

— H —

Halbrook, Barbara, 32
 Hamberg, Cheryl, 35
 Hand, James, 57
 Harbert, Cathy E., 31
 Harker, Susan, 34
 Harris, Ilene, 31
 Hawk, Susan A., 35
 Heenan, Daniel J., 33
 Hillner, Melanie M., 33
 Hinegardner, Patricia, 56
 Hoffman, Kathryn J., 55
 Holtz, Virginia H., 48
 Howard, Frances, 29
 Hubbard, Abigail, 33, 57
 Hunter, Joy, 34
 Hunter, Steve, 34

— I —

Infante, Ettore, 43

— J —

Jackson, Meliza, 36
 Jenkins, Carol G., 33
 Johnson, Anita DeArmond, 57
 Johnson, Donna P., 43
 Johnson, George O., 43

— K —

Kahane, Stephen N., 30
 Kane, Robert L., 50
 Kelly, Elizabeth, 32
 Key, Jack, 31
 Knotts, Mary Ann, 57

— L —

Lambremont, Jane, 36
 Lange, R. Thomas, 32, 55
 Latimer, George, 29
 Leredu, Martha, 34
 Levine, Marion Holena, 56
 Lim, Josefina P., 55
 Lindberg, Donald A. B., 37, 49
 Loepprich, Joyce, 56
 Loev, Adrienne, 56
 Lovas, Irene, 34
 Lowe, James U., 56
 Lyders, Richard A., 38

— Mc —

McCollister, Robert, 31
 McGee, Jenny, 34
 McGowan, Julie Johnson, 55
 McGowan III, William T., 32
 McIntyre, Micki, 56
 McKeehan, Nancy C., 55
 McVoy, Jean, 34

— M —

Malamud, Judie, 56
 Marshall, Joanne Gard, 55
 Mason, Frank, 33
 Mayfield, M. Kent, 49
 Messerle, Judith, 52
 Miller, Dick R., 32
 Miller, Jean K., 39
 Miller, Marianne, 50
 Moore, Mary, 35
 Montanary, Barbara, 38
 Morse, David H., 33
 Mueller, Mary, 57

— N —

Nakeff-Plaat, Jennifer, 32

— P —

Pass, Franklin, 43
 Pedersen, Lila, 57
 Phelps, John P., 51
 Phillips, Frances, 34

— R —

Rankin, Jocelyn A., 55
 Ream, Diane F., 34
 Rees, Alan M., 49
 Reibman, Jean, 55
 Rettino, Janice, 56
 Richetelle, Alberta L., 34
 Robinson, Judith G., 33
 Robison, Leslie, 35
 Russell, Lisa Rains, 55
 Russell, Susan Ellingson, 55, 56

— S —

Sargent, Charles W., 35
 Sawyer, Warren A., 55
 Scanlon, Mary, 56
 Self, Phyllis, 57
 Smith, Valerie K., 34
 Spyker, Daniel A., 37
 Srivastava, Gita, 33
 Srygley, Ted F., 34
 Stein, Barbara, 57
 Swanner, Sallieann, 57
 Sutton, Lynn Sorensen, 34

— T —

Teitelbaum, Sandra, 30
 Ting, Shirley C., 34
 Turkle, Sherry, 52

— V —

Van Toll, Faith, 31

— W —

Weaver, Carolyn G., 34
 Weise, Freida O., 56
 Wellen, Maureen, 35
 Wilhem, Mary Pat, 56
 Williams, Marsha Dallaire, 56
 Williams, Thomas, 57
 Willoughby, T. Lee, 33
 Wilson, Barbara, 57
 Wineburgh-Freed, Margaret, 33
 Winfield, Susan, 34
 Wulff, L. Yvonne, 49, 56

— Y —

Yokote, Gail A., 33

New!



See a demonstration of the MEDLINE and CSA Life Sciences Collection databases on compact disc at the MLA Meeting

Visit Cambridge Scientific Abstracts (booth 52) at the 1986 MLA Annual Meeting. See how the new CD-ROM technology gives you unlimited database usage on your IBM PC for one low annual fee. Powerful command-driven software plus user-friendly menus.

Cambridge Scientific Abstracts

5161 River Road, Bethesda, MD 20816 □ 301-951-1400

CONTRIBUTIONS

The Medical Library Association
gratefully acknowledges support

for

the 86th Annual Meeting

from

its many friends in the library community

- Ballen Booksellers International, Incorporated
- F.W. Faxon Company, Incorporated
- Alfred Jaeger, Incorporated
- Majors Scientific Books, Incorporated
- Pergamon Press
- Read-More Publications, Incorporated



Is your book budget being absorbed by black holes?

A stolen book takes two off your shelf.

Book theft creates more than the gaping holes that punctuate your library's shelves and frustrate library users. It creates large voids into which your book budget disappears. Funds intended for purchasing new volumes must be spent replacing stolen ones. And that, in turn, threatens the future growth of your library.

A 3M Library Security System expands your library by discouraging theft.

Book theft doesn't have to remain a problem. Proven reliable in libraries across the country, 3M Library Security Systems have been responsible for reducing book losses by up to 99%. A choice of styles provides aesthetic appeal while their very presence discourages thieves.

Guaranteed protection costs as little as \$3 per day.

3M offers a number of financing options designed to fit your budget. You'll find that your library can own a 3M System for as little as \$90 a month. And because every one comes with an 80% Loss Reduction Guarantee, your investment will pay for itself many times over.

Sales Representative Imprint

3M

HYATT REGENCY MINNEAPOLIS

1st FLOOR

-  PUBLIC WALKWAYS
-  GUEST ROOM ELEVATORS
-  GREENWAY ATHLETIC CLUB ELEVATORS
-  PARKING ELEVATORS
-  STAIRWAYS
-  TELEPHONE

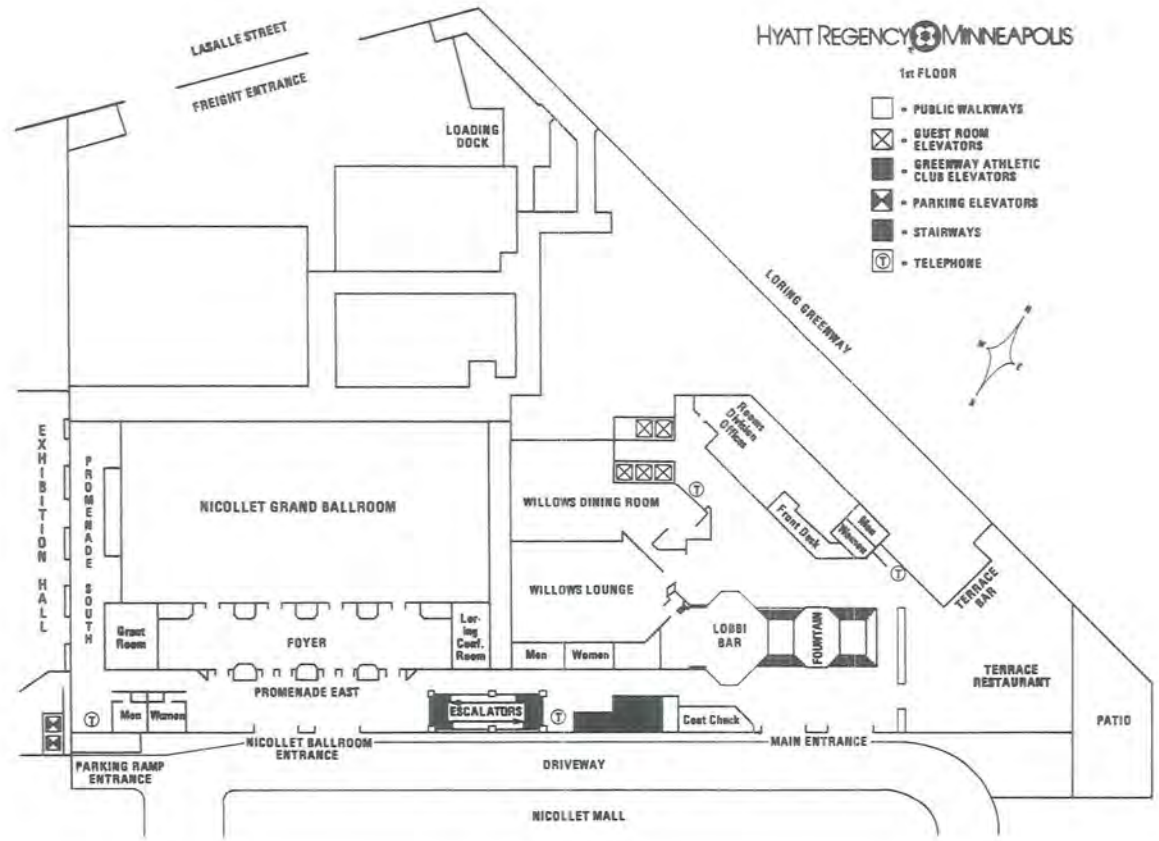

HYATT REGENCY MINNEAPOLIS

2nd FLOOR

-  - RETAIL SHOPS
-  - PUBLIC WALKWAYS
-  - GUEST ROOM ELEVATORS
-  - GREENWAY ATHLETIC CLUB ELEVATORS
-  - STAIRWAYS
-  - TELEPHONE

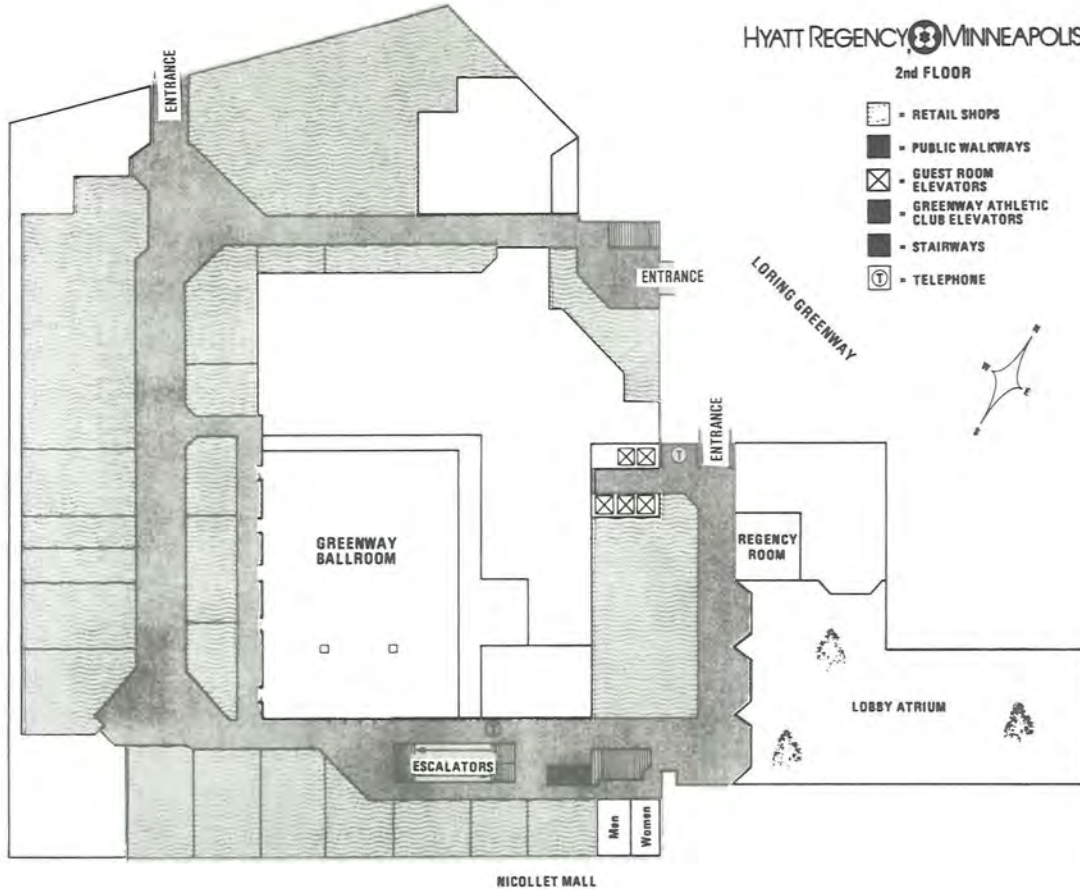

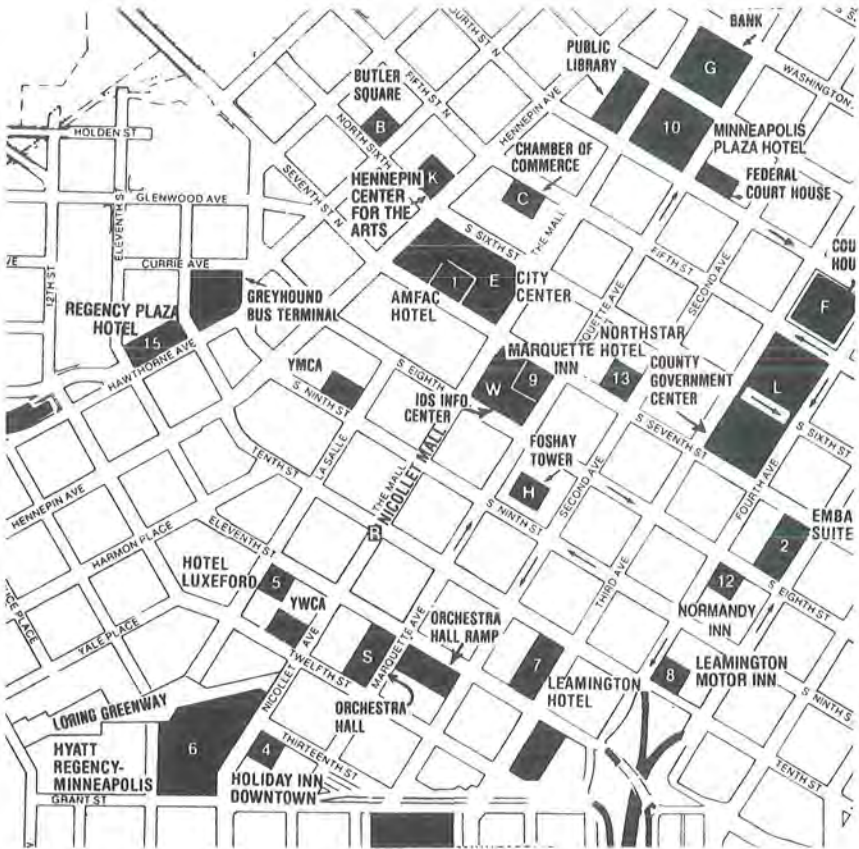

DOWNTOWN MINNEAPOLIS

New Medical Journals from Springer-Verlag

New in 1986

Pediatric Surgery International

Editor-in-Chief: A.F. Schärlf

Pediatric Surgery International publishes significant and up-to-date articles in clinical and experimental pediatric surgery, as well as related fields. A section in each issue will be devoted to a special topic, with invited contributions from recognized authorities.

ISSN: Pending Title No. 383

1986, Volume 1 (4 issues): \$70.00

Dysphagia

An International Multidisciplinary Journal Devoted to Swallowing and Its Disorders

Editor: M.W. Donner

Physicians and health professionals in all fields can turn to **Dysphagia** as the source of information on every aspect of normal and dysphagic ingestion involving the mouth, pharynx and esophagus. **Dysphagia** presents articles which advance the understanding of normal swallowing as well as material related to dysphagia, its diagnosis, and its clinical management.

ISSN: 0179-051X Title No. 455

1986, Volume 1 (4 issues): \$110.00

International Journal of Colorectal Disease

Editor: R.J. Nicholls

Co-Editors: N.J. McC. Mortensen,
J.M.A. Northover

The expansion of clinical and laboratory research in the field of colorectal disease prompts a new publication—**International Journal of Colorectal Disease**. The journal's multidisciplinary board of editors and consultants encompasses the fields of surgery, gastroenterology, endoscopy, radiotherapy, pathology, radiology, physiology, and microbiology.

ISSN: Pending Title No. 384

1986, Volume 1 (4 issues): \$65.00

Neuro-Orthopedics

Editor-in-Chief: H. Verbiest

Neuro-Orthopedics takes a unique approach to disorders and injuries of the musculo-skeletal system by examining them *in conjunction* with the nervous system. The journal publishes articles on applied research as well as diagnosis and clinical management in the following areas—orthopedics, neurosurgery, traumatology, neurology, neuroradiology, biomechanics, anatomy, clinical neurophysiology, rheumatology and rehabilitation.

ISSN: 0177-7955 Title No. 716

1986, Volumes 1-2 (2 issues each): \$80.00

Theoretical Surgery

A Journal of Decision Making in Surgery, Anaesthesia and Intensive Care

Managing Editors: W. Lorenz, J.H. Baron

Theoretical Surgery is a new journal on decision making in surgery, covering all non-operative aspects such as intensive care and anaesthesia in the care of surgical patients. Articles cover methodology and application of clinical decision making in surgery, progress and problems in clinical trials, basic research in surgical patients, cost benefit analysis and audit, risk analysis, controversies, philosophy, ethics and history.

ISSN: Pending Title No. 385

1986, Volume 1 (4 issues): \$70.00

New in 1985

Heart and Vessels

Editor-in-Chief: A. Takao

Heart and Vessels is an international journal covering the diagnosis, treatment and understanding of a wide scope of cardiovascular diseases as well as basic research on the cardiovascular system.

ISSN: 0910-8327 Title No. 380

1986, Volume 2 (4 issues): \$63.00

Child's Nervous System

Official Journal of the International Society for Pediatric Neurosurgery

Executive Editor: A.J. Raimondi

Child's Nervous System covers all aspects of the pediatric neurosciences, including development and growth, trauma, degenerative disorders, hereditary diseases, neurophysiology, neurology, and neurosurgery.

ISSN: 0256-7040 Title No. 381

1986, Volume 2 (6 issues): \$140.00

Ask for your free sample copies of these journals!

Springer-Verlag New York, Inc.

Attn: A. Essen

175 Fifth Avenue

New York, NY 10010



Springer-Verlag

New York Berlin Heidelberg Tokyo

4/86 S4920

Notes

Notes

Notes

Your prescription for current awareness...

Whether you're a practicing physician, nurse, or medical librarian, you and your colleagues share one important concern: keeping up with new medical developments reported in the journal literature. That's why hundreds of busy clinicians and librarians throughout the world rely on *Current Contents/Clinical Practice* for all their current awareness needs...

Each week, *CC*[®]/*CP*'s easy-to-scan format shows you titles of articles from the contents pages of more than 800 journals published worldwide—journals including *The Lancet*, the *American Journal of Cardiology*, and *The New England Journal of Medicine*... And *CC/CP* is specially designed for quick scanning. In less than one hour per week, *CC/CP* subscribers can pinpoint articles of particular interest in their specialties, including radiology, neurology, and nuclear medicine... *CC*'s *Title Word Index* enables you to quickly locate articles on particular topics. The *Author Index & Address Directory* makes it easy to get reprints of articles fast. And the *Publisher's Address Directory* gives you direct access to journal subscription information.

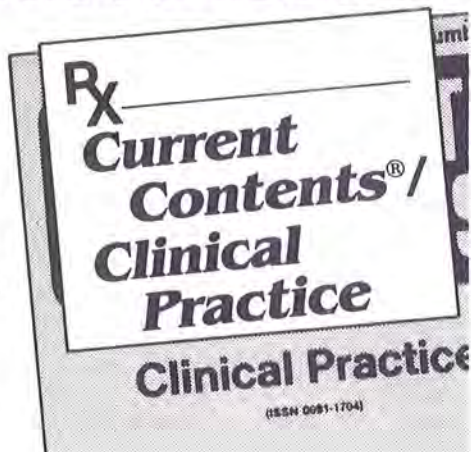

For more information about *Current Contents*, stop by Booths 31 & 32. And for a free sample issue of *CC/Clinical Practice*, fill out and mail the coupon below.

I want to see for myself how *Current Contents*[®]/*Clinical Practice* can fill my current awareness needs. . . Please send me my free sample issue today!

Name/Title

Organization/Department

Address

City

State/Province

ZIP/Postal Code

Telephone

isi[®] Institute for Scientific Information[®]

©1985 ISI 259-4248

Customer Services Department, 3501 Market Street, Philadelphia, PA 19104 U.S.A., Tel: (215) 386-0100, ext. 1405, Cable: SCINFO, Telex: 84-5305
European Office: 132 High Street, Uxbridge, Middlesex UB8 1DP, U.K. Tel: 44-895-70016, Telex: 933693 UKISI

Now Available

Stop by Booth #20 to examine this groundbreaking new reference—review it with your users' needs in mind

The most up-to-date, authoritative and comprehensive dictionary of medicine in English

■ 150,000 terms—nearly 50% more than any existing dictionary

- Covers a much greater range of biomedical specialities including many fields of biology
- Extensive coverage of rapidly changing areas—molecular genetics and immunology...ultrasound, CT-scanning and other imaging techniques... health care delivery systems, etc.
- Over 100 contributors -- including many world-renowned scientists

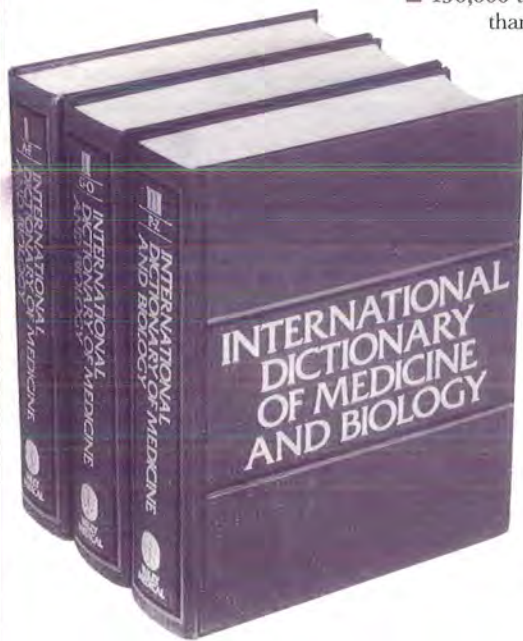

Available in 3 volumes
3,200 pages/0471 01849-X
\$395.00

John Wiley & Sons, Inc.

Order through your medical/library book wholesaler.