



88th Annual Meeting
Medical Library Association
May 20-26, 1988

New Orleans, Louisiana

EXPAND YOUR RESEARCH POWER

**Science Citation Index®
Compact Disc Edition**--search
the science literature using the
power of citation indexing and
compact disc technology.

ISI Atlas of Science® --receive
expert analysis and complete
bibliographies of today's "hot"
research with this new series of
review journals.

**Science Citation Index® 1945-
1954**--access information on ten
of the most crucial years of
scientific research.

ASCA® --receive a customized
weekly report on the latest journal
articles relevant to your area of
interest.

**Current Contents® and Current
Contents Search™** --use the
print version or the online
database to find out what's being
published in current issues of the
world's leading journals.

**Cited Reference Searching:
Online**--learn how to perform ef-
fective cited reference searches
on ISI databases with this new
video.

Current Contents Connection™
--boost productivity with this fast,
easy-to-use software for access-
ing *CC Search*.

**Stop by booths 113-117
for more information.**

isi® Institute for
Scientific Information®

3501 Market Street,
Philadelphia, PA 19104 U.S.A. S- 259-5220
Telephone: (800) 523-1850, ext. 1405

Official Program

**88th Annual Meeting
Medical Library Association
May 20-26, 1988**

New Orleans, Louisiana

"Patrons ask me how they can get accurate up to date health information on every subject. What should I tell them to do?"



**SEARCH
ME!**

PaperChase delivers MEDLINE, the world's largest health database. No one has more health and medical information than we do. No one! Anywhere!

PaperChase

Over 5 million references are ready for you and your patrons **right now**. And they're available 365 days a year, 24 hours a day. From any personal computer with modem. Anywhere. Always up to date.

Call 800-722-2075 today for your free information kit. Your patrons have a multitude of health questions. PaperChase has their health answers.

800-722-2075

617-732-4800

PaperChase • Beth Israel Hospital • 330 Brookline Avenue • Boston, MA 02215

PaperChase is a service of Boston's Beth Israel Hospital, a major teaching hospital of the Harvard Medical School.

Welcome to the 88th Annual Meeting of the Medical Library Association

The National Program Committee and its Local Assistance Subcommittees join me in welcoming you to New Orleans, one of the world's landmark cities. The city offers a diversity of experiences for you. Here you'll find the best of Creole and Cajun food, the home of Dixieland jazz, the vibrant streets of the French Quarter, the loveliness of the Garden District, and bustling port activities along the Mississippi River.

The National Program Committee has planned a varied, informative program with many opportunities for membership participation in contributed papers sessions, small group sharing sessions, and Expo 88: Demonstrations and Posters. The Keynote session and two additional plenary sessions provide presentations on topics important to the entire membership, ranging from information policy issues to technological change, and section and committee-sponsored sessions provide focused programs relevant to specific interests and expertise of MLA members. A comprehensive roster of continuing education courses complement program offerings, and MLA's over 85 exhibitors demonstrate a diversity of health science information services and products.

This year's meeting is the culmination of three years of planning and preparation by the members of the 1988 National Program Committee, its Local Assistance Subcommittees, and MLA Headquarters staff. Section and Committee members, Exhibitors, Sponsors, and many additional MLA members also worked hard to bring the meeting to fruition. To each of these individuals I extend my sincere appreciation.

Bienvenue à Nouvelle Orléans!

Mary M. Horres
Chairman
1988 National Program Committee

WHAT'S NEW IN PSYCHIATRIC PUBLISHING?

Visit Booth #112 at the Medical Library

Association meeting in New Orleans to find out!

Announcing . . .

The American Psychiatric Press Textbook of Psychiatry

*Edited by John A. Talbott, MD;
Robert E. Hales, MD; and Stuart C.
Yudofsky, MD*

At last . . . a comprehensive single volume reference to modern Psychiatry. Clinically relevant and data based, the more than 60 contributors, under the umbrella of a distinguished Editorial Board, have strived to eliminate all psychiatric jargon and theoretical vagaries. The contributors, distinguished in their respective fields, have been carefully selected for their distinct ability to pass on their knowledge.

Each chapter is structured to address a specific topic in considerable detail, but without providing extraneous information. The Textbook is completely correlated with *DSM-III-R*, with the Diagnostic Criteria included in an appendix. A second appendix presents excerpts from the recently published *Sixth Edition of the American Psychiatric Glossary*.

March 1988/1,312 pages/17 color illustrations & numerous b & w photos, tables, charts
\$85.00/ORDER #8251

Also of Interest . . .

Study Guide and Self-Assessment for The American Psychiatric Press Textbook of Psychiatry

Mark Lovell, PhD, and Michael D. Franzen, PhD

Follows the same chapter outline as *The Textbook*, with questions and answers for each section.

March 1988/272 pages/\$20.00 paper
ORDER #8293

The American Psychiatric Press Textbook of Neuropsychiatry

*Edited by Robert E. Hales, MD and
Stuart C. Yudofsky, MD*

"A multi-authored work focusing on the problems of patients with symptoms that overlap the disciplines of psychiatry and neurology. The editors have chosen authors

who have made original contributions to the areas addressed and who can write with authority.

"I recommend this book highly, especially for the reader desiring clinically applicable information and a solid bibliography. Practitioners in many settings will find information relevant to the care of their patients. This textbook will be widely read and discussed."

—*New England Journal of Medicine*

1987/480 pages/illustrated/\$59.95
ORDER #8217

Study Guide and Self-Assessment for The American Psychiatric Press Textbook of Neuropsychiatry

Michael D. Franzen, PhD, and Mark Lovell, PhD

" . . . Superb, highlighting the most important issues and providing annotated answers for the self-assessment tests provided with each chapter."

—*New England Journal of Medicine*

1987/144 pages/\$20.00 paper
ORDER #8277

Updated Version of a Classic Reference

American Psychiatric Glossary Sixth Edition

Compiled and Edited by Evelyn M. Stone

The first major revision to this essential reference tool in eight years. Contains more than 200 new entries and revisions, and incorporates the revised nomenclature of *DSM-III-R*.

1988
hardcover: 152 pages/\$19.95
ORDER #8275
paperback: 232 pages/\$10.00
ORDER #8288

All American Psychiatric Press books are available through your local medical book distributor. Or you can order direct from the publisher by toll-free phone: (800) 368-5777.

American
Psychiatric
Press, Inc.

Suite 1101
1400 K Street, N.W.
Washington, D.C. 20005

Table of Contents

	Page
Board of Directors	1
Appointed Officers	3
Headquarters Staff	3
National Program Committee	5
Contributors	7
Continuing Education Courses	9
General Information	13
Registration Center	13
Tickets for Special Activities	14
Hospitality Booth	14
Child Care	16
Tours Desk	16
MLA Exhibit	16
MLA Scholarship Booth	16
Meeting Locations	19
Taped Sessions	19
Film Festival 1988	19
1988 Exhibit	19
Lost and Found	20
MLA Office	23
Placement Service	23
Newsletter	23
Message Center	23
Office Equipment	23
Handicapped Access	24
Safety Tips	24
1989 Annual Meeting	24
Daily Program	29
Wednesday, May 18	29
Thursday, May 19	29
Friday, May 20	29
Saturday, May 21	30
Sunday, May 22	31
Monday, May 23	37
Tuesday, May 24	48
Wednesday, May 25	58
Thursday, May 26	68
Friday, May 27	68
Maps	70
Index to Presenters	74
Exhibitors	78
Index to Advertisers	81
Committee Meeting Schedule	82
Informal Meeting Schedule	84
Index	88

The difference between Faxon and other subscription service firms is the difference between spending your budget wisely, and merely spending it.

Faxon's Medical Group can provide you with more helpful financial management services and budgeting tools than any other subscription service firm. These services help you gain better control of your budget by providing the information you need, including where the potential exists for cost savings.

Faxon also has two new services – MEDLINE Knowledge Finder and Biomedical Document Delivery Service – designed specifically for medical libraries and their patrons.

For unmatched financial management and budgetary control services, unique medical library services, plus superior subscription and continuation services, Faxon is the right choice. Find out more about us at our MLA conference booths, 92-94 and 108-110. Or, contact The Faxon Company, Inc., 15 Southwest Park, Westwood, MA 02090. Our toll-free number is 1-800-225-6055 (in MA, AK or HI call collect, 617-329-3350).

FREE CD-ROM Catalog! ACCESS is new from Faxon. It gives you a single, comprehensive way to source all CD-ROM titles and publishers, as well as CD-ROM hardware manufacturers, consultants and independent services. Feature articles help you keep up with the latest CD-ROM developments. The 48-page premiere issue is yours free when you stop by the Faxon booths, 92-94 and 108-110.

The logo for Faxon, featuring the word "faxon" in a bold, lowercase, sans-serif font. The letter "a" is stylized with a horizontal bar through it.

Medical Information Services Division

1987-88 MLA Board of Directors

Holly Shipp Buchanan, *President*
Corporate Information Resources
NKC Hospitals
Louisville, Kentucky

Eloise C. Foster, *President Elect*
AHA Resource Center
American Hospital Association
Chicago, Illinois

Judith Messerle, *Immediate
Past President*
Medical Center Library
St. Louis University
St. Louis, Missouri

Jacqueline D. Bastille, *Director*
Treadwell Library
Massachusetts General Hospital
Boston, Massachusetts

Mickey Cook, *Director*
Medical Library
Washington Hospital Center
Washington, DC

Sherrilynne S. Fuller, Ph.D., *Director*
Health Sciences Library and
Information Center
University of Washington
Seattle, Washington

J. Michael Homan, *Director*
Sciences Library
University of California, Irvine
Irvine, California

*Rosanne Labree, *Director*
Mental Health Sciences Library
McLean Hospital
Belmont, Massachusetts

Richard A. Lyders, *Director*
Texas Medical Center Library
Houston Academy of Medicine
Houston, Texas

+Audrey Powderly Newcomer,
Director
McGoogan Library of Medicine
University of Nebraska Medical
Center
Omaha, Nebraska

Fred W. Roper, Ph.D., *Director*
College of Library and
Information Science
University of South Carolina
Columbia, South Carolina

Gail A. Yokote, *Director*
Louise Darling Biomedical Library
Center for the Health Sciences
University of California, Los Angeles
Los Angeles, California

Raymond A. Palmer, *Executive
Director*
Medical Library Association
Chicago, Illinois

*Chapter Council Chairman
+Section Council Chairman

OCLC

Services for Medical Libraries

Some Simple Truths About OCLC and Medical Libraries

1. Medical Libraries are valuable members of OCLC.

Your specialized collections are important resource sharing additions to the Online Union Catalog. Your unique records enhance the OCLC database, which benefits all member libraries.

2. Small Medical Libraries can afford OCLC.

We know Medical Libraries vary greatly in size and degree of financial resources available for automation. But whether you have a staff of 1 or 100, OCLC represents a cost-effective way of providing library service. Yes, there are fees associated with OCLC membership. But, these costs are offset by the savings accrued through shared cataloging and resource sharing. Staff hour for staff hour, OCLC can save you time and money. And that's true no matter the size of your library.

3. You do more than cataloging—and so do we.

As a Medical Librarian, you acquire, organize, and disseminate information. And OCLC can help—from acquisitions to cataloging, from interlibrary loan to online and compact disc database searching, we work with you to improve service to your clients.

4. You don't need special equipment to use OCLC services.

Many Medical Libraries have been using terminals and microcomputers for years, which makes the move to OCLC even more cost-effective. The PC-compatible microcomputer or "dumb" terminal you already own can be used to access OCLC services. There's no need to purchase new hardware or pay for a dedicated telecommunications line.

Simply stated, isn't this the year you should visit the OCLC booth to learn more about what we do? Large or small, we want to work with you.

And that's the simple truth.



OCLC Online Computer Library Center, Inc.
6565 Frantz Road
Dublin, Ohio 43017-0702
(614) 764-6000

OCLC BOOTH 51

Appointed Officers

Raymond A. Palmer,
Executive Director
Medical Library Association
Chicago, Illinois

Darel Jay Robb,
Parliamentarian
Urbana, Illinois

Mary Helms,
Sargeant at Arms
School of Medicine Library
Washington University
St. Louis, Missouri

Nancy Fabrizio,
Editor, MLA News
Health Sciences Library
State University of New York at
Buffalo
Buffalo, New York

Susan Y. Crawford, Ph.D.,
*Editor, Bulletin of the Medical
Library Association*
School of Medicine Library
Washington University
St. Louis, Missouri

MLA Headquarters Staff

Administration

Raymond A. Palmer, Executive Director
Lisa McKamy, Assistant to the Executive Director
Jeffrey Crouch, Secretary to the Executive Director

Raymond S. Naegele, Director of Financial and Administrative Services
Eliezer Ventura, Accounting and Records Manager
Patricia Carolan, Secretary for Membership and Public Relations
James McKinley, Office Management Assistant
Candy Wederbrook, Accounting and Records Assistant

Professional Development

M. Kent Mayfield, Ph.D., Associate Executive Director
Eileen Fitzsimons, Ph.D., Program and Information Resources Coordinator
Daniel Mendelson, Meetings and Exhibits Planner
Katie McMunn, Member and Program Services Assistant
James Rusnak, Secretary to the Associate Executive Director

Communications

Nell Lundy, Editorial and Production Assistant
Bertha Ruckman, Secretary to the Director of Communications

O u r o n l i n e d a t a b a s e s

stand alone

i n d r u g i n f o r m a t i o n .

ASHP® databases help you to locate a wide scope of drug information, including fulltext drug monographs, patient counseling information and abstracts of articles.

Drug Information Fulltext®



The DIF database contains detailed, comprehensive drug information representing over 50,000 marketed drug products.

Consumer Drug Information™



CDIF is a fulltext database with descriptions written for the patient's understanding. More than 3,000 brand name drug products are covered.

International Pharmaceutical Abstracts®



The IPA database is the practical, efficient way of locating information from over 800 pharmaceutical, medical, cosmetic and other health-related journals throughout the world. IPA's abstract/indexing system works to help you easily locate the information.



ASHP databases are available around the world through international online computer systems. For a brochure or more information, contact ASHP's Database Services at 301-657-3000, or write to:



ASHP Database Services
4630 Montgomery Avenue
Bethesda, MD 20814

1988 National Program Committee

Mary E. Horres, *Chairman*
Biomedical Library
University of California, San Diego
La Jolla, California

Carolyn E. Lipscomb,
Associate Chairman
Health Sciences Library
University of North Carolina at
Chapel Hill
Chapel Hill, North Carolina

Betsey Beamish, *Member*
Rick B. Forsman, *Member*
Nelson J. Gilman, *Member*
Judith Hodges, *Member*
Sheldon Kotzin, *Member*
Lynn A. Lloyd, *Member*
Richard A. Lyders, *Member*
Fred W. Roper, Ph.D., *Member*
Leonard Schrift, *Member*
Madeline V. Taylor, *Member*
M. Kent Mayfield, Ph.D.,
Associate Executive Director
Daniel Mendelson, *Meetings and*
Exhibits Planner
Holly S. Buchanan, *Board of*
Directors Liaison

Expo '88: Demonstrations and Posters

Nelson Gilman, *Chairman*
Janis Brown
Ellen Green
Leonard Schrift

Contributed Papers

Carolyn Lipscomb, *Chairman*
Rick Forsman
Sheldon Kotzin
Lynn Lloyd
Madeline V. Taylor

Local Assistance Committee

Judith Caruthers, *Co-Chairman*
W.D. Postell, Jr., *Co-Chairman*

Hospitality Committee

Mary Marix, *Co-Chairman*
Elizabeth Strother, *Co-Chairman*
Karen Bertel
Mary Holt
Nancy Keller
Susan Loubiere

Publicity and Promotion Committee

Cynthia Goldstein, *Chairman*
Joan Marcotte
Marianne Puckett
Margaret Rennie
Rudy Whipple

Social Events Committee

Ann Macomber, *Co-Chairman*
Patricia Copeland, *Co-Chairman*
Jean Rouse

Tours Committee

Kathleen Puglia, *Chairman*
Wilma Nevue
Marylynn Rooney

Facilities/Assistance and Continuing Education Assistance Committee

Mildred Moore, *Chairman*
B. Carol McGee
Judith Roberts
William Ross
William Triplet

New and Recent Journals from Springer-Verlag

• New in 1988

Adolescent and Pediatric Gynecology

Editor-in-Chief: P.G. McDonough

Transplant International

Editor-in-Chief: G. Koostra

• First Appearing in 1987

Cell Biology Reviews/ Revisiónes sobre Biología Celular

Editor: E. Barbera-Guillem

European Journal of Cardio-thoracic Surgery

Editor: H.G. Borst

Pediatric Nephrology

Journal of the International Pediatric Nephrology Association

Editor: A.M. Robson; Co-Editor: C. Chantler

Surgical Endoscopy Ultrasound and Interventional Techniques

Editorial Board: G. Berci, T. Dent, M. Endo, K.A. Forde, H. Groill,
B.C. Manegold, G. Marks, A. Montori, J. Terblanche, and H. Troidl

• Now published by Springer-Verlag

Nutrition Reviews

Editor: R.E. Olson

• Books of Interest

Medicine: Preserving the Passion

P.R. Manning and L. DeBakey

Two-Dimensional Echocardiographic Atlas Vol. I, Congenital Heart Disease

J.B. Seward, A.J. Tajik, W.D. Edwards, D.J. Hagler

Acupuncture Textbook and Atlas

G. Stux and B. Pomeranz

Family Medicine Principles and Practice

THIRD EDITION

Edited by R.B. Taylor

For more information on these and other medical titles published by Springer-Verlag, **visit our booth or write to: Springer-Verlag New York, INC.,** Attn: D. Emin (L153), 175 Fifth Avenue, New York, NY 10010

3/88

L153



Springer-Verlag

New York Berlin Heidelberg Vienna London Paris Tokyo

Contributors

The Medical Library Association gratefully acknowledges support for the 88th Annual Meeting from the following organizations

- Ballen Booksellers International, Incorporated
- BRS Information Technologies
- EBSCO Subscription Services
- The FAXON Company, Incorporated
- Institute for Scientific Information
- Login Brothers Book Company
- Majors Scientific Books, Incorporated
- Readmore Publications, Incorporated
- South Central Regional Group of the Medical Library Association

THE RESOURCE AUTHORITIES.



"Even when 16th and 19th century periodicals are available, the convenience and comfort of working from microform makes it a valuable tool for researchers in medical history. The periodicals themselves benefit as well, being exposed to less wear and tear."

—Dr. Sherwin Nuland
Associate Clinical Professor of Surgery,
Yale University
Associate Editor, *Journal of the History
of Medicine and Allied Sciences*
Chairman, Board of Trustees, *Associates
of the Yale Medical Library*
Author

American Medical Periodicals, 1797–1900 a comprehensive collection in microform.

American Medical Periodicals, 1797–1900 is based on holdings of the National Library of Medicine in Bethesda, Maryland, one of the world's richest resources for research into the history of medicine. This comprehensive collection of over 1,200 periodicals from Research Publications provides rare insight into all aspects of nineteenth-century American medical thought and development, and also provides a view into sociological and psychological impacts. Many of the early journals contained a diversity of topics, making them a rich source for local history.

These journals trace the growth of medical societies, the demand for definitive ethics, the development of medical education, and record the history of such significant discoveries and trends as: anesthetics, cellular pathology, microorganisms and infection, inoculation, botanic medicine, legislation and public health, dental science, and quasi- and pseudo-medical practices and philosophies.

For detailed information call 1-800-REACH-RP now. From Connecticut, Alaska and Canada, call collect (203) 397-2600.

Please send me information on other RP products and services checked:

- Early American Medical imprints 1668–1820
- Journals in Microform
- Research Collections in Microform
- Television News Transcripts and Indexes
- International Newspapers on Microfilm
- Newspaper Indexes
- U.S. and International Patent Documentation

rp infofile # 8 research publications®

12 Lunar Drive/Drawer AB
Woodbridge, CT 06525
Toll-free: 1-800-REACH-RP
TWX: 710-465-6345
FAX: 203-397-3893

- Please send me more information on American Medical Periodicals, 1797–1900.
- Please have a sales representative call me.

Name _____ Title _____
Institution _____
Address _____
City _____ State _____ Zip Code _____
Phone _____

For further information, or to place your order directly, call 1-800-REACH-RP (1-800-732-2477).

1-800-REACH-RP

Continuing Education Courses

Continuing Education courses are offered Friday, May 20; Saturday, May 21; Sunday morning, May 22; Thursday, May 26; and Friday, May 27. On Thursday and Friday, May 20 and 21, courses from the MLA Continuing Education Roster will be given in the Doubletree Hotel, and New Perspective courses will be given in the Sheraton New Orleans Hotel. All Sunday courses are in the Doubletree Hotel, and all post-conference courses are in the Sheraton New Orleans Hotel. To register on site, check the MLA Registration Center.

All courses are scheduled from 8:30 a.m.- 5:00 p.m. except Sunday courses, which are scheduled from 8:30 a.m.- 12:30 p.m. An asterisk (*) indicates a two day course. Instructors' names appear in parentheses.

FRIDAY, May 20

NP 088—AIDS: Concepts and Resources (Ginn and Stevens), Pontchartrain D, Sheraton New Orleans

NP 880—An Introduction to Research Methods for Health Sciences Librarians (Marshall), Bayside B, Sheraton New Orleans

NP 881—Information Resources in Gerontology and Geriatric Medicine (Grainger), St. Charles A, Sheraton New Orleans

*NP 888—Systems Analysis Techniques for Health Science Librarians (Koenig and Davison) (Day 1), St. Charles B, Sheraton New Orleans

NP 889—Indexing and Thesaurus Construction (Batty), Aurora, Sheraton New Orleans

CE 112—Collection Development and Use (Gilman), Madewood A, Doubletree

CE 246—Introduction to Financial Management for Health Sciences Librarians (Byrd), Madewood B, Doubletree

CE 456—Advanced Skills for Online Searchers (Feinglos), Shadows, Doubletree

CE 459—Online Biomedical Searching in the Health Sciences (McGregor) Notoway A, Doubletree

CE 675—Editing and Producing a Newsletter (Pisciotta), Notoway B, Doubletree

CE 680—Health Professionals and Information: Value, Variables, Variety (Meadows and Hamberg) Rosedown, Doubletree

SATURDAY, May 21

NP 882—Leadership and Modern Management (Kirkpatrick), Bayside A, Sheraton New Orleans

NP 883—An Introduction to the Preservation of Library Materials (Byrnes), Bayside B, Sheraton New Orleans

NP 884—Reading and Evaluating Reports of Clinical Research: A Basic Introduction (Fuller), Aurora, Sheraton New Orleans

NP 885—Managing Microcomputers (Camille), St. Charles A, Sheraton New Orleans

*NP 888—Systems Analysis Techniques for Health Sciences Librarians (Day 2) (Koenig and Davison), St. Charles B, Sheraton New Orleans

CE 114—Essentials of Online Searching: What You Need to Know to Be an Effective MEDLINE Searcher (Yokote), Madewood A, Doubletree

CE 122—Planning Library Facilities (Stroyan), Madewood B, Doubletree

CE 245—Marketing Library Services (Rees), Shadows, Doubletree

CE 342—Nursing Information Resources (Peloquin), Notoway A, Doubletree

CE 352—Governmental Information Resources (Budrew), Notoway B, Doubletree

CE 370—Information Resources in Clinical Medicine (Wood), Rosedown A, Doubletree

CE 454—Oncology: Concepts and Resources (Seltzer), Rosedown B, Doubletree

CE 637—Health Information Services for the Layperson (Hackleman), Crescent A, Doubletree

SUNDAY, May 22 (half-day courses)

NP 886—Current Issues in Bibliometrics (Brooks), Shadows, Doubletree

901—Procedures Manuals: A Management Tool for the 80's (Taylor), Madewood A, Doubletree

902—How to Present a Successful Workshop (Ward), Madewood B, Doubletree

THURSDAY, May 26

NP 887—So You Need a Consultant (Rubin), Bayside B, Sheraton New Orleans

*NP 988—Expert Systems Design (Day 1) (Strong), St. Charles, Sheraton New Orleans

CE 258—Planning: Strategic and Tactical (Prime), Estherwood, Sheraton New Orleans

FRIDAY, May 27

*NP 988—Expert Systems Design (Day 2) (Strong), St. Charles, Sheraton New Orleans

**We've
got
you
covered.**

**Come by the EBSCO
Booth to get your
serials needs covered!**

EBSCO has all your serials needs covered—from locating and efficiently processing the order for an obscure publication to keeping all your active claims up-to-date to providing you with customized reports for improved serials management. And, because we are as committed to keeping your customer service and serials management needs covered as we are to increasing our database of serials titles, we operate 23 regional processing offices throughout the world. At EBSCO, in addition to a qualified sales representative, your account will be

serviced by a knowledgeable customer service representative and an entire regional office staff dedicated to providing you with sound customer service.

Isn't that what you expect from a professional subscription agency?

EBSCO
SUBSCRIPTION SERVICES
International Headquarters
P.O. Box 1943
Birmingham, Alabama 35201
(205) 991-1182

•
*Serving you from 23 offices
around the world*

ANNOUNCING . . .

The NEW 1988 Supplement to the Directory of Medical Specialists, 23rd Edition

Let this invaluable NEW fourth component of the *Directory of Medical Specialists* set **make your job easier.**

To find out how, stop by the Marquis Who's Who booth.

You may even win a FREE copy of this new four-volume set—**that's a \$325.00 value!**

But you must enter to win, so come visit us; we're in booth #95.



MARQUIS
Who'sWho
MACMILLAN DIRECTORY DIVISION

3002 Glenview Road
Wilmette, Illinois 60091

GENERAL INFORMATION

REGISTRATION CENTER

The Registration Center is located in the Sheraton New Orleans Hotel Pontchartrain Ballroom Foyer. In addition to the Registration and Pre-Registration Areas, the MLA Exhibit, Hospitality/Information Booth, MLA Scholarship Booth, Message Board, Tapes Desk, and Tour Desk are located here. Official conference badges, ribbons, programs, tickets, and other meeting materials are available at the Registration Center.

Registration Center Hours

Thursday, May 19	4:00 p.m. - 8:00 p.m.
Friday, May 20	7:00 a.m. - 8:30 a.m.
	4:00 p.m. - 8:00 p.m.
Saturday, May 21	7:00 a.m. - 6:00 p.m.
Sunday, May 22	7:00 a.m. - 4:00 p.m.
Monday, May 23	8:00 a.m. - 4:00 p.m.
Tuesday, May 24	8:00 a.m. - 4:00 p.m.
Wednesday, May 25	8:00 a.m. - 4:00 p.m.
Thursday, May 26	7:00 a.m. - 8:00 a.m.

Badges and ribbons are color-coded to assist you in identifying the roles and responsibilities of each registrant

Ribbons

Brown.....	Presenters
Dark Blue.....	Chapter Council Representatives and Alternates
Light Blue.....	Committee Chairmen
Gold.....	Membership Committee
Dark Green.....	Section Council Representatives and Alternates
Light Green.....	First Time Attendees, New Members, and Guests
Lavender.....	International Cooperation Committee and International Visitors
Orange.....	MLA Headquarters Staff
Pink.....	Hospitality Committee and Volunteers
Purple.....	Exhibitors
Red.....	Contributors
Rose.....	National Program Committee
Yellow.....	Instructors, Speakers, and Moderators
White.....	Officers, Board Members, and Appointed Officers

Badges

Blue.....	Regular, Fellow, Honorary, and Life Individual Members
Pink.....	Institutional Representatives
Yellow.....	Institutional Representative and one of the above categories
White.....	Non-Member, Exhibitor, Sustaining, Associate, Student

TICKETS FOR SPECIAL ACTIVITIES

Tickets for special events, if still available, may be purchased at the Ticket Desk located at Registration during regular registration hours (see above). Please note ticket sale cut-off time for each event. If you have any questions about special events or tickets, please inquire at the Ticket Desk.

Event	Date	Ticket Price	Ticket Sales End
*Welcome Reception	Sunday, May 22	\$10.00	12:00 noon Sunday
History of Health Sciences Dinner	Monday, May 23	\$25.00	4:00 p.m. Sunday
Hospital Libraries Luncheon	Tuesday, May 24	\$18.00	4:00 p.m. Monday
President's Reception	Tuesday, May 24	\$50.00	12:00 noon Tuesday
*+Closing Banquet	Wednesday, May 25	\$50.00	4:00 p.m. Tuesday

*One ticket to this event included with the Inclusive and Conference Only Registration Fee.

+One ticket to this event included with the Inclusive Registration Fee.

President's Reception/Masquerade Party

President Holly Shipp Buchanan cordially invites you to attend her President's Reception, beginning at 6:30 p.m. Tuesday evening, a benefit to initiate an endowment fund for the Cunningham Memorial International Fellowship. Your tax-deductible contribution to this worthy cause is your "ticket" to a delightful pre-dinner party featuring fine wines and mouth-watering hors d'oeuvres. Mardi Gras style masks can be purchased at the MLA Scholarship Booth.

Closing Banquet

Bring the meeting to a close with a delightful evening of dinner and dancing. Dinner begins at eight, featuring Louisiana Trout Amandine, with a cash bar beginning at 7:00 p.m. For your dancing and listening pleasure the evening's entertainment will be provided by Percy Humphrey and the Crescent City Joymakers. Come celebrate a night of fine cuisine and entertainment as only New Orleans can provide.

HOSPITALITY BOOTH

Welcome to New Orleans! The Hospitality/Information Booth has information about the conference program, the city of New Orleans, and points of interest in the surrounding areas. Feel free to drop by to learn about things that "shouldn't be missed." The Hospitality/Information Booth is located at the Registration Center, Sheraton New Orleans Hotel, and is open during the following hours:

Friday, May 20	4:00 p.m. - 8:00 p.m.
Saturday, May 21	7:00 a.m. - 6:00 p.m.
Sunday, May 22	7:00 a.m. - 4:00 p.m.
Monday, May 23	8:00 a.m. - 4:00 p.m.
Tuesday, May 24	8:00 a.m. - 4:00 p.m.
Wednesday, May 25	8:00 a.m. - 4:00 p.m.

Visit us at
"ISLAND C" at the
MLA Annual Meeting
in New Orleans,
May 23-25, 1988

Announcing

EMBASE *plus*

The Excerpta Medica Database

Database enhancements make EMBASE *plus* easier and more flexible to search. And, EMBASE *plus* retains those features which have distinguished the database: in-depth drug indexing, high percentage of unique records, most records containing abstracts, and comprehensive, international coverage of the world's biomedical and drug literature.

plus means -

- 30-day throughput time for all articles
- One appearance of each record online with complete indexing, classification and abstracting
- 20% increase in the number of records added to the database annually
- EMTREE - a new, simplified, hierarchical thesaurus incorporating the most frequently used MALIMET terms. These 22,500 MINI-MALIMET terms have been combined with EMTAGS and formed into a "tree-like" structure to provide hierarchic access.
- New Chemical Abstract Service (CAS) Registry Number field
- Linked index terms
- Linked drug manufacturer and trade name fields
- Up to 20 author names per article
- ISSN number field

Write or phone

In North America

Elsevier Science Publishers
North American Database Department
52 Vanderbilt Avenue
New York, NY 10017
Tel: (800) HLP-EMED; (212) 916-1161

In Japan

Excerpta Medica, Ltd.
No. 5 Kowa Building
15-23, Nishi-Azabu 4-chome
Minato-ku, Tokyo 106, Japan
Tel: (03) 499-0041

All other countries

Elsevier Science Publishers, B.V.
Database Marketing Department
Molenwerf 1
1014 AG Amsterdam, The Netherlands
Tel: (020) 5803-507

Excerpta Medica: the most experienced words in the language of medicine



A division of Elsevier Science Publishers

CHILD CARE

A list of child care services is available at the Hospitality/Information Booth. Child care services are not associated with MLA and any use of such service is strictly an agreement between the child care provider and the user.

As such, MLA disclaims any liability for any use of child care services and provides this listing solely as a convenience to participants.

TOURS DESK

A representative from Capricho Special Events will be available at the Tours Desk located at the Registration Center (see Tours Desk for posted hours). Registrants may confirm their advance tour registrations as well as sign up for tours that are available.

MLA EXHIBIT

The MLA Exhibit will be open during registration hours, Sunday through Wednesday, May 22–25. Members from various MLA committees will be available over the lunch hours to discuss Association programs and services. Also, samples of several items available for sale to attendees will be on display, including:

MLA Pin: the official MLA jewelry, this attractive gold and enamel lapel pin can be proudly worn by all MLA members;

MLA Note Pad: these practical 500-sheet pads with the MLA logo are ideal for short messages and notes;

MLA Publications: Viewing copies of all MLA publications will be on display including two new books: *Handbook of Medical Library Practice*, Volume III, Louise Darling, Editor, David Bishop and Lois Ann Colaianni, Associate Editors and *Personal Filing Systems: Creating Information Retrieval Systems on Microcomputers*, written by Sherrie McCarthy.

Items displayed at the MLA Exhibit are available for sale at the Registration Center.

MLA SCHOLARSHIP BOOTH

Help support the MLA scholarship program by purchasing T-shirts, coffee mugs, and other souvenir items from this year's meeting. Mardi Gras-style masks for the President's Reception/Masquerade Party will also be sold at the booth. Cash, checks, Visa, and MasterCard are accepted. The Scholarship Booth is located at the Registration Center and is open during the following hours:

Saturday, May 21	11:00 a.m. - 6:00 p.m.
Sunday, May 22	9:00 a.m. - 4:00 p.m.
Monday, May 23	9:00 a.m. - 4:00 p.m.
Tuesday May 24	9:00 a.m. - 4:00 p.m.
Wednesday, May 25	9:00 a.m. - 4:00 p.m.

WHEN YOU HAVE THE MOST SOUGHT AFTER BIOMEDICAL INFORMATION, HOW DO YOU GET MORE PEOPLE TO USE IT?

By making our online biomedical information easier to use, we've opened the door for more users.

Your users, for instance.

If you work with physicians or researchers in medical, clinical, university, or scientific environments, our new Dialog Medical Connection™ could very well be the research tool that makes your job more far reaching.

Dialog, the world's largest online knowledgebank, is already the choice of the majority of information specialists. Now your users will have direct access to the most sought after information available. How?

With our new professional package, Dialog Medical Connection, you can offer an easy-to-follow menu for new users or a command mode for more experienced searchers.

Now it's easy to have fast access to the major biomedical databases like MEDLINE.

Or BIOSIS PREVIEWS, giving

you world wide coverage of research in the life sciences.

Or NEWSEARCH, one of many general reference databases providing a daily index of articles and book reviews from over 1700 of the most important newspapers, magazines and periodicals.

So it's easy to stay well informed on virtually any topic that's important.

There's no reason not to have instant, simple access to information your users need when they need it.

Call Dialog today and ask about our special incentives for first-time users including \$100 free connect time. 1-800-3-DIALOG. Or write Dialog marketing department, 3460 Hillview Avenue, Palo Alto, CA 94304.

SIMPLE.



D I A L O G
MEDICAL CONNECTION™

Part of the world's largest online knowledgebank.

1-800-3-DIALOG

**Just because we're friendly,
highly trained, fast and efficient,
doesn't mean you should use us...**

or does it?

The fact is...there is no secret to our success. We're fast. We're efficient. We're a fully automated organization that hasn't forgotten the human touch.

Find out why our periodical services are so highly rated.
Call Readmore. 1 (800) 221-3306

READMORE

140 Cedar Street, New York, NY 10006

ACCESS THE FUTURE!

FREE Electronic Ordering over IOD DIRECT!

- TELENET access worldwide 24 hours a day (**FREE** in U.S. and Canada)
- NTIS Reports (depository collection from 1971 on)—**faster and cheaper** from IOD's California retrieval site
- An additional **5% discount** on all items placed/filled over **IOD DIRECT**
- A simple and easy to follow menu-driven system
- Direct entry of orders for either Document Delivery or Research Projects
- Electronic Status Reports available when *you want them!*

Contact:



INFORMATION ON DEMAND, INC.

Marketing Department
P.O. Box 1370
Berkeley, California 94701
(800) 227-0750, in California (415) 644-4500
Associated with the Pergamon Group of Companies

MEETING LOCATIONS

Continuing Education Courses will be held in the Doubletree Hotel and the Sheraton New Orleans Hotel. (See page 9 for schedule.)

Except where noted, Annual Meeting programming will be held in the Sheraton New Orleans Hotel. Please check the program listing for the exact location of each meeting.

Committee Meetings and Informal Meetings, except where noted, will be held in the Sheraton New Orleans Hotel. (See schedule on pages 82 and 84.)

Maps of the Sheraton New Orleans Hotel are located on page 70.

TAPED SESSIONS

Plenary, Contributed Paper, Section, and Business Sessions will be audio taped during the meeting. Cassette tapes may be purchased at the Registration Center during registration hours, where a representative from Teach 'Em, Inc. will be present to assist you. A complete list of available tapes is included in your registration materials.

FILM FESTIVAL 1988

Coordinated by the Health Sciences Audio Visual Section, films will be shown from 1:00 p.m.-2:00 p.m. on Monday, Tuesday, and Wednesday in the Senate Room of the Sheraton New Orleans Hotel. A brief description of the daily topics can be found below. Title listings are included in the registration materials; extra copies are available at the Registration Center.

Monday, May 23

Selected winners from the 1988 Health Sciences Communications Association (HeSCA) Media Festival. Winning entries from the Patient/General, Continuing Education, and Curriculum-Based Education categories plus selected Special Award Winners will be shown.

Tuesday, May 24

Selected programs on topics related to Acquired Immunodeficiency Syndrome (AIDS).

Wednesday, May 25

Selected programs of interest to health and library professionals. Topics covered will include preservation of library materials, communications in the health care setting, ethics, etc.

1988 EXHIBIT

The 1988 Exhibit will include over 85 suppliers to the biomedical information community. The Exhibit offers an opportunity for participants to view the latest in medical books and journals, database services, library equipment and

supplies, and state of the art computer software and hardware, including many CD-ROM products. Attendees are invited to attend the Exhibit Opening Ceremony and coffee break, Monday, May 23 at 10:30 a.m.

The Exhibit is located in the Grand Ballroom and the Rampart Room of the Sheraton New Orleans Hotel. Exhibit hours are:

Monday, May 23	10:30 a.m. - 5:00 p.m.
Tuesday, May 24	10:00 a.m. - 5:00 p.m.
Wednesday, May 25	10:00 a.m. - 5:00 p.m.

Attendees are invited to take a break in the exhibit hall where complimentary refreshments will be served during the following hours:

Monday, May 23 Sponsored by MLA	3:00 p.m. - 3:30 p.m.
Tuesday, May 24 Sponsored by BRS Information Technologies and MEDLINK	10:00 a.m. - 10:30 a.m.
Tuesday, May 24 Sponsored by MLA	4:00 p.m. - 4:30 p.m.
Wednesday, May 25 Sponsored by Login Brothers Book Company	10:30 a.m. - 11:00 a.m.
Wednesday, May 25 Sponsored by MLA	3:30 p.m. - 4:00 p.m.

Louisiana Lotto

When you visit the Exhibits, be sure to complete your Louisiana Lotto card (enclosed with your registration materials) so that you will be eligible to win one of the many prizes offered, including an airline ticket to the 1989 Annual Meeting in Boston, complimentary conference-only registration for the 1989 Annual Meeting, reduced fees for 1989 Annual Meeting Continuing Education Courses, dinners at conference hotels in New Orleans, and special Taste of New Orleans gift packages. Contest rules can be found on the back of the game card.

Exhibitor Demonstrations

Special Exhibitor Demonstrations will take place Monday and Wednesday from 1:00 p.m.-2:00 p.m. Exhibitor Demonstrations are open to all Annual Meeting registrants. For additional information, please refer to the Guide to Exhibits.

LOST AND FOUND

Lost and found items should be turned in to the third floor Registration Center in the Sheraton New Orleans Hotel. Items will be stored in the MLA Office (Southdown Room) when the Registration Center is closed.

*F*iction:
*Sophisticated library software
is hard to use.*

FACT:

The Assistant is sophisticated library automation made easy.

At last, a complete automation software package that's genuinely easy to use. The Assistant is sophisticated enough to meet your every need—and so manageable that little or no training is required. Developed with the small to medium-sized library in mind, The Assistant offers modules to handle:

- Cataloging
- Circulation Control
- Serials Control
- Acquisitions/Accounting
- MARC Interface

Our product is so well-designed you'll wonder how you ever got along

without it. And we stand behind every system with a complete client support package—including daily telephone access, if needed.

The Assistant is not only easy to use, its low price will surprise you. Call today for more facts about sophisticated library automation made easy.

THE 
ASSISTANT

*The Assistant has been approved
as an IBM Value Added Product.*

PSYCIINFO

. . . for access to the serial literature in psychology and related disciplines.

Online

PsycINFO
PsycALERT

CD-ROM

PsycLIT

Print

*Psychological
Abstracts*

Visit PsycINFO at Booth 29

Try PsycLIT

***See the 1988 Thesaurus of Psychological
Index Terms, 5th Edition***

American Psychological Association
1200 Seventeenth Street, NW
Washington, DC 20036

MLA OFFICE

The MLA Office will be located in the Southdown Room of the Sheraton New Orleans Hotel. Messages for Board Members and MLA Staff may be left here. The direct dial phone number when dialing from outside the hotel is 595-5570. If calling from within the Sheraton New Orleans Hotel, call extension 5931.

PLACEMENT SERVICE

The MLA 1988 Placement Service may be used by all Annual Meeting Attendees to list job openings or to register as a job applicant. For employers listing job openings there is a fee of \$25.00 for members or \$50 for non-members. There is no fee for individuals seeking jobs.

Notebooks of job descriptions and a bulletin board listing job openings, as well as notebooks of applicant resumes are available for review at the Placement Service.

Attendees can obtain the necessary forms to list job openings or applicant resumes at the Placement Service desk at the Registration Center during the following hours:

Saturday, May 21	1:00 p.m. - 4:00 p.m.
Sunday, May 22	8:00 a.m. - 12:00 p.m.

The Placement Service will be located in the Poydras room of the Sheraton New Orleans Hotel from 8:00 a.m. to 5:00 p.m. on Monday, Tuesday, and Wednesday.

NEWSLETTER

The 1988 Annual Meeting daily newsletter, *Lagniappe*, will be published from Sunday, May 21 to Wednesday, May 25. Attendees are invited to submit items for publication. Instructions for placing items in the newsletter may be obtained at the Hospitality Desk located at the Registration Center. **Please note: copy for the next day's issue must be submitted to the Hospitality Desk no later than 12 noon the preceding day.**

MESSAGE CENTER

Bulletin boards for all MLA official announcements as well as an Attendee Message Center are located at the Registration Center.

OFFICE EQUIPMENT

The Executive Business Center, located on the third floor of the Sheraton New Orleans Hotel, can provide many different office services, including photocopying, computer and typewriter rental, secretarial services, telefacsimile, pager rental, etc. The Business Center is open from 8:00 a.m.-5:00 p.m. Monday through Friday and 11:00 a.m.-3:00 p.m. on Saturday and Sunday. For services during non-business hours call extension 5361 in the Sheraton New Orleans Hotel (525-2500).

HANDICAPPED ACCESS

All hotels are accessible to handicapped individuals. Please note that the Senate room in the Sheraton Hotel (location of the film festival) is built in tiers. Persons in wheel chairs may enter the room from the lower level. Also, the lobby of the Monteleone hotel has a few small steps. A ramp is available from the hotel assistant manager.

Persons requiring special assistance should notify staff in the MLA Office (Southdown).

SAFETY TIPS

To fully enjoy your stay in New Orleans, follow some of the "common sense" safety tips listed below:

- Remember that you are a visitor to the city. Try not to travel in unknown, unpopulated areas.
- Do not wear your registration badge outside the convention hotels. It signals that you are a visitor.
- Handbags should be carried securely; wallets should be carried in inside jacket pockets.
- Do not carry excess cash. All of the conference hotels provide a limited number of safety deposit boxes. Use them for storing extra cash, jewelry, airline tickets, and any other valuables.

Emergencies

If an emergency situation occurs while in a hotel, dial O for the hotel operator. State your location and outline the emergency help needed. If you are outside and a medical, fire, or police emergency occurs, dial 911 for assistance.

Fire Precautions

All conference hotel facilities meet with local fire regulations. However, in order to be best prepared in case of a fire emergency, please keep a few things in mind.

When first entering your room, familiarize yourself with emergency exits located on the floor. Count the number of doorways from your room to the fire exit. Keep your key in the same place whenever you are in the room.

In the event of a fire in your room, get out, close the door behind you, get to safety, and immediately report the fire. If the fire is not located in your room, check to see if the door is hot before leaving. If the door is cool, take your key, open the door slowly, and proceed to the nearest exit (crawling if the hall is filled with heavy smoke). Do *not* use elevators. If your door is hot, do *not* exit room. Seal the cracks with wet towels, phone for help, and wait.

1989 ANNUAL MEETING

The 89th Annual Meeting of the Medical Library Association will be held in Boston, Massachusetts, May 19-25, 1989. The Preliminary Program will be distributed to all members in January.

Information on the 1989 Call for Contributed Papers, Demonstrations, and Posters is included with your registration materials. Additional copies are available at the Registration Center.

AMA/NET Lets You Offer More

Today on-line information means more than just medical literature. AMA/NET lets you offer clinical information services in your library such as diagnostic assistance and drug interaction information, plus many physician-oriented services that you will not find anywhere else.

PROFESSIONAL PROGRAMS

- **MEDICOM® Drug Interaction Database** – The only on-line, generic ingredient-based drug interaction database. From Professional Drug Systems, Inc.
- **DXplain™** – A new medical resource to expand the physician's diagnostic considerations. From the Massachusetts General Hospital (MGH).
- **MGH-CME** – Interactive, self-paced programs for Category I credit.

LITERATURE SEARCHES

- **EMPIRES Key Clinical Literature**
- **PaperChase**
- **Social and Economic Aspects of Medicine (SEAM)**
- **Disease Information**

MEDICAL NEWS AND PUBLIC INFORMATION

- **Associated Press Medical News Service**
 - **AMA Washington Report**
 - **Public Information Services**
Sources include:
CDC, the Surgeon General and NLM/NIH
- and **ELECTRONIC COMMUNICATIONS**

**Visit us at booth 101
Call 1-800-426-2873
for demo disk or more
information.**

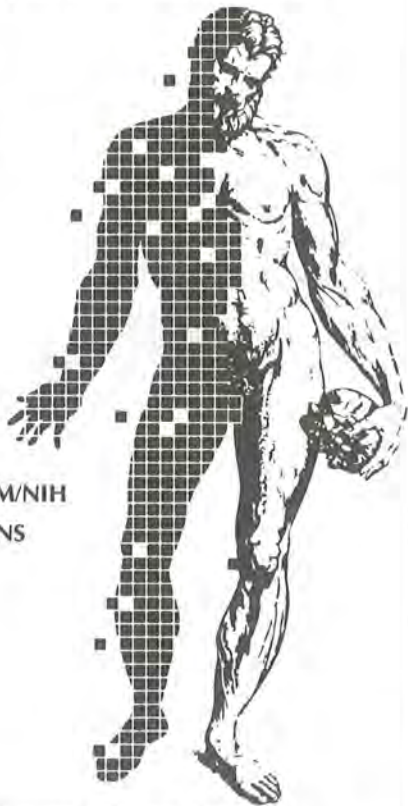

Sponsored by the American Medical Association.

AMA/NET is a service of SoftSearch, Inc. and American Medical Computing, Ltd., a subsidiary of the AMA.

resource \rē-sō(s)r, l a : a source of supply or support
: an available means **b** : a natural source of wealth or revenue
c : a source of information or expertise **2** : an ability to meet
and handle a situation

In today's progressive health care environment, being on the "leading edge" means having access to accurate, timely information for making sound, responsive decisions.

Yet, finding specific health care management information when you need it can be a major challenge confronting health care professionals.

The solution:

The AHA Resource Center

The AHA Resource Center provides easy access to these invaluable services and products:

- comprehensive health care literature collections
- information and data retrieval services
- the *Hospital Literature Index*
- the Health Planning and Administration database
- document delivery services
- factual information and referral services

The AHA Resource Center keeps you informed and up-to-date on the latest trends and practices, statistical data, and legislative and regulatory events in the field.

Our highly trained professional staff can help you determine the library resources that will help you most in your patient care, administrative, educational, or research-oriented activities.

Call us toll-free at 800/621-6712, x6263 (In Illinois, call 800/572-6850, x6263)

AHA Resource Center
840 North Lake Shore Drive
Chicago, Illinois 60611
312.280.6263

American Hospital Association



Consumer Health & Nutrition Index

Edited by Alan M. Rees

Popular general interest magazines now included. Annual cumulations available with subscription at no extra charge!

Visit the Oryx Press Booth #45 and pick up your free copy of *Consumer Health & Nutrition Index*. Editor Alan M. Rees will be available Monday, May 23 and Tuesday, May 24 to answer questions.



REFERENCE LEADERSHIP FROM:

THE ORYX PRESS

2214 North Central at Encanto
Phoenix, Arizona 85004-1483

Order Toll-Free: 1-800-457-ORYX*

*In Arizona, Alaska, and Hawaii, call (602) 254-6156

THE RESOURCE AUTHORITIES.



Journals of Science, Technology, and Medicine, in microform, from one source.

Guaranteed availability, when you want them. Research Publications has taken journals in microform a giant step forward — every title filmed and delivered when your patrons need them. All current and backfile volumes are filmed in their entirety from the first issue forward.

The point is, you get them without ordering and then having to wait, and wait, and wait. . . . Research specialists, engineers, chemists, doctors, and the general public can access entire years of journals in microform. Your paper issues can continue to circulate. And it's all cost-efficient from your first subscription on. One purchase order, one invoice, and your current microform subscriptions will be fulfilled within three months of the end of the volume year.

For further information, use the form below. Or call 1-800-REACH-RP (1-800-732-2477) now. From Connecticut, Alaska and Canada, call collect (203) 397-2600.

Please send me information on other RP products and services checked:

- American Medical Periodicals 1797-1900
- U.S. and International Patent Documentation
- Patent Search and Awareness Services
- International Newspapers on Microfilm
- Newspaper Indexes
- Television News Transcripts and Indexes
- Research Collections in Microform
- Reference Books

ip infofile #15

research publications®

12 Lunar Drive/Drawer AB
Woodbridge, CT 06525
Toll-free: 1-800-REACH-RP
TWX: 710-465-6345
FAX: 203-397-3893

- Please send me your catalog of Journals in Microform
- Have a representative call me

Name _____ Title _____
 Institution _____
 Address _____
 City _____ State _____ Zip Code _____
 Phone _____

For further information, or to place your order directly, call 1-800-REACH-RP (1-800-732-2477).

1-800-REACH-RP

On display at booth 104, *MLA Annual Meeting*

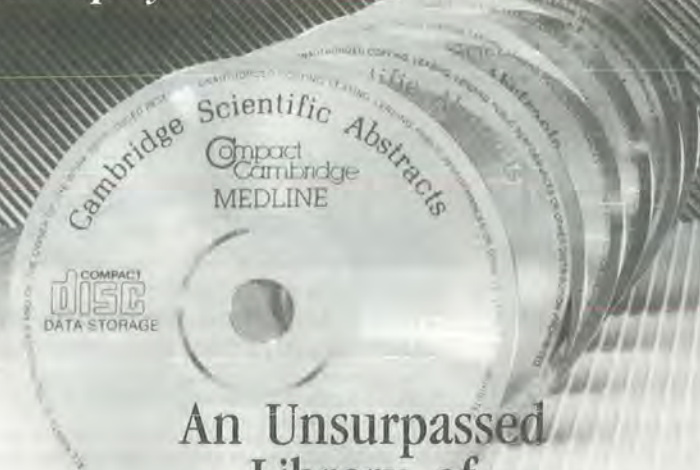

An Unsurpassed Library of CD-ROM Databases.

*An Unbeatable
30-day free trial
offer.
All from Compact
Cambridge!*

Compact Cambridge invites you to sample its line of five vital databases for 30 days at no cost and with no risk!

After 30 days, if you are not fully satisfied that these outstanding databases belong in your facility, simply return the CD's and that's it. No strings. No hassles.

Three Compact Cambridge databases are now available:

Medline

Produced under license from the U.S. National Library of Medicine, Compact Cambridge MEDLINE offers complete coverage of the foremost database in the medical field. Strongly recommended by the Journal of the American Medical Association.

Life Sciences Collection

Exclusively from Compact Cambridge, this database brings together reports in 18 subject categories relating to the life sciences...including the first in-depth coverage of AIDS research available on CD!

PDQ/Physicians Data Query

Produced by the U.S. National Cancer Institute, PDQ provides easy access to state-of-the-art cancer therapy and research.

And two more important databases are coming this summer and fall:

Cancerlit (Cancer Literature)

Prepared by the National Cancer Institute, CANCERLIT gives quick, computerized access to published cancer literature from more than 3,000 biomedical journals. A superb resource for clinicians and researchers.

Drugs Database

The American Society of Hospital Pharmacists produces this detailed database describing virtually every single-drug entity available in the United States.

There's simply no better CD-ROM database library available! To start your no-risk 30-day trial of any Compact Cambridge database, call TOLL FREE today: 1-800-843-7751.

Cambridge Scientific Abstracts

A division of Cambridge Information Group

7200 Wisconsin Avenue
Bethesda, MD 20814 U.S.A.
Tel: (301) 961-6757
Fax: (301) 961-6720

**Medical Library Association
88th Annual Meeting
New Orleans, Louisiana**

The Daily Program

All events in this program are held at the Sheraton New Orleans Hotel unless otherwise noted, and will begin and end promptly.

WEDNESDAY, May 18

8:00 a.m. - 5:00 p.m.

**BOARD OF DIRECTORS MEETING
Bayside A**

THURSDAY, May 19

8:00 a.m. - 5:00 p.m.

**BOARD OF DIRECTORS MEETING
Bayside A**

4:00 p.m. - 8:00 p.m.

**REGISTRATION
Pontchartrain Ballroom Foyer**

FRIDAY, May 20

7:00 a.m. - 8:30 a.m.

**REGISTRATION
Pontchartrain Ballroom Foyer**

8:00 a.m. - 5:00 p.m.

**BOARD OF DIRECTORS MEETING
Bayside A**

8:30 a.m. - 5:00 p.m.

CONTINUING EDUCATION COURSES

4:00 p.m. - 8:00 p.m.

**REGISTRATION
Pontchartrain Ballroom Foyer**

SATURDAY, May 21

7:00 a.m. - 6:00 p.m.

REGISTRATION
Pontchartrain Ballroom Foyer

8:00 a.m. - 5:00 p.m.

COMMITTEE MEETINGS
(See schedule on page 82)

8:30 a.m. - 5:00 p.m.

CONTINUING EDUCATION COURSES

1:00 p.m. - 4:00 p.m.

**ADMINISTRATIVE SERVICES FOR
PLACEMENT SERVICE**
Pontchartrain Ballroom Foyer

5:00 p.m. - 7:00 p.m.

CHAPTER COUNCIL MEETING
Bonnie Burn

5:00 p.m. - 7:00 p.m.

SECTION COUNCIL MEETING
Oakley

SUNDAY, May 22

7:00 a.m. - 4:00 p.m.	REGISTRATION Pontchartrain Ballroom Foyer
8:00 a.m. - 12:00 p.m.	ADMINISTRATIVE SERVICES FOR PLACEMENT SERVICE Pontchartrain Ballroom Foyer
8:00 a.m. - 12:00 p.m.	CHAPTER COUNCIL MEETING Bayside A
8:00 a.m. - 12:00 p.m.	SECTION COUNCIL MEETING Bayside B
8:00 a.m. - 12:00 p.m.	COMMITTEE MEETINGS (See schedule on page 82)
8:30 a.m. - 12:30 p.m.	CONTINUING EDUCATION COURSES
10:00 a.m. - 11:00 a.m.	MODERATOR ORIENTATION Gallier House
11:00 a.m. - 1:00 p.m.	INCOMING CHAIRMEN'S LUNCHEON St. Charles
1:00 p.m. - 2:00 p.m.	OPENING SESSION Pontchartrain Ballroom

Welcome

Carolyn E. Lipscomb, Associate Chairman, 1988 National Program Committee, University of North Carolina at Chapel Hill, Chapel Hill, North Carolina
William D. Postell, Co-Chairman, Local Assistance Committee, Tulane University School of Medicine, New Orleans, Louisiana

Distinguished Public Service Award

Honorable Claude D. Pepper, U.S. House of Representatives, Washington, D.C.

Presenting the Award:

Holly Shipp Buchanan, President, Medical Library Association; Director, Corporate Information Resources, NKC Hospitals, Louisville, Kentucky

Accepting the Award for Mr. Pepper:

C. Lindy Boggs, U.S. House of Representatives, Louisiana

Introducing Ms. Boggs:

Frances Humphrey Howard, Special Assistant to the Associate Director of Extramural Programs, National Library of Medicine, Bethesda, Maryland

2:00 p.m. - 3:00 p.m.

**JOHN P. MCGOVERN AWARD LECTURE
KEYNOTE ADDRESS
Pontchartrain Ballroom**

Richard A. Lyders, Moderator, Director, Houston Academy of Medicine-Texas Medical Center Library, Houston, Texas

Access to Intellectual Property: The Foundation of Biomedical Communication Systems for the 21st Century

Robert Wedgeworth, Dean, School of Library Service, Columbia University, New York, New York

The tenth anniversary of the new copyright law is an appropriate occasion to review the contributions of the medical library community to broadening access to the work of researchers and scholars and the implications of access questions for future biomedical communications systems.

3:00 p.m. - 3:30 p.m.

BREAK

3:30 p.m. - 6:00 p.m.

**SECTION AND COMMITTEE-SPONSORED
PROGRAMS
SECTION BUSINESS MEETINGS**

Programs are scheduled from 3:30 to 5:00 p.m. with Section business meetings immediately following the program sessions.

**CONSUMER AND PATIENT HEALTH INFORMATION
Aurora**

Dealing with the Tough Questions: Compassionately and Professionally
Jodith Janes, Moderator, Clinical Librarian University Hospitals of Cleveland, Cleveland, Ohio

Three panelists will describe how they train their staff to answer the difficult questions posed by consumers searching for health information concerning their own or a loved one's health care. Suggestions and recommendations for responding in a compassionate and professional manner to the practical, ethical, and personal challenges posed by consumers' queries will be offered.

Rya Ben-Shir, Manager, Health Sciences Resource Center, MacNeil Hospital, Berwyn, Illinois
Tracey Cosgrove, Planetree Health Resource Center, San Francisco, California
Kathy Tappana, Head, Collection Development, McGoogan Library of Medicine, University of Nebraska Medical Center, Omaha, Nebraska (Formerly Health Information Librarian, Tulsa City-County Public Library, Health Information, Tulsa, Oklahoma)

NURSING AND ALLIED HEALTH RESOURCES**Bayside****The Future of Information Access Systems for Nursing and Allied Health**

Margaret Allen, Moderator, Librarian, Saint Joseph's Hospital School of Nursing, Marshfield, Wisconsin

What changes are occurring that will improve access to the nursing and allied health literature? Following an analysis of the information access concerns of nursing and allied health professionals, speakers will review the databases and print indexes generated by CINAHL, MEDLARS, and the Institute for Scientific Information in relation to their relevance to nursing and allied health. How is each responding to the needs of these disciplines? Nursing and Allied Health Resources Section members have submitted questions and concerns for the panel members to address in their papers.

Health Information Issues: Planning for the Future

Elaine Graham, Associate Director, PSRMLS, Louise Darling Biomedical Library, University of California, Los Angeles, Los Angeles, California

CINAHL and the Future for Nursing Information Resources

Carolyn Fishel, CINAHL Consultant and Director of Health Sciences Library, Glendale Adventist Medical Center, Glendale, California

Meeting the Needs of Nursing and Allied Health Professionals: The National Library of Medicine's Role

Jane Bryant, Librarian, MEDLARS Management Section, National Library of Medicine, Bethesda, Maryland

Citation Indexing Access to Nursing Resources

Judith E. Schaeffer, ASCATOPICS Coordinator, Institute for Scientific Information, Philadelphia, Pennsylvania

OSTEOPATHIC LIBRARIES**Felicity****Indexing and Abstracting of Special Medical Literature**

Ursula Stevenson, Moderator, Director, Medical Library, College of Osteopathic Medicine of the Pacific, Pomona, California

The first speaker will trace the history and development of the Chiropractic Research Archives Collection, begun in 1983 by the Canadian Memorial Chiropractic College to gain control over the vast literature in the field of manipulative medicine, chiropractic and osteopathic, as well as related medical sciences literature not indexed elsewhere. The second speaker will provide an update on the Osteopathic Literature Index/Outline, a comprehensive automated index to osteopathic literature initiated in 1983 specifically to meet the information needs of the osteopathic community.

The Chiropractic Research Archives Collection (CRAC)

Marilyn Schafer, Director of Library Services, Canadian Memorial Chiropractic College, Toronto, Canada

The Osteopathic Literature Index/Online (OLIO)

Mary Moules, Associate Editor, Special Projects, American Osteopathic Association, Chicago, Illinois

RESEARCH LIBRARIES

Monteleone: Iberville

Images of Viruses, Genes, and Libraries

Patricia J. Erwin, Moderator, Mayo Medical Library, Rochester, Minnesota

Genetic engineering and molecular cloning techniques have offered us a view of genes and evolution never before possible. Powerful techniques of modern molecular biology are being used to identify, to characterize, and then to manipulate genes and gene products. Specially prepared nucleic acid samples are examined with the extraordinary resolving power of the electron microscope to demonstrate the advantages and the pitfalls of the new biology. Displayed are the possibilities from conquering diseases to the broad promise of biotechnology with its ability to harness the biosynthetic capacities of cells and cell systems. Dr. Garon will illustrate, with his electron micrographs, interesting parallels between genes and libraries in their need for efficient storage and rapid retrieval of information.

Claude F. Garon, Ph.D., Researcher, Microbiology and Virology, NIH, Institute for Allergy and Infectious Diseases, Electron Microscopy Section, Hamilton, Montana

TECHNICAL SERVICES

Monteleone: Queen Anne

NLM Technical Services Update and TSS Strategic Planning Discussion

Carmel Corriveau Bush, Moderator, Assistant Director, Technical Services, Health Science Center, University of Texas Health Science Center at Dallas, Dallas, Texas

Duane Arenales gives the annual update of NLM activities of interest to technical services librarians. Her talk is followed by an update on the projects undertaken in cooperation with NLM by the Technical Services Section's Ad Hoc Cataloging Advisory Committee. The program is completed with an open discussion of the Technical Services Section's strategic plan that provides an opportunity for all to shape the Section's future roles and activities.

Technical Services Update from NLM

Duane Arenales, Chief, Technical Services Division, National Library of Medicine, Bethesda, Maryland

TSS Working With NLM: Update of the Activities of the Ad Hoc Cataloging Advisory Committee

Barbara G. Smith, Assistant Director, Technical Services, Health Sciences Library, University of Maryland at Baltimore, Baltimore, Maryland

TSS Strategic Planning Discussion

Carmel Corriveau Bush, Assistant Director, Technical Services, University of Texas Health Science Center at Dallas, Dallas, Texas

**HEALTH SCIENCES AUDIOVISUAL (Contributed Papers Session)
Monteleone: La Nouvelle Orleans West****From Audiovisuals to Educational and Information Technologies: The Changing Scope of Media Librarianship**

Jim Curtis, Moderator, Media Services Librarian, Augustus C. Long Health Sciences Library, Columbia University, New York, New York

3:35 p.m.: Of Modems and Men: Increasing Access to Information

Mary Joan Tooley, Head, Information Management Education Department, University of Maryland at Baltimore, Baltimore, Maryland

3:52 p.m.: Coordination of Audiovisual Equipment in a Large Medical Center

Diane G. Wolf, Medical Librarian, Wilmington Hospital Library, Medical Center of Delaware, Wilmington, Delaware

4:09 p.m.: Automated Media Booking Systems: An Overview of Current Practice

Janet Wilson Reit, Media Librarian, Charles A. Dana Medical Library, University of Vermont, Burlington, Vermont

4:26 p.m.: Staff Support for Public Access Computing: The Role of a Computer Education Specialist

Gale G. Hannigan, Manager, Medical Library Services, The UpJohn Company, Kalamazoo, Michigan

4:43 p.m.: Audiovisual Resource Sharing in Medical School Libraries: A Status Report

Daniel T. Richards, Assistant Health Sciences Librarian for Resources and References Services, Augustus C. Long Health Sciences Library, Columbia University, New York, New York

**MEDICAL SCHOOL LIBRARIES AND LIBRARY RESEARCH
(Joint Program) (Contributed Papers Session)
Monteleone: La Nouvelle Orleans East**

Library Research business meeting will take place in the Bonnet Carre Room.

Unanswered Questions: Evaluation—Environment—Emerging Issues

Nancy N. Woelfl, Ph.D., Moderator, Director, McGoogan Library of Medicine, University of Nebraska Medical Center, Omaha, Nebraska

3:35 p.m.: Scientific Fraud: A Case Study

Mary King Givens and Susan A. Selig, Health Science Library, University of Tennessee, Memphis, Tennessee

3:52 p.m.: Determining Effective Promotional Strategies for Introducing Medical Literature Databases to Primary Care Physicians

Karen Hackleman, University of Maryland at Baltimore, Baltimore, Maryland; Robert E. Kristofco, West Virginia University, Morgantown, West Virginia; and Chris Olson, Chris Olson and Associates, Baltimore, Maryland

4:09 p.m.: Evaluating Online Biomedical Databases for End Users: BACS/Current Contents and BACS/MEDLINE

Susan Crawford, Ph.D., Elizabeth Kelly, and Linda Salisbury, Washington University School of Medicine Library, St. Louis, Missouri

4:26 p.m.: Academic Health Sciences Librarians and Faculty Status

Leslee C. Sumner, Health Sciences Library, University of North Carolina at Chapel Hill, Chapel Hill, North Carolina

4:43 p.m.: Libraries Without Walls: Blueprint for a Canadian Future

M.A. Flower, The Information Corner: Health Sciences Library Services, Terrace House, Cartwright Point, Kingston, Ontario

5:00 p.m. - 6:00 p.m.

**ORIENTATION FOR NEW MEMBERS, INTERNATIONAL VISITORS, AND FIRST-TIME ATTENDEES
St. Charles B**

New members, first-time annual meeting attendees, and international visitors are invited to attend this special reception.

6:00 p.m. - 8:00 p.m.

**WELCOME RECEPTION
Pontchartrain Ballroom**

Sponsored by: EBSCO Subscription Services

MONDAY, May 23

As information professionals, we need to be alert to the new technologies and improved products and services which can help us and our institutions be efficient and effective.

Be sure to include the MLA Exhibit as part of your MLA '88 experience. We suggest that you allocate four to six hours for viewing the exhibits over the next three days. This will insure ample time to visit all of the companies featuring the most up to date products and services available to the library community.

8:00 a.m. - 4:00 p.m.

REGISTRATION
Pontchartrain Ballroom Foyer

7:00 a.m. - 9:00 a.m.

COMMITTEE AND INFORMAL MEETINGS
(Please see schedule on pages 82 and 84)

8:00 a.m. - 5:00 p.m.

PLACEMENT SERVICE
Poydras

9:00 a.m. - 10:30 a.m.

PLENARY SESSION I: Strategic Management of Libraries: Stewardship Versus Competitive Strategy
Pontchartrain Ballroom

Fred W. Roper, Ph.D., Moderator, Dean, College of Library and Information Science, University of South Carolina, Columbia, South Carolina

Strategic Management: Knowledge as a National Resource

Nina Matheson, Director, Welch Library, The Johns Hopkins University, Baltimore, Maryland

Strategic Management: Contention for Resources

Donald Marchand, Ph.D., Dean, School of Information Studies, Syracuse University, Syracuse, New York

Towards Reconciling the Views

Reactor: Patricia Battin, President, Commission on Preservation and Access, Council on Library Resources, Washington, D.C.

The presenters will debate the economic and intellectual value of information in terms of the strategic management of libraries. Strategic management places value on performance and measurable contributions towards advancing the organization's mission and goals. Each component of an organization must contend for its share of resources on these terms. Are these values diluting and undermining the traditional values of the library profession? The library profession holds that information is above all a public good, a resource self-evidently fundamental to any productive organization, academic center, or government. Libraries are the stewards of society's knowledge and must be

supported to carry out this role. Can these two points of view be reconciled? Is there a middle ground?

Sponsor: Faxon Company, Medical Information Services Division.

10:30 a.m. - 11:00 a.m.

EXHIBIT OPENING CEREMONY
Grand Ballroom

11:00 a.m. - 12:30 p.m.

BUSINESS SESSION I
Pontchartrain Ballroom

Presiding: Holly Shipp Buchanan, President, Medical Library Association; Director, Corporate Information Resources, NKC Hospitals, Inc., Louisville, Kentucky

Announcements and Introduction

Call to order by Holly Shipp Buchanan

Numbers in parentheses following each report refer to pages in the 1987/88 Annual Report.

Report of the Finance Committee

Sherrilynne S. Fuller, Ph.D., Chairman (4)

Reports of Appointed Officers

- *Bulletin of the Medical Library Association* (31)
Susan Crawford, Ph.D., Editor, *Bulletin of the Medical Library Association*
- *MLA News* (34)
Nancy Fabrizio, Editor, *MLA News*

Reports of Administrative Committees

- Committees of the Board
 - Committee on Committees (35)
 - Elections Committee (40)
 - Nominating Committee (42)
 - Eloise C. Foster, Chairman
- Bylaws Committee (44)
Lucretia McClure, Chairman
Sherrilynne S. Fuller, Ph.D., Board Liaison
- Exchange Committee (48)
Kay E. Wellick, Chairman
Jacqueline D. Bastille, Board Liaison
- Membership Committee (49)
Cathryn E. White, Chairman
Rosanne Labree, Board Liaison

Information Issues and Policy

- Governmental Relations Committee (52)
Valerie Florance, Chairman
Audrey Powderly Newcomer, Board Liaison
- International Cooperation Committee (62)
Marion Holena Levine, Chairman
J. Michael Homan, Board Liaison
- Publishing and Information Industries Relations Committee (67)
Penny Coppernoll-Blach, Chairman
J. Michael Homan, Board Liaison
- Status and Economic Interests of Health Sciences
Library Personnel Committee (70)
Diane G. Schwartz, Chairman
J. Michael Homan, Board Liaison

Professional Development

- Credentialling Committee (74)
Kathryn J. Hoffman, Chairman
Fred W. Roper, Ph.D., Board Liaison
- Continuing Education Committee (71)
Frances A. Bischoff, Chairman
Fred W. Roper, Ph.D., Board Liaison
- Editorial Panel for Certification and Registration Examination (92)
Rick B. Forsman, Editor
Fred W. Roper, Ph.D., Board Liaison
- Health Sciences Library Technicians Committee (94)
Susan C. Speer, Chairman
Jacqueline D. Bastille, Board Liaison

Meeting Coordination

- 1988 National Program Committee (95)
Mary M. Horres, Chairman
Holly Shipp Buchanan, Board Liaison
- 1989 National Program Committee (97)
Irwin H. Pizer, Chairman
Eloise C. Foster, Board Liaison
- 1990 National Program Committee
Robert Braude, Chairman
Frances Groen, Board Liaison
- Program and Convention Committee (99)
Jeanette C. McCray, Chairman
Jacqueline D. Bastille, Board Liaison

Honors and Awards Coordination

- Awards Committee (100)
Betsy L. Humphreys, Chairman
Mickey Cook, Board Liaison
- Grants and Scholarship Committee (101)
Judith A. Overmier, Ph.D., Chairman
Mickey Cook, Board Liaison
- Joseph Leiter NLM/MLA Lectureship Committee (104)
Lois Ann Colaianni, Chairman
Jacqueline D. Bastille, Board Liaison

Communications

- *Bulletin* Consulting Editors Panel (31)
Susan Crawford, Ph.D., Chairman
Gail Yokote, Board Liaison
- Editorial Committee for the *Bulletin* (105)
Cynthia H. Goldstein, Chairman
Gail Yokote, Board Liaison
- Editorial Committee for the *MLA News* (106)
Denis Gaffney, Chairman
Gail Yokote, Board Liaison
- Oral History Committee (107)
Suzanne Grefsheim, Chairman
Richard A. Lyders, Board Liaison
- Publication Panel (109)
Pat L. Walter, Chairman
Richard A. Lyders, Board Liaison

Report of Councils

- Chapter Council (123)
Rosanne Labree, Chairman
- Section Council (127)
Audrey Powderly Newcomer, Chairman

Note: MLA Representatives' Reports appear as part of their respective Standing Committee's Annual Reports.

Announcement of Election Results

Bylaws Introduction

Darel J. Robb, Parliamentarian
Lucretia McClure, Chairman, Bylaws Committee

Old Business

New Business

12:30 p.m. - 2:00 p.m.

LUNCH —

SUSAN BARNES

1:00 p.m. - 2:00 p.m.

FILM FESTIVAL
Senate

Selected winners from the 1988 Health Sciences Communications Association (HeSCA) Media Festival. Winning entries from the Patient/General, Continuing Education, and Curriculum-Based Education categories plus selected Special Award Winners. Title listings available at Registration.

1:00 p.m. - 2:00 p.m.

EXHIBITOR DEMONSTRATIONS
(Please refer to Guide to Exhibits for further information)

2:00 p.m. - 3:00 p.m.

NATIONAL LIBRARY OF MEDICINE SESSION
Pontchartrain Ballroom

The National Library of Medicine: A Year After the Long Range Plan
Donald A.B. Lindberg, M.D., Director, National Library of Medicine, Bethesda, Maryland

Update on Library Operations

Lois Ann Colaianni, Associate Director, Library Operations, National Library of Medicine, Bethesda, Maryland

3:00 p.m. - 3:30 p.m.

EXHIBIT BREAK
Grand Ballroom

Sponsor: The Medical Library Association

3:30 p.m. - 6:00 p.m.

SECTION AND COMMITTEE-SPONSORED
PROGRAMS
SECTION BUSINESS MEETINGS

Programs are scheduled from 3:30 p.m. to 5:00 p.m. with Section business meetings immediately following the program sessions.

CANCER LIBRARIANS
Monteleone Hotel: Iberville

Cancer Databases

Jeanne Becker, Moderator, Memorial Sloan-Kettering Cancer Center, New York, New York

Speakers will provide updated information on cancer databases. The principal emphasis of the first presentation is on enhancements, modifications, and plans for PDQ, the NCI's multi-faceted database of cancer treatment information,

although other NCI databases will be briefly mentioned. Major changes during the past two years will be reviewed, including expansion of PDQ to include several additional types of information, internal restructuring of the information, addition of powerful new capabilities and options for information retrieval and display, expansion of accessibility through the NLM and commercial online vendors, and improved user aids. The new PDQ ACCESS software will be highlighted. The second presentation features CANCER-CD, which combines three unique databases—EMBASE, CANCERLIT, and YEARBOOK OF CANCER,—on one CD-ROM. CANCER-CD enables comprehensive searching of basic sciences cancer and AIDS research, cancer conference proceedings, Cancergrams, and clinical cancer research. Search strategies, SilverPlatter software functionality, and various work station administrative issues will be discussed.

The National Cancer Institute's Databases: An Update

Dianne E. Tingley, Ph.D., Chief, International Cancer Research Data Bank Branch, International Cancer Information Center, National Cancer Institute, Bethesda, Maryland

Searching CANCER-CD: A Unique User-Friendly Database on CD-ROM

Elaine C. Alligood, Manager, North American Database Department, Elsevier Science Publishers, New York, New York

COLLECTION DEVELOPMENT, TECHNICAL SERVICES, PUBLISHING AND INFORMATION INDUSTRIES RELATIONS COMMITTEE (Joint Program) Bayside

Only the Collection Development business meeting will follow this program.

Economic Impact of the New Publishing Technologies

Jacqueline Wilson, Moderator, Collection Development/Education Officer, The Library, University of California, San Francisco, San Francisco, California

The program will include three speakers, one each from a publisher, a vendor, and a medical library. These speakers will present three different perspectives on the economic impact of new publishing technologies on library activities. Examples of new forms of publishing being addressed will include CD-ROM, online full text, and computer software. Presenters will be approaching the topic from a collection development and technical services perspective, rather than a reference or public services perspective. A question and answer session will follow the formal presentations.

A Publisher's Perspective

Jane Kelly, Director of Electronic Products and Services, Cambridge Scientific Abstracts, Bethesda, Maryland

A Vendor's Perspective

Jeanne L. Spala, Administrative Manager, EBSCO Electronic Information, Torrance, California

A Librarian's Perspective

David Morse, Associate Director for Collection Resources, Norris Medical Library, University of Southern California, Los Angeles, California

FEDERAL MEDICAL LIBRARIES

Monteleone Hotel: Skylite

V. Lynn Gera, Moderator, Director, Information Resources Center/Library, and Consultant, Library Program, U.S. Army Medical Research and Development Command, Walter Reed Army Institute of Research, Washington, D.C.

Computers Working for You

Mary Lou Himes Burton, Chief, Library Services, Resource Librarian, Automation Consultant, Veterans Administration Medical Center, Coatesville, Pennsylvania

INTERNATIONAL COOPERATION COMMITTEE

Monteleone: Queen Anne

AIDS and the Human Immunodeficiency Virus: A Global Threat**AIDS: An Introduction**

Julie Johnson McGowan, Moderator, Associate Director, School of Medicine Library, University of South Carolina, Columbia, South Carolina

Following a brief introduction by Ms. McGowan which alludes to some deadly parallels between the spread of AIDS and the "Black Death" of the Middle Ages, Dr. Robbins will address the international medical and sociopolitical ramifications of the spread of AIDS and the HIV based on the history of polio, smallpox, and other infectious diseases. Dr. Cohen will then discuss the clinical picture of AIDS, including diagnosis, testing, and prognosis. He will also speak on the need for rapid dissemination of information about both the syndrome and the infection, and the informational sources that exist today.

Ms. Compton will conclude with a presentation on the demographics of AIDS, both as it exists today and as it threatens generations of tomorrow. She will also suggest the significance of this global disease in relation to the influence it will exert on the information professional. A panel discussion with audience participation will follow the formal program.

The Historical Perspective on the AIDS Pandemic

Frederick C. Robbins, M.D., Nobel Laureate, Dean Emeritus, School of Medicine, and University Professor, Case Western Reserve University, Cleveland, Ohio

Clinical Aspects and Ramifications of the Human Immunodeficiency Virus: Information Modalities

Philip T. Cohen, M.D., Ph.D., Associate Clinical Professor, School of Medicine, University of California, San Francisco, and Editor, AIDS Knowledge Base, San Francisco, California

The Demographic Implications of AIDS for the Information Industry: A Global View

Anne W. Compton, Associate Director, Population Information Program, The Johns Hopkins University, Baltimore, Maryland

Sponsors: BRS Information Technologies, Electronic Distributors of the AIDS Knowledge Base; The Faxon Company, Medical Division; Alfred Jaeger, Inc., Periodicals/Back Volumes; Population Information Program, The Johns Hopkins University.

**MEDICAL LIBRARY EDUCATION
St. Charles B****Education for New Roles in the Nineties**

Alan M. Rees, Moderator, Visiting Professor, School of Information Science and Policy, State University of New York, Albany, New York

A change in the traditional library paradigm is in progress as libraries move from information collection and transfer to information management and use. Library staff will increasingly serve as information resources managers in medical centers and hospitals. However, if the library is to be pivotal in the emerging, integrated information networks, it will be necessary to assemble a team of library-based professionals who can effectively participate in medical education, artificial intelligence research, expert systems, and computing, and who possess the skills to develop and apply information management techniques. The speakers will review this changing environment and the progress being made in implementing the IAIMS concept and will outline the educational programs required to provide the knowledge necessary to develop and manage technologically advanced health sciences libraries and information resources management networks.

New Roles for Health Sciences Librarians in a Changing Environment

Naomi Broering, Director, Dahlgren Memorial Library, Georgetown University Medical Center, Washington, D.C.

Education and Training of Health Sciences Librarians: Current Programs

Ellen Gay Detlefsen, Associate Professor, Graduate School of Information Science, University of Pittsburgh, Pittsburgh, Pennsylvania

Education and Training of Health Sciences Librarians: A Blueprint for the Nineties

Alan M. Rees, Visiting Professor, School of Information Science and Policy, State University of New York, Albany, New York

**PUBLIC HEALTH/HEALTH ADMINISTRATION, RELEVANT ISSUES,
GOVERNMENTAL RELATIONS COMMITTEE (Joint Program)
Aurora**

Public Health/Health Administration business meeting will take place in the Aurora Room; Relevant Issues business meeting will take place in the Bonnie Burn Room; Governmental Relations Committee will meet in the Felicity Room.

Health Policy Agenda: Private and Public Cooperation

Suzanne Paul, Moderator, Director, Ciocco Library Graduate School of Public Health, University of Pittsburgh, Pittsburgh, Pennsylvania

The Health Policy Agenda was initiated in 1982 by the American Medical Association to bring together the public and private sectors to prepare a framework for the future of United States Health Policy. Participants are making efforts to communicate the concepts of the project to all persons working in the health care field. Basic health benefits, extension and uniformity of Medicaid, and cost effective payments systems are some of the major focus issues. The speakers, representing different constituencies, will discuss the health care crisis from their vantage points. Audience participation will follow the formal presentations.

C. Lindy Boggs, Member, U.S. House of Representatives, Louisiana; Member, House Appropriations Committee, Washington, D.C.

Linda Diamond, Director of the Health Policy Agenda, American Medical Association, Chicago, Illinois

**VETERINARY MEDICAL LIBRARIES
St. Charles A**

The Importance of Research and Publication to the Health Science Library Professional

Sue Loubiere, Moderator, School of Veterinary Medicine Library, Louisiana State University, Baton Rouge, Louisiana

Studies have shown that professional success--measured by number of people supervised, salary, and position in the institutional hierarchy--is directly tied to research and publication activity. In spite of this, many librarians seem reluctant to embark upon a publishing career. This presentation will demonstrate the natural evolution of writing for publication by examining three levels of development: factual service; descriptive/analytical; and research/empirical. The presenter will demonstrate that writing can be easily integrated into a professional career in a natural and logical manner.

Kathleen M. Heim, Dean, School of Library and Information Science, Louisiana State University, Baton Rouge, Louisiana

HOSPITAL LIBRARIES (Contributed Papers Session)
Monteleone Hotel: La Nouvelle Orleans East

No business meeting follows this program. Program will end at 5:00 p.m.

Taking Charge, Making Changes: Commitment to Quality in Hospital Libraries

Carole Gilbert, Moderator, Director, Library Services, Providence Hospital, Southfield, Michigan

3:35 p.m.: Organizational Change Within a Hospital Library Consortium: The Evolution of Resource Sharing

Kathleen Murray, Library Director, Horton Health Sciences Library, Providence Medical Center, Seattle, Washington

3:52 p.m.: Health Sciences Library Involvement in Geriatric Education Centers

Kathleen M. McCloskey, Head, Hope Fox Eccles Clinical Library, University of Utah Hospital, Salt Lake City, Utah

4:09 p.m.: Taking Charges - Making Change - \$

Marlene S. Englander, Medical Librarian, Cleveland Clinic Foundation, Cleveland, Ohio

4:26 p.m.: Criteria-based Performance Appraisals: Their Time Has Come

Courtland M. Chaney, Ph.D., Human Resource Management Association, Baton Rouge, Louisiana

4:43 p.m.: Evaluating Hospital Library Online Search Services: Do They Affect Management Decision Making?

Mary Campbell, Director, Health Information Network Services, Everett, Washington

PUBLIC SERVICES (Contributed Papers Session)
Monteleone Hotel: La Nouvelle Orleans West

No business meeting follows this program. Program will end at 5:00 p.m.

Hot Topics/Hot Issues in Public Services

Nancy W. Clemmons, Moderator, Head of Reference Services, Lister Hill Library of the Health Sciences, University of Alabama at Birmingham, Birmingham, Alabama

3:35 p.m.: Paraprofessionals at the Reference Desk: Benefit or Liability?

Kay Deeney, Reference Librarian, Louise M. Darling Biomedical Library, University of California, Los Angeles, Los Angeles, California

3:52 p.m.: Electronic Access and Creative Staffing for Reference

Marjorie Simon, Head of Reference Services and Inga Moten, Information Specialist, Health Sciences Library, University of Maryland at Baltimore, Baltimore, Maryland

4:09 p.m.: Reference Desk Service in an Electronic Environment

Beryl Glitz, Educational Services Coordinator, Louise M. Darling Biomedical Library, University of California, Los Angeles, Los Angeles, California

4:26 p.m.: Paying Our Way: Charges in a Medical School Library

Thomas Williams, Associate Director, Louis Calder Memorial Library, University of Miami School of Medicine, Miami, Florida

4:43 p.m.: Seeing Ourselves as Others See Us

Phyllis Lansing, User Education Coordinator and Inga Moten, Information Specialist, Health Sciences Library, University of Maryland at Baltimore, Baltimore, Maryland

TUESDAY, May 24**7:00 a.m. - 8:00 am****COMMITTEE MEETINGS**
(Please see schedule on page 82)**8:00 a.m. - 4:00 p.m.****REGISTRATION**
Pontchartrain Ballroom Foyer**8:00 a.m. - 5:00 p.m.****PLACEMENT SERVICE**
Poydras**8:30 a.m. - 10:00 a.m.****CONTRIBUTED PAPERS I****SESSION I - Expanded Roles for Libraries**
Pontchartrain B

Madeline V. Taylor, Moderator, George F. Smith Library, University of Medicine and Dentistry of New Jersey, Newark, New Jersey

8:30 a.m.: Responding to Consumer Health Questions: The Academic Medical Library's Dilemma

Judith M. Wetmore, Barbara J. Frey, Linda Kaczmarczyk and Alberta Richetelle, Lyman Maynard Stowe Library, University of Connecticut Health Center, Farmington, Connecticut

8:45 a.m.: Basic Computer Literacy—One Library's Program

Shelley A. Bader and Elaine R. Martin (presenter), Himmelfarb Health Sciences Library, George Washington University Medical Center, Washington, D.C.

9:00 a.m.: Facilitating the Use of "Peoplebases"—The University of Maryland at Baltimore Health Sciences Library's Experience with a Computer Conferencing System

Mary Joan (M.J.) Tooley and Beverly R. Webster, Health Sciences Library, University of Maryland at Baltimore, Baltimore, Maryland

9:15 a.m.: New Electronic Resources: A Catalog of Local Data Files

Nancy K. Roderer, Mary Lukanuski, and Judith L. Wulff (presenter), Columbia University Health Sciences Library, New York, New York

9:30 a.m.: Cancer Information for Librarians: Medical-Subject-Based Continuing Education

Nancy L. Ekstrand and Warren W. Olds, M.D., Department of Radiology, Bowman Gray School of Medicine; Betty H. Ladner and Kathryn Thodeson (presenter), Carpenter Library, Bowman Gray School of Medicine, Winston-Salem, North Carolina

8:45 a.m.: Some Thoughts About the Accuracy of Journal Articles

Sheldon Kotzin and Peri Schuyler, National Library of Medicine, Bethesda, Maryland

**SESSION II - Specialized Information Resources
Pontchartrain D**

Karen K. Grandage, Moderator, Medical Library, Wake Medical Center/Wake Area Health Education Center, Raleigh, North Carolina

9:30 a.m.: A Health Promotion Clearinghouse for Family Practice

Patricia A. Gibson, Ph.D. and Marian D. Craig, Family Health Foundation of America Library, Kansas City, Missouri

10:45 a.m.: Occupational/Environmental Protocols Designed for Use by Poison Information Specialists

Sherrie Kline, Douglas Linz, M.D., C. Scott Clark, Ph.D., and Martha J. Radike, Ph.D., University of Cincinnati Department of Environmental Health; Virginia H. Sublet, Ph.D., J. Frank Bonfiglio, Ph.D., and Leonard T. Sigell, Ph.D., University of Cincinnati Drug and Poison Information Center, Cincinnati, Ohio

11:00 a.m.: A Comparison of Socioeconomic Information in Three Online Databases

Jan H. LaBeause, Health Sciences Library, LeBonheur Children's Medical Center, Memphis, Tennessee; Karen J. Graves, Division of Library and Information Management, American Medical Association, Chicago, Illinois

11:15 a.m.: The Medical Center Archives and the Archives of Organizations

Madeleine Bagwell Perez, Medical Center Archives, Carpenter Library, Bowman Gray School of Medicine, Winston-Salem, North Carolina

11:30 a.m.: An International Experiment in Establishing High-Quality, Low-Cost Biomedical Core Collections in Developing Countries

Refko Saracevic, Ph.D., School of Communication, Information, and Library Studies, Rutgers, The State University of New Jersey, New Brunswick, New Jersey

11:45 a.m.: The CRISP System: An Untapped Resource for Biomedical Research Project Information

Kenneth Alan Collins, Ph.D., National Institutes of Health, Bethesda, Maryland

**SESSION III - Collection Management and Access
Aurora**

Maureen Battistella, Moderator, Baptist Medical Center Princeton, Birmingham, Alabama

8:30 a.m.: Analyzing In-House Journal Utilization: An Added Dimension in Decision Making

Shelley A. Bader and Laurie L. Thompson, Himmelfarb Health Sciences Library, George Washington University Medical Center, Washington, D.C.

8:45 a.m.: Journal Deselection in a Biomedical Research Library: A Mediated Mathematical Approach

Richard K. Hunt, Lawrence Livermore National Laboratory Library, Livermore, California

9:00 a.m.: Citation Analysis of Faculty Publications: Do the Library's Collection and Education Programs Support the Research?

Elizabeth H. Wood, Norris Medical Library, University of Southern California, Los Angeles, California

9:15 a.m.: Ranking of Journals from Citation Analysis for Health Sciences Librarianship

Min-Lin Emily Fang, Library of the Health Sciences, University of Illinois at Chicago, Chicago, Illinois

9:30 a.m.: Government Documents and the Online Catalog

Mary Charles Lasater and Frances Lynch, Vanderbilt Medical Center Library, Nashville, Tennessee

9:45 a.m.: Health Professionals' Use of Documents Obtained Through the Regional Medical Library Network

Irene Lovas, Brian Warling, Elaine Graham, and Virginia Flack, Louise Darling Biomedical Library, University of California, Los Angeles, Los Angeles, California

**SESSION IV - Automated Information Systems
Bayside**

June Fulton, Moderator, Medical Documentation Service, College of Physicians of Philadelphia, Philadelphia, Pennsylvania

8:30 a.m.: BioSynthesis: Bridging the Information Gap

Naomi C. Broering and H. Richard Gault, Dahlgren Memorial Library, Georgetown University Medical Center, Washington, D.C.; Howard Epstein, AT&T Federal Systems, Washington, D.C.

8:45 a.m.: LIS/DIS: Linking the Library, Drug Information, and Patient Care

Rajia Tobia, Susan Willcox, Nancy Bierschenk, and Anne Comeaux, Briscoe Library, The University of Texas Health Science Center at San Antonio, San Antonio, Texas; Leroy Knodel, Drug Information Service, The University of Texas Health Science Center at San Antonio, San Antonio, Texas

11:00 a.m.: MELVYL MEDLINE: A Project to Incorporate a MEDLINE Subset into the University of California MELVYL Online Catalog
Mike Berger, Laine Farley, University of California Division of Library Automation, Berkeley, California

11:15 a.m.: The Cleveland Free-Net: Community Computing and Medical Libraries
Sharron Carlson, Department of Family Medicine, Case Western Reserve University, Cleveland, Ohio

11:30 a.m.: Using TOXNET Software for Multiple In-House Databases
Gary Freiburger, Health Sciences Library, University of Maryland at Baltimore, Baltimore, Maryland

11:45 a.m.: Systems Functions Advisory Group: Its Contributions to the WEL-MED System
V. Jean Pugh, Melissa A. Kraft, Gary Moore, Cynthia H. Roberts, and Rebecca K. Satterthwaite, William H. Welch Medical Library, The Johns Hopkins University, Baltimore, Maryland

SESSION V - Management Issues St. Charles

Lynn Lloyd, Moderator, Health Sciences Library, Veterans Administration Medical Center, Providence, Rhode Island

12:30 a.m.: Effective Financial Management in Health Sciences Libraries
Gary Byrd, Health Sciences Library, University of North Carolina at Chapel Hill, Chapel Hill, North Carolina; Jacqueline Doyle (presenter), Health Sciences Library, Good Samaritan Medical Center, Phoenix, Arizona

12:45 a.m.: Clinical Medical Librarianship: The Evolution of a Program
Naomi Miller, Florence A. Moore Library of Medicine, Medical College of Pennsylvania, Philadelphia, Pennsylvania

1:00 a.m.: A Clinical Librarian Program for Restorative Dentistry: Adapting to the Needs of a Dental School Department in An Academic Health Center
Barbara J. Frey, Lyman Maynard Stowe Library, University of Connecticut Health Center, Farmington, Connecticut

1:15 a.m.: The Role of Publicity in the Successful Implementation of an Integrated Library System
Suzanne Kehm, Leslee Shell, Dorothy Willis, and Carolyn Reid, McGoogan Library of Medicine, University of Nebraska Medical Center, Omaha, Nebraska

9:30 a.m.: Bibliographic Verification for Interlibrary Loans: How Necessary Is It?

Susan C. Speer and JoAnn Bell, Ph.D. (presenter), Health Sciences Library, East Carolina University, Greenville, North Carolina

9:45 a.m.: One Field—Many Workers: A Structural Analysis

Dorothy Gilroy, Cincinnati Center for Developmental Disorders, Cincinnati, Ohio
Jane Thompson, Health Sciences Library, University of Cincinnati, Cincinnati, Ohio

10:00 a.m. - 10:30 a.m.

EXHIBIT BREAK
Grand Ballroom

Sponsors: BRS Information Technologies and MEDLINK

10:30 a.m. - 11:30 a.m.

HONORS AND AWARDS PRESENTATIONS
Pontchartrain Ballroom

11:30 a.m. - 12:30 p.m.

JANET DOE LECTURE
Pontchartrain Ballroom

Domus or Polis? The Location of Value

Gerald J. Oppenheimer, Former Director, University of Washington Health Sciences Library and Information Center, Seattle, Washington

12:30 p.m. - 2:00 p.m.

LUNCH

12:30 p.m. - 4:00 p.m.

HOSPITAL LIBRARIES SECTION
Luncheon, Program, and Business Meeting
Monteleone Hotel: La Nouvelle Orleans

Ethical and Educational Challenges in Aging: Who Finds the Answers?

Phyllis C. Gilliken, Moderator, Library Director, Coordinator, Library Information Network, Northwest Area Health Education Center at Hickory, North Carolina

Old and new friends will meet at 12:30 for lunch prior to the Hospital Libraries Section annual program and business meeting. The program begins at 1:15 and focuses on ethical and educational issues in aging. Marjorie V. Goff will address the educator's challenge in helping an aging population live better. She will particularly highlight the need for creative multi-disciplinary approaches to the provision of educational services. Dr. Harmon L. Smith will discuss ethical issue emerging from this significant population trend, especially problems of allocating finite resources in a world of infinite need. The Hospital Libraries Section business meeting will begin at 2:30 p.m., followed by a Town Hall discussion of the Section's strategic plan.

Helping an Aging Population Live Better: A Challenge to Educators

Marjorie V. Goff, R.N., M.S.H.E., Consultant (formerly Director of Aging Initiatives for Northwest AHEC, Winston-Salem, North Carolina)

Ethical Issues Emergent in Aging and Human Development

Harmon L. Smith, Ph.D., Professor of Moral Theology and Professor of Community and Family Medicine, Duke University Divinity School, Durham, North Carolina

1:00 p.m. to 2:00 p.m.

FILM FESTIVAL
Senate

Selected programs on topics related to Acquired Immunodeficiency Syndrome (AIDS). Title listings available at Registration.

2:00 p.m. - 4:00 p.m.

**SECTION AND COMMITTEE-SPONSORED
PROGRAMS**
SECTION BUSINESS MEETINGS

Programs are scheduled from 2:00 p.m. to 3:30 p.m. with Section business meetings immediately following the program sessions.

DENTAL LIBRARIES

Bayside B

Ann Marie Corry, Moderator, Dental Librarian, School of Dentistry Library, University of Missouri-Kansas City, Kansas City, Missouri

In the contemporary academic setting, it is becoming a necessity that faculty, staff, and students have access to the rapid information processing capabilities of microcomputers. These capabilities range from mundane word processing to the more complex operations of desktop publishing; from simple mathematic applications to complex statistical analyses which may even include graphics; and data management. Selection of hardware and software is critical in terms of cost-effectiveness and user-effectiveness. Other concerns include user-training, hardware and software maintenance and update, and scheduling the use of the equipment. This presentation is intended to be food-for-thought for those who have existing facilities and want to improve or update them as well as for those who are in the planning stages of developing a multi-user microcomputer facility.

Hardware and Software Selection in Multi-User Multi-Function Situations

William D. Davenport, Jr., Ph.D., Associate Professor of Oral Pathology, School of Dentistry, Louisiana State University, New Orleans, Louisiana

HISTORY OF THE HEALTH SCIENCES

Bayside A

Looking a Gift Horse in the Mouth

Billie K. Broaddus, Moderator, Head of Historical, Archival and Museum Services, Medical Center Information and Communications, University of Cincinnati, Cincinnati, Ohio

The gift appraisal process will be defined and described by an expert appraiser and rare book dealer. Particular attention will be given to the myths and realities of the process in terms of the expectations and requirements of the appraiser, the IRS, the donor, and the librarian.

The Appraiser: A Bridge Between the Librarian, the IRS, the Donors, and the Books

John A. Woods, John A. Woods Appraisers, South Windsor, Connecticut

**MEDICAL SCHOOL LIBRARIES AND MEDICAL INFORMATICS
ROUNDTABLE (Joint Program)
Pontchartrain Ballroom C/D**

No business meeting follows this program. Program will end at 4:00 p.m.

The Unified Medical Language System (UMLS) Project of the National Library of Medicine—Overview and Progress

Peter Stangl, Moderator, Director, Lane Medical Library, Stanford University Medical Center, Stanford, California

The lack of precise links among related medical information in different types of automated databases is a fundamental barrier to integrated access to the body of biomedical information in machine readable form. The purpose of the National Library of Medicine's UMLS Project is to overcome this barrier by permitting retrieval of related machine-readable information from at least four sources: the biomedical literature, clinical records, biomedical databanks, and knowledge bases. The goal is *not* to impose a single vocabulary on all systems and users, but to make the many different classifications of medical knowledge invisible to users. Although the development of the UMLS is a long-term project involving research groups at NLM and several universities, one of its goals is to create interim products which will have an immediate beneficial effect on the ability of health professionals and researchers to retrieve relevant information. The session will provide an overview of the UMLS project; a description of two specific UMLS research projects; and a discussion of interim products resulting from the research effort.

Overview of the UMLS Project

Donald A. B. Lindberg, M.D., Director, National Library of Medicine, Bethesda, Maryland

Structured Disease Descriptions: A UMLS Knowledge Source and a Tool for Examining Medical Language in Context

Marsden S. Blois, M.D., Ph.D., Professor and Chairman, Section on Medical Information Science, University of California, San Francisco, San Francisco, California

MicroMeSH: A Microcomputer-based Tool for Exploration and Display of Relationships within Vocabularies

Ray Octo Barnett, M.D., Professor of Medicine, Harvard Medical School, Cambridge, Massachusetts, and Director, Laboratory of Computer Science, Massachusetts General Hospital, Boston, Massachusetts

Year-term Products of the UMLS Project

Christy L. Humphreys, Deputy Associate Director, Library Operations, National Library of Medicine, Bethesda, Maryland

MEDICAL SOCIETY LIBRARIES

Aurora

Keeping Pace with Change: Some Innovative Approaches of Medical Society Libraries

Barbara L. Westermann, Moderator, John N. Shell Library, Nassau Academy of Medicine, Garden City, New York

The Medical Society Libraries program will have three invited papers presented, followed by a business meeting. The first presentation describes the progress of the ACOG IAIMS project, the first IAIMS project to be awarded to a national medical society, toward developing a national information network on women's health. The second presentation, on the Maryland MedSIG, discusses the development and management of a regional medical electronic information system and the role the library can play. The final presentation explains how the Bibliographic Services Unit, a fee-based service of the New York Academy of Medicine, affecting the overall mission and activities of the New York Academy of Medicine Library.

ACOG IAIMS: Progress Towards Developing a National Information Network on Women's Health

Amelita Van Hine, Resource Center, The American College of Obstetricians and Gynecologists, Washington, D.C.

The Maryland MedSIG: One Library's Role in Developing and Managing a Regional Medical Electronic Information Network

Joseph E. Jensen, Library of the Medical and Chirurgical Faculty of the State of Maryland, Baltimore, Maryland

The Impact of Introducing Fee-Based Information Services on the Mission of a Medical Library

Arthur Downing, The New York Academy of Medicine Library, New York, New York

MENTAL HEALTH
Monteleone Hotel: Queen Anne

The AIDS Epidemic as a Social Psychiatry Phenomenon

Pauline A. Kruk, Moderator, Stratford Hall Health Sciences Library, Fairfield Hills Hospital, Newtown, Connecticut

The speaker will address the impact of AIDS on psychiatry--how AIDS has affected the mental health profession and its workers; legal issues related to AID patients and those who treat them, i.e., patient confidentiality and legal liability; course of the disease and some treatment issues; psychiatric manifestations of th AIDS virus; and AIDS prevention issues.

Howard Joseph Osofsky, M.D., Head of Psychiatry, Louisiana State University School of Medicine, New Orleans, Louisiana

PHARMACY AND DRUG INFORMATION
Monteleone Hotel: Iberville

Excerpta Medica Lecture: Safety Assessment of New Drugs and New Project Formulations: The Use of Published and Unpublished Toxicology Data

Terry Ann Jankowski, Moderator, Online Resources Librarian, Health Sciences Library and Information Center, University of Washington, Seattle, Washington

Toxicologists work closely with product development personnel in the formulat of new products. Illustrations showing how the toxicologist utilizes computerize published literature to obtain information on the use of excipients in these new products will be presented. In addition, a situation will be described in which published data on chemical structure activity relationships are used to avoid ma toxicologic problems when developing a new class of compounds. Finally, and most important, a case history will be presented concerning why certain toxicolc data are not published regardless of a compound's potential toxicity.

Raymond E. Stoll, Ph.D., Director of Toxicology and Pathology, Sandoz Pharma ceuticals Corporation, East Hanover, New Jersey

Sponsor: Excerpta Medica

PUBLIC SERVICES AND TECHNICAL SERVICES (Joint Program)
St. Charles

Only the Public Services business meeting will follow this session.

And the Wall Came Tumbling Down! Cooperative Relationships Between Public and Technical Services

Barbara G. Smith, Co-Moderator, Assistant Director, Technical Services, Health Sciences Library, University of Maryland at Baltimore, Baltimore, Maryland; Na W. Clemmons, Co-Moderator, Head of Reference Services, Lister Hill Library of Health Sciences, University of Alabama at Birmingham, Birmingham, Alabama

many institutions, the "wall" between public and technical services is disappearing. The formerly distinct division of traditional functions is blurring. Automation has brought about an increased need for cooperation and understanding among all library units. It has also been the impetus for more joint responsibility, personnel crossover, and in some situations, total reorganization of the library staff. The two speakers are administrators who will discuss their viewpoints from opposite sides of the "wall." Ms. Yokote, from public services, and Mr. Miller, from the technical services arena, will describe their experiences at their own large academic health science libraries and discuss trends in other institutions. The future should bring exciting combinations of expertise as technical services and public services explore cooperative ventures.

Post Break: Options for a Public-Technical Services Team

Ms. Yukote, Associate Biomedical Librarian for Public Services, Louise M. Darling Biomedical Library, University of California, Los Angeles, Los Angeles, California

Barriers to Information Access: Mutual Concerns for Public and Technical Services

Dr. R. Miller, Systems Librarian and Head of Technical Services, Lane Medical Library, Stanford University Medical Center, Stanford, California

4:00 p.m. - 4:30 p.m.

EXHIBIT BREAK Grand Ballroom

Join your friends and colleagues in the MLA Exhibit, designed to be a hub of activity throughout the day including vendor demonstrations, prize drawings, informal conversation, and a lounge in the center of the hall.

Sponsor: Medical Library Association

4:30 p.m. - 6:00 p.m.

BUSINESS MEETING II—Open Forum Concurrent Sessions

Looking Ahead: Programs and Services (Pontchartrain A/B)

Shaping a Legislative Agenda

Advancing Professional Knowledge

Fostering Excellence

Developing New Resources

Expanding Chapter and Section Activities

Recognizing Professional Accomplishment—An Overview of Revisions in Credentialing (Pontchartrain C/D)

5:00 p.m. - 8:00 p.m.

INFORMAL MEETINGS (See schedule on page 84)

5:30 p.m. - 8:00 p.m.

PRESIDENT'S RECEPTION Windsor Court Hotel: Chinoiserie B

WEDNESDAY, May 25

Today is your last chance to take advantage of the MLA Exhibit where you can view the state of the art products and services in information technology, health care and scientific publications, library automation products, database services, photocopying equipment and services, micrographic equipment, and bibliographic and administrative software.

7:00 a.m. - 9:00 a.m.

COMMITTEE AND INFORMAL MEETINGS
(See schedule on pages 82 and 84)

8:00 a.m. - 4:00 p.m.

REGISTRATION
Pontchartrain Ballroom Foyer

8:00 a.m. - 5:00 p.m.

PLACEMENT SERVICE
Poydras

9:00 a.m. - 10:30 a.m.

EXPO '88: Demonstrations and Posters I
Doubletree Hotel: International Ballroom
(Session repeats at 4:00 p.m.)

Expo 88 will provide MLA members the opportunity to view posters on, and demonstrations of, a variety of health sciences library projects. It will feature presentations by librarians from many organizational environments.

Booth A—SCHIN: The South Carolina Health Information Network
Nancy C. McKeenan, Nancy J. Smith, and Anne W. Kabler, Library, Medical University of South Carolina, Charleston, South Carolina

Booth B—Indexes to the Pamphlet Collection of the American Nurses' Association
Robert M. Pringle, Jr. and Betty M. Anderson, Library, Intercollegiate Center for Nursing Education, Spokane, Washington

Booth C—Cancelled

Booth D—PAL, Patron/End Users At Lane: An Microcomputer Database for the Management of End User Training Registration and Statistics
Marsha Mielke, Lane Medical Library, Stanford University Medical Center, Stanford, California

Booth E—Statistical Summary of Chiropractic College Libraries in the United States and Canada 1981-1982 through 1986-1987
Dennis Peterson and Glenda Wiese, Palmer College of Chiropractic, Davenport Iowa

Booth F—Using a File Manager to Create a "Faculty/Staff Interests" Database Aid in Collection Development

Antonija Prelec and Betty Emilio, Health Sciences Library, State University of New York at Stony Brook, East Setauket, New York

Booth G—The Role of the Library Technician in Contributing to the Delivery of Health Care Information

Deleen Ann Brown, McGoogan Library of Medicine, University of Nebraska Medical Center, Omaha, Nebraska and Gayle K. Willard, Veterinary Medical Library, College of Veterinary Medicine, Kansas State University, Manhattan, Kansas

Booth H—Bibliotherapy in a Pediatric Setting

Brothly Gilroy, Cincinnati Center for Developmental Disorders, Cincinnati, Ohio

Booth I—End User Training Using PC Storyboard Software

Lary Berwick, Ph.D., Adrienne Loev, Linda Rossi, and Carlos Rodriguez, Biomedical Library, University of Pennsylvania, Philadelphia, Pennsylvania

Booth J—GRATEFUL MED Program

Ellen Wilson Green, Health Sciences Information Center, Cedars-Sinai Medical Center, Los Angeles, California

Booth K—MELVYL MEDLINE

Susan Starr and Mary Horres, Biomedical Library, University of California, San Diego, La Jolla, California and Mike Berger, Division of Library Automation, University of California, Berkeley, Berkeley, California

Booth L—VA Library Automation

Joy W. Hunter, Library Service, VA Medical Center, Murfreesboro, Tennessee and Jean M. McVoy, Library Division, VA Central Office, Washington, D.C.

Booth M—Instruction in Personal File Management

Sydney Apostle and E. Martin, Paul Himmelfarb Health Sciences Library, George Washington University Medical Center, Washington, D.C.

Booth N—The International Nursing Library and Resource Center

Marie Sparks, Library and Information Services, Sigma Theta Tau, Incorporated, Indianapolis, Indiana

Booth O—Online Mendelian Inheritance in Man (OMIM)

Richard E. Lucier and Gary G. Moore, The William H. Welch Medical Library, The Johns Hopkins University, Baltimore, Maryland

Booth P—Core List of Journals in Aging, Gerontology, and Geriatrics

Karen McNally Bensing, Brittingham Library, Cleveland Metro General Hospital, Cleveland, Ohio

Booth Q—Women's Health Movement Periodicals

Trudy K. Landwirth, Library of the Health Sciences, University of Illinois at Chicago, Chicago, Illinois

Booth R—The Future is Now: IAIMS Progress at Georgetown University

Naomi C. Broering, John Vinton Dahlgren Memorial Library, Georgetown University Medical Center, Washington, D.C.

Booth S—South Carolina Health Promotion Clearinghouse

Michael Kronenfeld, Jerry Dell Gimarc, Peter Lee, Corinne Meltzer, Cynthia Ross, John Ureda, and Maria Whitehead, Educational Resource Center, South Carolina Department of Health and Environmental Control, Columbia, South Carolina

Booth T—AIDS Information Center

Lisa Rains Russell and Barbara Doughty, Health Sciences Library, University of Alabama, Tuscaloosa, Alabama

Booth U—The WELMED Project - Featuring the Core Concept Database

Karen Butler, Gary Moore, and W. Jean Pugh, William H. Welch Medical Library, Johns Hopkins University, Baltimore, Maryland

Booth V—Tailored Search Results/Electronic Bulletin Board Services

Pamela Bradigan and Carol Mularski, Health Sciences Library, The Ohio State University, Columbus, Ohio

Booth W—Information on Aging through a User-Friendly Geriatric Database

Ellen Sheehan, Virginia Corcoran, Kelly Daigle, and Sherry Morgan, Hartford Hospital Health Sciences Libraries, and Jefferson House Gerontology Resource Center, Hartford, Connecticut

Booth X—LEON: A Public Relations Campaign for an Intergrated Library System

Leslee B. Shell, McGoogan Library of Medicine, University of Nebraska Medical Center, Omaha, Nebraska

Booth Y—The Brizzogo: A Medical Librarian Built Microcomputer

B. Sue Brizuela and Joyce D. Zotott, Joseph W. England Library, Philadelphia College of Pharmacy and Science, Philadelphia, Pennsylvania

Booth Z—Toy Express

Jean Long, Professional Library, Newington Children's Hospital, Newington, Connecticut

Booth AA—Teaching MeSH to End-Users

Kathy Torrente and Linda Garr Markwell, Health Sciences Library, Emory University, Atlanta, Georgia

Booth BB—Information Course for Freshmen Medical Students

David S. Ginn, Thomas L. Williams, Suzetta Burrows, and Neil Love, M.D., Louis Alder Memorial Library, University of Miami School of Medicine, Miami, Florida

Booth CC—ILL3 Datafile

Michael F. Strahan, N.E. French Library of the Health Sciences, School of Medicine, University of North Dakota, Grand Forks, North Dakota and Pat Onsi, State University of New York, Upstate Medical Center Library, Stony Brook, New York

Booth DD—Family Library

John Ingersoll, Family Library, Children's Hospital National Medical Center, Washington, D.C.

Booth EE—Native Americans into Medicine

Bartha Eberhart, Health Science Library, University of Minnesota, Duluth, Minnesota

Booth FF—Developing a Database for Ephemeral Materials

Bartha Bovee, Biomedical Library, University of California at San Diego, La Jolla, California

9:00 a.m. - 10:30 a.m.

SHARING SESSIONS I

(Sessions with an asterisk (*) will be repeated at 4:00 p.m. with another presenter.)

These informal Sharing Sessions will give you an opportunity to share information with your colleagues on a variety of topics. Each session is forty-five minutes long with a five minute break between sessions to allow you to move to a different session if you so choose.

Budget Reductions in Hospital Libraries—Survival Techniques* (Bonnie Burn) Jacqueline D. Bastille, Treadwell Library, Massachusetts General Hospital, Boston, Massachusetts

IV. Marketing Strategies—Selling the Library as a Part of the Patient Care Package* (Edgewood)

Ernie Todd Smith, Werner Health Science Library, Rochester General Hospital, Rochester, New York

VI. CD-ROM Use in Health Science Libraries—What Works and How* (Estherwood)

Susan J. Barnes, Augustus C. Long Health Sciences Library, Columbia University, New York, New York

V. Mounting Local Databases—Staff Responsibilities, Costs, Lead Time: The Triumphs and the Pitfalls (Evergreen)

Neil Rambo, Houston Academy of Medicine-Texas Medical Center Library, Houston, Texas

V. Strategies for Integrating Database Searching into the Medical School Curriculum (Felicity)

Linda Watson, Houston Academy of Medicine-Texas Medical Center Library, Houston, Texas

VI. Library System Software for Small Hospital Libraries* (Gallier House)

Rosalind F. Dudden, Gerald Tucker Library, National Jewish Center for Immunology and Respiratory Medicine, Denver, Colorado

VII. Microcomputer Lab Management—Start Up and Maintenance* (Oakley)

Janis F. Brown, Norris Medical Library, University of Southern California, Los Angeles, California

VIII. Experiences with Telefacsimile* (Aurora - Table One)

Leila M. Hover, Holy Name Hospital, Teaneck, New Jersey

IX. Retrain the Old or Hire the New—Gaining Staff Expertise in Library Automation* (Aurora - Table Two)

Irene M. Lathrop, Peters Library, Rhode Island Hospital, Providence, Rhode Island

X. The Role of Practicing Librarians and Educators in Recruiting and Training Students for Careers in Health Science Libraries (Bayside B - Table One)

Frank R. Kellerman, Sciences Library, Brown University, Providence, Rhode Island

XI. Collection Development Issues for the 1990s* (Bayside B - Table Two)

Daniel T. Richards, Augustus C. Long Health Sciences Library, Columbia University, New York, New York

XII. Consulting for Fun and Profit (Ellendale)

Linda Grix, Carmichael, California

XIII. Library Involvement in User Education-- An Exchange of Creative, Effective Ideas that Produce Results* (Crescent)

Jacqueline D. Doyle, Health Sciences Library, Good Samaritan Medical Center, Phoenix, Arizona

XIV. Application of dBASE, LOTUS, and Other Software in the Library (St. Charles A - Table One)

Joe Wible, Falconer Biology Library, Stanford University, Stanford, California

XV. Access/Cataloging Issues in the 1990s (St. Charles A - Table Two)

Kathy Hoffman, Houston Academy of Medicine-Texas Medical Center Library, Houston, Texas

XVI. Online Training for Health Professionals—What's Needed in the Era of User-Friendly Systems?* (Bayside A - Table One)

Beverly L. Renford, Biomedical Library, University of California, San Diego, La Jolla, California

XVII. Fund Raising Strategies for Libraries* (Bayside A - Table Two)

Henry L. Lemkau Jr., Louis Calder Memorial Library, University of Miami, Miami, Florida

10:30 a.m. - 11:00 a.m.

EXHIBIT BREAK
Grand Ballroom

Sponsor: Login Brothers Book Company

11:00 a.m. - 12:30 p.m.

BUSINESS SESSION III
Pontchartrain Ballroom

Presiding: Holly Shipp Buchanan, President, Medical Library Association; Director, Corporate Information Resources, NKC Hospitals, Louisville, Kentucky

New Business
Resolutions
Recognition of Retiring Board Members
Introduction of Incoming Board Members

Inaugural Address: Bridging the Gap from Plan to Action

Eloise C. Foster, President-Elect, Medical Library Association; Director, AHA Resource Center, American Hospital Association, Chicago, Illinois

12:30 p.m. - 2:00 p.m.

LUNCH

1:00 p.m. - 2:00 p.m.

FILM FESTIVAL
Senate

Selected programs of interest to health and library professionals. Topics covered will include preservation of library materials, communications in the health care setting, ethics, etc. Title listings available at registration.

1:00 p.m. - 2:00 p.m.

EXHIBITOR DEMONSTRATIONS
(Please refer to Guide to Exhibits for further information)

2:00 p.m. - 3:30 p.m.

PLENARY SESSION II: Managing Transformation: Internal and External
Pontchartrain Ballroom

Rick B. Forsman, Moderator, Associate Director for Technical Systems, Denison Memorial Library, University of Colorado, Denver, Colorado

Health Professions Education and the Information Society: Implications for Leadership at the Interface

Eugene S. Mayer, M.D., Associate Dean and AHEC Program Director, School of Medicine, University of North Carolina at Chapel Hill, Chapel Hill, North Carolina

Dr. Mayer will share his views on the growing complexities of the health care field and the vital role of information professionals as generalists in maintaining awareness of the larger whole. His remarks will consider technology as a factor in external changes and draw parallels between health care and information generalists.

Terminal Paralysis

Sara Fine, Ph.D., Associate Professor, School of Library and Information Science, University of Pittsburgh, Pittsburgh, Pennsylvania

Dr. Fine is a psychologist and will be addressing the challenges of managing people in light of technological advances.

Reactors: Robert G. Cheshier, Cleveland Health Sciences Library, Cleveland, Ohio
 Rachael K. Anderson, Director, Health Sciences Library, Columbia University, New York, New York

Suzanne F. Grefsheim, Associate Director, Southeastern/Atlantic Regional Medical Library, Health Sciences Library, University of Maryland, Baltimore, Maryland

Co-Sponsors: Readmore and the South Central Regional Group of the Medical Library Association

3:30 p.m. - 4:00 p.m.

EXHIBIT BREAK
Grand Ballroom

Sponsor: Medical Library Association

4:00 p.m. - 5:30 p.m.

CONTRIBUTED PAPERS II

SESSION I - Searching Choices
Bayside

James Shedlock, Moderator, Archibald Church Medical Library, Northwestern University, Chicago, Illinois

4:00 p.m.: Replacing Online Services with CD-ROM Technology

Leslie Goodale Adebajo, Mattie McHollin (presenter), Faye Kulp, Marsha Williams, Meharry Medical College Library, Nashville, Tennessee

4:15 p.m.: MEDLINE Alternatives

Susan Barnes and Nancy K. Roderer, Augustus C. Long Health Sciences Library, Columbia University, New York, New York

4:30 p.m.: Evaluating CD-ROM Versions of the MEDLINE Database

Nancy S. Hewison, Life Sciences Library, Purdue University, Lafayette, Indiana

4:45 p.m.: Introducing MEDTUTOR: Microcomputer-Based Training for MEDLINE

Patricia C. Buchan, Miriam L. Perkins, Melvin L. Spann, National Library of Medicine, Bethesda, Maryland

5:00 p.m.: Evaluation of the Use of the PDQ System in a Clinical Setting

Jennifer J. Angier, Providence Medical Center, Seattle, Washington; Susan L. Beck and Harmon J. Eyre, M.D., University of Utah Health Sciences Center, Salt Lake City, Utah

5:15 p.m.: Individual Characteristics Related to the Implementation of End-User Searching by Health Professionals

Joanne G. Marshall, Ph.D., Faculty of Library and Information Science, University of Toronto, Toronto, Ontario,

**SESSION II—Automation—Practical and Philosophical
St. Charles**

Charles Bandy, Moderator, Denison Memorial Library, University of Colorado Health Sciences Center, Denver, Colorado

4:00 p.m.: Minis, Micros, and Macros: Automation "for the Rest of Us"

Marsha Williams, Leslie Goodale Adebajo and Mattie McHollin, Meharry Medical College Library, Nashville, Tennessee

4:15 p.m.: Adapting Computer Software to a Library's Needs

John P. Glueckert, Dental Library, Health Sciences Library System, University of Southern California, Los Angeles, California

4:30 p.m.: A Microcomputer Based Net Lending Interlibrary Loan System

Linda S.L. Yau, Michael L. Newman, and Maryse Gascard, Lane Medical Library, Stanford University, Stanford, California

4:45 p.m.: The South Dakota Med-Fax Network

David Hulkonen, Lommen Health Sciences Library, University of South

Dakota, Vermillion, South Dakota; Carol Galganski, McKennan Hospital Library, Sioux Falls, South Dakota; Pat Hamilton, Rapid City Regional Hospital Library, Rapid City, South Dakota; Rita Sieracki, Howard Young Medical Center, Woodruff, Wisconsin

5:00 p.m.: An Online Survey Questionnaire Used in Conjunction with LIS

Jean Reibman, Samuel J. Wood Library, Cornell University Medical College, New York, New York

5:15 p.m.: A Medical School Library in the "New" China

Thomas Williams, Louis Calder Memorial Library, University of Miami School of Medicine, Miami, Florida

4:00 p.m. - 5:30 p.m.

EXPO '88: Demonstrations and Posters II

Doubletree: International Ballroom

(See page 58 for descriptions)

4:00 p.m. - 5:30 p.m.

SHARING SESSIONS II

(Repeat of 9:00 a.m. sessions.)

These informal Sharing Sessions will give you an opportunity to share information with your colleagues on a variety of topics. Each session is forty-five minutes long with a five minute break between sessions to allow you to move to a different session if you so choose.

I. Budget Reductions in Hospital Libraries—Survival Techniques (Bonnie Burn)

Chris Jones, VA Medical Center, Biloxi, Mississippi

II. Marketing Strategies—Selling the Library as a Part of the Patient Care Package (Edgewood)

Marion Holena Levine, Lyman Maynard Stowe Library, University of Connecticut Health Center, Farmington, Connecticut

III. CD-ROM Use in Health Science Libraries—What Works and How (Estherwood)

Margaret Bandy, Health Sciences Library, St. Joseph Hospital, Denver, Colorado

IV. Mounting Local Databases—Staff Responsibilities, Costs, Lead Time: The Triumphs and the Pitfalls (Evergreen)

Virginia M. Bowden, Briscoe Library, University of Texas Health Science Center, San Antonio, Texas

V. Library System Software for Small Hospital Libraries (Gallier House)

Nancy Bush Fazzone, Health Sciences Library, Salem Hospital, Salem, Maine

VI. Microcomputer Lab Management—Start Up and Maintenance (Oakley)

Patricia L. Thibodeau, Information and Media Services, Mountain Area Health Education Center, Asheville, North Carolina

VII. Experiences with Telefacsimile (Aurora - Table One)

Betty Sawyers, Health Sciences Library, Ohio State University, Columbus, Ohio

VIII. Retrain the Old or Hire the New—Gaining Staff Expertise in Library Automation (Aurora - Table Two)

Rachael K. Anderson, Augustus C. Long Health Sciences Library, Columbia University, New York, New York

IX. Collection Development Issues for the 1990s (Ellendale)

Carolyn Fishel, Medical Library, Glendale Adventist Medical Center, Glendale, California

X. Library Involvement in User Education—An Exchange of Creative, Effective Ideas that Produce Results (Crescent)

Beryl Glitz, Louise M. Darling Biomedical Library, University of California, Los Angeles, Los Angeles, California

XI. Online Training for Health Professionals—What's Needed in the Era of User-Friendly Systems? (Felicity)

Ellen R. Westling, Treadwell Library, Massachusetts General Hospital, Boston, Massachusetts

XII. Fund Raising Strategies for Libraries (Senate)

Marilee Creelan, Medical Library, Akron City Hospital, Akron, Ohio

4:00 p.m. - 7:00 p.m.

CHAPTER COUNCIL MEETING
Salon 808

4:00 p.m. - 7:00 p.m.

SECTION COUNCIL MEETING
Salon 812

5:30 p.m. - 7:00 p.m.

INFORMAL MEETINGS
(See schedule on page 84)

8:00 p.m.

BANQUET
Pontchartrain Ballroom

Entertainment provided by: Majors Scientific Books, Inc.

THURSDAY, May 26**7:00 a.m. - 8:00 a.m.****REGISTRATION
Pontchartrain Ballroom Foyer****8:00 a.m. - 5:00 p.m.****BOARD OF DIRECTORS MEETING
Bayside A****8:30 a.m. - 3:00 p.m.****1990 NATIONAL PROGRAM COMMITTEE
MEETING
Gallier House****8:30 a.m. - 5:00 p.m.****CONTINUING EDUCATION COURSES****FRIDAY, May 27****8:00 a.m. - 5:00 p.m.****BOARD OF DIRECTORS MEETING
Bayside A****8:30 a.m. - 5:00 p.m.****CONTINUING EDUCATION COURSES**

Need
Nursing
Information
Quickly?

The first floppy disk software system retrieving current nursing information from 60 leading nursing journals.

Requires only IBM PC (or IBM compatible) with 512K, 2.0+ DOS.

Price: 1985, 1986 \$165/year;
1987, 1988 \$170/year.

See NurseSearch™
*demonstrated at the
MLA Convention.
Booth #12.*

CINAHL
Cumulative Index to
Nursing & Allied
Health Literature

1509 Wilson Terrace
Post Office Box 871
Glendale, California
91209-0871
For further information:
(818) 409-8005

KA RETRIEVAL
SYSTEM
WARE
KNOWLEDGE ACCESS

NurseSearch™
Nursing Literature on Floppy Disk

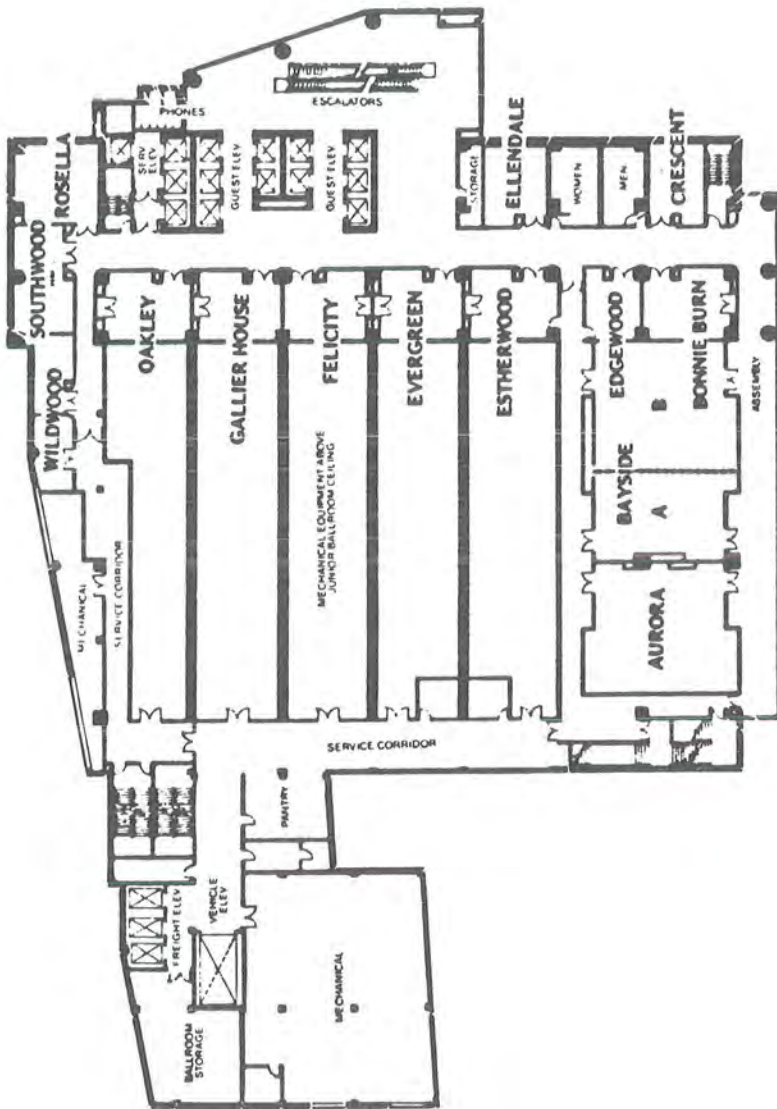

Sheraton New Orleans Hotel, 4th floor

All salons are located on the eighth floor of the Sheraton New Orleans Hotel.

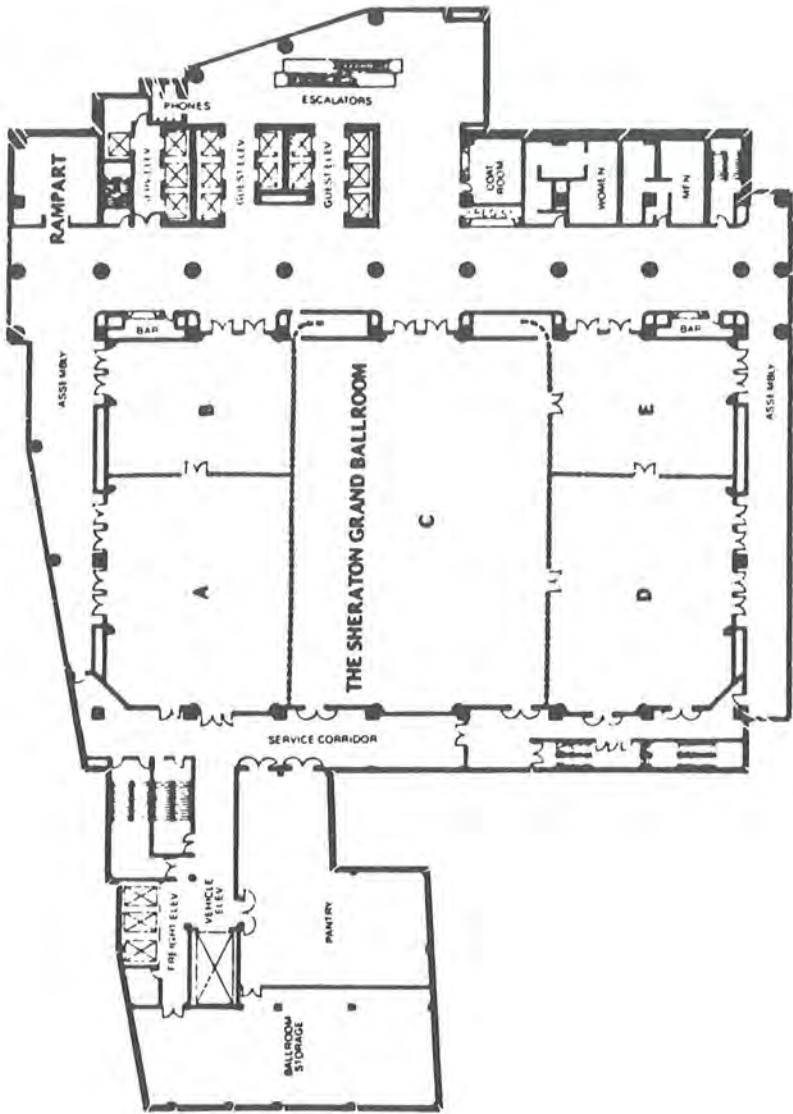

Sheraton New Orleans Hotel, 5th floor

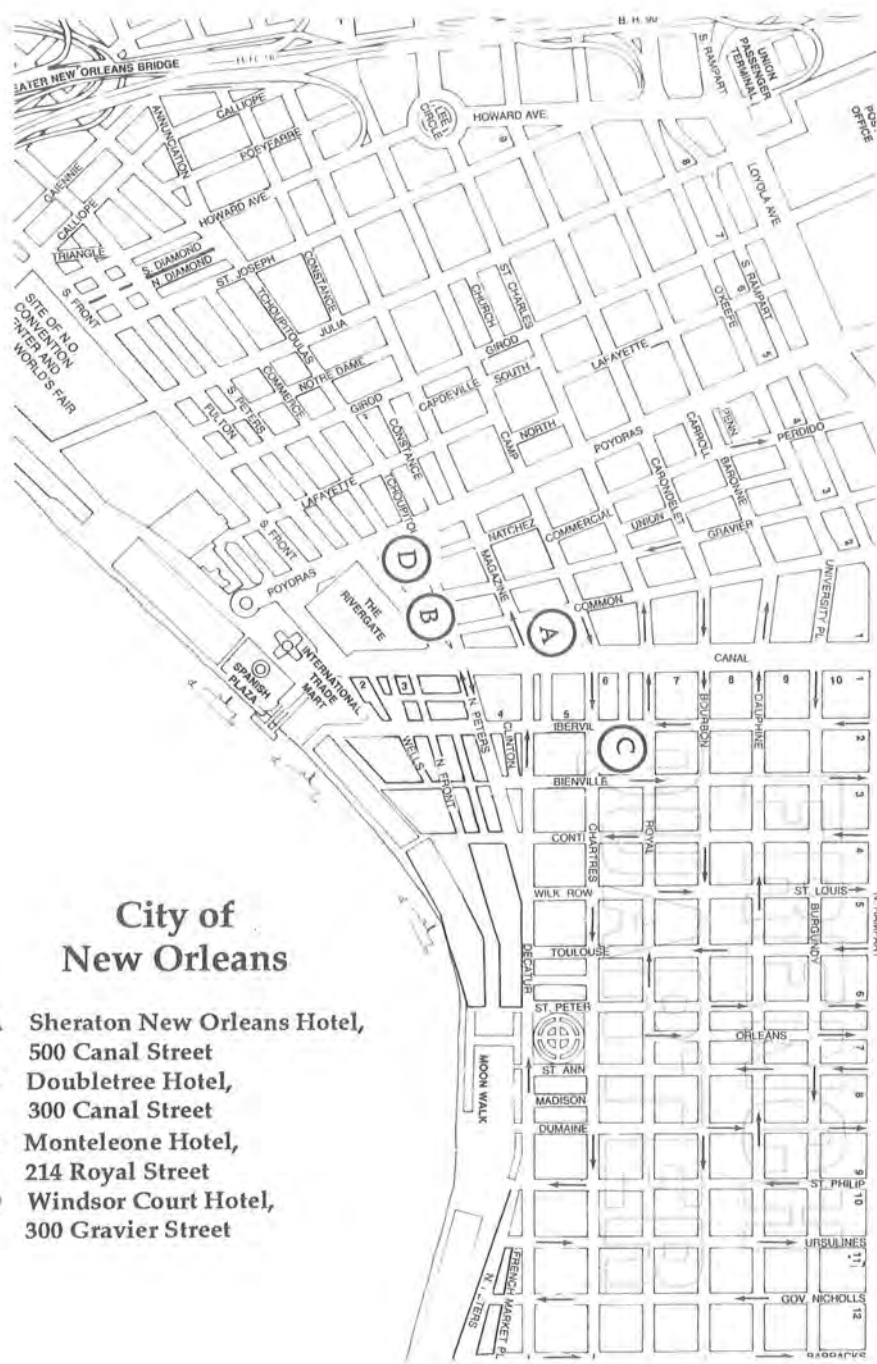

City of New Orleans

- A** Sheraton New Orleans Hotel,
500 Canal Street
- B** Doubletree Hotel,
300 Canal Street
- C** Monteleone Hotel,
214 Royal Street
- D** Windsor Court Hotel,
300 Gravier Street



An Information Source in
Gerontology
& Geriatric Medicine

The rapidly increasing size of the elderly population has compelled scientists and society at large to focus major new efforts in the varied disciplines of **Gerontology** and **Geriatric Medicine**. UMI answers the need for information in these disciplines with a comprehensive microfiche collection, designed for the study of all aspects of aging. *The Microfiche Library of Gerontology & Geriatrics* brings together for the first time key materials which have previously only been available in scattered libraries and in diverse, inconvenient formats.

The collection covers four Main Interest Categories: biological; clinical; behavioral and social; and health care aspects of aging.

UMI also offers current microfiche collections in the following categories:

- **CHIS: Consumer Health Information Service**—Vital information on health-related topics such as nutrition. Updated biennially.
- **Health Care**—An ongoing series providing recent health literature. Designed for health care professionals.
- **Rehabilitation and Handicapped Literature**—Statistical surveys, case histories and handbooks on physical and mental rehabilitation programs and procedures.
- **History of Nursing**
- **NEW! Primary Sources for the History of Pharmacy in the United States**—Pharmaceutical law, treatises, textbooks, catalogs and formula books from the Colonial Period through 1940.

For more information on these collections and pricing, call your **UMI Research Collections Account Representative**.

U·M·I Research
Collections

A Bell & Howell Information Company
300 North Zeeb Road, Ann Arbor, MI 48106-1346 USA
Continental US: 1-800-423-6108
Michigan & Alaska: Collect 313-761-4700
Canada 1-800-343-5299

Index to Presenters

A

Adebonojo, Leslie
 Goodlae, 65
 Allen, Margaret, 33
 Alligood, Elaine C., 42
 Anderson, Betty M., 58
 Anderson, Rachael K., 64, 67
 Angier, Jennifer J., 65
 Apostle, Lynne, 59
 Arenales, Duane, 35

B

Bader, Shelly, 48, 50
 Bandy, Charles, 65
 Bandy, Margaret, 66
 Barnett, Guy Octo, 55
 Barnes, Susan J., 61
 Bastille, Jacqueline D., 61
 Battin, Patricia 37
 Battistella, Maureen, 49
 Barnes, Susan, 65
 Beck, Susan L., 65
 Becker, Jeanne, 41
 Bell, JoAnn, 52
 Ben-Shir, Rya, 32
 Bensing, Karen McNally, 59
 Berger, Mike, 50, 51
 Berwick, Mary, 59
 Bierschenk, Nancy, 50
 Blois, Marsden S., 54
 Boggs, C. Lindy, 31, 45
 Bonfiglio, J. Frank, 49
 Rovee, Martha, 61
 Bowden, Virginia M., 66
 Bradigan, Pamela, 60
 Brizuela, B. Sue, 60
 Broaddus, Billie K., 53
 Broering, Naomi, 44, 51, 60
 Brown, Helen Ann, 59
 Brown, Janis F., 62
 Bryant, Jane, 33
 Buchan, Patricia C., 65
 Buchanan, Holly Shipp, 31, 63
 Burrows, Suzetta, 61
 Bush, Carmel Corriveau, 34, 35
 Butler, Karen, 60
 Byrd, Gary, 51

C

Campbell, Mary, 46
 Carlson, Sharron, 51
 Chaney, Courtland M., 46
 Cheshier, Robert G., 64
 Clark, Scott C., 49
 Clemmons, Nancy W., 46, 56
 Cohen, Philip T., 44
 Colaianni, Lois Ann, 41

Collins, Kenneth Alan, 49
 Comeaux, Anne, 50
 Compton, Anne W., 44
 Corcoran, Virginia, 60
 Corry, Ann Marie, 53
 Cosgrove, Tracey, 32
 Craig, Marian D., 49
 Crawford, Susan, 36
 Creelan, Marilee, 67
 Curtis, James, 35

D

Daigle, Kelly, 60
 Davenport, William D., 53
 Deeney, Kay, 46
 Detlefsen, Ellen Gay, 44
 Diamond, Linda 45
 Doughty, Barbara, 60
 Downing, Arthur, 55
 Doyle, Jacqueline, 51, 62
 Dudden, Rosalind F, 62

E

Eberhart, Martha, 61
 Ekstrand, Nancy L., 48
 Emilio, Betty, 59
 Englander, Marlene S, 46
 Epstein, Howard, 50
 Erwin, Patricia, 34
 Eyre, Harmon J., 65

F

Fang, Min-Lin Emily, 50
 Farley, Laine, 50
 Fazzone, Nancy Bush, 66
 Fine, Sara, 64
 Fishel, Carolyn, 33, 67
 Flack, Virginia, 50
 Florance, Valerie, 39
 Flower, M.A., 36
 Forsman, Rick B., 39, 64
 Foster, Eloise C., 63
 Frey, Barbara J., 48, 51
 Freiburger, Gary, 51
 Fuller, Sherrilynn S., 38
 Fulton, June, 50

G

Galganski, Carol, 66
 Garon, Claude, F., 34
 Gault, H. Richard, 50
 Gascard, Maryse, 65
 Gera, V. Lynn, 43
 Gibson, Patricia A., 49
 Gilbert, Carole, 45
 Gilliken, Phyllis C., 52

Ginn, David S., 61
 Givens, Mary King, 36
 Gilroy, Dorothy, 52, 59
 Gimarc, Jerry Dell, 60
 Clitz, Beryl, 47, 67
 Glueckert, John P., 65
 Goff, Marjorie V., 52
 Graham, Elaine, 33, 50
 Grandage, Karen K., 49
 Graves, Karen J., 49
 Green, Ellen Wilson, 59
 Grefsheim Suzanne F., 64
 Grix, Linda, 62

H

Hackleman, Karen, 36
 Hamilton, Pat, 66
 Hannigan, Gale G., 35
 Hein, Kathleen, 45
 Hewison, Nancy S., 65
 Himes, Mary Lou, 43
 Hoffman, Kathy, 62
 Horres, Mary, 59
 Hover, Leila M., 62
 Howard, Frances
 Humphrey, 31
 Hulkonen, David, 65
 Humphries, Betsy L., 55
 Hunt, Richard K., 50
 Hunter, Joy, 59

I

Ingersoll, Lyn, 61

J

Janes, Jodith, 32
 Jankowski, Terry Ann, 56
 Jensen, Joseph E., 55
 Jones, Chris, 66

K

Kabler, Anne W., 58
 Kaczmarczyk, Linda, 48
 Kehm, Suzanne, 51
 Kelly, Elizabeth, 36
 Kelly, Jane, 42
 Kellerman, Frank R., 62
 Kline, Sherri, 49
 Knodel, Leroy, 50
 Kotzin, Sheldon, 49
 Kraft, Melissa A., 51
 Kristofco, Robert E., 36
 Kronenfeld, Michael, 60
 Kruck, Pauline A., 56
 Kulp, Faye, 65

- L**
 LaBeause, Jan H., 49
 Ladner, Betty H., 48
 Landwirth, Trudy K., 60
 Lansing, Phyllis, 47
 Lasater, Mary Charles, 50
 Lathrop, Irene M., 62
 Lee, Peter, 60
 Lemkau, Henry L., 63
 Levine, Marion Holena, 66
 Lindberg, Donald A.B., 41, 54
 Linz, Douglas, 49
 Lipscomb, Carolyn, 31
 Lloyd, Lynn, 51
 Loev, Adrienne, 59
 Long, Jean, 60
 Loubiere, Sue, 45
 Lovas, Irene, 50
 Love, Neil, 61
 Lucier, Richard, 59
 Lukanuski, Mary 48
 Lyders, Richard A., 32
 Lynch, Frances, 50
- Mc**
 McCloskey, Kathleen, 46
 McGowen, Julie Johnson, 43
 McHollin, Mattie, 65
 McKeehan, Nancy C., 58
 McVoy, Jean M., 59
- M**
 Marchand, Donald, 37
 Markwell, Linda Garr, 60
 Marshall, Joanne G., 65
 Martin, Elaine R. 48
 Martin, E., 59
 Matheson, Nina, 37
 Mayer, Eugene S., 64
 Meltzer, Corinne, 60
 Mielke, Marsha, 58
 Miller, Dick R., 57
 Miller, Naomi, 51
 Moore, Gary G., 51, 60
 Morgan, Sherry, 60
 Morse, David, 43
 Moten, Inga, 46, 47
 Moules, Mary, 34
 Mularski, Carol, 60
 Murray, Kathleen, 46
- N**
 Newman, Michael L., 65
- O**
 Olds, Warren W., 48
 Olson, Chris, 36
- Onsi, Pat, 61
 Oppenheimer, Gerald J., 52
 Osofsky, Howard Joseph, 56
- P**
 Paul, Suzanne, 45
 Perez, Madeleine Bagwell, 49
 Perkins, Miriam, L., 65
 Peterson, Dennis, 58
 Prelec, Antonija, 59
 Pringle, Robert M., 58
 Postell, William D., 31
 Pugh, W. Jean, 51, 60
- R**
 Radlike, Martha J., 49
 Rambo, Neil, 61
 Rees, Alan M., 44
 Reibman, Jean, 66
 Reid, Carolyn, 51
 Reit, Janet Wilson, 35
 Renford, Beverly L., 63
 Richards, Daniel T., 35, 62
 Richetelle, Alberta, 48
 Robbins, Frederick C., 43
 Roberts, Cynthia H., 51
 Roderer, Nancy K., 48, 65
 Rodriguez, Carlos, 59
 Roper, Fred, 37
 Ross, Cynthia, 60
 Rossi, Linda, 59
 Russell, Lisa Rains, 60
- S**
 Salisbury, Linda, 36
 Saracevic, Tefko, 49
 Satterthwaite, Rebecca K., 51
 Sawyers, Betty, 67
 Schaeffer, Judith E., 33
 Schafer, Marilyn, 34
 Schuyler, Peri, 49
 Schwartz, Diane G., 39
 Selig, Susan A., 36
 Shedlock, James, 64
 Sheehan, Ellen, 60
 Shell, Leslee, 51, 60
 Sieracki, Rita, 66
 Sigell, Leonard T., 49
 Simon, Marjorie, 46
 Smith, Barbara G., 35, 56
 Smith, Bernie Todd, 61
 Smith, Hammond L., 53
 Smith, Nancy J., 58
 Spala, Jeanne L., 43
 Spann, Melvin L., 65
 Sparks, Marie, 59
 Speer, Susan C., 39, 52
 Strahan, Michael F., 61
- Stangl, Peter, 54
 Star, Susan, 59
 Stevenson, Ursula, 33
 Stoll, Raymond E., 56
 Sublet, Virginia H., 49
 Sumner, Leslee C., 36
- T**
 Tappana, Kathy, 32
 Taylor, Madeline V., 48
 Thibodeau, Patricia L., 66
 Thodeson, Kathryn, 48
 Thompson, Jane, 52
 Thompson, Laurie L., 50
 Tingley, Dianne E., 42
 Tobia, Rajia, 50
 Tooley, Mary Joan, 35, 48
 Torento, Kathy, 60
- U**
 Ureda, John, 60
- V**
 Van Hine, Pamela, 55
- W**
 Warling, Brian, 50
 Watson, Linda, 62
 Webster, Beverly R., 48
 Wedgeworth, Robert, 32
 Wellick, Kay E., 38
 Weise, Glenda, 58
 Westermann, Mary L., 55
 Westling, Ellen R., 67
 Wetmore, Judith M., 48
 White, Catheryn E., 38
 Whitehead, Maria, 60
 Wible, Joe, 62
 Willard, Gayle K., 59
 Williams, Marsha, 65,
 Williams, Thomas, 47, 61, 66
 Wilcox, Susan, 50
 Willis, Dorothy, 51
 Wilson, Jacqueline, 42
 Woelf, Nancy N., 36
 Wolf, Diane G., 35
 Wood, Elizabeth H., 50
 Woods, John A., 54
 Wulff, Judith L., 48
- Y**
 Yau, Linda S., 65
 Yokote, Gail, 57
- Z**
 Zogott, Joyce, D., 60

INTRODUCING

SEDBASE

The Meyler's Side Effects of Drugs Database



SEDBASE, a specialized, evaluated drug information database, contains over 22,000 concise synopses of all significant adverse drug reactions, drug side effects, and drug interactions reported each year in over 3,500 journals published in 110 countries.

SEDBASE provides

- Expert drug side effects evaluations by recognized authorities.
- Access by drug names and classes, trade names, chemical names, and all synonyms.
- Access by drug effects and classes, and all effects synonyms.
- Access by interacting drug names and classes.
- EMBASE/Excerpta Medica abstracts, where cited, are added to SEDBASE records.

SEDBASE is produced by combining the authoritative book series: *Meyler's Side Effects of Drugs* and the *Side Effects of Drugs Annuals*. All volumes from the past 12 years, along with cited EMBASE records and a pharmacologic and chemical dictionary, combine to form SEDBASE, a powerful, comprehensive, expert-evaluated online drug information database.

A valuable end-user and information specialist reference resource

Side Effects of Drugs, Annual 12

edited by M.N.G. Dukes

1988 460 pages 0-444-90491-3 \$131.50

This annual is designed to provide an up-to-date account of new information relating to adverse drug reactions and interactions. It contains a complete overview of all known side effects of drugs, both major and obscure, from information obtained from more than 3,500 journals.

Due September 1988







Meyler's Side Effects of Drugs,

11th Edition

edited by M.N.G. Dukes

MEDICAL LIBRARY RESOURCES FROM ELSEVIER

ELSEVIER AND MEPC SOFTWARE

-  **MEDITEL® Computer Assisted Diagnosis, Adult Diagnostic System** Available in Fall 1988!
-  **Understanding Biostatistics: A computer-based tutorial**
-  **Elsevier Patient Simulations in Medicine: Pediatrics, Volume 1**
-  **Mathematics of Nursing Pharmacology**
-  **Clinical Simulations in Nursing Pharmacology**
-  **Computer Preparation for the Nursing Boards**
- Clinical Simulations in Nursing I**
- Clinical Simulations in Nursing II**

BOOKS AND JOURNALS



**Elsevier Science
Publishing
Company, Inc.**

52 Vanderbilt Avenue,
New York, New York
10017 (212) 370-5520

Elsevier • North-
Holland • Excerpta
Medica • Elsevier
Sequoia • Elsevier
Applied Science •
MEPC • Cuadra
Elsevier • Elsevier
International
Bulletins

Visit us at "ISLAND C"
May 23-25, 1988
10am-5pm

1988 Exhibitors

Company Name	Booth Number(s)
AARP Ageline Database	119 & 120
Adams Publishing Group, Ltd.	16
AMA/NET	101
American Association for Cancer Research	Rampart Room, T7
American Board of Medical Specialties	77
American Hospital Association	25
American Medical Association	79
American Psychiatric Press, Inc.	112
Aries Systems Corporation	118
ASHP (American Society of Hospital Pharmacists) Database	36
Baker and Taylor	26
Ballen Booksellers International, Inc.	47 & 48
BIOSIS	91
Boley International Subscription Agency	39
<i>British Medical Journal</i>	106
BRS Information Technologies	57 & 58
Cambridge Scientific Abstracts	104
Checkpoint Systems, Inc.	14
CINAHL	12
Clinical Reference Systems, Ltd.	96
CLSI, Inc.	105
Conference Book Service, Inc.	27
Congressional Information Service, Inc.	Rampart Room, T3
Data-Star, Inc.	30
DataTrek, Inc.	87
DIALOG Information Service, Inc.	34 & 35
DIAGENES	86
Dual Copy Systems	31
EBSCO Subscription Services	Island A
Elsevier Science Publishing Company	Island C
The FAXON Company	92-94 & 108-110
Gaylord Brothers	97, 98, & 99
General Meters Corporation	6
Georgetown University Library Information System	85
Gordon and Breach Scientific Publishers	Rampart Room, T4 & T5
Otto Harrassowitz	89
The Highsmith Company, Inc.	17 & 18
Institute for Scientific Information	113-117
Iowa Drug Information Service	13
Alfred Jaeger, Inc.	53
Library Automation Products, Inc.	82
J.B. Lippincott Company	76
Alan Liss, Inc.	83
Login Brothers Book Company	50

Majors Scientific Books, Inc.	Island B
Marcel Dekker, Inc.	20
Marcive, Inc.	33
Marquis Who's Who/MacMillan Directory Division	95
Mathews Medical and Scientific Books, Inc.	80 & 81
McGregor Subscription Service, Inc.	28
Medi-Sim, Inc.	46
MEDLINK	59
Micromedex, Inc.	43 & 44
The C.V. Mosby Company	5
National Cancer Institute, International Cancer Information Center	100
National Center for Health Statistics	Rampart Room, T1
National Library of Medicine	Island D
Nedbook International	73
Network for Continuing Medical Education	7
OCLC	51 & 52
Omnifax/Telautograph	107
Online Research Systems, Inc.	Rampart Room, T2
The Oryx Press	45
PaperChase	38
Pergamon Press	8
Personal Bibliographic Software, Inc.	21
Population Information Program	75
Princeton Microfilm Corporation	49
Professional Software	78
PsycINFO, American Psychological Association	29
The Publishers Book Exhibit, Inc.	9 & 10
Readex Microprint	Rampart Room, T6
Readmore Publications, Inc.	1-4
Research Information Systems	103
Right on Programs	42
Rittenhouse Book Distributors, Inc.	54
W.B. Saunders Company	19
Scholarly Publications	40
Scientific American Medicine	11
Scientific and Medical Publishers of France	84
SilverPlatter Information, Inc.	22
Springer-Verlag, New York, Inc.	111
Sydney Development Corporation	72
Teaching Films, Inc./MEES	74
UMI (University Microfilms International)	55 & 56
Universal Serials and Book Exchange, Inc.	41
University Products, Inc.	37
Veterans Administration	24
XCP/Venda Card	88
Year Book Medical Publishers	90

Database Quiz

1. Does your institution subscribe to?
 - A. POISINDEX®
 - B. DRUGDEX®
 - C. EMERGINDEX®
 - D. Other Micromedex[®] Information systems on CD-ROM, Mainframe or Microfiche
2. What department(s) subscribe?
 - A. Poison Center
 - B. Emergency Department
 - C. Pharmacy
 - D. Medical Library
 - E. All of the above
3. The following is/are true about Micromedex:
 - A. Micromedex was the first to provide medical databases on CD-ROM.
 - B. Micromedex Databases provide peer reviewed patient care information developed by and for clinicians.
 - C. About 2,000 U.S. Hospitals subscribe to one or more Micromedex Databases.
 - D. All of the above
4. How do you find out?
 - A. Visit the Micromedex Booth #43 & 44 at the 1988 MLA Meeting in New Orleans
 - B. Contact Micromedex:
660 Bannock Street - Suite 300
Denver, Colorado 80204
(800) 525-9083
(303) 623-8600

With the correct answers, you could add the Micromedex Databases on CD-ROM to your personal computer system for as little as \$995 per year!



MICROMEDEX, INC.

COMPUTERIZED CLINICAL INFORMATION SYSTEMS

Index to Advertisers

	Page
AMA/NET	25
American Hospital Association	26
American Psychiatric Press/PsychINFO	iv
American Psychological Association	22
American Society of Hospital Pharmacists	4
BRS Information Technologies	cover 3
Cambridge Scientific Abstracts	28
CINAHL	69
DataTrek, Inc.	cover 4
Data-Star, Inc.	91
DIALOG	17
EBSCO Subscription Services	11
Elsevier Science Publishing	15, 76-77
The FAXON Company, Inc.	vi
Information on Demand	18
ISI (Institute for Scientific Information)	cover 2
Library Automation Products	21
Marquis Who's Who	12
Micromedex, Inc.	80
OCLC	2
OCLC Local Systems	83
The Oryx Press	26
PaperChase	ii
Pergamon Press	86
Readmore Publications, Inc.	18, 90
Research Publications	8, 27
Springer-Verlag, New York, Inc.	6
Sydney DataProducts	87
UMI (University Microfilms International)	73

Committee Meetings Schedule

All meeting rooms are located in the Sheraton New Orleans Hotel.

COMMITTEE	Date	Time	Location
Awards	5/23	7:00 a.m.	Bonnie Burn
Awards Juries	5/25	7:00 a.m.	St. Charles B
<i>Bulletin</i> Consulting Editors	5/23	7:00 a.m.	Salon 824
Bylaws	5/24	7:00 a.m.	Ellendale
Continuing Education	5/21	1:00 p.m.	Ellendale
	5/22	8:00 a.m.	Ellendale
	5/23	7:00 a.m.	Estherwood
	5/25	7:00 a.m.	Salon 808
Credentiailling	5/21	8:00 a.m.	Estherwood
	5/22	8:00 a.m.	Estherwood
	5/23	7:30 p.m.	St. Charles A
	5/24	7:00 a.m.	Oakley
	5/25	7:00 a.m.	Salon 812
Editorial Committee for the <i>Bulletin</i>	5/24	7:00 a.m.	Gallier House
Editorial Committee for the <i>MLA News</i>	5/23	7:00 a.m.	Ellendale
Editorial Panel for the Certification and Registration Examination	5/22	8:00 a.m.	Felicity
	5/24	7:00 a.m.	Felicity
Exchange	5/23	7:00 a.m.	Salon 817
Governmental Relations	5/23	7:00 a.m.	Gallier House
	5/23	5:00 p.m.	Felicity
Grants and Scholarships	5/24	7:00 a.m.	Edgewood
Grants and Scholarships Juries	5/25	7:00 a.m.	St. Charles B
Health Sciences Library Technicians	5/24	7:00 a.m.	Crescent
International Cooperation	5/23	7:00 a.m.	Felicity
	5/25	7:00 a.m.	Salon 828
Joseph Leiter NLM/MLA Lectureship	5/23	7:00 a.m.	Edgewood
Membership	5/25	7:00 a.m.	Salon 816
1988 National Program	5/21	4:00 p.m.	Felicity
1989 National Program	5/23	7:00 a.m.	Oakley
	5/25	7:00 a.m.	Salon 824
1990 National Program	5/21	8:00 a.m.	Gallier House
	5/25	7:00 a.m.	Salon 820
	5/26	8:30 a.m.	Gallier House
Oral History	5/25	7:00 a.m.	Wildwood
Program and Convention	5/23	7:00 a.m.	Crescent
Publication Panel	5/21	8:00 a.m.	Evergreen
	5/22	8:00 a.m.	Evergreen
	5/24	7:00 a.m.	Evergreen
	5/25	7:00 a.m.	Salon 817
Publishing and Information Industries Relations	5/25	7:00 a.m.	Salon 829
Status and Economic Interests of Health Sciences Library Personnel	5/24	7:00 a.m.	Estherwood

OCLC Local Systems

Building On Four Years of Growth and Twenty Years of OCLC Experience

- * 148 installations serving 251 libraries
- * 90 Local Systems staff to respond to users' needs
- * 87 SC350 system installations

1987 was a year of growth and stability for OCLC Local Systems, as each year we build upon the year before, expanding our number of users and providing better service through enhancements to our systems.

LS
2000 LS/2000

1987 Introduced **authorities control software**, enabling new LS/2000 sites to check their headings against LC authority records and add cross-references before bringing up their online catalog.

SC
350 SC350

1987 Introduced serials control multi-user capability and the new, powerful M350 Workstation.

ACQ
350 ACQ350

1987 Introduced complete microcomputer-based acquisitions processing system, for use in a single or multi-user environment.

CD
2000 CD/2000

1987 Responding to the need for system backup, we developed and introduced CD/2000. Now LS/2000 sites can access their database on a compact disc so that online downtime is no longer a problem and remote sites have access to the database.



We believe our steady growth shows libraries know Local Systems—and OCLC—are names they can count on for support, stability, and development, now and in the future. For more information on how OCLC and the staff of Local Systems can work for you, please call us toll-free. 800-848-5878 Ext. 6403, 800-848-8286 Ext. 6403 (Ohio).

Visit OCLC Local Systems at the MLA
Conference **Booth 51.**

OCLC
Local Systems

Informal Meetings Schedule

All Informal Meetings will be held in the Sheraton New Orleans Hotel.

MONDAY, May 23

7:00 a.m. - 8:00 a.m.

National Library of Medicine: NLM Online Users Meeting Pontchartrain A

7:00 a.m. - 9:00 a.m.

Association of Academic Health Sciences Library Directors (AAHSLD): Board of Directors Meeting Aurora

Cumulative Index to Nursing & Allied Health (CINAHL) User's Group: Cumulative Index to Nursing & Allied Health Literature (CINAHL)—Print, Online, & Floppy Disk St. Charles A

Hospital Libraries Section: Strategic Planning Committee Meeting Salon 812

Hospital Libraries Section: Membership Committee Meeting Salon 816

Hospital Libraries Section: Automation Committee Meeting, Bylaws Committee Meeting Salon 820

Pediatric Library Group: Pediatric Librarians Meeting St. Charles B

Public Services Section: Executive Committee Meeting Salon 828

Selective Medical Library Microfiche: International meeting with participants from four countries in an experiment establishing high-quality, low-cost biomedical core collections in developing countries. Salon 825

UMI/Data Courier and BRS Information Technologies The Business Prescription: Finding Business Information for the Health Sciences Bayside B

TUESDAY, May 24

6:00 p.m. - 8:00 p.m.

Association of Visual Science Librarians: Informal Meeting Oakley

Data Trek Users Group: What's Happening at DTI Bayside A

Hospital Libraries Section: Automation Forum Aurora

Hospital Libraries Section: Task Force on Hospital Library Statistics	Felicity
Hospital Libraries Section: Government Relations Committee Meeting, Publications Committee Meeting	Estherwood
Information Management Education Special Interest Group Online Searching Services Special Interest Group End-User Forum	St. Charles
Southern Chapter: Executive Committee Meeting	Bonnie Burn
Technical Services Section: Strategic Planning Committee	Ellendale
Veterans Administration: VA Librarians Meeting	Bayside B

WEDNESDAY, May 25

7:00 a.m. - 9:00 a.m.

Association of Academic Health Sciences Library Directors (AAHSLD): Board of Directors Meeting	Safron
Hospital Libraries Section: Awards Committee, Membership Committee, Task Force on Section Fiscal Affairs	Pontchartrain D
Hospital Libraries Section: 1989 National Program Committee, Professional Development Committee, Task Force on a National Agenda on Hospital Libraries	Salon 825
Hospital Libraries Section: Strategic Planning Committee	Rhythms
National Cancer Institute: PDQ User Group Meeting	Pontchartrain B
Public Services Section Fee Based Services SIG: Fee Based Services Interest Group Organizational Meeting	Aurora
5:30 p.m. - 7:00 p.m.	
Hospital Libraries Section: Executive Committee Meeting	Safron
Medical Informatics Roundtable: Business Meeting	Salon 828
National AHEC Libraries Network: Providing Information and Library Services to Rural Areas	Salon 824
Technical Services Section: Executive Board Meeting	Salon 816

MEDICAL DOSIMETRY

PERGAMON PRESENTS THE LATEST IN MEDICAL PUBLISHING

PERITONEAL DIALYSIS INTERNATIONAL

The Basic Science of Oncology
Ian F. Tannock & Richard P. Hill

COMPREHENSIVE CARDIOLOGY INTERNATIONAL

NEW

CLINICAL BIOCHEMISTRY REVIEWS

Edited by: D.M. Goldberg (Toronto), W.H.C. Walker (Hamilton, Ontario)

Volume 1, 1987-1988 hardcover Published bi-annually
Volume 1: \$70.00

CURRENT ADVANCES IN CANCER RESEARCH

Volume 1, 1988 Published 12 per annum
Annual subscription rate (1988): \$365.00

ELECTRON MICROSCOPY REVIEWS

Editor-in-Chief: J.R. Harris (Brentwood, U.K.)

Volume 1, 1988 Published 2 per annum
Annual subscription rate: \$120.00

NEURAL NETWORKS

The Official Journal of the International Neural Network Society
Editor-in-Chief: S. Amari (Tokyo), S. Grossberg (Boston),
T. Kohonen (Helsinki).

Volume 1, 1988 Published 4 per annum
Annual subscription rate (1988): \$95.00

NOW PUBLISHED BY PERGAMON

BIOGENIC AMINES

Chief Editors: H. Parvez (Orsay, France), T. Nagatsu (Nagoya, Japan), C.O. Rutledge (W. Lafayette, IN)

Volume 5, 1988 Published 6 per annum
Annual subscription rate (1988): \$195.00

MEDICAL DOSIMETRY

The Official Journal of the American Association of Medical Dosimetrists

Co-Editors: P.W. Redmond (Scranton, PA), R. Garcia (Portland, OR)

Volume 13, 1988 Published 4 per annum
Annual subscription rate (1988): \$60.00

PERITONEAL DIALYSIS INTERNATIONAL

Journal of the International Society for Peritoneal Dialysis
Editor: D. Oreopoulos (Toronto)

Volume 8, 1988 Published 4 per annum
Annual subscription rate (1988): \$110.00

APPEARING IN FALL 1988

CELLULAR SIGNALLING

Will publish original papers and short reviews covering all aspects of mechanisms, actions, and structural components of cellular signalling systems.

Volume 1, 1988/89 Published 6 per annum
Annual Subscription (1989): Contact Pergamon



PERGAMON PRESS, INC.
A member of the Maxwell Communication Corporation Group of Companies Maxwell House, Fairview Park, Elmsford, NY 10523, USA
PERGAMON PRESS LTD.
A member of Pergamon Press plc Publishing Group Headington Hill Hall, Oxford OX3 0BW, UK

BOOKS OF NOTE

THE BASIC SCIENCE OF ONCOLOGY

Ian F. Tannock, M.D., Ph.D. & Richard P. Hill, Ph.D., The Ontario Cancer Institute and the University of Toronto

This text covers all aspects of basic science related to cancer causation, biology and treatment. It is designed as a reference for those involved in cancer treatment and for students with an interest in cancer, such as residents in clinical radiation oncology and pre- and post-doctoral trainees and workers in cancer research.

February 1987 ISBN 0-08-032389 8 hardcover 406 pp. \$87.50
ISBN 0-08-032388 X softcover \$37.50

COMPREHENSIVE CARDIOLOGY INTERNATIONAL

Edited by Tsung O. Cheng, M.D., M.S. (Medicine), The George Washington University Medical Center, Washington, D.C.

Comprehensive Cardiology International presents a comprehensive look at all aspects of modern cardiology. Vast in scope, with contributions from authorities worldwide, this volume serves as an ideal primary reference, yet also distinguishes itself from all other texts in its field.

February 1987 ISBN 0-08-035562 5 hardcover 1328 pp. \$195.00

ATOMS, RADIATION, AND RADIATION PROTECTION

by James E. Turner, Oak Ridge National Laboratory

This text describes basic atomic and nuclear structure, the physical processes that result in the emission of ionizing radiation, and external and internal radiation protection criteria, standards, and practices from the standpoint of their underlying physical and biological properties.

1985 ISBN 0-08-031937 8 hardcover 336 pp. \$70.00
ISBN 0-08-031949 1 softcover \$35.00

INTRODUCTION TO HEALTH PHYSICS, 2nd Edition

by Herman Cember, Northwestern University

In the revised and expanded second edition of this classic work, Dr. Cember presents a major text-guidebook which offers students a background and basic understanding of the biophysical bases of radiation, radiation safety standards and the key factors in radiation protection.

1983 ISBN 0-08-030129 0 hardcover 536 pp. \$85.00
ISBN 0-08-030936 4 softcover \$36.00

Sample copies of journals are available upon request.

U.S. Dollar prices quoted apply to customers in North, Central and South America and include postage and insurance. For prices in other countries, please inquire to Pergamon. Prices are subject to change without notice.

Have you read a best seller lately?

Title: The Complete Automation Solution

Author: Sydney Library Systems

- for corporate and special libraries
- comprised of 5 fully integrated modules
- completely automates circulation, cataloging, inquiry, materials acquisition and serials management
- will run on IBM and IBM compatible micros and DEC VAX minicomputers

Come see us in New Orleans at M.L.A.
Booth #72

Sydney Dataproducts, Inc.

Los Angeles, California
Iselin, New Jersey
Toronto, Ontario
Vancouver, British Columbia
London, England



For Information Call Toll Free: 1-800-663-6951

NOW AVAILABLE!

Volume III, *The Handbook of Medical Library Practice*

HANDBOOK OF MEDICAL LIBRARY PRACTICE, Volumes I through III
All three volumes edited by Louise Darling; Associate Editors, David Bishop
and Lois Ann Colaianni. Published by the Medical Library Association.

Volume III, Health Science Librarianship and Administration \$35.00
(1988, 593 pages, 6" x 9", hardcover). Contents include chapters
on professional associations, the National Library of Medicine,
interlibrary cooperation, general principles of administration applied
to health sciences, personnel, promoting and enhancing the library
program, space planning, and special collections.

Volume II, Technical Services in Health Science Libraries \$27.50
(1983, 392 pages, 6" x 9", hardcover)

Volume I, Public Services in Health Sciences Libraries \$22.50
(1982, 344 pages, 6" x 9", hardcover)

Three-Volume set \$80.00

Name _____

Institution _____

Address _____

City _____ State _____ Zip _____

Check enclosed _____ Charge to: Visa MasterCard

Card number: _____ Expiration date: _____

Return this form to MLA, 919 N. Michigan Ave., Suite 3208, Chicago, IL 60611.
Prices include bulk rate shipment; add \$5 per book for airmail or UPS shipment.

Volume I _____ copies x \$22.50 _____ Volume II _____ copies x \$27.50 _____

Volume III _____ copies x \$35.00 _____ 3-volume set _____ copies x \$80.00 _____

UPS or airmail _____ books x \$5.00 _____ TOTAL \$ _____

Index

	Page
Advertisers, Index to	81
Appointed Officers	3
Banquet	14
Board of Directors	1
Business Sessions	38, 57, 63
Chapter Council Meeting	30, 67
Child Care	16
Committee Meeting Schedule	82
Continuing Education Courses	9
Contributors	7
Daily Program	
Wednesday, May 18	29
Thursday, May 19	29
Friday, May 20	29
Saturday, May 21	30
Sunday, May 22	31
Monday, May 23	37
Tuesday, May 24	48
Wednesday, May 25	58
Thursday, May 26	68
Friday, May 27	68
Exhibit, MLA	16
Exhibit, 1988 (commercial)	19
Exhibitors	78
Expo '88	58, 66
Film Festival 1988	19
General Information	13
Handicapped Access	24
Headquarters Staff	3
Honors and Awards Ceremony	52
Hospitality Booth	14
Informal Meeting Schedule	84
Janet Doe Lecture	52
John P. McGovern Lecture	32
Lost and Found	20
Maps	70
Meeting Locations	19
Message Center	23
MLA Exhibit	16
MLA Office	23
MLA Scholarship Booth	16
National Program Committee	5
New Member Orientation	36

Newsletter.....	23
Office Equipment.....	23
Opening Session.....	31
Plenary Sessions.....	37, 64
Placement Service.....	23
Presenters, Index to.....	74
President's Reception/Masquerade Party.....	14
Registration Center.....	13
Safety Tips.....	24
Section Council Meeting.....	30, 67
Scholarship Booth, MLA.....	16
Taped Sessions.....	19
Tickets for Special Activities.....	14
Tours Desk.....	16
Welcome Reception.....	14
1989 Annual Meeting.....	24

REDUCE YOUR SERIALS MANAGEMENT PROBLEMS.

Now you can use a few square inches of counter space to support a full serials management system. Remo, the first micro-computer based software package handles the full range of serials management functions. Remo offers automated claiming, routing management, analysis and user generated custom reports in a stand alone or network configuration.

Remo is the modern cost effective way to convert a time consuming manual process into a fast and easy check-in operation with full automated support. In the event of questions, an answer is only a phone call away on our toll free hot line.

Find out how Remo can help you reduce your serials management problems. Write for further information or call us at (800) 221-3306.



remo

READMORE

140 Cedar Street, New York, N.Y. 10006

2

EXCEPTIONAL PHARMACEUTICAL DATABASES

Pharmaprojects & Scrip

ONLY ON DATA-STAR!

Data-Star, Europe's best online host, does it again!

Our Pharmaprojects database offers the most complete, up-to-date pharmaceutical information available today. Containing intelligence about more than 4,000 new products, from their earliest developmental stages to launch, from over 800 of the most distinguished companies and organizations around the world, Pharmaprojects provides the crucial marketing, licensing and R&D information you need. And, it's fast, flexible and easy to use.

Our Pharmaceutical Industry News is the only full text, online version of the prestigious SCRIP newsletter. Truly international, SCRIP online gives you important, up-to-the-minute, pre-publication information on products, markets, companies, people, conferences, and more!

Over 40 key biomedical and pharmaceutical databases join Pharmaprojects and SCRIP on Data-Star.

Enjoy the benefits of some very special services. Subscribe, and be a Data-Star... Today!

Call the USA Help-Desk

toll-free at 1-800-221-7754 or 215-687-6777.

**Visit
Booth
#30**



data-star

Suite 110, 485 Devon Park Drive, Wayne, PA 19087
THE GLOBAL SERVICE.

Notes

Notes

Notes

Come
visit us at
Booth #57-58

When is MEDLINE better than MEDLINE?



Online... On tape... On CD-ROM... with an advanced front end. MEDLINE is clearly the most pervasive source of medical information in the world. But are all MEDLINE's alike? What makes one MEDLINE more effective, more efficient than another? MEDLINE was BRS's first database in 1977. Since then, the company has innovated such new features as **quick search/quick explodes, fast ways to limit human and english searches, the entire MEDLINE in a single database and menu-driven options for online novices.** But BRS hasn't stopped there. Continuing to look for improvements, recently BRS introduced **automatic searching of British spellings, automatic plurals and a new field for unabbreviated journal titles.**

BRS created these tools to make MEDLINE searching faster and more effective. If you use MEDLINE online, on CD-ROM or through some other medium, are you getting the most out of the time and money you invest? Are your results as effective as they can be? Look at BRS before you answer.

When is MEDLINE better than MEDLINE? ...When it comes from BRS.

BRS ~~SEARCH~~ SERVICE

1-800-468-0908



HOW TO TAME YOUR LIBRARY.

Even the most efficient library can be a real jungle.

But no more. Data Trek can help you cut through the tangle of managerial and clerical drudgery with high-performance, fully-supported microcomputer automation software.

Regardless of your library's size, specialty or budget, Data Trek can provide everything you need to streamline your operation. Like microcomputer and LAN hardware. Comprehensive training. Technical expertise. And outstanding online support. Data Trek makes automation

very affordable, too, thanks to a unique software design which allows you to put individual modules to work, or combine them into a fully integrated system.

Still not convinced? Then consider this: our state-of-the-art Card Datalog™ System is being used by more special librarians than any other microcomputer system in the world. And, right now, you can get a preview of exactly what it will do for you. Just fill out the coupon below

and mail it in. In return, we'll send you a free Card Datalog Sampler so that you can take your own self-running, guided tour.

If greater efficiency and productivity are what you're hunting for, check out Data Trek.

We think you'll find the difference anything but tame.

 data trek

We wrote the book on library automation.

621 Second Street
Encinitas, California 92024
Telephone 619/436-5055

© 1987 Data Trek, Inc.

Explore The Data Trek Demo Free Card Datalog Sampler

For your Card Datalog Sampler, fill out the coupon, attach it to your letterhead, and return to Data Trek, 621 2nd St., Encinitas, CA 92024, ATTN: Tom Beaudin. Note: IBM PC, XT or 100% compatible hardware with minimum 512K RAM required.



NAME _____

TITLE _____

LIBRARY NAME _____

ADDRESS _____

CITY _____ STATE _____ ZIP _____

() _____

PHONE _____ MAIL